

CALENDAR FOR THE ACADEMIC YEAR 2016
SPRING SEMESTER 2016 (April 1 - September 20, 2016)

2016

APRIL		
2 (SAT)	Entrance ceremony for new students	
	Orientation for new students	
2 (SAT)-12 (TUE)	Course registration	
3(SUN)	Japanese Placement Test	
	(only for students who wish to take Japanese language courses)	
11 (MON)	Classes begin	
13 (WED)	Results of course registration available on Loyola	
14 (THU)-16 (SAT)	Course adjustment	
19 (TUE)	Final confirmation of course registration available on Loyola	
29 (FRI)	Classes to be held	
MAY		
9 (Mon)-12 (Thu)	Withdrawal period for courses offered in the first half of the semester	
31 (TUE)	Leave of absence application deadline	
JUNE		
6 (MON)-10 (FRI)	Withdrawal period	
18 (SAT)	Make-up classes	
JULY		
2 (SAT)	Make-up classes	
10 (SUN)	Make-up classes	
16 (SAT)	Make-up classes	
21 (THU)	Classes end	
22 (FRI)-29 (FRI)	Final examinations Extra day : JULY 29 (FRI)	
AUGUST		
1 (MON)- SEPT 28 (WED)	Summer vacation	
26 (FRI)	Grades available on Loyola (for second year and graduating students)	
29 (MON)	Deadline for Request for grade review (for second year and graduating students)	
SEPTEMBER		
9 (FRI)	Announcement of graduating students on Loyola	
10 (SAT)	Grades available on Loyola	
16 (FRI)	Graduation ceremony	
20 (TUE)	Deadline for request for grade review (for 2016 spring courses)	

AUTUMN SEMESTER 2016 (September 21, 2016 - March 31, 2017)

2016

SEPTEMBER

21 (WED)	Entrance ceremony for new students Orientation for new students
21 (WED)- 30 (FRI)	Course registration
22 (THU)	Japanese Placement Test (only for students who wish to take Japanese language courses)
29 (THU)	Classes begin

OCTOBER

1 (SAT)-2 (SUN)	Results of course registration available on Loyola
3 (MON)-5 (WED)	Course adjustment
7 (FRI)	Final confirmation of course registration available on Loyola
10 (MON)	Classes to be held
24 (MON)-27 (Thu)	Withdrawal period for courses offered in the first half of the semester
31 (MON)	No Class Day

NOVEMBER

1 (TUE)	Foundation Day / Memorial Service (No Class Day)
1 (TUE)-3 (THU)	Sophian's Festival
2 (WED)	No Class Day
23 (WED)	Classes to be held
30 (WED)	Leave of absence application deadline

DECEMBER

5 (MON)-9 (FRI)	Withdrawal period
10 (SAT)	Make-up classes
17 (SAT)	Make-up classes
23 (FRI)-JAN 4 (WED)	Winter recess

2017

JANUARY

5 (THU)	Classes resume
6 (FRI)	Virtual Wednesday*
7 (SAT)	Make-up classes
12 (THU)	Virtual Monday*
14 (SAT)	Make-up classes
24 (TUE)	Classes end
25 (WED)-FEB 1 (WED)	Final examinations Extra day: FEB 1(WED)

FEBRUARY

2 (THU)-MAR 31 (FRI)	Spring vacation
24 (FRI)	Grades available on Loyola (for second year and graduating students)
28 (TUE)	Deadline for Request for grade review (for second year and graduating students)

MARCH

15 (WED)	Announcement of graduating students on Loyola
16 (THU)	Grades available on Loyola
27 (MON)	Graduation ceremony
31 (FRI)	Deadline for request for grade review (for 2016 autumn courses)

* Virtual days are scheduled so that each course is held a sufficient number of hours to fulfill the requirements set by the Ministry of Education, Culture, Sports, Science and Technology (MEXT).

HOLIDAYS AND NO-CLASS DAYS

Spring Semester:

May 3 (Tue)	Constitution Memorial Day (National Holiday)
May 4 (Wed)	Greenery Day (National Holiday)
May 5 (Thu)	Children's Day (National Holiday)
July 18 (Mon)	Marine Day (National Holiday)

Autumn Semester:

October 31 (Mon)	School Holiday
November 1 (Tue)	Foundation Day / Memorial Service (School Holiday)
November 2 (Wed)	School Holiday
November 3 (Thu)	Culture Day (National Holiday)
December 3 (Sat)	St. Xavier's Day (School Holiday)
January 9 (Mon)	Adults' Day (National Holiday)

CLASS CANCELLATIONS

Classes are normally held according to the academic calendar, but they may be canceled due to an academic conference, business trip or illness of a faculty member. Class cancellations are announced on Loyola when the teacher notifies the Center for Academic Affairs. An announcement may be posted on Loyola on the same day a class is canceled, so please make it a habit to check Loyola before each class. You may check class cancellations on the day of the class also from your mobile phone.

If a faculty member does not come to class within 30 minutes of the starting time, please notify the Center for Academic Affairs and follow the instructions.

MAKE-UP CLASSES

Make-up classes are normally held on predetermined dates scheduled in the Spring and Autumn Semesters, but other days may also be arranged for make-up classes. In both cases, the days for the make-up classes will be announced on Loyola; please check the date, time, and classroom.

Class cancellations, make-up classes or any additional no-class days will be announced on the Loyola bulletin board.
--

CONTENTS

SOPHIA UNIVERSITY	1
GENERAL INFORMATION	2
REGULATIONS AND PROCEDURES	10
TUITION AND FEES, FINANCIAL ASSISTANCE	18
GRADUATE PROGRAM IN GLOBAL STUDIES	23
M.A. CURRICULUM	29
M.A. Degree Requirements and Schedules	29
Regulations and Procedures	32
M.A. in Global Studies	35
M.A. in International Business & Development Studies	41
M.A. in Japanese Studies	45
Registration Codes and Course List	50
Dual Degree Program Sophia (GPGS)-SOAS	54
PH.D. CURRICULUM	55
Ph.D. Degree Requirements and Schedules	55
Ph.D. in Global Studies	55
Ph.D. in Japanese Studies	59

GRADUATE PROGRAM IN SCIENCE AND TECHNOLOGY65

M.A. CURRICULUM.....72

Ph.D. CURRICULUM82

INTERNATIONAL GRADUATE COURSE

IN GLOBAL ENVIRONMENTAL STUDIES89

M.A. CURRICULUM.....94

PH.D. CURRICULUM107

Ph.D. Degree Requirements and Schedules 110

SOPHIA UNIVERSITY

Sophia University was founded in 1913 by the Jesuits, a Catholic order renowned for excellence in education. From the beginning, the university founders stressed an internationally oriented curriculum and rigorous training in foreign languages. Sophia soon established itself as a leading institution for scholarship in foreign languages and literature in Japan. After World War II, personnel and contributions flowed in from abroad, new departments were created including the International Division offering courses in English, and women were enrolled. Links between its research institutes and similar centers throughout the world strengthened Sophia's international reputation, as did its English-language publications, including the quarterly journal *Monumenta Nipponica*, a leading journal of Japanese studies.

Today Sophia University is a major teaching and research university with 12,000 students and a teaching staff of 1,000 representing dozens of nationalities. Graduate education at Sophia has been recognized for excellence by the Japanese Ministry of Education, Culture, Sports, Science and Technology (MEXT) through several government-supported projects and awards. Sophia's advanced research and study is based in the numerous graduate programs and research institutes, and it is supported by a central library and a number of specialized libraries. Located in Tokyo's Chiyoda district near the National Diet and Imperial Palace, Sophia is easily accessible by train and subway.

GENERAL INFORMATION

1. THE ACADEMIC YEAR

There are two semesters, beginning in April and September. Each semester consists of 15 weeks of classes, including final examinations. To ensure that each course is held a sufficient number of hours to fulfill the requirements of MEXT, make-up class days for regular class days canceled for any reason may be scheduled at the end of the term prior to the examination period.

2. LOYOLA WEB-SERVICE

The Loyola web-service for teachers and students enables students to:

- Register and withdraw from courses (there are some exceptions)
- Check their registration status and grades
- Check information concerning canceled classes, make-up classes, and notices on an online bulletin board through PCs and mobile phones
- To check and submit report assignments electronically

Please refer to the “Loyola Handbook” (available online via Loyola web-service) for a detailed explanation of how to use Loyola.

3. RESOURCES

Sophia University’s library holds approximately 1,100,000 books and 11,000 periodicals. The central library has open stacks for ease of use while specialized collections are found in smaller libraries and research institutes. The library’s digital resources include online searches of its holdings (OPAC), extensive databases, e-journals, and specialized search engines for journal and newspaper articles. Holdings from universities throughout Japan are also accessible through inter-library loans.

4. CATEGORIES OF STUDENTS

A. Degree Student

Degree students are those who intend to earn a degree from Sophia.

B. Non-Degree Student

Non-degree students are those who enroll for one year to take courses and obtain credits but do not intend to earn a degree. This category includes graduate students who are pursuing a graduate degree at another university and wish to come to Japan either to do

research for their thesis or undertake related course work. Non-degree student status is applicable only to international students who enroll as full-time students. The application deadline is the same as for degree students.

C. Non-Matriculated Students (科目等履修生自由履修コース)

Non-matriculated students are persons of any nationality who wish to take one or more courses of their choice, up to 10 credits in one year, but do not intend to earn a degree from Sophia. In order to be eligible for this status, the student must have already completed an undergraduate degree and hold a valid visa for Japan.

5. HEALTH AND INSURANCE

-National Health Insurance System

International students who will stay in Japan for more than three months are required to join this insurance system. The procedures are carried out at the local ward/city office.

-Personal Accident Insurance for Students Pursuing Education and Research

All degree students and exchange students must be affiliated with this insurance plan. This plan covers physical injuries a student suffers during prescribed educational and research activities at the university and during commuting to school and in transit between school facilities.

Additional information can be found in ‘Sophians’ Guide 2016’

6. CERTIFICATES

Various certificates are obtained either from the certificate issuance machine or at relevant offices. Check the type of certificates you need and apply as follows:

Certificates from the certificate issuance machine

Certificates	Fees	Day of issue	Notes
Certificate of Attendance (Japanese / English)	¥200	On the same day	Issuance machines are installed on: • 4th floor, Bldg. No.2; • Mejiro Seibo Campus (in office center) Service Hours: Mon. - Fri. 9:00 to 17:00 * any changes due to school events will be announced
Official Transcript (Japanese / English)	¥200		
Certificate of prospective graduation (Japanese / English)	¥200		
Student Travel Discount Certificate	free		
Medical Checkup Certificate (university designated form in Japanese only)	¥300		
Temporary Student ID Card (issued only during Final Exam period)	¥500		

Please follow the voice instructions of the certificate issuance machine on how to operate the machine.

- *A Student ID Card is required in order to have a certificate issued. The certificate issuance machine is available for current students only.
- *The Certificate of Prospective Graduation certifies that the final year student is eligible to graduate if the student has met all graduation requirements, but it does not mean that the University guarantees the student's graduation.
- *Up to 10 copies of Student Travel Discount Certificate can be issued from the machine. If you need more copies, please inquire at the Center for Student Affairs.
- *For the password, inquire at the Center for Academic Affairs, Academic Records Section.

Certificates issued at the office

Certificates	Fees	Day of issue
Certificate of prospective acquisition of teacher's license	¥400	Takes 3 working days from application date
Certificates necessary for application of "Permission to change the status of residence" and "Permission to extend period of stay"	¥200	Application received → Day of issue • Mon./Tue. → Fri. • Wed./Thu. → following Mon. • Fri. → following Wed.
Reissuance of Student ID Card	¥1,000	On the same day

Office in charge: Center for Academic Affairs, Academic Records Section; 1F, Bldg. No.2

Office hours: Mon.-Fri. 9:30 - 11:30, 12:30 - 17:00

* Any changes due to school events will be announced on Loyola.

- 1) Complete application forms available at the office.
- 2) Purchase fee payment sticker from the vending machine and place it on the application form.
- 3) Submit completed application forms with your Student ID Card to the office. Receipts will be issued to the applicant.
- 4) On the day of issue, show the Receipt at the office and receive the certificate.

7. STUDENT IDENTIFICATION CARD (ID CARD)

The Student ID Card certifies that you are a student of Sophia University. Carry it with you at all times as you may be asked to show it in various situations both on and off campus. Services may not be provided if you do not have your Student ID Card.

Student ID Cards should not be lent or given to another person for any reason. In the case of withdrawal from the university, the Student ID Card must be returned as it is no longer valid.

■ You will need the Student ID Card in the following cases:

- 1) to take the exams
- 2) to use the certificate issuance machine and obtain a certificate or student travel fare discount certificate
- 3) to enter the university main library, to borrow library books
- 4) to buy a commuting pass
- 5) to show at the request of officials when you are on trains etc. using a commuting pass or student discount ticket
- 6) to show when requested by a program member or staff of Sophia University

8. EXTENSION OF PERIOD OF STAY AS “COLLEGE STUDENT” / CHANGE OF STATUS OF RESIDENCE TO “COLLEGE STUDENT”

For procedures to extend your period of stay or change your status of residence, please refer to ‘Sophians’ Guide 2016’. Please note that among the documents submitted to the Immigration Bureau, there are forms that must be filled out by the Academic Records Section, which take about four days to be issued.

After your application is approved;

1. Please register the changes in registration at the residential municipal office within 14 days.

2. Please submit a photocopy of the updated “Resident Card” to the Center for Academic Affairs, Academic Records Section as soon as possible.

※ Various disadvantages regarding school life, such as restriction from accessing Loyola or non-receipt of scholarships may occur until the above submissions are confirmed

9. GUARANTOR

Sophia University requires all students to have a guarantor. Sophia University sends important notices regarding academic affairs and school newsletters to the guarantor’s address, and may contact the guarantor in cases of emergency.

The guarantor should be one of the following (listed in order of priority) :

1. A parent living in Japan.
2. A person who lives in Japan and earns his/her living independently.
3. A person who earns his/her living independently and who lives in a foreign country. (This option is only for non-Japanese students.)

10. CHANGE OF GUARANTOR FOR SOPHIA UNIVERSITY, STUDENT’S NAME, AND OTHER CHANGES

If there are any changes in a student’s or guarantor’s address, renew the registered data on Loyola under the address registration menu. If the guarantor’s address is outside Japan, submit notification by the designated form available at the Academic Records Section (this option is only for non-Japanese students). If a student’s address is changed, receive a new enrollment sticker (Zaiseki-kakunin Seal) at the Academic Records Section.

If there is a change in the student’s name, submit notification by the designated form available at the Academic Records Section and attach a certificate of residence (住民票の写し) issued by the local government (stating the full name, gender, and date of birth of the student; permanent address and family relation information and Individual Number (My Number) is not required).

If a student intends to change his/her guarantor, submit notification by the designated form available at the Academic Records Section. Only non-Japanese students can have a guarantor who lives outside Japan.

11. BULLETIN BOARDS

Notices concerning classes (canceled classes, make-up classes, and change of classrooms) and announcements for individual students, including urgent matters, will be posted on the Loyola Web-Service bulletin board. Some notices may also be posted on university bulletin boards on campus. All students are strongly advised to check the Loyola and university bulletin boards regularly.

12. ABSENCES DUE TO LAY JUDGE SERVICE

Based on the “Act on Criminal Trials Examined under the Lay Judge System,” students may decline to serve as lay judges under the lay judge system. However, in order to respect the wishes of students that consent to being appointed as lay judges, absences due to lay judge service (including any attendant procedures) will be treated as follows:

A. Scope of Policy

This policy applies to degree-seeking undergraduate and graduate students as well as non-matriculated students. This policy does not apply to auditing students.

B. Accepted Grounds for Absence

- a. Appearing at a courthouse as a lay judge candidate for appointment procedures
- b. Attending a trial as a lay judge
- c. Sitting in on trial proceedings as an alternate lay judge

C. Procedures

In general, students must contact the Center for Academic Affairs, receive a copy of the designated Notification of Absence due to Lay Judge Service form, and submit this form, along with a copy of the Notice of Date for Lay Judge Appointment sent in the mail from the court, to the program member(s) in charge of the class(es) from which the student is to be absent. The student must also show to the program member(s) the post-trial discharge certification documentation issued by the court.

D. Handling of Absences

Provided that the student has given notice of absence by means of the designated forms mentioned above, the following considerations will be observed to avoid causing detriment to the student.

- a) The student will not be counted as absent to classes. Make-up opportunities will be determined by the program member.

- b) The student will not be counted absent for quizzes. Make-up opportunities will be determined by the program member.
- c) The student will not be counted absent for examinations. The student will be allowed to sit a make-up examination. The usual request for a make-up examination should be submitted on time.

13. WHEN PUBLIC TRANSPORTATION IS SHUT DOWN

When the university decides that it is not possible to hold regular classes or final exams due to the shutdown of transport services caused by natural disasters such as typhoons, heavy rainfall, accidents or strikes, classes may be canceled and exams rescheduled to another day. Such cancellation and changes will be announced on the university's official website, Loyola web-service or official Facebook. Please be sure to refer to those websites.

14. INFECTIOUS DISEASES

A student is not allowed to attend school for a designated period of time to prevent spread of the disease when he or she has contracted one of the diseases the School Health Law (Gakko-Hoken-Anzen-Ho) prescribes as "Gakko Kansen-sho" (such as influenza, measles, whooping cough, German measles, mumps and chicken pox).

For a new infectious disease such as new strains of influenza, special measures may be taken. Please check Loyola for any notices from the university.

If a student has contracted such an infectious disease:

1. The student must follow a physician's instructions and stay home until there is no risk of infection. Report it to the University Health Center by telephone, fax or via Loyola.
2. The student must download the "Doctor's permission to return to campus" (Toko Kyoka Sho) form from the university website or request the Health Center to provide the form and then ask the physician to fill out the form and specify the date when permitted to return to school. (Other forms prepared by a hospital are acceptable if the period of required absence is clearly stated.)
3. The student must give the original copy of the form to the Health Center. A photocopy of the form must be submitted to the instructors of each course in which the student is enrolled.

It is the student's responsibility to inform the instructor about the situation when he or she returns to school. The Center for Academic Affairs does not relay messages to the instructors.

OFFICE DIRECTORY

OFFICE HOURS: Mon- Fri 9:30~11:30 AM, 12:30~5:00 PM

- ※ Services are available only during the above office hours for providing information, accepting applications and required documents.
- ※ Offices are closed on Saturdays, Sundays and national holidays.
- ※ Office hours during summer and winter vacations and in special circumstances are announced on Loyola Bulletin Board for Center for Academic Affairs (Academic Services)

	Office	Tel	Bldg	Floor
Course Registration / Class Information / Transfer Credits / Examination / Grades	Center for Academic Affairs	03-3238-3515	No. 2	1F
Tuition and Fees	Center for Academic Affairs	03-3238-3195	No. 2	1F
Request for Leave of Absence Request for Withdrawal from the University I.D. Card Reissuance Change of Address / Guarantor Re-admission Transfer of Faculty / Department	Center for Academic Affairs (Academic Records Section)	03-3238-3519	No. 2	1F
Student Travel Fare Discount Certificates Certificate of Enrollment / Official Transcript	Vending machine		No. 2	4F
Student Counseling, clubs and circles Extra-curricular Activities & Volunteering Insurance, Dormitory, Part-time Jobs, Assistance for Students with Disabilities, etc Childcare Room Applications	Center for Student Affairs	03-3238-3525	No. 2	1F
Financial Support (Scholarship)		03-3238-3523		
Lost & Found	Office of Property	03-3238-3112	No. 2	1F
Exchange Program (Incoming / Outgoing) Short-term Language Programs Short-term Study Abroad Programs Social Engagement Programs Monbukagakusho Scholarship	Center for Global Discovery	03-3238-3521	No. 2	1F
Employment / Internship	Career Center	03-3238-3581	No. 2	1F
Admissions	Admissions Office (Undergraduate) (Graduate)	03-3238-4018 03-3238-3517	No. 2	1F
Appointment with Dean / Chair / Director	FLA / GPGS Office	03-3238-4004	No. 10	4F
	GPST Office	03-3238-3300	No. 4	5F
	IGCGES Office	03-3238-3550	No. 2	15F
Health Service	Health Center	03-3238-3394	Hoffman Hall	2F
Resources	Library	03-3238-3510	Central Library	1F
Information & Communication Technology Computer Room, Wired and Wireless LAN, Email	Media Center http://ccweb.cc.sophia.ac.jp	03-3238-3101	No. 2	3F
Counseling	Counseling Center	03-3238-3559	No. 10	3F
Teacher and Curator Certification	Center for Teaching and Curator Credentials	03-3238-3520	No. 2	1F
Campus Ministry	Catholic Center	03-3238-4161	No.2	1F

Personal Information

For the policy on protection of personal information of Sophia School Corporation, visit the following site:
http://www.sophia.ac.jp/eng/info/privacypolicy/joho_manage

REGULATIONS AND PROCEDURES

1. COURSE REGISTRATION PROCEDURES

A. Registration Schedule for Spring & Autumn Semester 2016

Events	Spring	Autumn
Course Registration	April 2 (Sat), 10:00 - April 12 (Tue), 21:00	September 21 (Wed), 10:00 - September 30 (Fri), 21:00
Results of Course Registration Available	April 13 (Wed)	October 1 (Sat)
Course Adjustment	April 14 (Thu), 10:00 - April 16 (Sat), 21:00	October 3 (Mon), 10:00 - October 5 (Wed), 21:00
Final Confirmation of Course Registration Available	April 19 (Tue), 13:00	October 7 (Fri), 13:00
Withdrawal from Courses offered in the first half of the Semester	May 9 (Mon), 10:00 - May 12 (Thu), 21:00	October 24 (Mon), 10:00 - October 27 (Thu), 21:00
Withdrawal from Courses	June 6 (Mon), 10:00 - June 10 (Fri), 21:00	December 5 (Mon), 10:00 - December 9 (Fri), 21:00

B. Course Registration

Course registration is the procedure for the student to register for all courses he/she will take in a semester. Registration for Research Guidance, Thesis Seminar, Master's Thesis and Graduation Project must also be done via Loyola during this period.

Graduate students may register for undergraduate courses (including Japanese language courses) during the course registration period. While students are allowed to take undergraduate courses a permission from their advisors, and by submitting an application form to the Center for Academic Affairs, credits from undergraduate courses are not counted as credits required for MA graduation. However, grades for undergraduate courses will be calculated into the student's GPA along with the grades from graduate courses. Courses offered in undergraduate programs with admittance through lottery are not open to graduate students.

C. Numbering

The Numbering system has been introduced for all Graduate Programs from Academic Year 2016.

Numbering is a system that classifies courses by giving appropriate numbers to show the level and order of learning and clearly indicates the curriculum system.

Numbering shows the fields of the course subject, the levels of learning, and the order in which courses should be taken. The Numbering system will be a useful guide to help students in planning course enrollment.

- 1) Courses to which Numbering applies: All graduate courses
- 2) Basic policy of Numbering

↓ Shows the field of course subject (given three alphabet letters)

AAA 5 1 1

↑ The hundreds place shows the level of learning of the course

【The levels classified by the hundreds place】

500-599 : Introductory courses for first year Master's

600-699 : Advanced Courses for second year Master's

700-799 : Specialized Courses for Master's degree

800-899 : Directed Study Courses, Thesis Seminar and Master's Thesis

900-999 : Thesis Guidance and Courses for Doctoral degree / Dissertation

- 3) The numbering is shown in the column next to the course code on the List of Courses and Instructors.

Field (Alphabet)	Field
AGS	Global Studies
IBD	International Business and Development Studies
JST	Japanese Studies
SCT	Science and Technology
GRS	Green Science and Engineering Division
GES	Global Environmental Studies

D. Credit Approval for Courses offered by other Graduate Schools

As stated in Article 17 of the Sophia University Graduate School Regulations, students may take courses offered by other Graduate Schools with permission from their thesis advisor and the Program Chair, and may apply to have the credits earned for those courses recognized as credits required for completion of their Graduate Program (credit transfer to completion requirements).

To have credits transferred to completion requirements, you will need to register via Loyola and also submit a form at the Center for Academic Affairs. If you wish to transfer credits, obtain the necessary application papers from the Center for Academic Affairs (Academic Services), and submit the completed application for the courses you wish to take to the Center during the office hours of the course registration period and/or course adjustment period (9:00~11:30, 12:30~17:00).

(For reference: Article 17, Graduate School Regulations)

The graduate schools may allow students to take courses offered by other graduate schools or undergraduate faculties, if the thesis advisors deem it beneficial for educational and research purposes.

2. The credits earned for courses as provided in the preceding clause, excluding those earned for undergraduate courses, may be recognized up to a maximum of eight credits.

Results of course registration are available online. Students must confirm the results via Loyola and make adjustment, if necessary, within the course adjustment period.

*For GPGS students, please see page 32 for more details.

E. Course Adjustment

Students can change or add/cancel courses any number of times during this period via Loyola. As this is the final chance to register for courses, students are advised to check carefully.

F. Withdrawal from Courses

If a student decides after the course registration period not to finish a course for which he/she has registered, the student should apply to withdraw from the course through Loyola during the course withdrawal period (in the case of withdrawing from Thesis Seminar, Master's Thesis, or Graduation Project, a request for withdrawal must be submitted to the Center for Academic Affairs). The student will receive a grade of "W" for the course which will not be calculated into the student's GPA. If a student discontinues attending a course and does not complete withdrawal online during the withdrawal period, he/she will receive an "F" for the course, a grade that will be calculated into the student's GPA. No withdrawals are allowed for Research Guidance.

G. Submission of Withdrawal of Graduation Project and Master's Thesis

A student who has registered for Graduation Project or Master's Thesis in the semester that he/she intends to graduate may, for various reasons, decide later in the semester that he/she would like to submit the project or thesis in a subsequent semester. In such cases the student must submit, in lieu of the project or thesis, a letter to the Center for Academic Affairs indicating her/his intention not to submit a project or a thesis. The deadline for submitting the letter is the same as the submission deadline for the Graduation Project or Master's Thesis. The grade of "W" will appear on the student's transcript for coursework in that semester. However, this grade will not be calculated into the student's GPA and will not appear on the official transcript that the student receives after graduation.

2. GRADING

Grading and evaluation criteria are as follows:

		grade	points	QPI	criteria
evaluated	pass	A	100~90	4.0	EXCELLENT
		B	89~80	3.0	GOOD
		C	79~70	2.0	SATISFACTORY
		D	69~60	1.0	PASSING
		P	——	—	PASSING
	fail	F	59 or below	0	FAILURE (did not show results satisfying passing level in a course with passing grades of "A", "B", "C", "D")
		X	——	—	NOT PASSING (did not show results satisfying passing level in a course with passing grade of "P")
not evaluated	Withdrawal	W	——	—	Withdrew from course during designated course withdrawal period
	Transfer credits approved	N	——	—	TRANSFERRED FROM OTHER UNIVERSITIES (Approved as credits equivalent to those earned at Sophia up to 10 credits)

The following "Grading Guideline" has been implemented by the university from the academic year 2015. The grades should be determined according to this guideline.

【The Grading Guideline】

An "A" should be given to approximately 20% and no more than 30% of the registered students. This policy, however, does not apply to seminars, guidance courses, and lecture courses with less than 30 registered students.

Although each course should be graded according to the evaluation criteria indicated in the course syllabus, professors should apply a grading curve to limit the number of A's to no more than 30% of the students in the course. As a result, when

more than 30% of the students receive a raw score of 90 points (out of 100), those students outside the top 30% would receive a lower grade for the course.

3. GRADE POINT AVERAGE (GPA)

Each grade is assigned a weight called the quality point index (QPI: e.g., A=4.0, etc.) The QPI multiplied by the number of credits for the course determines the quality points (QP) for that course. The sum of all the quality points divided by the total number of credits attempted (including the credits of a course for which an “F” is assigned) gives the grade point average (GPA).

4. GRADE REVIEW

Students must confirm their grades via Loyola web-service at the end of each semester. If any student believes there may have been a mistake with a grade, a request for review of the grade can be submitted to the Center for Academic Affairs. Note that the purpose of this procedure is to confirm the accuracy of the grade recorded, not to petition for changing a grade. Final authority regarding grades rests with the instructor. No requests for grade review can be accepted after the deadline for submitting such requests.

2016 Spring Courses: September 12 (Mon)-September 20 (Tue), 2016

For graduating Students: August 26(Fri)-August 29(Mon),2016

2016 Autumn: March 16 (Thu)-March 31 (Fri), 2017

For graduating students: February 24(Fri)- February 28(Tue), 2017

5. ACADEMIC RESEARCH ETHICS

In order to promote the sound development of academic research and harmonious coexistence with society, Sophia University has set academic research ethics guidelines such as the Sophia University Guidelines for ‘Academic Research Ethics’ and ‘Sophia University Guidelines for ‘Research on Human Subjects,’ and requires all its researchers to follow the highest standards of academic and research honesty.

Besides faculty members and research associates of the University, the Guidelines, shall apply to anyone engaged in research activities at the University including students in the graduate schools.

All graduate students, like other researchers at Sophia have academic freedom which entails respect for the autonomy of researchers in their research activities as well as their

right to investigate the truth, but they are also expected to have highest ethics when they engage in research activities.

Researchers shall not commit or be complicit in the committing of forgery, falsification or plagiarism in any aspect of research activities. In addition, they should increase awareness of research ethics, and make every effort to have a basic understanding of what will be considered plagiarism or falsification, and to prevent misconduct in their research activities. The students shall be thorough in the recording, storage and proper handling of data obtained in their research, and they shall also strive to create a research environment that is conducive to the forestalling of misconduct.

The “Guidelines” are available on the Sophia University website. Please read and fully understand what is expected of each student in pursuit of your academic research activities at Sophia.

Sophia University website HOME> Research > Sophia Research Organization > Academic Research Ethics

http://www.sophia.ac.jp/eng/research/research/ethics_R

6. SUBMISSION OF MASTER’S THESIS / GRADUATION PROJECT / DOCTORAL DISSERTATION

A. Master’s Thesis

Registration for Master’s Thesis: Registration must be done through Loyola web-service during the registration period of the intended semester of graduation.

Note: Please pick up a “Master’s Thesis Submission Form” at the Center for Academic Affairs and submit the form with a Bookbinding Fee (修士論文製本) stamp which is available at the Center for Academic Affairs before submitting the thesis.

B. Graduation Project

Registration for Graduation Project: Registration must be done through Loyola during the registration period of the intended semester of graduation.

C. Doctoral Dissertation

Please inquire at the Center for Academic Affairs.

For more details, please refer to the curriculum pages of each program.

7. TRANSFER OF CREDIT FROM OTHER UNIVERSITIES

Up to 10 credits can be transferred from a student’s previous work as a graduate student.

Transfer of such credit must be approved by the program. Students are requested to apply for transfer of credits as soon as they enter Sophia. Otherwise there may be difficulty graduating on time.

8. RESIDENCE

According to MEXT regulations, the standard residence requirement is two full academic years for a Master’s degree and three full academic years for a Ph.D. degree. The maximum time allowed to complete all the requirements is four full academic years for a Master’s degrees and five full academic years for a Ph.D. degree, excluding time spent on leave of absence from the university.

9. LEAVE OF ABSENCE

All graduate students are expected to take courses and attend classes every semester. Degree students who are unable to study during a particular term should apply for a Leave of Absence. The total time period spent on Leaves of Absence may not exceed 5 years for students in graduate programs. The period spent on Leaves of Absence does not count towards the residence requirement for graduation. Leave of Absence application forms and other information are available at the Academic Records Section, Center for Academic Affairs (1F of Bldg. No. 2).

Deadline for submitting the Request for Leave of Absence

	Period of Leave of Absence	Deadline to submit request
Spring Semester	April 1 – September 20, 2016	May 31 (Tue), 2016
Autumn Semester	September 21, 2016 – March 31, 2017	November 30 (Wed), 2016

An application form must be submitted to the Academic Records Section, Center for Academic Affairs, during its office hours by the deadline for each semester in which student is applying for leave. In the case of submission by mail, applications must be postmarked on or before the deadline date.

For fees during Leaves of Absence, please refer to p.21, “Fees to be Paid by Degree Students During Leave of Absence.”

10. WITHDRAWAL FROM THE UNIVERSITY

If a student wishes to withdraw from the university, he/she should submit a “Request for Withdrawal from the University Form” to the Academic Records Section, Center for

Academic Affairs, together with his/her student ID card after consulting with the advisor or the Program director. The withdrawing student must also pay all tuition and fees due up to that point in full.

11. WITHDRAWAL FROM THE PH.D. PROGRAM AFTER COMPLETING ALL THE REQUIREMENTS EXCEPT FOR DISSERTATION

<Students who enrolled in a Sophia University Ph.D. program by September 2013>

If a student wishes to withdraw from the Ph.D. program after completing all the requirements except for the doctoral dissertation, both a “Request for Withdrawal from the University” (退学願) and a “Request for Permission of Submitting the Dissertation” (課程博士学位論文提出申請書) should be submitted to the Center of Academic Affairs, Academic Records Section. If the request is accepted, the student retains the right to submit the doctoral dissertation within three years after the withdrawal. For details, consult with the Academic Records Section.

<Students who enrolled in a Sophia University Ph.D. program in or after April 2014>

If a student wishes to withdraw from the Ph.D. program after completing all the requirements except for the doctoral dissertation, a “Request for Withdrawal from the University” (退学願) should be submitted to the Center of Academic Affairs, Academic Records Section.

*** Re-admission for doctoral dissertation (論文再入学)**

Re-admission of a student who had withdrawn by completion, in order to undertake a doctoral dissertation review, is a special case of re-admission. In this case, the student can only withdraw when one or more semester is remaining. For details, consult with the Academic Records Section.

12. EARLY GRADUATION

Students who wish to graduate early (i.e. in two or three semesters for the MA program) can apply for early graduation if they are in good academic standing by the judgment of the program.

For more details, please refer to the curriculum pages of each program.

TUITION AND FEES, FINANCIAL ASSISTANCE

1. TUITION AND OTHER FEES (FOR ACADEMIC YEAR 2016)

A. Tuition and Fees

Graduate Program in Global Studies

<Degree Students >

Currency : Japanese Yen

	Master's Program			Doctoral Program				Note
	Entrance Year			Entrance Year				
	2016	2015	Before 2014	2016	2015	2014	Before 2013	
Entrance Fee	200,000	—	—	200,000	—	—	—	
Semester Enrollment Fee (per Semester)	30,000	30,000	30,000	30,000	30,000	30,000	30,000	
Tuition Fee (per semester)	240,000	240,000	240,000	225,500	225,500	225,500	225,500	(1)
Education Enhancement Fee (per semester)	90,000	90,000	90,000	45,000	45,000	45,000	45,000	
Subtotal	560,000	360,000	360,000	500,500	300,500	300,500	300,500	
Alumni Association Fee (once at matriculation)	20,000	—	—	20,000	—	—	—	
Premium for Personal Accident Insurance for Students Pursuing Education and Research	1,400	—	800	2,100	—	—	800	(2)
Subtotal	21,400	—	800	22,100	—	—	800	
Total	581,400	360,000	360,800	522,600	300,500	300,500	301,300	

【Note】

(1) The tuition fee is revised annually based on the rate of inflation.

(2) Coverage:

Master's program: 2 year period. Doctoral program: 3 year period.

If a student studies beyond the standard residence requirement, ¥800 per year will be charged.

<Non-Degree Students>

Currency : Japanese Yen

	Entrance Year	
	2016	2015
Tuition Fee (per semester)	270,000	270,000
Education Enhancement Fee (per semester)	90,000	90,000

Graduate Program in Science and Technology

(Green Science and Engineering Division)

Currency : Japanese Yen

Program Entrance Year Item	Master's			Doctoral			Note
	2016	2015	2014	2016	2015	2014	
Entrance Fee	200,000		—	200,000		—	
Semester Enrollment Fee (per semester)	30,000	30,000	30,000	30,000	30,000	30,000	
Tuition Fee (per semester)	473,000	473,000	473,000	250,500	250,500	250,500	(1)
Education Enhancement Fee (per semester)	130,000	130,000	130,000	65,000	65,000	65,000	
Laboratory & Research Fee (per semester)	65,250	65,250	65,250	65,250	65,250	65,250	(2)
Subtotal	898,250	698,250	698,250	610,750	410,750	410,750	
Alumni Association Fee	20,000	—	—	20,000	—	—	
Premium for Personal Accident Insurance for Students Pursuing Education and Research	1,400	—	800	2,100	—	—	(3)
Subtotal	21,400	—	—	22,100	—	—	
Total	919,650	698,250	699,050	632,850	410,750	410,750	

【Note】

- (1) The tuition fee is revised annually based on the rate of inflation.
- (2) The laboratory and research fee is revised annually based on the rate of inflation.
- (3) Coverage :
 Master's program: 2 year period Doctoral program: 3 year period
 If a student studies beyond the standard residence requirement, ¥800 per year will be charged.

International Graduate Course in Global Environmental Studies

<Degree Students >

Currency : Japanese Yen

	Master's Program			Doctoral Program				Note
	Entrance Year			Entrance Year				
	2016	2015	Before 2014	2016	2015	2014	Before 2013	
Entrance Fee	200,000	—	—	200,000	—	—		
Semester Enrollment Fee (per semester)	30,000	30,000	30,000	30,000	30,000	30,000	30,000	
Tuition Fee (per semester)	295,500	295,500	295,500	258,500	258,500	258,500	258,500	(1)
Education Enhancement Fee (per semester)	90,000	90,000	90,000	45,000	45,000	45,000	45,000	
Subtotal	615,500	415,500	415,500	533,500	333,500	333,500	333,500	
Alumni Association Fee (once at matriculation)	20,000	—	—	20,000	—	—	—	
Premium for Personal Accident Insurance for Students Pursuing Education and Research	1,400	—	800	2,100	—	—	800	(2)
Subtotal	21,400	—	800	22,100	—	—	800	
Total	636,900	415,500	416,300	555,600	333,500	333,500	334,300	

【Note】

(1) The tuition fee is revised annually based on the rate of inflation.

(2) Coverage:

Master's program: 2 year period. Doctoral program: 3 year period.

If a student studies beyond the standard residence requirement, ¥800 per year will be charged.

B. Issuance of bills and payment deadlines

Spring Semester 2016

	Master's Program		Doctoral Program	
Entrance Year	2015/ in Autumn 2014	In Spring 2014 before 2013	2015-2014/ in Autumn 2013	In Spring 2013/ before 2012
Bill Sent	April 11 (Mon)	May 6 (Fri)	April 11 (Mon)	May 6 (Fri)
Payment Deadline	April 22 (Fri)	May 20 (Fri)	April 22 (Fri)	May 20 (Fri)

Autumn Semester 2016

	Master's Program		Doctoral Program	
Entrance Year	2016*-2015	before 2014	2016*-2014	before 2013
Bill Sent	September 28 (Wed)	October 18 (Tue)	September 28 (Wed)	October 18 (Tue)
Payment Deadline	October 11 (Tue)	October 28 (Fri)	October 11 (Tue)	October 28 (Fri)

*Except New Students

C. Reduction due to Graduation postponement <commonly known as “thesis reduction”>

If a student meets all the following conditions, her/his tuition and fees will be automatically reduced.

- a) The student has been studying beyond the standard residence requirement.
(Three years or more in the Master's Program, four years or more in the Doctoral Program)
- b) The student has already satisfied the prescribed conditions stipulated in the graduate program except master's thesis, Graduation Project or Doctoral Dissertation.
- c) The student is not taking any subjects that confer credits (including “Thesis Guidance” or “Thesis Seminar” in the Master's Program).

For details, please consult the Center for Academic Affairs.

D. Fees to be Paid by Degree Students During Leave of Absence

Students will be exempt from the following fees during a Leave of Absence;

Tuition Fee, Education Enhancement Fee, Laboratory and Research Fee

For details, please consult with the Center for Academic Affairs (Tuition and Fees).

2. FINANCIAL ASSISTANCE

A. University Scholarship Programs

Three types of scholarships are awarded to degree students on the basis of financial needs and academic records.

i. Sophia University Tuition Support Scholarships

This scholarship is for students with good grades who are experiencing proven financial difficulties that make it difficult for them to continue their studies. For details, please check the Loyola web-service online bulletin board carefully.

<AMOUNT>

Full tuition, half tuition or one-third tuition

- 1) When a graduate student has exceeded the minimum stipulated duration for his/her course and is paying reduced tuition fees for doing thesis work only.
- 2) When a student is receiving other tuition reduction scholarships.

ii. Sophia University Benefactors' Scholarships

These scholarships are awarded by benefactors within Japan and overseas, to full-time degree or postgraduate students who meet each benefactor's criteria, decided by the President after deliberating with the Committee of Student Affairs. The scholarship will last for one year, but students may be selected again. As a rule, recipients of one Sophia University Benefactor's Scholarships are not selected for others. For details, please check the Loyola web-service online bulletin board carefully.

B. Other Scholarships:

i. JASSO Scholarship Loan Programs (Nihon Gakusei-Shien-Kiko Scholarship)

This is a loan scholarship program for students of Japanese nationality administered by Japan Student Services Organization (JASSO). The recipient has responsibility of repaying the loan after graduation.

ii. Scholarships offered by local governments and private organizations

Many different scholarships are offered throughout the academic year for both Japanese and international students. Information will be announced on the online bulletin board of the Center for Student Affairs on Loyola web-service.

For scholarship information, please inquire at:

Center for Student Affairs

Tel: 03-3238-3523

Graduate Program in Global Studies



Education and Research Objectives and Human Resource Development Objectives

The Graduate School of Global Studies comprises an International Relations Program involving multifaceted research on multiple aspects of international relations and various problems relating thereto, an Area Studies Program focusing on understanding regions including Asia, the Middle East, and Latin America on their own terms, and a Global Studies Program that uses multi-faceted approaches to tackle global issues. It produces research specialists and high-level professionals capable of applying and interrelating the methodologies acquired in each of the above Programs to achieve an integrated understanding of our globalizing world today.

Curriculum Policy

[Master's Program]

Each of the three majors—Global Studies, International Business and Development Studies, and Japanese Studies—offers a systematic and flexible curriculum for broad and deep learning. All teaching and guidance is conducted in English while the completed master's thesis/graduate project is submitted upon consultation and guidance by the faculty advisor.

[Doctoral Program]

The doctoral degree is limited to Global Studies and Japanese Studies degrees for students seeking to write a dissertation in English. Step-by-step support and guidance is provided, from the qualifying exams, to the dissertation proposal, and the research and writing of the dissertation, as is advice regarding academic presentations and publications.

Diploma Policy

[Master's Program]

The master's degree (Comparative Japanese Studies, International Management Development Studies or global social research) is awarded upon successful obtainment of the required number of credits and passing the evaluation of the master's thesis/graduation project. A degree conferee will have the expertise and critical abilities to be active in networks requiring knowledge of globalization and English ability.

[Doctoral Program]

The doctoral degree (Global Studies or Comparative Japanese Studies) is awarded upon successful evaluation of a doctoral dissertation that has passed rigorous peer-review, including external review. Degree conferees have the resources to make creative contributions in international research networks.

Note: The English translation is provided for information. The original Japanese version remains the sole official version. If there is any discrepancy between the two versions, the Japanese original should take precedence.

Master's Thesis / Doctoral Dissertation Evaluation Criteria

【Master's Thesis】

The master's thesis (Global Studies, International Business and Development Studies, Japanese Studies) is proof of possessing the specialized knowledge, comprehension and research skills, and problem-solving skills necessary for the performance of professional research in the area of the relevant degree.

Evaluation Criteria will be announced later.

【Doctoral Dissertation】

The dissertation in Global Studies or Japanese Studies must demonstrate an original contribution to knowledge and high academic value, which is publishable in appropriate academic journals and other forums.

GRADUATE PROGRAM IN GLOBAL STUDIES

OVERVIEW

The Graduate Program in Global Studies (GPGS) is part of Sophia University, a leading private university in Japan. The GPGS, founded in April 2006 (formerly the Graduate Program in Comparative Culture from 1979 to 2005), builds on Sophia's traditional strengths in area studies to study globalization. It emphasizes inquiry into the contemporary world and its historical antecedents through a curriculum that combines the themes of interdisciplinary global studies, theories and methodologies of academic disciplines, and the language training and cross-cultural understandings of Japanese and area studies.

The approximately 30 faculty members in the GPGS have advanced degrees from leading universities around the world and are actively engaged in research and publication in their specializations. They represent many different disciplines, nationalities and cultural backgrounds, ensuring a diverse range of perspectives. A number of professors from other graduate programs in the university are also affiliated with the GPGS.

Every semester, up to 15 applicants are admitted to pursue the M.A. degree, as well as up to three Ph.D. candidates. The size of the program is kept small to encourage close student-faculty interaction. Graduate students have access to the university's research facilities, while the location in central Tokyo provides easy access to such nearby resources as the National Diet Library.

1. DEGREES

The GPGS offers five degrees that are accredited by MEXT.

The M.A. in Global Studies emphasizes the study of global issues from social science perspectives, focusing on global-local, systemic, and transnational processes. The degree prepares students for research and teaching positions in academia and think tanks, international organizations, as well as entry into doctoral programs.

The M.A. in International Business and Development Studies emphasizes the acquisition of analytical skills to deal with a range of contemporary global business and development problems that focus on Japan and Asia. It prepares students for careers in business firms and development organizations with an international orientation.

The M.A. in Japanese Studies enables an interdisciplinary approach to the study of both historical and contemporary aspects of Japanese history, literature, religion, art

history, society, and culture. It prepares students for further study and research in doctoral programs or in positions that place a premium on knowledge about Japan. Qualified students may pursue a dual M.A. in Japanese Studies offered by Sophia University and SOAS (School of Oriental and Asian Studies, University of London).

The Ph.D. in Global Studies is designed for the advanced study of specific regions and locales in the context of global processes. It prepares students for academic posts in university, international, and global studies programs, as well as research positions in institutions requiring advanced analysis of countries and regions in a global context.

The Ph.D. in Japanese studies is designed for the advanced study of Japan in a transnational, regional and global context. Research and writing agendas emphasize methods and concepts from the disciplines of art history, literature, history, religious studies, cultural anthropology, media studies and cultural studies. The degree prepares students for academic positions in Japanese Studies programs, for research positions in foundations, NGOs, and companies that need advanced analyses of countries and regions in global contexts.

2. CURRICULUM

The small scale of the GPGS and the diverse disciplinary specializations, broad experience, and research interests of the faculty enable flexible course selection. In consultation with faculty members, students select courses designed to meet their individual interests and to further the acquisition of specialized knowledge in their chosen fields.

The master's degree has two tracks; each track has different graduation requirements. Students in the thesis track write a research thesis while those in the credit track complete a graduation project. The selection of the track takes place after a student matriculates in the program. Those who seek to enter the thesis track need to apply for it, typically at the start of the second semester, with entry contingent upon academic performance, availability of a mentor for the proposed topic, and successful defense of a thesis proposal.

Doctoral students work on their dissertation under the guidance of an advisor. While no course work is required, candidates participate in workshops and other program activities and may, in consultation with their dissertation advisor, attend courses.

English is the language of instruction. However, the study of Japanese is encouraged. Students may take advantage of the comprehensive Japanese language courses offered at Sophia. Those with a sufficient level of Japanese language proficiency as determined by a language examination may also take courses taught in Japanese as part of their studies. Additionally, students may study other languages at Sophia that are relevant to their studies, depending on availability of space in the courses.

3. GPGS Japanese Language Courses

Beginning in spring 2016, two new Japanese language courses will be established in the GPGS curriculum. All GPGS students, and especially JS students, who have met the required levels of competency are highly encouraged to attend.

****Japanese Language Course A (starts Spring 2016, offered every semester) 2 credits**
For students who have acquired N2 in the Japanese Language Proficiency Test (JLPT). Students may also take the Japanese Placement Test (JPT) at Sophia if they have not taken the JLPT. This course focuses on academic skills and includes some training in interview skills.

N2 相当の下のレベルでインタビュースキルなども含めたアカデミックスキル全般の授業

****Japanese Language Course B (starts Autumn 2016, offered every semester) 2 credits**
In principle, for students who have completed Course A. Students who have not completed Course A are required to have achieved N1 in the JLPT, or have passed the JPT for Course B. This is a reading course that specializes in subject matters relevant to selected disciplines in the GPGS. Discussions are included in the course.

GPGS の内容に特化したあくまで日本語の読解の授業+ディスカッション

4. RESOURCES

Many members of the GPGS faculty are also members of the Institute of Comparative Culture. The Institute sponsors a lecture series in English that invites leading scholars in Global Studies, Japan Studies, International Business and Economics and related fields. Students in the GPGS are strongly encouraged to attend lectures, and are often given a chance to meet with and discuss research with visiting scholars at the Institute. The Institute also sponsors research projects related to the interests of GPGS students, offering the opportunity for some students to participate as research assistants or as presenters at academic workshops sponsored by the Institute.

The GPGS has its own study rooms and computer facilities and provides students with on-campus lockers for storing materials. In addition, graduate students can use the university computing facilities, cafeterias, gymnasium, athletic fields, and medical and counseling facilities. As with urban universities generally in Japan, Sophia has several off campus dormitories and affiliated dormitories in and around the Tokyo area.

M.A. CURRICULUM

M.A. Degree Requirements and Schedules

1. M.A. Thesis Track

Students who wish to write a thesis apply for the thesis track, typically at the beginning of their second semester after enrollment in the GPGS. Acceptance into this track is a two-step process consisting, first, of the evaluation of a student's potential for writing a thesis after the submission of the "Thesis Intention" form and, second, evaluation of a student's thesis proposal at the official proposal defense. Satisfying the graduation requirements of this track typically requires four semesters. Entry into the thesis track can be initiated after the second semester, but this will likely prolong a student's time in the GPGS. Thesis-track graduation requirements are: 1) accumulation of 30 course credits; 2) continuous registration in "Research Guidance" (0 credit) under the name of the student's advisor from the first semester until the graduating semester; 3) submission of a Master's thesis. In the semester of intended graduation, students should register for "Thesis Seminar" (4 credits) and "Master's Thesis" (0 credit)

Overview

The thesis track enables a student to pursue independent research under the supervision of a faculty member. The final result should be a paper that makes an original contribution to knowledge in a designated academic discipline.

The Thesis

The thesis is an argument supported by primary data, and/or secondary data to which an original methodology/interpretation is applied that is positioned in and makes a contribution to a debate in a scholarly discipline. A thesis paper is typically 40-60 pages in length.

Seeking an Advisor

In the semester of intended application to the thesis track, students need to obtain the signature of their advisor who is willing to guide the students in developing a thesis proposal and then supervise the research and writing of the thesis. Should students find a professor other than their current advisor better suited for supervision, students can ask their preferred professor to become the new advisor and, upon the professor's agreement, inform the GPGS office of the change.

Forming a Thesis Committee

Once students have successfully defended their thesis proposal, a committee consisting of the advisor and two readers will be formed. The designation of the two readers is at the discretion of the advisor, in consultation with students.

Typical Thesis Track Schedule (4 semesters)

Semester 1	attend “Thesis Track Guidance”
Semester 2	<p>a) submit “Thesis Intention” form</p> <p>Evaluation criteria are:</p> <ul style="list-style-type: none"> - overall quality - availability of a mentor - academic performance (minimum 3.5 GPA based on at least 8 credits of coursework) <p>b) notification of evaluation result</p> <p>c) develop thesis proposal</p> <p>d) defend thesis proposal at the end of the semester</p>
Semester 3	research thesis
Semester 4	<p>a) submit thesis outline to advisor by first day of classes</p> <p>b) register for “Thesis Seminar” (4 credits) and “Master’s Thesis” (0 credit)</p> <p>c) submit thesis draft to GPGS office by deadline</p> <p>d) revise thesis</p> <p>e) submit final draft to GPGS office by deadline</p> <p>f) defend thesis</p>

Note: Detailed information on the M.A. degree and the two tracks is available on the GPGS website.

2. M.A. Credit Track

Credit-track graduation requirements are: 1) accumulation of 30 course credits; 2) continuous registration for “Research Guidance” (0 credit) under the name of the student’s advisor from the first semester until the graduating semester; 3) submission of a graduation project. In the semester of intended graduation, a student registers for “Graduation Project” (0 credit). Students on the credit track who expect to graduate in less than four semesters must apply for “Early Graduation” in the semester of intended graduation (please see p.33).

Overview

The credit track emphasizes coursework, with a graduation project. The project allows students to further their knowledge of a topic or issue they encountered in a course. The project is a research paper, unless the student requests another format and the advisor’s agree. The research paper is undertaken in the student’s final semester and is supervised and evaluated by a professor of the student’s choosing in the student’s degree area.

The Graduation Project

The graduation project typically expands on a topic that the student encountered in a course through further research and writing. Students can use secondary sources, primary sources or a combination thereof. The final paper is 30-40 pages in length, including notes and references.

Selecting an Advisor

At the end of the second-to-last semester or beginning of the last semester, students ask their advisor to supervise the graduation project. Should students find a professor other than their current advisor better suited for supervision, students can ask their preferred professor to become the new advisor and, upon the professor's agreement, inform the GPGS office of the change.

Typical Graduation Project Schedule (final semester)

Month 1: The student works with the advisor to develop the paper's focus through consultations. By the end of the month the student has a paper outline, bibliography, and schedule.

Months 2-3: The student does reading and research for the paper and writes a first draft

Month 4: The student submits the first draft to the advisor for comments and then revises the paper accordingly. S/he then submits two copies of the final draft on the day stated on the academic calendar, one to the advisor and one to the graduate program office.

Regulations and Procedures

1. COURSE ADVISORY MEETING

At the beginning of each semester, all graduate students will attend a meeting to help them chart their path through graduate study. Students will be introduced to the different theoretical and methodological specializations of each faculty member. In consultation with the faculty about their interests, background and plan of study, students will select their courses and will be assigned an advisor (the advisor can later be changed according to the topic of the student's graduation project or thesis). Each student should bring to this meeting all registration materials.

Spring Semester: April 7 (Thu.), 2016

Autumn Semester: September 27 (Tue.), 2016

2. LIMIT ON NUMBER OF CREDITS PER SEMESTER

Graduate students may register for up to 12 credits of courses per semester. This includes Japanese language courses offered by the Center for Language Education and Research. While the 12-credit limit cannot be exceeded in a student's first semester it may be exceeded in subsequent semesters with the permission of the GPGS Director. This permission and the number of credits in excess of 12 credits is decided case-by-case by the Director on the basis of a student's GPA and graduation plans.

Non-degree students / Exchange-students who have scheduling difficulties in fulfilling Visa Requirements because of the 12-credit limit should consult the GPGS Director.

3. CREDIT APPROVAL FOR NON – GSGS (GRADUATE SCHOOL OF GLOBAL STUDIES) COURSES

If students wish to take non-GSGS courses as Elective Courses, they must submit the "Credit Approval Form for Non-GSGS Courses" with the approval of their advisor and the GPGS Director. In addition to registering for non-GSGS courses via Loyola, the student must submit this form to the Center for Academic Affairs within the registration period or adjustment period to receive approval. Failure to follow this procedure will result in the courses not be counted as credit for graduation. Up to eight credits of courses offered by other (Sophia) graduate schools may be counted as Elective Courses in AG, BD or JS fields.

4. EARLY GRADUATION

Students who wish to graduate early (i.e. in two or three semesters) can apply for Early Graduation if they are in good academic standing by the judgment of the faculty and satisfy the following:

- A. Submit an “Early Graduation Request” form.
- B. Complete at least 30 credits of courses from the GPGS curriculum by the time of graduation.
- C. Complete all requirements for either the M.A. thesis track or M.A. credit track.

“Application for Early Graduation” forms are available in the GPGS office. They should be submitted to the office by the first day of classes in the semester that the student intends to graduate. The faculty will review the application.

Early graduation application deadline:

April 11 (Mon.), 2016 for September 2016 graduation
September 29 (Thu.), 2016 for March 2017 graduation

5. SUBMISSION OF THESIS TRACK INTENTION FORM

“Thesis Track Intention” forms are available in the GPGS office.

Thesis intention application deadline

Spring Semester: April 29 (Fri.), 2016
Autumn Semester: October 31 (Mon.), 2016

6. SUBMISSION OF THESIS PROPOSAL

Deadline of submission

Spring Semester: June 10 (Fri.), 2016
Autumn Semester: December 9 (Fri.), 2016

Proposal Defense

Spring Semester: June 29 (Wed.), 2016
Autumn Semester: January 11 (Wed.), 2017

7. SUBMISSION OF MASTER’S THESIS / GRADUATION PROJECT

A. Master’s Thesis

Registration for Master’s Thesis: Registration must be done through Loyola during the registration period of the intended semester of graduation.

Deadline of submission (first draft):

June 8 (Wed.), 2016 for September 2016 graduation
December 7 (Wed.), 2016 for March 2017 graduation

Deadline of submission (final draft):

July 6 (Wed.), 2016 for September 2016 graduation

January 11 (Wed.), 2017 for March 2017 graduation

Place to submit: GPGS Office

Thesis Defense:

July 27 (Wed.), 2016 for September 2016 graduation

January 27 (Fri), 2017 for March 2017 graduation

Time to be announced.

Note: Please pick up a “Master’s Thesis Submission Form” at the Center for Academic Affairs and submit the form with a Bookbinding Fee (修士論文製本) stamp available at the Center for Academic Affairs before submitting the thesis to the GPGS Office.

B. Graduation Project

Registration for Graduation Project: Registration must be done through Loyola during the registration period of the intended semester of graduation.

Notification form submission deadline:

June 8 (Wed.), 2016 for September 2016 graduation

December 7 (Wed.), 2016 for March 2017 graduation

Submission deadline:

July 6 (Wed.), 2016 for September 2016 graduation

January 11 (Wed.), 2017 for March 2017 graduation

Place to submit: GPGS office.

For detailed information, please see p. 31

M.A. in Global Studies

The M.A. in Global Studies examines world systems, transnational processes, and global-local interactions from perspectives informed by the disciplines of anthropology, history, political science, religious studies, and sociology. Students are required to take 4 credits of Foundational Courses to acquire theoretical concepts and methodological approaches for the study of global phenomena. A range of thematic Elective Courses drawing on concrete cases in Japan, China, and the rest of Asia enables students to explore global issues and phenomena from an area-based perspective. Students proficient in Japanese may also choose from a range of area studies and international relations courses taught in Japanese that focus on Southeast Asia, Latin America, and the Middle East. Study of Japanese and other languages relevant to a student’s research and future career is strongly encouraged.

Students are required to take a total of 30 credits distributed as follows:

<u>Thesis-track students</u>	
Foundational Courses in AG*	4 credits
Elective Courses in AG**	22 credits
Research Guidance***	0 credit
Thesis Seminar****	4 credits
Master’s Thesis****	0 credit
<u>Credit-track students</u>	
Foundational Courses in AG*	4 credits
Elective Courses in AG**	26 credits
Research Guidance***	0 credit
Graduation Project****	0 credit

*Students are required to take AG741 and AG745 as Foundational Courses.

**Up to 8 credits of non-AG courses (BD, JS, and graduate courses offered by any other graduate school at Sophia University) can be counted as Elective Courses. However, students must request for an approval to count non-GSGS courses as Elective Courses. For procedures, refer to p. 12.

Students can include 2 credits taken at UNU with an approval from the Director.

For procedures, consult the Center for Academic Affairs.

***Students should register every semester.

****Students should register in the final semester.

Courses

Foundational Courses		Credits
AG741	Introduction to Global Studies 1	2
AG745	Introduction to Global Studies 2	2

Elective Courses

AG520	Global Health	4
AG521	Globalization and Society*	4
AG524	Human Rights*	4
AG525	Global Culture*	4
AG527	Globalization and Nation-States*	4
AG502	Comparative Politics	2
AG504	Democracy in Globalization	2
AG531	Global Politics*	4
AG532	Media and Politics	4
AG509	China-The Global History of a Rising Power**	2
AG508	Empire and Aftermath -A Global History**	2
AG535	Diplomatic History	4
AG537	Global Issues	4
AG510	Globalization and Popular Religion	2
AG512	Topics in Sociological Theory*	2
AG514	Approaches to Development*	2
AG516	Global Migration	2
D41057	Globalization and Public Policy	2
D41058	Contemporary Japanese Politics	2

Elective Courses (Primarily taught in Japanese)		Credits
JS590Z	Japanese Language Course A***	2
JS591Z	Japanese Language Course B***	2
D41029	International Politics	2
D41030	International Migration	2
D41055	Political Economy of Globalization 1	2
D41056	Political Economy of Globalization 2	2
D62119	Political Economy of Developing Countries 1 (Theory)	2
D62120	Political Economy of Developing Countries 2 (Case Study)	2
D62138	Research in Development Economics 1	2
D62139	Research in Development Economics 2	2
D63051	International Relations of Middle East	2
D63086	Problems of Globalization: Political and Economic	2
D63101	S.E. Asian Society and Culture 1	2
D63102	S.E. Asian Society and Culture 2	2

D63113	S.E. Asian Culture 1	2
D63114	S.E. Asian Culture 2	2
D63129	Social History of Middle East 1	2
D63130	Social History of Middle East 2	2
D63137	Middle Eastern Culture 1	2
D63138	Middle Eastern Culture 2	2
D63145	Latin American International Relations 1	2
D63146	Latin American International Relations 2	2
D63153	Latin American Society 1	2
D63154	Latin American Society 2	2
D63161	Latin American Economy 1	2
D63162	Latin American Economy 2	2
D83048	Economic Sociology and Sociology of Organization 1	2
D83049	Economic Sociology and Sociology of Organization 2	2
D83052	Nationalism and Globalization 1	2
D83053	Nationalism and Globalization 2	2
D83073	Seminar on Social Movement	2
D81102	Lec. International Educational Development	2
Thesis Track		Credits
AG900	Master's Thesis	0
AG790	Thesis Seminar	4
AG888	Research Guidance	0
Credit Track		
AG802	Graduation Project	0
AG888	Research Guidance	0

*Students may take these courses twice.

**Students who took AG533 Global History cannot take these courses.

***Note that there are rules for taking courses. Please refer to each syllabus on the Loyola web-service before registration.

JS590Z is a prerequisite for taking JS591Z.

Faculty

ANNO Tadashi

Associate Professor, Political Science

B.A., University of Tokyo; M.A., Ph.D., University of California, Berkeley

Theories of international relations and comparative politics, globalization and the future of the nation-state, nationalism, Soviet and Post-Soviet politics

BURRETT Tina

Associate Professor, Political Science

B.A., Leeds University; M.phil, Ph.D., Cambridge University

Governance, leadership, democratization, political accountability, the role of the media in politics

FAHY Sandra

Associate Professor, Anthropology

B.A., M.A., York University;

Ph.D., School of Oriental and African Studies, University of London

Social and cultural anthropology of East Asia region

FARRER James

Professor, Sociology

B.A., University of North Carolina, Chapel Hill; M.A., Ph.D., University of Chicago

Urban sociology, foodways and cuisine, sexuality, nightlife, skilled migration (expatriates)

HESS Christian

Associate Professor, Modern Chinese History

B.A., University of California, Davis

M.A., Ph.D., University of California, San Diego

Modern Chinese history, urban history, Japanese colonialism in Northeast China

ITO Takeshi

Associate Professor, Political Science

B.A., Keio University; M.A. Hitotsubashi University;

M.A. and M.Phil, Yale University; Ph.D., Yale University

Agrarian studies, comparative politics, development studies, global environmental politics

SUGAWARA Yuka

Assistant Professor, Sociology

B.A., Sophia University, M.A., Harvard University, Ph.D., University of Texas at Austin

Social demography, health and aging, socio-economic transition from communication in East Central Europe and the former Soviet Union

MURAKAMI Tatsuo

Assistant Professor, Religion

B.A., Beloit College; M.A., Syracuse University; Ph.D., University of California, Santa Barbara

Theories of religion (modernity, colonialism, materiality), African Pentecostalism

NAKANO Koichi

Professor, Political Science

B.A., University of Tokyo; B.A., University of Oxford; M.A., Ph.D., Princeton University

Japanese politics, comparative politics, New Right transformation, public protest and civic activism, party politics and policy change, bureaucracy and administrative reform

WANK David L.

Professor, Sociology

B.A., Oberlin College; M.A., Ph.D., Harvard University

Economic sociology, political sociology, social networks, institutional change, communities and transnational links, ethnography, China

WATANABE Takehiro

Associate Professor, Anthropology

B.A., State University of New York, Albany; M.A., Ph.D., Columbia University

Cultural and social anthropology, modernity, critical theory, history, Japan

Affiliated Faculty

AKAHORI Masayuki (Area Studies)

Professor, Middle Eastern Studies

M.A., The University of Tokyo

HATAYA Noriko (Area Studies)

Professor, Latin American Studies

Ph.D., University of London

KATO Kozo (Law)

Professor, Political Science

Ph.D., Cornell University

KISAICHI Masatoshi (Area Studies)

Professor, Middle Eastern History

M.A., Chuo University

KOMATSU Taro (Educational Studies)
Professor, International Education Development
Ph.D., University of Minnesota

KOYASU Akiko (Area Studies)
Associate Professor, Luso-Brazilian Studies
M.A., Sophia University

MARUI Masako (Area Studies)
Associate Professor, Southeast Asian Studies
Ph.D., Sophia University

MIURA Mari (Law)
Professor, Political Science
Ph.D., University of California, Berkeley

OKABE Midori (Law)
Associate Professor, International Relations
M.A., University of Tokyo

SARUYA Hiroe (Sociology)
Assistant Professor, Sociology
Ph.D., University of Michigan

TAKASHIMA Ryo (International Relations)
Associate Professor, Economics
Ph.D., West Virginia University

TANI Hiroyuki (Area Studies)
Professor, Latin American Studies
M.A., Sophia University

TATEYAMA Ryoji (International Relations in Middle East)
Emeritus Professor, National Defense Academy

TERADA Takefumi (Area Studies)
Professor, Southeast Asian Studies
Ph.D., University of the Philippines

WATANABE Shin (Sociology)
Professor, Sociology
Ph.D., University of California, Los Angeles

YOSHINO Kosaku (Sociology)
Professor, Sociology
Ph.D., University of London

M.A. in International Business and Development Studies

The M.A. in International Business and Development Studies emphasizes the acquisition of analytical skills to deal with a broad range of contemporary global business and development problems with a strong focus on Japan and Asia. It seeks to provide students with an integrated understanding of business and development together with specialized training in one of these fields. Due to globalization, business activities are increasingly worldwide in scope, requiring a deep understanding of conditions in both developed and developing countries as well as specialized management capability. International organizations, governments of developing countries, and businesses committed to sustainable development likewise need specialists capable of handling development issues from a business perspective. In pursuing this degree graduate students are advised to plan their course selection in consultation with faculty members so as to facilitate the acquisition of an integrated or specialized capability in business and/or development.

Students are required to take a total of 30 credits that are distributed as follows:

<u>Thesis-track students</u>	
Core Courses in International Business category or Development Studies category	12 credits
Elective Courses in any BD category*	14 credits
Research Guidance**	0 credit
Thesis Seminar***	4 credits
Master's Thesis***	0 credit
<u>Credit-track students</u>	
Core Courses in International Business category or Development Studies category	12 credits
Elective Courses in any BD category*	18 credits
Research Guidance**	0 credit
Graduation Project***	0 credit

*Up to 8 credits of non-BD courses (AG, JS, and graduate courses offered by any other graduate school at Sophia University) can be counted as Elective Courses. However, students must request for an approval to count non-GSGS courses as Elective Courses. For procedures, refer to p. 12.

Students can include 2 credits taken at UNU with an approval from the Director.

For procedures, consult the Center for Academic Affairs.

**Students should register every semester.

***Students should register in the final semester.

Courses

Core Courses Applicable to Both International Business and Development Studies

	Credits
BD500 Mathematical Techniques in Business and Economics	4
BD510 Business and Economic Statistic	4

International Business Core Courses

BD503 Corporate Strategy and Organizational Development	4
BD504 International Information System and Management	4
BD505 Financial Accounting	4
BD507 Asian Comparative Management	4
BD508 International Financial Management	4
BD511 International Marketing*	4
D51520 Corporate Finance	4

Development Studies Core Courses

BD520 Development Theory and Policy	4
BD521 International Economics	4
BD525 Supply Chain Management	4
BD531 Environmental Economics and Policy	4

Advanced Elective Courses

	Credits
BD707 Topics in Business and Development 1	2
BD708 Topics in Business and Development 2	2

Thesis Track

BD900 Master's Thesis	0
BD790 Thesis Seminar	4
BD888 Research Guidance	0

Credit Track

BD802 Graduation Project	0
BD888 Research Guidance	0

* Students may take this course twice.

Faculty

ASANO Akihito

Associate Professor, Economics

B.A., Yokohama National University; M.A., Hitotsubashi University;

M.Ec., Australian National University; Ph.D., Australian National University

Applied microeconomic theory, economics education

HAGHIRIAN Parissa

Professor, Business

M.A., University of Vienna; M.A., Ph.D., Vienna University of Economics and Business Administration

Japanese market entry, knowledge transfer, intercultural communication, headquarter-subsidiary relations in Japanese multinational corporations, Japanese consumer behavior

HASEBE Takuya

Assistant Professor, Economics

B.A., Rutgers University; Ph.D., City University of New York

Econometrics, labor economics, health economics, applied microeconomics

ISAKA Naoto

Associate Professor, Finance

B.A., Sophia University; M.A., Osaka University; Ph.D., Hitotsubashi University

Financial markets, Corporate finance

KHOJASTEH Yacob

Associate Professor, Business and Management

BS, Iran University of Science and Technology; M.Sc., Tarbiat Modares University;

M.A., Ph.D., Tsukuba University

Operating management, supply chain management, business and management

KONISHI Yoshifumi

Associate Professor, Economics

B.A., Chuo University

M.A., University of Pittsburgh, Ph.D., University of Minnesota

Empirical microeconomics, environmental economics, public economics

KOSAKA Michiru

Associate Professor, Economics

B.A., M.A., Hitotsubashi University; Ph.D., Duke University

Macroeconomics, international finance

MORIMOTO Mariko

Associate Professor, Marketing

B.A., The American University; M.A., Boston University;

Ph.D., Michigan State University

Marketing communication, consumer psychology and global advertising

UENISHI Junko

Associate Professor, Accounting

B.A., Harvard University; M.S., M.B.A., Northeastern University; C.P.A.

Financial accounting, international accounting, comparative accounting systems

Affiliated Faculty

KAWANISHI Satoshi (Economics)

Professor, Finance

Ph.D., University of Tokyo

M.A. in Japanese Studies

The M.A. in Japanese Studies offers an integrated and interdisciplinary approach to the study of both historical and contemporary aspects of Japanese history, literature, religion, art history, society, and culture. Courses are organized in two categories: Arts and Culture (art history / visual culture and literature), and Thought and Society (history, religion and philosophy, anthropology). For a balanced understanding and exposure to the themes, methodologies and research materials of the different disciplines, students are required to take at least four credits from each of the two categories. All students are advised to take advanced Japanese language training to facilitate use of Japanese sources in their research.

Courses in the M.A. in Japanese Studies are designated by the JS prefix. A total of 30 credits are required for graduation, to be distributed as follows:

FOR STUDENTS WHO ENROLLED IN 2016 OR AFTER

<u>Thesis-track students</u>	
Introduction to Japanese Studies (taken in the first semester upon enrollment)*	2 credits
Arts and Culture category courses	4 credits
Thought and Society category courses	4 credits
Elective Courses in any JS category**	16 credits
Research Guidance***	0 credit
Thesis Seminar****	4 credits
Master's Thesis*****	0 credit
<u>Credit-track students</u>	
Introduction to Japanese Studies (taken in the first semester upon enrollment)*	2 credits
Arts and Culture category courses	4 credits
Thought and Society category courses	4 credits
Elective Courses in any JS category**	20 credits
Research Guidance**	0 credit
Graduation Project***	0 credit

FOR STUDENTS WHO ENROLLED BEFORE 2016

<u>Thesis-track students</u>	
Arts and Culture category courses	4 credits
Thought and Society category courses	4 credits
Elective Courses in any JS category**	18 credits
Research Guidance***	0 credit
Thesis Seminar****	4 credits
Master's Thesis*****	0 credit
<u>Credit-track students</u>	
Arts and Culture category courses	4 credits
Thought and Society category courses	4 credits
Elective Courses in any JS category**	22 credits
Research Guidance***	0 credit
Graduation Project*****	0 credit

* Students enrolled in 2016 and after are required to take JS546 as Foundational Courses.

Sophomore students who wish to take these courses must obtain his/her adviser's approval. (The credits go to Elective Courses)

Students who belong to AG, BD cannot take these courses.

** Up to 8 credits of non-JS courses (AG, BD, and graduate courses offered by any other graduate school at Sophia University) can be counted as Elective Courses.

However, students must request for an approval to count non-GSGS courses as Elective Courses. For procedures, refer to p. 12.

Students can include 2 credits taken at UNU with an approval from the Director.

For procedures, consult the Center for Academic Affairs.

*** Students should register every semester.

**** Students should register in the final semester.

Courses

		Credits
Foundational Courses		
JS546	Introduction to Japanese Studies	2
Arts and Culture		
JS501	Modern Japanese Visual Culture *	4
JS504	Japanese Art History*	4
JS505	Modern Japanese Arts History*	4
JS506	Representations of Race, Gender and Body *	4
JS510	Contemporary Japanese Literature *	4
JS511	Interpretations of Modernity *	4
JS512	Comparative Literature *	4
JS514	Seminar in Pre-modern Japanese Literature *	4
JS750	Reading in Japanese Sources *	2
Thought and Society		
JS517	Religion and Japanese Society	4
JS532	Japanese History *	4
JS533	Modern Japanese History *	4
JS541	Japanese Ethnography *	4
JS542	Popular Culture	4
JS543	Urban Space Studies	4
JS544	Topics in Japanese Religion	4
JS545	Topics in Contemporary Japanese Buddhism*	4
Japanese Language		
JS590	Japanese Language Course A**	2
JS591	Japanese Language Course B**	2
Thesis Track		Credits
JS900	Master's Thesis	0
JS790	Thesis Seminar	4
JS888	Research Guidance	0
Credit Track		
JS802	Graduation Project	0
JS888	Research Guidance	0

* Students may take these courses twice.

**Note that there are rules for taking courses. Please refer to each syllabus on the Loyola web-service before registration. JS590 is a prerequisite for taking JS591.

Faculty

CHOO Kukhee

Assistant Professor, Visual Media

B.A., M.A., University of Texas; Ph.D., University of Tokyo

Globalization and cultural policies; trans-Asian media flow, gender and body in popular culture

DROTT Edward

Assistant Professor, Religion

B.A., M.A., Ph.D., University of Pennsylvania

History of Japanese religion, religion and the body

GARDNER Richard

Professor, Religion

B.A., Miami University; M.A., Ohio State University; M.A., Ph.D., University of Chicago

Theories of religion, theater and religion, religion and the arts, humor and religion

GRAMLICH-OKA Bettina

Professor, History

B.A., Tübingen University; M.A., Sophia University; Ph.D., Tübingen University

Japanese history, women's studies, medical history

HAYASHI Michio

Professor, Art History

B.A., University of Tokyo; M.A., Ph.D., Columbia University

Modern and contemporary art, mass culture, media

HIRASAWA Caroline

Associate Professor, Art History

B.A., Empire State College; MFA, Tokyo National University of Fine Arts and Music;

M.A., Ph.D., Stanford University

Japanese sacred art, including paintings of the afterlife and pilgrimage mandara

KONO Shion

Associate Professor, Literature

B.A., Bowdoin College; M.A., Ph.D., Princeton University

Comparative literature and modern Japanese literature

MURAI Noriko

Associate Professor, Art History

B.A., University of California, Berkley; M.A., Ph.D., Harvard University

Modern art history (Japan), visual culture, gender studies

ROBOÜAM Thierry Jean, S.J.

Associate Professor, Religion and Philosophy

B.A., M.A., Sophia University; S.T.D., Jesuit School of Theology at Berkeley
Systematic theology, Buddhist studies (Mahayana Mikkyo), modern philosophy
(Descartes), postmodern philosophy (Deleuze)

SAALER Sven

Associate Professor, History

M.A., Ph.D., University of Bonn

Japanese political history, history of Japanese foreign relations, politics of memory,
history of Pan-Asianism

SLATER David

Professor, Anthropology

B.A., Vassar College; M.A., Ph.D., University of Chicago

Cultural and social anthropology, education, social class, semiotics, urban studies, Japan

STRECHER Matthew

Professor, Literature

B.A., M.A., University of Texas; Ph.D., University of Washington

Modern and contemporary Japanese literature, literary journalism, genre studies,
mythology, global literature, and postmodernism

THOMPSON Mathew

Associate Professor, Literature

B.A., Yale University; M.A., Ph.D., Columbia University

Medieval and early modern Japanese literature, the legend of Minamoto no Yoshitsune

YIU Angela

Professor, Literature

B.A., Cornell University; M.A., Ph.D., Yale University

Modern Japanese literature, literature and Tokyo, Taisho utopianism, modernism,
postwar literature, and urban space

Registration Codes

<Research Guidance>

*Please make sure that all degree students register for “Research Guidance” every semester.

AG888

Spring

ANNO Tadashi	MZAG8881
FARRER James	MZAG8882
HESS Christian	MZAG8887
ITO Takeshi	MZAG8886
NAKANO Koichi	MZAG8883
WANK David	MZAG8885
FAHY Sandra	MZAG8888
BURRETT Tina	MZAG8889
WATANABE Takehiro	MZAG8884

Autumn

ANNO Tadashi	MZAG888Z
FARRER James	MZAG888Y
HESS Christian	MZAG888T
ITO Takeshi	MZAG888U
NAKANO Koichi	MZAG888X
WANK David	MZAG888V
FAHY Sandra	MZAG888A
BURRETT Tina	MZAG888B
WATANABE Takehiro	MZAG888C

BD888

Spring

ASANO Akihito	MZBD8881
HAGHIRIAN Parissa	MZBD8882
KOSAKA Michiru	MZBD8884
KHOJASTEY Yacob	MZBD8889
KONISHI Yoshifumi	MZBD8888
MORIMOTO Mariko	MZBD8887
UENISHI Junko	MZBD8886

Autumn

HAGHIRIAN Parissa	MZBD888Y
ISAKA Naoto	MZBD888X
KOSAKA Michiru	MZBD888Q
KHOJASTEY Yacob	MZBD888R
MORIMOTO Mariko	MZBD888T
UENISHI Junko	MZBD888U

Not offered in Spring

ISAKA Naoto	MZBD8883
-------------	----------

Not offered in Autumn

ASANO Akihito	MZBD888Z
KONISHI Yoshifumi	MZBD888S

JS888

Spring

GARDNER Richard	MZJS8882
HAYASHI Michio	MZJS8884
HIRASAWA Caroline	MZJS8885
KONO Shion	MZJS8886
MURAI Noriko	MZJS8883
SAALER Sven	MZJS8889
ROBOUAM Thierry	MZJS8888
SLATER David	MZJS8810
STRECHER Matthew	MZJS8881
THOMPSON Mathew	MZJS8887
YIU Angela	MZJS8811

Autumn

GARDNER Richard	MZJS888L
GRAMLICH-OKA Bettina	MZJS888K
HAYASHI Michio	MZJS888J
HIRASAWA Caroline	MZJS888I
KONO Shion	MZJS888H
MURAI Noriko	MZJS888B
ROBOUAM Thierry	MZJS888F
SAALER Sven	MZJS888E
SLATER David	MZJS888D
STRECHER Matthew	MZJS888A
THOMPSON Mathew	MZJS888G
YIU Angela	MZJS888C

Not offered in Spring

GRAMLICH-OKA Bettina	MZJS8812
----------------------	----------

<Graduation Project>

AG802

Spring

ANNO Tadashi	MZAG8026
FARRER James	MZAG8021
HESS Christian	MZAG8022
ITO Takeshi	MZAG8023
NAKANO Koichi	MZAG8027
WANK David	MZAG8024
FAHY Sandra	MZAG8028
BURRETT Tina	MZAG8029
WATANABE Takehiro	MZAG8030

Autumn

ANNO Tadashi	MZAG802S
FARRER James	MZAG802N
HESS Christian	MZAG802O
ITO Takeshi	MZAG802P
NAKANO Koichi	MZAG802T
WANK David	MZAG802Q
FAHY Sandra	MZAG802U
BURRETT Tina	MZAG802V
WATANABE Takehiro	MZAG802W

BD802

Spring

ASANO Akihito	MZBD8028
HAGHIRIAN Parissa	MZBD8021
KHOJASTEY Yacob	MZBD8026
KONISHI Yoshifumi	MZBD8029
MORIMOTO Mariko	MZBD8022
UENISHI Junko	MZBD8025
KOSAKA Michiru	MZBD8023

Autumn

HAGHIRIAN Parissa	MZBD802N
ISAKA Naoto	MZBD802Q
KHOJASTEY Yacob	MZBD802O
MORIMOTO Mariko	MZBD802V
UENISHI Junko	MZBD802R
KOSAKA Michiru	MZBD802P

Not offered in Spring

ISAKA Naoto	MZBD8024
-------------	----------

Not offered in Autumn

ASANO Akihito	MZBD802U
KONISHI Yoshifumi	MZBD802M

JS802

Spring

GARDNER Richard	MZJS8021
HAYASHI Michio	MZJS8027
HIRASAWA Caroline	MZJS8031
KONO Shion	MZJS8028
MURAI Noriko	MZJS8032
ROBOUAM Thierry	MZJS8024
SAALER Sven	MZJS8023
SLATER David	MZJS8025
STRECHER Matthew	MZJS8030
THOMPSON Mathew	MZJS8022
YIU Angela	MZJS8026

Autumn

GARDNER Richard	MZJS802A
GRAMLICH-OKA Bettina	MZJS802M
HAYASHI Michio	MZJS802K
HIRASAWA Caroline	MZJS802C
KONO Shion	MZJS802L
MURAI Noriko	MZJS802E
ROBOUAM Thierry	MZJS802G
SAALER Sven	MZJS802F
SLATER David	MZJS802H
STRECHER Matthew	MZJS802B
THOMPSON Mathew	MZJS802J
YIU Angela	MZJS802I

Not offered in Spring

GRAMLICH-OKA Bettina	MZJS8029
----------------------	----------

<Thesis Seminar>

The first thesis seminar will be held on Wed. 17:00-20:15 at each professor's office.

AG790

Spring

ANNO Tadashi	MZAG7904
FARRER James	MZAG7901
HESS Christian	MZAG7902
ITO Takeshi	MZAG7903
NAKANO Koichi	MZAG7905
WANK David	MZAG7906
FAHY Sandra	MZAG7907
BURRETT Tina	MZAG7908
WATANABE Takehiro	MZAG7909

BD790

Spring

ASANO Akihito	MZBD7906
HAGHIRIAN Parissa	MZBD7901
KHOJASTEH Yacob	MZBD7905
KONISHI Yoshifumi	MZBD7907
MORIMOTO Mariko	MZBD7902
UENISHI Junko	MZBD7904
KOSAKA Michiru	MZBD7908
Not offered in Spring	
ISAKA Naoto	MZBD7903

JS790

Spring

GARDNER Richard	MZJS7901
HAYASHI Michio	MZJS7907
HIRASAWA Caroline	MZJS7911
KONO Shion	MZJS7908
MURAI Noriko	MZJS7912
ROBOUAM Thierry	MZJS7904
SAALER Sven	MZJS7903
SLATER David	MZJS7905
STRECHER Matthew	MZJS7910
THOMPSON Mathew	MZJS7902
YIU Angela	MZJS7906
Not offered in Spring	
GRAMLICH-OKA Bettina	MZJS7909

Autumn

ANNO Tadashi	MZAG790D
FARRER James	MZAG790A
HESS Christian	MZAG790B
ITO Takeshi	MZAG790C
NAKANO Koichi	MZAG790E
WANK David	MZAG790F
FAHY Sandra	MZAG790G
BURRETT Tina	MZAG790H
WATANABE Takehiro	MZAG790I

Autumn

HAGHIRIAN Parissa	MZBD790A
KHOJASTEH Yacob	MZBD790E
ISAKA Naoto	MZBD790C
MORIMOTO Mariko	MZBD790B
UENISHI Junko	MZBD790D
KOSAKA Michiru	MZBD790H
Not offered in Autumn	
ASANO Akihito	MZBD790F
KONISHI Yoshifumi	MZBD790G

Autumn

GARDNER Richard	MZJS790A
GRAMLICH-OKA Bettina	MZJS790I
HAYASHI Michio	MZJS790G
HIRASAWA Caroline	MZJS790K
KONO Shion	MZJS790H
MURAI Noriko	MZJS790L
ROBOUAM Thierry	MZJS790D
SAALER Sven	MZJS790C
SLATER David	MZJS790E
STRECHER Matthew	MZJS790J
THOMPSON Mathew	MZJS790B
YIU Angela	MZJS790F

<Master's Thesis>

AG900

Spring	MZAG9001
Autumn	MZAG9002

BD900

Spring	MZBD9001
Autumn	MZBD9002

JS900

Spring	MZJS9001
Autumn	MZJS9002

COURSE LIST

Course No.	Registration Code	Course Numbering	Course Title	Credits	Professor	Semester	Remarks
AREA-BASED GLOBAL STUDIES							
<i>Foundational Courses</i>							
AG741	MZAG7410	AGS501	INTRODUCTION TO GLOBAL STUDIES 1	2	co) Watanabe, Takehiro	Spring	
AG745	MZAG7450	AGS502	INTRODUCTION TO GLOBAL STUDIES 2	2	co) Watanabe, Takehiro	Autumn	
<i>Elective Courses</i>							
AG520	MZAG5200	AGS701	GLOBAL HEALTH	4	Sugawara, Yuka	Autumn	
AG521	MZAG5210	AGS702	GLOBALIZATION AND SOCIETY	4	Farrer, James	Spring	
AG524	MZAG5240	AGS703	HUMAN RIGHTS	4	Fahy, Sandra	Autumn	
AG525	MZAG5250	AGS704	GLOBAL CULTURE	4	Watanabe, Takehiro	Not offered	
AG527	MZAG5270	AGS705	GLOBALIZATION AND NATION-STATES	4	Anno, Tadashi	Autumn	
AG502	MZAG5020	AGS714	COMPARATIVE POLITICS	2	Nakano, Koichi	Spring	
AG504	MZAG5040	AGS715	DEMOCRACY IN GLOBALIZATION	2	Nakano, Koichi	Autumn	
AG531	MZAG5310	AGS707	GLOBAL POLITICS	4	Ito, Takeshi	Spring	
AG532	MZAG5320	AGS708	MEDIA AND POLITICS	4	Burrett, Tina	Autumn	
AG508	MZAG5080	AGS716	EMPIRE AND AFTERMATH-A GLOBAL HISTORY	2	Hess, Christian	Spring	
AG509	MZAG5090	AGS717	CHINA-THE GLOBAL HISTORY OF A RISING POWER	2	Hess, Christian	Autumn	
AG535	MZAG5350	AGS710	DIPLOMATIC HISTORY	4	Michelin, Franck	Spring	
AG537	MZAG5370	AGS711	GLOBAL ISSUES	4	Dale, Sonja	Spring	
AG510	MZAG5100	AGS712	GLOBALIZATION AND POPULAR RELIGION	2	Murakami, Tatsuo	Spring	
AG512	MZAG5120	AGS718	TOPICS IN SOCIOLOGICAL THEORY	2	Wank, David	Spring	
AG514	MZAG5140	AGS719	APPROACHES TO DEVELOPMENT	2	Wank, David	Autumn	
AG516	MZAG5160	AGS720	GLOBAL MIGRATION	2	Zulueta, Johanna	Spring	
D41029	MLLW7230	POL705	INTERNATIONAL POLITICS	2	Okabe, Midori	Not offered	L
D41030	MLLW7240	POL706	INTERNATIONAL MIGRATION	2	Okabe, Midori	Not offered	L
D41055	MLLW7190	POL701	POLITICAL ECONOMY OF GLOBALIZATION 1	2	Kato, Kozo	Spring	L
D41056	MLLW7200	POL702	POLITICAL ECONOMY OF GLOBALIZATION 2	2	Kato, Kozo	Autumn	L
D41057	MLLW7210	POL703	GLOBALIZATION AND PUBLIC POLICY	2	Miura, Mari	Spring	L
D41058	MLLW7220	POL704	CONTEMPORARY JAPANESE POLITICS	2	Miura, Mari	Not offered	L
D62119	MFIR6260	IRS726	POLITICAL ECONOMY OF DEVELOPING COUNTRIES 1(Theory)	2	Takashima, Ryo	Spring	I
D62120	MFIR6270	IRS727	POLITICAL ECONOMY OF DEVELOPING COUNTRIES 2 (Case Study)	2	Takashima, Ryo	Autumn	I
D62138	MFIR6271	IRS782	RESEARCH IN DEVELOPMENT ECONOMICS 1	2	Takashima, Ryo	Not offered	I
D62139	MFIR6272	IRS783	RESEARCH IN DEVELOPMENT ECONOMICS 2	2	Takashima, Ryo	Not offered	I
D63051	MFAS7440	ARS713	INTERNATIONAL RELATIONS OF MIDDLE EAST	2	Tateyama, Ryoji	Spring	A
D63086	MFAS7840	ARS707	PROBLEMS OF GLOBALIZATION: POLITICAL AND ECONOMIC	2	co) Kawashima, Midori	Autumn	A
D63101	MFAS7040	ASE701	S.E. ASIAN SOCIETY AND CULTURE 1	2	Marui, Masako	Spring	A
D63102	MFAS7050	ASE702	S.E. ASIAN SOCIETY AND CULTURE 2	2	Marui, Masako	Autumn	A
D63113	MFAS7160	ASE709	S.E. ASIAN CULTURE 1	2	Terada, Takefumi	Spring	A
D63114	MFAS7170	ASE710	S.E. ASIAN CULTURE 2	2	Terada, Takefumi	Autumn	A
D63129	MFAS7320	AME705	SOCIAL HISTORY OF MIDDLE EAST 1	2	Kisaichi, Masatoshi	Spring	A
D63130	MFAS7330	AME706	SOCIAL HISTORY OF MIDDLE EAST 2	2	Kisaichi, Masatoshi	Autumn	A
D63137	MFAS7400	AME713	MIDDLE EASTERN CULTURE 1	2	Akahori, Masayuki	Spring	A
D63138	MFAS7410	AME714	MIDDLE EASTERN CULTURE 2	2	Akahori, Masayuki	Autumn	A
D63145	MFAS7490	ALA705	LATIN AMERICAN INTERNATIONAL RELATIONS 1	2	Koyasu, Akiko	Spring	A
D63146	MFAS7500	ALA706	LATIN AMERICAN INTERNATIONAL RELATIONS 2	2	Koyasu, Akiko	Autumn	A
D63153	MFAS7570	ALA709	LATIN AMERICAN SOCIETY 1	2	Hataya, Noriko	Not offered	A
D63154	MFAS7580	ALA710	LATIN AMERICAN SOCIETY 2	2	Hataya, Noriko	Not offered	A
D63161	MFAS7650	ALA717	LATIN AMERICAN ECONOMY 1	2	Tani, Hiroyuki	Spring	A
D63162	MFAS7660	ALA718	LATIN AMERICAN ECONOMY 2	2	Tani, Hiroyuki	Autumn	A
D83048	MHSC7150	SOC715	ECONOMIC SOCIOLOGY & SOCIOLOGY OF ORGANIZATION 1	2	Watanabe, Shin	Spring	S
D83049	MHSC7160	SOC716	ECONOMIC SOCIOLOGY & SOCIOLOGY OF ORGANIZATION 2	2	Watanabe, Shin	Autumn	S
D83052	MHSC7190	SOC719	NATIONALISM AND GLOBALIZATION 1	2	Yoshino, Kosaku	Spring	S
D83053	MHSC7200	SOC720	NATIONALISM AND GLOBALIZATION 2	2	Yoshino, Kosaku	Autumn	S
D83073	MHSC7280	SOC728	SEMINAR ON SOCIAL MOVEMENT	2	Saruya, Hiroe	Autumn	S
D81102	MHED7490	EDU515	LEC. IN INTERNATIONAL EDUCATIONAL DEVELOPMENT	2	Komatsu, Taro	Spring	E

co) : Coordinator

Course No.	Registration Code	Course Numbering	Course Title	Credits	Professor	Semester	Remarks
INTERNATIONAL BUSINESS AND DEVELOPMENT STUDIES							
<i>Core Course Applicable to Both International Business and Development Studies</i>							
BD500	MZBD5000	IBD501	MATHEMATICAL TECHNIQUES IN BUSINESS AND ECONOMICS	4	Asano, Akihito	Not offered	
BD510	MZBD5100	IBD705	BUSINESS AND ECONOMIC STATISTIC	4	Hasebe, Takuya	Spring	
<i>International Business Core Courses</i>							
BD503	MZBD5030	IBD502	CORPORATE STRATEGY AND ORGANIZATIONAL DEVELOPMENT	4	Haghirian, Parissa	Autumn	
BD504	MZBD5040	IBD701	INTERNATIONAL INFORMATION SYSTEM AND MANAGEMENT	4	Singh, Mahendra	Spring	
BD505	MZBD5050	IBD702	FINANCIAL ACCOUNTING	4	Uenishi, Junko	Spring	
BD507	MZBD5070	IBD703	ASIAN COMPARATIVE MANAGEMENT	4	Tachiki, Dennis	Autumn	
BD508	MZBD5080	IBD704	INTERNATIONAL FINANCIAL MANAGEMENT	4	Isaka, Naoto	Autumn	
BD511	MZBD5110	IBD706	INTERNATIONAL MARKETING	4	Morimoto, Mariko	Spring	
D51520	MEEC7190	ECN716	CORPORATE FINANCE	4	Kawanishi, Satoshi	Autumn	EC
<i>Development Studies Core Courses</i>							
BD520	MZBD5200	IBD707	DEVELOPMENT THEORY AND POLICY	4	Staff	Autumn	
BD521	MZBD5210	IBD708	INTERNATIONAL ECONOMICS	4	Kosaka, Michiru	Spring	
BD525	MZBD5250	IBD709	SUPPLY CHAIN MANAGEMENT	4	Khojasteh, Yacob	Autumn	
BD531	MZBD5310	IBD710	ENVIRONMENT ECONOMICS AND POLICY	4	Konishi, Yoshifumi	Spring	
<i>Advanced Elective Courses</i>							
BD707	MZBD7070	IBD711	TOPICS IN BUSINESS AND DEVELOPMENT 1	2	Liu, Simon	Spring	
BD708	MZBD7080	IBD712	TOPICS IN BUSINESS AND DEVELOPMENT 2	2	Liu, Simon	Autumn	
JAPANESE STUDIES							
<i>Foundational Courses</i>							
J546	MZJS5460	J546	INTRODUCTION TO JAPANESE STUDIES	2	Gardner, Richard	Spring	
J546	MZJS5461	J546	INTRODUCTION TO JAPANESE STUDIES	2	Gardner, Richard	Autumn	
<i>Japanese Language Courses</i>							
J590	MZJS5901	J590	JAPANESE LANGUAGE COURSE A	2	Tokumaru, Satoko	Spring	
J590	MZJS590A	J590	JAPANESE LANGUAGE COURSE A	2	Tokumaru, Satoko	Autumn	
J591	MZJS591B	J591	JAPANESE LANGUAGE COURSE B	2	Tokumaru, Satoko	Autumn	
<i>Arts and Culture</i>							
J501	MZJS5010	J501	MODERN JAPANESE VISUAL CULTURE	4	Hayashi, Michio	Spring	
J504	MZJS5040	J504	JAPANESE ART HISTORY	4	Hirasawa, Caroline	Autumn	
J505	MZJS5050	J505	MODERN JAPANESE ART HISTORY	4	Murai, Noriko	Autumn	
J506	MZJS5060	J506	REPRESENTATIONS OF RACE, GENDER AND BODY	4	Choo, Kukhee	Spring	
J510	MZJS5100	J510	CONTEMPORARY JAPANESE LITERATURE	4	Strecher, Matthew	Autumn	
J511	MZJS5110	J511	INTERPRETATIONS OF MODERNITY	4	Yiu, Angela	Autumn	
J512	MZJS5120	J512	COMPARATIVE LITERATURE	4	Kono, Shion	Spring	
J514	MZJS5140	J514	SEMINAR IN PRE-MODERN JAPANESE LITERATURE	4	Thompson, Mathew	Spring	
J570	MZJS7000	J570	READING IN JAPANESE SOURCES	2	Nakai, Maki	Spring	
<i>Thought and Society</i>							
J517	MZJS5170	J517	RELIGION AND JAPANESE SOCIETY	4	Drott, Edward	Autumn	
J532	MZJS5320	J532	JAPANESE HISTORY	4	Gramlich-Oka, Bettina	Not offered	
J533	MZJS5330	J533	MODERN JAPANESE HISTORY	4	Saaler, Sven	Autumn	
J541	MZJS5410	J541	JAPANESE ETHNOGRAPHY	4	Slater, David	Spring	
J542	MZJS5420	J542	POPULAR CULTURE	4	Galbraith, Patrick	Spring	
J543	MZJS5430	J543	URBAN SPACE STUDIES	4	Dimmer, Christian	Autumn	
J544	MZJS5440	J544	TOPICS IN JAPANESE RELIGION	4	Gardner, Richard	Not offered	
J545	MZJS5450	J545	TOPICS IN CONTEMPORARY JAPANESE BUDDHISM	4	Robouam, Thierry	Spring	

Any changes in course schedule will be announced on the Loyola bulletin board. Please check carefully before registration.

A: offered by Graduate Program in Area Studies

EC: offered by Graduate Program in Economics

I: offered by Graduate Program in International Relations

L: offered by Graduate Program in Law

S: offered by Graduate Program in Sociology

E: offered by Graduate Program in Education

Dual Degree Program Sophia (GPGS)-SOAS

Sophia University's Graduate Program in Global Studies (GPGS) and the Department of Japan and Korea at SOAS (School of Oriental and Asian Studies, University of London) have launched a Dual Degree Program (DDP) that enables students to benefit from the combined resources of the two schools, located in two major world cities – Tokyo and London.

Students will typically study one year at GPGS and one year at SOAS and, after fulfilling the requirements of the two programs, receive two degrees: an M.A. from Sophia and an M.A. from SOAS.

The DDP allows students to fully utilize the resources of both schools to widen their intellectual horizons by taking classes at two leading institutions in the field of Japanese Studies. Prominent scholars affiliated with the two institutions will supervise the students' theses or graduation projects, enabling them to explore Japanese studies from a variety of perspectives.

Sophia University students entering in April will need to apply separately for admission to SOAS during their first semester and would typically spend their second and third semesters at SOAS. Students entering Sophia University in September have to apply for admission to SOAS in their second semester, spend their third and fourth semesters at SOAS and complete Sophia requirements in their fifth semester.

Typical sequence for Sophia GPGS students participating in the DPP

Semester	Autumn	Spring	Autumn	Spring	Autumn
Autumn entry	Sophia	Sophia	SOAS	SOAS	Sophia
Spring entry		Sophia	SOAS	SOAS	Sophia

The application deadline for the DDP is in May. Detailed information about the application procedure is available at the GPGS office

*Applicants must have achieved a GPA of at least 3.3 or higher (out of 4.0) in undergraduate education. Also students will obtain entry to the DDP based on the following TOEFL/IELTS results:

TOEFL : iBT 105 with at least 22 in each sub-score

IELTS : Overall 7 (with 6.5 in each sub-score)

*The Japanese government sponsored (MEXT) students will not be able to apply for this program.

SOAS Japan and Korea Department

<http://www.soas.ac.uk/japankorea/>

PH.D. CURRICULUM

Ph.D. Degree Requirements and Schedules

Ph.D in Global Studies

A doctoral student begins working towards the doctoral degree upon matriculation in the GPGS. With the successful defense of the dissertation prospectus, typically in the third semester, the graduate student is considered a doctoral candidate.

The general requirements for completing the Ph.D. are a period of enrollment, and the writing and defense of a satisfactory dissertation that is subsequently accepted by the dissertation committee. No specified number of courses completed or credits earned will assure attainment of the doctorate. A doctoral program consists of a combination of course seminars and individual study and research that meets the minimum requirements of the GPGS and is approved by the doctoral committee for each individual student.

Process

Step 1: Qualifying Exams

A doctoral student is examined for knowledge and training to research and write a dissertation. There are three kinds of qualifying exams: global studies, disciplinary, and language. The timing of the exams depends on the student's background and advisor's judgment but they are usually taken in the first year.

Step 2: Dissertation Prospectus

Upon successful passage of the qualifying exams, a student develops a dissertation prospectus under the guidance of the advisor that is defended before the faculty.

Step 3: Research and Writing

Upon successful defense of the dissertation prospectus, the candidate is considered a doctoral candidate and embarks on researching and writing the dissertation. The candidate may choose, upon consultation with the advisor, to leave for extended fieldwork. (S/he must continue to pay full tuition until satisfying the three-year minimum enrollment requirement).

Step 4: Dissertation Defense

The dissertation is submitted by the end of the semester prior to the semester in which the candidate intends to defend the dissertation, and at least four months before the intended defense date.

The Ph.D. in Global Studies is designed for the advanced study of specific areas or locals in the context of global processes and transnational connections. While the questions and lines of inquiry in global studies are interdisciplinary, research and writing agendas emphasize methods and concepts from the disciplines of history, political science, and sociology. The degree is intended to prepare persons for academic positions in area, international, and global studies programs, or for research positions in foundations, NGOs, and companies that need advanced analysis of countries and regions in a global context.

The Ph.D. program, which requires a three-year residency, focuses on the writing of a doctoral dissertation. While no course work is required, candidates participate in workshops and other program activities and may, in consultation with their dissertation supervisor, attend courses. Candidates first pass several qualifying exams and then, upon successful defense of a dissertation prospectus proceed to dissertation research and writing. To enable close guidance of the dissertation, only a few candidates are admitted each year.

<Research Guidance>

For students who entered in April 2011 or after

Course numbering; AGS988		
Professor	Semester	Registration Code
ANNO Tadashi	Spring	DZAG3004
BURRETT Tina	Spring	DZAG3008
FAHY Sandra	spring	DZAG3006
FARRER James	Spring	DZAG3001
HESS Christian	Spring	DZAG3007
ITO Takeshi	Spring	DZAG3002
NAKANO Koichi	Spring	DZAG3005
WANK David	Spring	DZAG3003
WATANABE Takehiro	Spring	DZAG3009
ANNO Tadashi	Autumn	DZAG300D
BURRETT Tina	Autumn	DZAG300I
FAHY Sandra	Autumn	DZAG300H
FARRER James	Autumn	DZAG300A
HESS Christian	Autumn	DZAG300G
ITO Takeshi	Autumn	DZAG300B
NAKANO Koichi	Autumn	DZAG300E
WANK David	Autumn	DZAG300C
WATANABE Takehiro	Autumn	DZAG300J

<Thesis Guidance>

For students who entered before 2011

Course numbering; AGS989		
Professor	Semester	Registration Code
STAFF	Spring	DZAG9997
STAFF	Autumn	DZAG999G

Students who entered the Ph.D. program before 2011 should register for “Thesis Guidance” with their advisors each semester during the first three years.

Students who entered after 2011 should register for “Research Guidance” every semester during their residency in GPGS.

Faculty

ANNO Tadashi

Associate Professor, Political Science

B.A., University of Tokyo; M.A., Ph.D., University of California, Berkeley

Theories of international relations and comparative politics, globalization and the future of the nation-state, nationalism, Soviet and Post-Soviet politics

BURRETT Tina

Associate Professor, Political Science

B.A., Leeds University; M.phil, Ph.D., Cambridge University

Governance, leadership, democratization, political accountability, the role of the media in politics

FAHY Sandra

Associate Professor, Anthropology

B.A., M.A., York University;

Ph.D., School of Oriental and African Studies, University of London

Social and cultural anthropology of East Asia region

FARRER James

Professor, Sociology

B.A., University of North Carolina, Chapel Hill; M.A., Ph.D., University of Chicago

Urban sociology, foodways and cuisine, sexuality, nightlife, skilled migration

(expatriates)

HESS Christian

Associate Professor, Modern Chinese History

B.A., University of California, Davis

M.A., Ph.D., University of California, San Diego

Modern Chinese history, urban history, Japanese colonialism in northeast China

ITO Takeshi

Associate Professor, Political Science

B.A., Keio University; M.A., Hitotsubashi University;

M.A., M.Phil., Ph.D., Yale University

Agrarian studies, comparative politics, development studies, global environmental politics

NAKANO Koichi

Professor, Political Science

B.A., University of Tokyo; B.A., University of Oxford; M.A., Ph.D., Princeton

University

Japanese politics, comparative politics, New Right transformation, public protest and civic activism, party politics and policy change, bureaucracy and administrative reform

WANK David L.

Professor, Sociology

B.A., Oberlin College; M.A., Ph.D., Harvard University

Economic sociology, political sociology, social networks, institutional change, communities and transnational links, ethnography, China

WATANABE Takehiro

Associate Professor, Anthropology

B.A., State University of New York, Albany; M.A., Ph.D., Columbia University

Cultural and social anthropology, modernity, critical theory, history, Japan

Ph.D. in Japanese Studies

A doctoral student begins working towards the degree upon matriculation in the GPGS. With the successful defense of the dissertation prospectus, the student is considered a doctoral candidate.

The general requirements for completing the Ph.D. are a period of enrollment, and the writing of a satisfactory dissertation that is defended and accepted by the dissertation evaluation committee. A doctoral program consists of individual study and research (including possible participation in graduate seminars) that meets the minimum requirements of the GPGS and is approved by the doctoral committee for each individual student.

PROCESS

Step 1: Qualifying Exams

A doctoral student is examined for knowledge and training to research and write a dissertation. There are three qualifying exams – Japanese Studies, Disciplinary, and Language. The timing of the exams depends on the doctoral student's background and the advisor's judgment, but the exams are usually taken during the second or the third semesters.

Step 2: Dissertation Prospectus

Upon successful passage of the qualifying exams, a doctoral student develops a dissertation prospectus under the guidance of the advisor and defends it before the JS Ph.D. faculty.

Step 3: Research and Writing

Upon successful defense of the dissertation prospectus, the doctoral student is considered a doctoral candidate and embarks on researching and writing the dissertation. The candidate may choose, upon consultation with the supervisor, to leave for extended fieldwork. (S/he must continue to pay full tuition until satisfying the three-year minimum enrollment requirement.)

Step 4: Dissertation Defense

The dissertation is submitted by the end of the semester prior to the semester in which the candidate intends to defend the dissertation, and at least four months before the intended defense date.

The Ph.D. in Japanese studies is designed for the advanced study of Japan in a transnational, regional and global context. Research and writing agendas emphasize methods and concepts from the disciplines of art history, literature, history, religious studies, cultural anthropology, media studies and cultural studies. The degree prepares students for academic positions in Japanese Studies programs, and for research positions in foundations, NGOs and companies that need advanced analyses of countries and regions in global contexts.

The doctoral course, which requires a three-year residency, focuses on the writing of a dissertation. While no course work is required, a doctoral student participates in workshops and other program activities and may, in consultation with her or his advisor, audit courses. A doctoral student must first pass qualifying exams and then proceed on to dissertation research and writing. To ensure close guidance of the dissertation, only a few candidates are admitted each year.

<Research Guidance>

Course numbering; JST988

Professor	Spring	Autumn
GARDNER Richard	DZJS3001	DZJS300A
GRAMLICH-OKA Bettina	DZJS3002	DZJS300B
HAYASHI Michio	DZJS3003	DZJS300C
HIRASAWA Caroline	DZJS3004	DZJS300D
KONO Shion	DZJS3005	DZJS300E
MURAI Noriko	DZJS3006	DZJS300F

Professor	Spring	Autumn
ROBOUAM Thierry	DZJS3007	DZJS300G
SAALER Sven	DZJS3008	DZJS300H
SLATER David	DZJS3009	DZJS300I
STRECHER Matthew	DZJS3012	DZJS300L
THOMPSON Mathew	DZJS3010	DZJS300J
YIU Angela	DZJS3011	DZJS300K

Students should register for “Research Guidance” every semester during their residency in GPGS.

Faculty

GARDNER Richard

Professor, Religion

B.A., Miami University; M.A., Ohio State University; M.A., Ph.D., University of Chicago

Theories of religion, theater and religion, religion and the arts, humor and religion

GRAMLICH-OKA, Bettina

Professor, History

B.A., Tübingen University; M.A., Sophia University; Ph.D., Tübingen University

Japanese history, women's studies, medical history

HAYASHI Michio

Professor, Art History

B.A., University of Tokyo; M.A., Ph.D., Columbia University

Modern and contemporary art, mass culture, media

HIRASAWA Caroline

Associate Professor, Art History

B.A., Empire State College; MFA, Tokyo National University of Fine Arts and Music;

M.A., Ph.D., Stanford University

Japanese sacred art, including paintings of the afterlife and pilgrimage mandara

KONO Shion

Associate Professor, Literature

B.A., Bowdoin College; M.A., Ph.D., Princeton University

Comparative literature, Modern Japanese literature

MURAI Noriko

Associate Professor, Art History

B.A., University of California, Berkeley; M.A., Ph.D., Harvard University

Modern art history (Japan), visual culture, gender studies

ROBOÜAM Thierry Jean, S.J.

Associate Professor, Religion and Philosophy

B.A., M.A., Sophia University S.T.D., Jesuit School of Theology at Berkeley

Systematic theology, Buddhist studies (Mahayana Mikkyo), modern philosophy (Descartes), postmodern philosophy (Deleuze)

SAALER Sven

Associate Professor, History

M.A., Ph.D., University of Bonn

Japanese political history, history of Japanese foreign relations, politics of memory, history of Pan-Asianism

SLATER David

Professor, Anthropology

B.A., Vassar College; M.A., Ph.D., University of Chicago

Cultural and social anthropology, education, social class, semiotics, urban studies, Japan

STRECHER Matthew

Professor, Literature

B.A., M.A., University of Texas; Ph.D., University of Washington

Modern and contemporary Japanese literature, literary journalism, genre studies, mythology, global literature, and postmodernism

THOMPSON Mathew

Associate Professor, Literature

B.A., Yale University; M.A., Ph.D., Columbia University

Medieval and early modern Japanese literature, the legend of Minamoto no Yoshitsune

YIU Angela

Professor, Literature

B.A., Cornell University; M.A., Ph.D., Yale University

Modern Japanese literature, literature and Tokyo

FACULTY OFFICES

Name	Room	Office Hours
Anno, Tadashi	10-525	(SPR) & (AUT) Tues. Fri. 1:00-2:30
Asano, Akihito	10-555	(SPR) Mon. Thurs. 3:15-4:45 or by appointment (AUT) Sabbatical
Burrett, Tina	10-522	(SPR) Mon.Thur.11:00-12:00 (AUT) Mon.12:30-1:30 or by appointment
Choo, Kukhee	10-632	(SPR) & (AUT) Tues. 3:00-4:30 or by appointment
Drott, Edward	10-653	(SPR) Mon. 1:00-2:00 Thurs. 2:00-3:00 (AUT) Mon 12:00-1:00 Thus. 11:00-12:00
Fahy, Sandra	10-505	(SPR) & (AUT) Fri. 3:30-4:30 or by appintment
Farrer, James	10-503	(SPR) & (AUT) Mon. 2:30-4:30 or by appointment
Gardner, Richard	10-649	(SPR) & (AUT) Tues. Fri. 1:30-3:00 or by appointment
Gramlich-Oka, Bettina	10-520	(SPR) Sabbatical (AUT) Fri. 11:00-1:00 or by appointment
Haghirian, Parissa	10-535	(SPR) & (AUT) Mon. 12:30-1:30
Hasebe, Takuya	10-553	(SPR) & (AUT) Mon. Thurs. 3:15-4:15 or by appointment
Hayashi, Michio	10-628	(SPR) & (AUT) Mon. Fri. 1:00-2:00
Hess, Christian	10-518	(SPR) & (AUT) Mon. 11:00-1:00 or by appointment
Hirasawa, Caroline	10-630	(SPR) Mon. 1:00-2:00 (AUT) Thurs. 3:00-4:00 or by appointment
Isaka, Naoto	10-543	(SPR) Sabbatical (AUT) Tues. 3:15-4:00 or by appointment
Ito, Takeshi	10-530	(SPR) & (AUT) Fri. 3:00-4:00
Khojasteh, Yacob	10-549	(SPR) Tues.Fri. 10:45-11:45 or by appointment (AUT) Tues.Fri. 2:15-3:15 or by appointment.
Konishi, Yoshifumi	10-547	(SPR) Mon.Thurs. 12:45-1:30 or by appointment (AUT) Sabbatical
Kono, Shion	10-637	(SPR) & (AUT) Fri. 2:00-3:00 or by appointment
Kosaka, Michiru	10-541	(SPR) Tues.Fri. 12:40-1:15 (AUT) Tues.Fri.12:15-1:15
Morimoto, Mariko	10-533	(SPR) Mon.3:15-4:30 (AUT) Mon.1:30-2:45 or by appointment
Murai, Noriko	10-634	(SPR) Tues. 3:30-4:30 (AUT) Tues.11:30-12:30
Murakami, Tatsuo	10-655	(SPR) & (AUT) Tues. Fri. 3:00-4:00
Nakano, Koichi	10-528	(SPR) Mon. 2:00-3:00 (AUT) Mon. 11:00-12:00
Robouam, Thierry	10-657	(SPR) & (AUT) Tues. Fri. 9:15-10:30
Saaler, Sven	10-516	(SPR) Thurs. 2:00-3:00 (AUT) Thurs. 2:00-3:00 or by appointment
Slater, David	10-509	(SPR) & (AUT) Tues. 1:30-3:00
Strecher, Matthew	10-642	(SPR) Tues.Fri. 11:00-12:00 (AUT) Tues. 10:00-12:00 or by appointment
Sugawara, Yuka	10-501	(SPR) Tues. 3:00-4:30 (AUT) Tues. 11:00-12:30 or by appointment
Thompson, Mathew	10-644	(SPR) & (AUT) Tues. 1:30-3:00
Uenishi, Junko	10-557	(SPR) Tues.Fri. 5:00-6:00 (AUT) Tues.Fri. 3:30-4:30 or by appointment
Wank, David	10-512	(SPR) & (AUT) Tues.4:00-5:00 or by appointment
Watanabe, Takehiro	10-514	(SPR) & (AUT) Tues.3:15-4:15 or by appointment
Yiu, Angela	10-647	(SPR) & (AUT) Fri. 3:00-4:00

Graduate Program in Science and Technology

Education and Research Objectives and Human Resource Development Objectives

The Graduate School of Science and Technology aims to achieve a distinctive combination of expertise that contributes to advancements in various contemporary fields of science and technology, and interdisciplinary strategies for comprehending impacts on human society and the global environment. The Pre-Doctoral Program, which is designed for continuity with the undergraduate curriculum, cultivates knowledgeable individuals equipped with both “multiple intelligence” and specialized skills and are capable of contributing to society and humanity. The Doctoral Program aims to produce researchers capable of undertaking research in their fields of specialization independently.

Curriculum Policy in Green Science and Engineering Division

[Master’s Program]

Extensive knowledge and advanced expert knowledge as well as professional expertise combined with cross-disciplinary knowledge in a field related to the environment and sustainability are fostered. All educational programs are offered in English with the aim of developing students’ ability to work in an international environment.

[Doctoral Program]

A broad range of academic backgrounds and leading-edge expert knowledge in a specialized field related to the environment and sustainability are offered to students in order to foster professional expertise that would enable them to carry out research and development independently. All educational programs are offered in English with the aim of developing students’ ability to work in an international environment.

Diploma Policy in Green Science and Engineering Division

[Master’s Program]

A master’s degree (in science or engineering) is conferred on those pursuing a discipline related to the environment and the sustainability of modern science and technology, who possess expertise that would contribute to the further development of the discipline as well as interdisciplinary abilities that would help identify its impact on the human society and global environment in a comprehensive manner, thereby contributing to the human society.

[Doctoral Program]

A doctoral degree (in science or engineering) is conferred on those pursuing a discipline related to the environment and the sustainability of modern science and technology, who possess expertise that would contribute to the further development of the discipline as well as interdisciplinary abilities that would help identify its impact on the human society and global environment in a comprehensive manner, and can carry out research and development independently.

Note: The English translation is provided for information. The original Japanese version remains the sole official version. If there is any discrepancy between the two versions, the Japanese original should take precedence.

GRADUATE PROGRAM IN SCIENCE AND TECHNOLOGY OVERVIEW

The Graduate Program in Science and Technology (GPST) has one interdisciplinary graduate program with nine divisions.

The interdisciplinary graduate program aims to be both specialized, to bring to light new scientific information and technological developments in all the academic divisions, and interdisciplinary, to foster a common regard for their effects of such developments on humankind, the society, and the global environment.

The first stage of the program is designed to maintain consistency with undergraduate instruction by combining cross-disciplinary knowledge and specialty with the objective of cultivating highly educated individuals who can contribute to the well-being of humankind and the society. The second stage of the program aims to produce researchers who can execute independent research in one or more academic fields.

Green Science and Engineering Division

The Green Science and Engineering Division is a new division, that was established in 2013. It occupies a special position among the nine divisions of the Graduate Program of Science and Technology.

First of all, the entire educational program, including lectures and research guidance, is conducted in English. In addition, emphasis is given to environment and sustainability-related studies, which are vital to the future of humankind.

To foster cross-disciplinary education, faculty members from the eight divisions (Mechanical Engineering, Electrical and Electronics Engineering, Applied Chemistry, Chemistry, Mathematics, Physics, Biological Science, Information Science) will be involved in teaching and research guidance. At the same time, by joining the research group of the faculty member of their choice, students can receive research guidance and pursue much more advanced research work.

1. Degrees

Master of Science in Green Science and Engineering or Doctor of Philosophy in Green Science and Engineering will be awarded after completion of each program. They are all accredited by the Ministry of Education, Culture, Sports, Science and Technology in Japan (MEXT).

2. Courses related to law and humanities for students in the Graduate School of Science and Technology

In accordance with the rules of the Graduate School of Sophia University, students are allowed to transfer up to 8 credits of classes obtained in other graduate schools of Sophia University deemed beneficial to their education and research by instructors to the required credits in their own schools. Courses with such transferable credits include law and humanities courses (including courses on Christian world view). Completion of these courses is recommended because recent rapid progress in science and technology has significantly affected various aspects of human life and has required students to acquire knowledge on various fields in addition to expertise as scientists and engineers. See pp 10~12 for necessary procedures.

3. Transfer of credit from other universities

In accordance with the rules of the Graduate School of Sophia University, students are allowed to transfer up to 10 credits from a student's previous work as a graduate student. Please note that transfer of such credit must be approved by the faculty of the GPST.

4. Submission of Master's Thesis

Registration for Master's Thesis: Registration must be done through Loyola during the registration period of the intended semester of graduation.

Deadline of submission: June 30 (Thu.), 2016

Place to submit: Office of the Green Science and Engineering Division (Room 4-590)

Note: Please pick up a "Master's Thesis Submission Form" at the Center for Academic Affairs and submit the form with a Bookbinding Fee (修士論文製本) stamp available at the Center for Academic Affairs before submitting the thesis to the Supervisor.

5. Early Graduation

Students who wish to graduate early (e.g. in 2 or 3 semesters) can apply for Early Graduation if they are in good academic standing by the judgment of the faculty and satisfy the requirements.

A. Submit an "Early Graduation Request" form.

B. Complete at least 30 credits of courses from the GPST curriculum by the time of graduation and obtain a GPA of 3.8 or higher.

"Application for Early Graduation" forms are available in the GPST office.

Students should submit the proposal form to their supervisor and chairperson of division one year before graduating.

* Please consult the supervisor.

6. Teachers License Course

Students may take additional courses offered to obtain a certificate for teachers license in Japan.

All courses will be offered in Japanese.

Please refer to the Academic Handbook for Teachers License (履修要覧 課程編) for details.

To obtain a Teachers Specialized Certificate:

Earn credits required for specified courses and submit collective application. Read carefully and apply as follows:

A. What is a Teachers Specialized Certificate?

Teachers Specialized Certificate is a higher level of license students may apply for if they have obtained Junior high/ High School teachers Primary License and have completed Pre-doctorate (Master's) Program. It is given only for the same category/subject for which the Teachers Primary License is obtained. The Teachers Specialized Certificates you may apply for at Sophia Graduate School are listed in the "Appendix"

B. Requirement for Teachers Specialized Certificate

Qualification Types of license	Basic requirements	Minimum number of credits required for each teaching subject
Teachers Specialized Certificate	Master's Degree	24 credits
	Enrolled at least one year in Graduate School and earned 30 credits or more (Teachers License Act, Article 5, Appended Table, Remarks 1, Section 2)	30 credits

- i. The courses required for obtaining Teachers Specialized Certificate are specified for each Teaching Subject License by each Graduate School/ Program. You must select from the list of specified courses and complete 24(30) credits. If you earn credits for courses not on the list of specified courses, the credits may be approved for your completion requirement but will not be considered for obtaining Teachers Specialized Certificate.
- ii. Credits earned for courses offered by Undergraduate Faculties, other Graduate Programs, other universities or overseas universities may be approved for credit transfer but will not be considered for obtaining Teachers Specialized Certificate.

C. Points to be noted for obtaining Teachers Specialized Certificate

i. If you have not obtained Teachers Primary License:

While being enrolled as a Graduate School student, you also need to enroll separately as non-degree student (Certification Course) and complete the credits required for Teachers Primary License and then, to obtain the Teachers Specialized Certificate, you also need to satisfy the requirements for Teachers Specialized Certificate as provided above (note that if you take undergraduate courses as a Graduate School student, the credits earned will not be approved for Teachers Primary License requirement).

ii. If you already have a Teachers License and a teaching experience of three years or more at a Junior high/High School:

According to Article 6 of Teachers License Act (Teachers Certification), you can obtain the Teachers Specialized Certificate by earning credits required (15 credits or more, generally) at Sophia University and taking the certification test held by prefectural governments. The number of minimum credits required varies with the years of teaching experience. For more information, inquire at each prefectural board of education.

D. Application for Teachers Specialized Certificate

Sophia University submits a collective application for Teachers License to Tokyo Metropolitan Government.

i. Collective application

Students eligible for collective application are those who have already obtained a Teachers Primary License for Junior high/High School or are expected to complete credits required for Class 1 license and are expected to obtain the Teachers Specialized Certificate at completion of Pre-doctorate Program (Master's Program).

To obtain the License at completion of your Graduate Program, you need to apply for the collective application in July in your Second Year of Pre-doctorate (Master's) Program. However, if you will not complete the Program in the academic year, you should apply in the next or following academic years.

ii. Individual application

If you do not qualify for the above collective application, you need to submit individual application. Individual application should be submitted to the prefectural board of education of “applicant's residential area”.

※ For more information on individual application, please inquire at prefectural board of education.

“Appendix”

■ Types of applicable Teachers Specialized Certificate

Graduate School	Graduate Program	Type of Teachers License	Licensed subject
Science and Technology	Science and Technology	Junior High School Teachers Specialized Certificate Junior High School Teachers Specialized Certificate High School Teachers Specialized Certificate High School Teachers Specialized Certificate High School Teachers Specialized Certificate High School Teachers Specialized Certificate	Mathematics Science Mathematics Science Engineering Information

M.A. CURRICULUM

M.A. in Green Science and Engineering Division

1. Instruction

- 1) To be eligible to receive a master's degree, students must complete at least 30 credits of coursework, submit a master's thesis, and pass oral and written exams. The required credits are as follows.

Compulsory elective courses: 2 credits

Elective courses: 28 credits

The elective courses should consist of the following.

(1) 18 credits from courses provided by Green Science and Engineering Division

(2) 4 credits from courses provided by other divisions of the School in Science and Technology or general courses of the Graduate School in Science and Technology (excluding basic courses of the Graduate School of Science and Technology)

(3) 6 credits from any of the following courses: courses provided by Green Science and Engineering Division, courses provided by other divisions, basic courses, and general courses of the Graduate School in Science and Technology

*When students earn more than 2 cr. from the courses provided as "Master's Thesis Tutorial and Exercise" (Compulsory elective courses), students may include the credits into the 6 credits described in (3).

*Students are allowed to include up to 8 credits from the courses provided by other Graduate schools within Sophia that have been approved by the supervisor to the 18 credits described in (1) above.

*In principle, "Master's Thesis Tutorial and Exercise" and "Seminar" should be completed in the order of 1A, 1B, 2A, and 2B.

*Only for courses overseen by the student's supervisor, the student is allowed to count credits from seminars provided by other divisions as seminars provided by his/her division after completing the required procedure. For details of this procedure, please contact the office of your division.

(4) Students are allowed to count credits from auditing of other university under auditing agreement as courses provided by Green Science and Engineering Division.

- 2) Students must also register the Thesis Guidance (required course) each semester.

2. Requirements for Courses, Credits, Number of courses

Core curriculum	Credits	Number of courses	Notes
Total credits	30		
Compulsory elective courses	2		
- Master's Thesis Tutorial and Exercise 1A	1		
- Master's Thesis Tutorial and Exercise 1B	1		
- Master's Thesis Tutorial and Exercise 2A	1		
- Master's Thesis Tutorial and Exercise 2B	1		
Elective courses	28		
- Courses provided by Green Science and Engineering division	18		*1, *2
- Courses provided by other divisions of the School in Science and Technology	4		*3
- Any courses provided by the School in Science and Technology	6		*4
Thesis Guidance(Compulsory)			*5
Master's Thesis			*6

- *1 Only for courses overseen by the student's supervisor, the student is allowed to count credits of seminars provided by other divisions as seminars provided by his/her division after completing the required procedure.
- *2 Courses taken at UNU may also be included with an approval from the Director.
- *3 Basic courses of the Graduate School in Science and Technology are excluded. General courses of the School in Science and Technology are included.
- *4 Any courses including basic and general courses of the Graduate School in Science and Technology.
- *5 No credits given. Students must register each semester.
- *6 Students must take the Thesis Guidance course and pass oral and written exams of their master's thesis (please register for this course within the registration period of the semester during which you will submit a master's thesis).
- *7 Up to 10 credits from the following programs may be included into the graduation requirement.
 - 1) Credits from graduate courses taken as a graduate student in a university (pre-matriculation credits)
 - 2) Credits taken under the Graduate School Pre-admission Course Enrollment System at Sophia
 - 3) Credits received as a special auditing student (such as UNU)
 - 4) Credits transfer from a study abroad

【Master's Thesis Evaluation Criteria】

- 1) An evaluation will be conducted on the submitted thesis to determine whether the applicant has research competency in his/her area of specialization.
- 2) In the evaluation, attention will be given to the content, structure, and expressions of the thesis. Among others, reviewed are whether previous studies are adequately referenced and specified, quotes are accurately included, and data are properly processed.
- 3) An oral examination will be conducted on an extensive range of related subjects centering on the thesis to determine whether the applicant has gained precise and

in-depth scholarly knowledge from a broad perspective.

- 4) As regards foreign languages, we may specify one foreign language as the mandatory one and require the applicant to take a written examination. However, if the applicant is deemed to have adequate foreign language ability that would justify his/her earning a degree, he/she may be exempted from taking the whole or part of the examination. The criteria for exemption will have to be confirmed with the division to which the applicant belongs.

3. Course Structure and Credits

<Basic Courses of the School in Science and Technology>

Course Title	Credits		
	Compulsory	Compulsory elective	Elective
Master's Thesis Tutorial and Exercise 1A		1	
Master's Thesis Tutorial and Exercise 1B		1	
Master's Thesis Tutorial and Exercise 2A		1	
Master's Thesis Tutorial and Exercise 2B		1	
English for Science/Engineering A *1			2
English for Science/Engineering B			2

*1 Students who earned credit for “English for Science/Engineering 2(1)” cannot take “English for Science/Engineering A”.

<General Courses of the Graduate School in Science and Technology>

Course Title	Credits		
	Compulsory	Compulsory elective	Elective
Environmental Assessment *1			2
Environmental Resource Management Policy *1			2
Environment and Sustainable Lifestyles *1			2
Environmental Planning *1			2
Global Environment Outlook *1			2

*1 Courses offered by the Graduate School in Global Environmental Studies. These courses can be treated as courses provided by the Graduate School in Science and Technology

<Green Science and Engineering Division>

Course Title	Credits		
	Compulsory	Compulsory elective	Elective
Green Science and Engineering 1			2
Green Science and Engineering 2			2
Green Science and Engineering 3			2
Green Science and Engineering 4			2
Introduction to Artificial Intelligence			2
Advanced Mechanical Engineering 1			2
Advanced Mechanical Engineering 2			2
Advanced Electrical and Electronics Engineering 1			2
Advanced Electrical and Electronics Engineering 2			2
Environmental Chemistry			2
Advanced Materials			2
Theoretical Chemistry			2
Environmental Analytical Chemistry			2
Differential Equations for Natural Phenomena			2
Statistical Data Analysis			2
Environmental Atomic and Molecular Physics			2
Cosmonuclear Science			2
Environmental Basic Biology			2
Environmental Life Science			2
Computer Science			2
Applied Computer Science			2
Seminar in Green Science and Engineering 1A			2
Seminar in Green Science and Engineering 1B			2
Seminar in Green Science and Engineering 2A			2
Seminar in Green Science and Engineering 2B			2

4. List of Courses

<Basic Courses of the School in Science and Technology>

Registration Code	Course Numbering	Semester	Course Title	Credits	Instructor's name	Division	Notes
MSCT511E	SCT501	Not offered	Master's Thesis Tutorial and Exercise 1A	1	SAKAMOTO, Orie	Green Science and Engineering	*1
MSCT512E	SCT502	Not offered	Master's Thesis Tutorial and Exercise 1B	1	SAKAMOTO, Orie	Green Science and Engineering	*1
MSCT513E	SCT601	Not offered	Master's Thesis Tutorial and Exercise 2A	1	SAKAMOTO, Orie	Green Science and Engineering	*1
MSCT514E	SCT602	Not offered	Master's Thesis Tutorial and Exercise 2B	1	SAKAMOTO, Orie	Green Science and Engineering	*1
MSCT515E	SCT501	Not offered	Master's Thesis Tutorial and Exercise 1A	1	HAYASHITA, Takashi	Green Science and Engineering	*1
MSCT516E	SCT502	Not offered	Master's Thesis Tutorial and Exercise 1B	1	HAYASHITA, Takashi	Green Science and Engineering	*1
MSCT517E	SCT601	Not offered	Master's Thesis Tutorial and Exercise 2A	1	HAYASHITA, Takashi	Green Science and Engineering	*1
MSCT518E	SCT602	Spring	Master's Thesis Tutorial and Exercise 2B	1	HAYASHITA, Takashi	Green Science and Engineering	*1
MSCT519E	SCT501	Not offered	Master's Thesis Tutorial and Exercise 1A	1	IROHARA, Takashi	Green Science and Engineering	*1
MSCT520E	SCT502	Not offered	Master's Thesis Tutorial and Exercise 1B	1	IROHARA, Takashi	Green Science and Engineering	*1
MSCT521E	SCT601	Not offered	Master's Thesis Tutorial and Exercise 2A	1	IROHARA, Takashi	Green Science and Engineering	*1
MSCT522E	SCT602	Not offered	Master's Thesis Tutorial and Exercise 2B	1	IROHARA, Takashi	Green Science and Engineering	*1
MSCT523E	SCT501	Not offered	Master's Thesis Tutorial and Exercise 1A	1	TANAKA, Shoji	Green Science and Engineering	*1
MSCT524E	SCT502	Not offered	Master's Thesis Tutorial and Exercise 1B	1	TANAKA, Shoji	Green Science and Engineering	*1
MSCT525E	SCT601	Not offered	Master's Thesis Tutorial and Exercise 2A	1	TANAKA, Shoji	Green Science and Engineering	*1
MSCT526E	SCT602	Spring	Master's Thesis Tutorial and Exercise 2B	1	TANAKA, Shoji	Green Science and Engineering	*1
MSCT527E	SCT501	Not offered	Master's Thesis Tutorial and Exercise 1A	1	SUZUKI, Takashi	Green Science and Engineering	*1
MSCT528E	SCT502	Spring	Master's Thesis Tutorial and Exercise 1B	1	SUZUKI, Takashi	Green Science and Engineering	*1
MSCT529E	SCT601	Autumn	Master's Thesis Tutorial and Exercise 2A	1	SUZUKI, Takashi	Green Science and Engineering	*1

Registration Code	Course Numbering	Semester	Course Title	Credits	Instructor's name	Division	Notes
MSCT530E	SCT602	Not offered	Master's Thesis Tutorial and Exercise 2B	1	SUZUKI, Takashi	Green Science and Engineering	*1
MSCT531E	SCT501	Not offered	Master's Thesis Tutorial and Exercise 1A	1	MIYATAKE, Masafumi	Green Science and Engineering	*1
MSCT532E	SCT502	Spring	Master's Thesis Tutorial and Exercise 1B	1	MIYATAKE, Masafumi	Green Science and Engineering	*1
MSCT533E	SCT601	Autumn	Master's Thesis Tutorial and Exercise 2A	1	MIYATAKE, Masafumi	Green Science and Engineering	*1
MSCT534E	SCT602	Not offered	Master's Thesis Tutorial and Exercise 2B	1	MIYATAKE, Masafumi	Green Science and Engineering	*1
MSCT535E	SCT501	Not offered	Master's Thesis Tutorial and Exercise 1A	1	HORIKOSHI, Satoshi	Green Science and Engineering	*1
MSCT536E	SCT502	Not offered	Master's Thesis Tutorial and Exercise 1B	1	HORIKOSHI, Satoshi	Green Science and Engineering	*1
MSCT537E	SCT601	Not offered	Master's Thesis Tutorial and Exercise 2A	1	HORIKOSHI, Satoshi	Green Science and Engineering	*1
MSCT538E	SCT602	Not offered	Master's Thesis Tutorial and Exercise 2B	1	HORIKOSHI, Satoshi	Green Science and Engineering	*1
MSCT539E	SCT501	Not offered	Master's Thesis Tutorial and Exercise 1A	1	NAKASHIMA, Toshiki	Green Science and Engineering	*1
MSCT540E	SCT502	Spring	Master's Thesis Tutorial and Exercise 1B	1	NAKASHIMA, Toshiki	Green Science and Engineering	*1
MSCT541E	SCT601	Autumn	Master's Thesis Tutorial and Exercise 2A	1	NAKASHIMA, Toshiki	Green Science and Engineering	*1
MSCT542E	SCT602	Not offered	Master's Thesis Tutorial and Exercise 2B	1	NAKASHIMA, Toshiki	Green Science and Engineering	*1
MSCT7025	SCT702	Spring	English for Science/Engineering A	2	DZIEMIŃSKA, Edyta	-	*2
MSCT7045	SCT704	Autumn	English for Science/Engineering B	2	TRIHAN, Fabien	-	

*1 Master's Thesis Tutorial and Exercise 1A and 2A, 1B and 2B are consolidated.

*2 Students who earned credit for "English for Science/Engineering 2(1)" cannot take "English for Science/Engineering A".

<General Courses of the Graduate School in Science and Technology>

Registration Code	Course Numbering	Semester	Course Title	Credits	Instructor's name	Notes
MGGE7770	GES767	Spring	Environmental Assessment	2	HUANG, Guangwei	*1
MGGE7990	GES776	Spring	Environmental Resource Management Policy	2	SHIBATA, Shingo	*1
MGGE7680	GES758	Autumn	Environment and Sustainable Lifestyles	2	HIRAO, Keiko	*1
MGGE7750	GES766	Not offered	Environmental Planning	2	HUANG, Guangwei	*1
MGGE7650	GES753	Autumn	Global Environment Outlook	2	HUANG, Guangwei	*1

*1 Courses provided by the Graduate School in Global Environmental Studies. These courses can be treated as courses provided by the Graduate School in Science and Technology

<Green Science and Engineering Division>

Registration Code	Course Numbering	Semester	Course Title	Credits	Instructor's name	Notes
MSGR7010	GRS701	Not offered	Green Science and Engineering 1	2	undecided	
MSGR7020	GRS702	Spring	Green Science and Engineering 2	2	BRENNER, Tom FUJITA, Masahiro	
MSGR7030	GRS703	Autumn	Green Science and Engineering 3	2	ARAKI, Tsuyoshi GONSALVES, Tad	
MSGR7040	GRS704	Not offered	Green Science and Engineering 4	2	undecided	
MSGR7045	GRS721	Autumn	Introduction to Artificial Intelligence	2	GONSALVES, Tad	
MSGR7050	GRS705	Not offered	Advanced Mechanical Engineering 1	2	NAGASHIMA, Toshio (Coordinator)	
MSGR7060	GRS706	Autumn	Advanced Mechanical Engineering 2	2	MUTOH, Yasuhiko (Coordinator)	
MSGR7070	GRS707	Not offered	Advanced Electrical and Electronics Engineering 1	2	KATAYAMA, Kozo	
MSGR7080	GRS708	Autumn	Advanced Electrical and Electronics Engineering 2	2	KATAYAMA, Kozo	
MSGR7090	GRS709	Not offered	Environmental Chemistry	2	HORIKOSHI, Satoshi	
MSGR7100	GRS710	Autumn	Advanced Materials	2	ITATANI, Kiyoshi	
MSGR7110	GRS711	Not offered	Theoretical Chemistry	2	NANBU, Shinkoh	

Registration Code	Course Numbering	Semester	Course Title	Credits	Instructor's name	Notes
MSGR7120	GRS712	Autumn	Environmental Analytical Chemistry	2	HAYASHITA, Takashi	
MSGR7130	GRS713	Spring	Differential Equations for Natural Phenomena	2	NAKASUJI, Maki	
MSGR7140	GRS714	Autumn	Statistical Data Analysis	2	KATO, Takeshi	
MSGR7150	GRS715	Not offered	Environmental Atomic and Molecular Physics	2	AZUMA, Yoshiro	
MSGR7165	GRS722	Autumn	Cosmonuclear Science	2	WANAJO, Shinya	
MSGR7170	GRS717	Spring	Environmental Basic Biology	2	KONDO, Jiro	
MSGR7180	GRS718	Not offered	Environmental Life Science	2	SASAKAWA, Nobuyuki (Coordinator)	
MSGR7190	GRS719	Spring	Computer Science	2	MIYAMOTO, Yuichiro (Coordinator)	
MSGR7200	GRS720	Not offered	Applied Computer Science	2	TAMURA, Yasuhisa (Coordinator)	
MSGR1011	GRS501	Not offered	Seminar in Green Science and Engineering 1A	2	SAKAMOTO, Ori	*1
MSGR1022	GRS502	Not offered	Seminar in Green Science and Engineering 1B	2	SAKAMOTO, Ori	*1
MSGR2013	GRS601	Not offered	Seminar in Green Science and Engineering 2A	2	SAKAMOTO, Ori	*1
MSGR2024	GRS602	Not offered	Seminar in Green Science and Engineering 2B	2	SAKAMOTO, Ori	*1
MSGR1031	GRS501	Not offered	Seminar in Green Science and Engineering 1A	2	HAYASHITA, Takashi	*1
MSGR1042	GRS502	Not offered	Seminar in Green Science and Engineering 1B	2	HAYASHITA, Takashi	*1
MSGR2033	GRS601	Not offered	Seminar in Green Science and Engineering 2A	2	HAYASHITA, Takashi	*1
MSGR2044	GRS602	Spring	Seminar in Green Science and Engineering 2B	2	HAYASHITA, Takashi	*1
MSGR1051	GRS501	Not offered	Seminar in Green Science and Engineering 1A	2	IROHARA, Takashi	*1
MSGR1062	GRS502	Not offered	Seminar in Green Science and Engineering 1B	2	IROHARA, Takashi	*1
MSGR2053	GRS601	Not offered	Seminar in Green Science and Engineering 2A	2	IROHARA, Takashi	*1
MSGR2064	GRS602	Not offered	Seminar in Green Science and Engineering 2B	2	IROHARA, Takashi	*1

Registration Code	Course Numbering	Semester	Course Title	Credits	Instructor's name	Notes
MSGR1071	GRS501	Not offered	Seminar in Green Science and Engineering 1A	2	TANAKA, Shoji	*1
MSGR1082	GRS502	Not offered	Seminar in Green Science and Engineering 1B	2	TANAKA, Shoji	*1
MSGR2073	GRS601	Not offered	Seminar in Green Science and Engineering 2A	2	TANAKA, Shoji	*1
MSGR2084	GRS602	Spring	Seminar in Green Science and Engineering 2B	2	TANAKA, Shoji	*1
MSGR1091	GRS501	Not offered	Seminar in Green Science and Engineering 1A	2	SUZUKI, Takashi	*1
MSGR1102	GRS502	Spring	Seminar in Green Science and Engineering 1B	2	SUZUKI, Takashi	*1
MSGR2093	GRS601	Autumn	Seminar in Green Science and Engineering 2A	2	SUZUKI, Takashi	*1
MSGR2104	GRS602	Not offered	Seminar in Green Science and Engineering 2B	2	SUZUKI, Takashi	*1
MSGR1111	GRS501	Not offered	Seminar in Green Science and Engineering 1A	2	MIYATAKE, Masafumi	*1
MSGR1122	GRS502	Spring	Seminar in Green Science and Engineering 1B	2	MIYATAKE, Masafumi	*1
MSGR2113	GRS601	Autumn	Seminar in Green Science and Engineering 2A	2	MIYATAKE, Masafumi	*1
MSGR2124	GRS602	Not offered	Seminar in Green Science and Engineering 2B	2	MIYATAKE, Masafumi	*1
MSGR1131	GRS501	Not offered	Seminar in Green Science and Engineering 1A	2	HORIKOSHI, Satoshi	*1
MSGR1142	GRS502	Not offered	Seminar in Green Science and Engineering 1B	2	HORIKOSHI, Satoshi	*1
MSGR2133	GRS601	Not offered	Seminar in Green Science and Engineering 2A	2	HORIKOSHI, Satoshi	*1
MSGR2144	GRS602	Not offered	Seminar in Green Science and Engineering 2B	2	HORIKOSHI, Satoshi	*1
MSGR1151	GRS501	Not offered	Seminar in Green Science and Engineering 1A	2	NAKASHIMA, Toshiki	*1
MSGR1162	GRS502	Spring	Seminar in Green Science and Engineering 1B	2	NAKASHIMA, Toshiki	*1
MSGR2153	GRS601	Autumn	Seminar in Green Science and Engineering 2A	2	NAKASHIMA, Toshiki	*1
MSGR2164	GRS602	Not offered	Seminar in Green Science and Engineering 2B	2	NAKASHIMA, Toshiki	*1

*1 Seminar in Green Science and Engineering 1A and 2A, 1B and 2B are consolidated.

* Although the language of instruction for the following courses are different, courses listed here are regarded as identical courses. The students may only take one of the two courses.

Course title (Cr.)	Course offered by other divisions ※(Cr.)	Remarks(Division)
Advanced Materials (2)	無機製造工学特論 (2)	応用化学領域
Theoretical Chemistry (2)	物理化学特論 (理論化学) (2)	化学領域
Environmental Analytical Chemistry (2)	分析化学特論 (超分子化学) (2)	化学領域

5. Thesis Guidance List

Registration Code	Course Numbering	Semester	Course Title	Instructor's name	Division	Notes
MSCTE011	SCT888	Autumn	Thesis Guidance	MIYATAKE, Masafumi	Green Science and Engineering	
MSCTE012	SCT888	Spring	Thesis Guidance	MIYATAKE, Masafumi	Green Science and Engineering	
MSCTE021	SCT888	Not offered	Thesis Guidance	HAYASHITA, Takashi	Green Science and Engineering	
MSCTE022	SCT888	Spring	Thesis Guidance	HAYASHITA, Takashi	Green Science and Engineering	
MSCTE031	SCT888	Not offered	Thesis Guidance	IROHARA, Takashi	Green Science and Engineering	
MSCTE032	SCT888	Not offered	Thesis Guidance	IROHARA, Takashi	Green Science and Engineering	
MSCTE041	SCT888	Not offered	Thesis Guidance	TANAKA, Shoji	Green Science and Engineering	
MSCTE042	SCT888	Spring	Thesis Guidance	TANAKA, Shoji	Green Science and Engineering	
MSCTE051	SCT888	Autumn	Thesis Guidance	SUZUKI, Takashi	Green Science and Engineering	
MSCTE052	SCT888	Spring	Thesis Guidance	SUZUKI, Takashi	Green Science and Engineering	
MSCTE061	SCT888	Not offered	Thesis Guidance	HORIKOSHI, Satoshi	Green Science and Engineering	
MSCTE062	SCT888	Not offered	Thesis Guidance	HORIKOSHI, Satoshi	Green Science and Engineering	
MSCTE071	SCT888	Autumn	Thesis Guidance	NAKASHIMA, Toshiki	Green Science and Engineering	
MSCTE072	SCT888	Spring	Thesis Guidance	NAKASHIMA, Toshiki	Green Science and Engineering	
MSCT910E	SCT899	Not offered	Master's Thesis	Supervisor	Green Science and Engineering	
MSCT900E	SCT899	Spring	Master's Thesis	Supervisor	Green Science and Engineering	

Ph.D. CURRICULUM

Ph.D. in Green Science and Engineering Division

1. Instruction

- 1) To be eligible to receive a Ph.D. degree, students must complete at least 2 credits of coursework, submit a Ph.D. dissertation, and pass oral and written exams.

The required credits are as follows.

Compulsory elective courses: 2 credits

- 2) Students must register the Thesis Guidance (required course) each semester.

2. Requirements for Courses, Credits, Number of courses

Core curriculum	Credits	Number of courses	Notes
Total credits	2		
Compulsory elective courses	2		
-DR. Dissertation Tutorial and Exercise 3A	1		
-DR. Dissertation Tutorial and Exercise 3B	1		
-DR. Dissertation Tutorial and Exercise 4A	1		
-DR. Dissertation Tutorial and Exercise 4B	1		
-DR. Dissertation Tutorial and Exercise 5A	1		
-DR. Dissertation Tutorial and Exercise 5B	1		
Thesis Guidance(Compulsory)			*1
Ph.D. Dissertation			*2

*1 No credits given. Students must register each semester.

*2 Students must take the Thesis Guidance course and pass oral and written exams of their Ph.D.

dissertation (please register for this course within the registration period for the semester during which you will submit a Ph.D. dissertation).

【Doctoral Dissertation Evaluation Criteria】

- 1) An evaluation will be conducted on the submitted dissertation to determine whether the applicant has conducted research independently in his/her area of specialization or has research competency required for engaging in other highly technical activities.
- 2) In the evaluation, attention will be given to the following:
 - (1) The content of the dissertation (whether the dissertation has sufficient academic value, including originality, novelty of knowledge, and usefulness)
 - (2) The format of the dissertation (whether the structure or expressions of the dissertation are appropriate or not)
- 3) An oral examination will be conducted on an extensive range of related subjects centering on the dissertation to determine whether the applicant has gained wide and in-depth scholarly knowledge that would serve as the foundation for high-level research competency required to conduct research independently in his/her area of specialization.

- 4) As regards foreign languages, we may specify one foreign language as the mandatory one and require the applicant to take a written examination. However, if the applicant is deemed to have adequate foreign language ability that would justify his/her earning a degree, he/she may be exempted from taking the whole or part of the examination. The criteria for exemption will have to be confirmed with the division to which the applicant belongs.

3. Course Structure and Credits

Course Title	Credits		
	Compulsory	Compulsory elective	Elective
DR. Dissertation Tutorial and Exercise 3A		1	
DR. Dissertation Tutorial and Exercise 3B		1	
DR. Dissertation Tutorial and Exercise 4A		1	
DR. Dissertation Tutorial and Exercise 4B		1	
DR. Dissertation Tutorial and Exercise 5A		1	
DR. Dissertation Tutorial and Exercise 5B		1	

4. List of Courses

Registration Code	Course Numbering	Semester	Course Title	Credits	Instructor's name	Division	Notes
DSCTE001	SCT901	Not offered	DR. Dissertation Tutorial and Exercise 3A	1	SHEN, Tielong	Green Science and Engineering	*1
DSCTE002	SCT902	Not offered	DR. Dissertation Tutorial and Exercise 3B	1	SHEN, Tielong	Green Science and Engineering	*1
DSCTE003	SCT903	Not offered	DR. Dissertation Tutorial and Exercise 4A	1	SHEN, Tielong	Green Science and Engineering	*1
DSCTE004	SCT904	Spring	DR. Dissertation Tutorial and Exercise 4B	1	SHEN, Tielong	Green Science and Engineering	*1
DSCTE005	SCT905	Autumn	DR. Dissertation Tutorial and Exercise 5A	1	SHEN, Tielong	Green Science and Engineering	*1
DSCTE006	SCT906	Spring	DR. Dissertation Tutorial and Exercise 5B	1	SHEN, Tielong	Green Science and Engineering	*1
DSCTE007	SCT901	Not offered	DR. Dissertation Tutorial and Exercise 3A	1	IROHARA, Tskashi	Green Science and Engineering	*1

Registration Code	Course Numbering	Semester	Course Title	Credits	Instructor's name	Division	Notes
DSCTE008	SCT902	Spring	DR. Dissertation Tutorial and Exercise 3B	1	IROHARA, Tskashi	Green Science and Engineering	*1
DSCTE009	SCT903	Autumn	DR. Dissertation Tutorial and Exercise 4A	1	IROHARA, Tskashi	Green Science and Engineering	*1
DSCTE010	SCT904	Not offered	DR. Dissertation Tutorial and Exercise 4B	1	IROHARA, Tskashi	Green Science and Engineering	*1
DSCTE011	SCT905	Not offered	DR. Dissertation Tutorial and Exercise 5A	1	IROHARA, Tskashi	Green Science and Engineering	*1
DSCTE012	SCT906	Spring	DR. Dissertation Tutorial and Exercise 5B	1	IROHARA, Tskashi	Green Science and Engineering	*1
DSCTE013	SCT901	Not offered	DR. Dissertation Tutorial and Exercise 3A	1	MIYATAKE, Masafumi	Green Science and Engineering	*1
DSCTE014	SCT902	Not offered	DR. Dissertation Tutorial and Exercise 3B	1	MIYATAKE, Masafumi	Green Science and Engineering	*1
DSCTE015	SCT903	Not offered	DR. Dissertation Tutorial and Exercise 4A	1	MIYATAKE, Masafumi	Green Science and Engineering	*1
DSCTE016	SCT904	Not offered	DR. Dissertation Tutorial and Exercise 4B	1	MIYATAKE, Masafumi	Green Science and Engineering	*1
DSCTE017	SCT905	Not offered	DR. Dissertation Tutorial and Exercise 5A	1	MIYATAKE, Masafumi	Green Science and Engineering	*1
DSCTE018	SCT906	Spring	DR. Dissertation Tutorial and Exercise 5B	1	MIYATAKE, Masafumi	Green Science and Engineering	*1
DSCTE019	SCT901	Not offered	DR. Dissertation Tutorial and Exercise 3A	1	KIKUCHI, Akihiko	Green Science and Engineering	*1
DSCTE020	SCT902	Spring	DR. Dissertation Tutorial and Exercise 3B	1	KIKUCHI, Akihiko	Green Science and Engineering	*1
DSCTE021	SCT903	Autumn	DR. Dissertation Tutorial and Exercise 4A	1	KIKUCHI, Akihiko	Green Science and Engineering	*1

Registration Code	Course Numbering	Semester	Course Title	Credits	Instructor's name	Division	Notes
DSCTE022	SCT904	Not offered	DR. Dissertation Tutorial and Exercise 4B	1	KIKUCHI, Akihiko	Green Science and Engineering	*1
DSCTE023	SCT905	Not offered	DR. Dissertation Tutorial and Exercise 5A	1	KIKUCHI, Akihiko	Green Science and Engineering	*1
DSCTE024	SCT906	Not offered	DR. Dissertation Tutorial and Exercise 5B	1	KIKUCHI, Akihiko	Green Science and Engineering	*1
DSCTE025	SCT901	Not offered	DR. Dissertation Tutorial and Exercise 3A	1	HORIKOSHI, Satoshi	Green Science and Engineering	*1
DSCTE026	SCT902	Spring	DR. Dissertation Tutorial and Exercise 3B	1	HORIKOSHI, Satoshi	Green Science and Engineering	*1
DSCTE027	SCT903	Autumn	DR. Dissertation Tutorial and Exercise 4A	1	HORIKOSHI, Satoshi	Green Science and Engineering	*1
DSCTE028	SCT904	Not offered	DR. Dissertation Tutorial and Exercise 4B	1	HORIKOSHI, Satoshi	Green Science and Engineering	*1
DSCTE029	SCT905	Not offered	DR. Dissertation Tutorial and Exercise 5A	1	HORIKOSHI, Satoshi	Green Science and Engineering	*1
DSCTE030	SCT906	Not offered	DR. Dissertation Tutorial and Exercise 5B	1	HORIKOSHI, Satoshi	Green Science and Engineering	*1

*1 DR. Dissertation Tutorial and Exercise 3A and 4A and 5A, 3B and 4B and 5B are consolidated.

5. Thesis Guidance List

Registration Code	Course Numbering	Semester	Course Title	Instructor's name	Division	Notes
DSCTE702	SCT988	Spring	Thesis Guidance	SHEN, Tielong	Green Science and Engineering	
DSCTE701	SCT988	Autumn	Thesis Guidance		Green Science and Engineering	
DSCTE704	SCT988	Spring	Thesis Guidance	IROHARA, Tskashi	Green Science and Engineering	
DSCTE703	SCT988	Autumn	Thesis Guidance		Green Science and Engineering	
DSCTE706	SCT988	Spring	Thesis Guidance	MIYATAKE, Masafumi	Green Science and Engineering	
DSCTE705	SCT988	Not offered	Thesis Guidance		Green Science and Engineering	
DSCTE708	SCT988	Spring	Thesis Guidance	KIKUCHI, Akihiko	Green Science and Engineering	
DSCTE707	SCT988	Autumn	Thesis Guidance		Green Science and Engineering	
DSCTE710	SCT988	Spring	Thesis Guidance	SUZUKI, Noriyuki	Green Science and Engineering	
DSCTE709	SCT988	Autumn	Thesis Guidance		Green Science and Engineering	

FACULTY OFFICES

Graduate School in Science and Technology Dean's Office 4-590 (ex. 3300)

Name	Room
Adachi, Tadashi	4-291B
Arai, Takayuki	4-290
Araki, Tsuyoshi	3-116
Azuma, Yoshiro	4-391B
Bandai, Masaki	1-301B
Brenner, Tom	3-113
Chiba, Atsuhiko	8-403B
Danielache, Sebastian Oscar	3-331
Dziemińska, Edyta	3-231
Ema, Kazuhiro	3-345A
Endo, Akira	3-441A
Fujii, Mamiko	1-120A
Fujita, Masahiro	4-373A
Fujiwara, Makoto	4-286
Furuya, Shinichi	1-208A
Gomi, Yasushi	1-407
Gonsalves, Tad	1-209B
Goto, Satoshi	1-401B
Goto, Takayuki	3-335B
Hashimoto, Takeshi	3-439
Hayashi, Hitoshi	1-118B
Hayashi, Kensuke	8-404B
Hayashita, Takashi	3-441B
Hirano, Tetsufumi	4-385B
Hirata, Hitoshi	1-403
Hisamori, Noriyuki	KH-426
Horikoshi, Satoshi	8-402A
Hoshino, Masamitsu	4-385A
Ichiyanagi, Mitsuhisa	3-138
Irohara, Takashi	KH-528
Itatani, Kiyoshi	3-445B
Ito, Kiyoshi	1-207B
Kanzawa, Nobuyuki	3-433
Katayama, Kozo	3-118
Kato, Takeshi	1-412
Kawabata, Ryo	1-208B
Kawaguchi, Mari	4-581
Kawanaka, Akira	1-310
Kikawada, Yoshikazu	4-482
Kikuchi, Akihiko	4-292
Kishino, Katsumi	3-235
Kobayashi, Kenichiro	4-593B
Kondo, Jiro	4-383B
Kunugita, Hideyuki	3-342
Kuroe, Haruhiko	3-341A
Kuwahara, Hideki	4-381
Kuze, Nobuhiko	4-497
Makino, Osamu	8-403A
Masuyama, Yoshiro	4-491A
Miyamoto, Yuichiro	TBA
Miyatake, Masafumi	3-243B
Mizugai, Yoshihiro	3-340
Muto, Yasuhiko	3-137A
Nagao, Hirotaka	4-491B
Nagashima, Toshio	3-145A
Nakamura, Kazuya	4-296
Nakaoka, Toshihiro	3-023

Name	Room
Nakashima, Toshiki	1-410
Nakasuji, Maki	1-414
Nanbu, Shinkoh	8-401A
Niikura, Takako	8-405B
Nomura, Ichiro	3-245A
Odagiri, Takeshi	4-291A
Ogawa, Masakatsu	1-307B
Ohtsuki, Tomi	4-389A
Oi, Takao	8-401B
Okada, Kunihiro	4-387B
Oshiro, Kanako	1-416
Rikukawa, Masahiro	4-481
Chairperson Saito, Tamao	3-531
Sakama, Hiroshi	3-341B
Sakamoto, Haruhisa	KH-329
Sakamoto, Oriie	3-241B
Sasakawa, Nobuyuki	8-405A
Shen, Tielong	3-137B
Shibuya, Tomoharu	1-405
Shimomura, Kazuhiko	3-239A
Suemasu, Hiroshi	3-143B
Sumi, Chikayoshi	1-017C
Suzuki, Hiroshi	MH-115E
Suzuki, Nobuhiro	4-582
Suzuki, Noriyuki	TBA
Suzuki, Takashi	3-135B
Suzuki, Yumiko	3-435B
Takahashi, Hiroshi	1-110
Takahashi, Kazuo	4-495B
Takai, Kenichi	KH-428
Takao, Tomoaki	3-241A
Takaoka, Eiko	IR-303
Takayanagi, Kazuo	4-383A
Takehara, Shoichiro	KH-326
Takeoka, Yuko	4-485
Tamura, Yasuhisa	1-309B
Tanaka, Hidetake	KH-327
Tanaka, Kunihiro	4-493
Tanaka, Shoji	1-302
Terumichi, Yoshiaki	3-143A
Trihan, Fabien	1-418
Tsuji, Hajime	1-409
Dean Tsukiji, Tetsuhiro	3-135A
Tsunogai, Hiroshi	1-406
Tsuzuki, Masao	1-411
Uchida, Hiroshi	3-446
Usuki, Toyonobu	4-474A
Waho, Takao	4-284A
Wanajo, Shinya	3-117
Watanabe, Mariko	3-133B
Yagai, Tsuyoshi	4-190
Yairi, Ikuko	1-401C
Yamanaka, Takao	1-202
Yasumasu, Shigeki	3-525

※ “I” = Ichigaya Campus Main Building
 “IR” = Ichigaya Campus Research Building
 “KH” = Krupp Hall
 “MH” = Machine Hall

International Graduate Course in Global Environmental Studies

Education and Research Objectives and Human Resource Development

For the resolution of global environmental issues, we are aimed to develop human resources with high levels of knowledge on social and natural sciences, high sense of mission and excellent skills in combining theory with practice.

A particular focus for Master course is to prepare our students to become highly competitive professionals in an increasingly complex society and world.

A particular focus for PhD course is to produce human resources that can conduct world class level of education and research on global environment.

Curriculum Policy

[Master's Program]

The curriculum is developed to emphasize the following point of view.

1. Interdisciplinary Curriculum that addresses environmental problems from the perspectives of both natural and social sciences.
2. Acquisition of the intellectual capability for problem identification, learning a well-balanced practical knowledge or practical skills for problem solving.
3. Although environmental studies involve a wide range of areas, compact curriculum is our philosophy. By avoiding small details, the whole structure of our curriculum becomes much transparent and easy for students to understand and follow what are essential.
4. To facilitate the learning of working students, night lectures and lectures on Saturday are provided. Under such a system, working students may obtain all required credits without quitting their jobs.
5. In the need for international cooperation to solve global environmental problems, teaching and research guidance in English are promoted.
6. It is also characterized by small-group teaching and good communication between lecturers and students.

[Doctoral Program]

Nurture highly competitive researchers for global environmental studies and highly skilled professionals for dealing with practical problems.

Diploma Policy

[Master's Program]

Enrolled in the course for the designated period of time, attending lectures, which are designed for students to acquire all necessary knowledge and better understanding for seeking solutions of environmental problems.

Under the guidance of supervisors, work out a master's thesis that meets the criteria such as the following. Students who pass the oral exam will be awarded a master's degree.

1. Research theme should be determined appropriately in order to solve today's environmental issues.
2. Literature survey is sufficiently conducted and the state of the art is well explained.
3. Original hypothesis is appropriately established toward problem solving.
4. Facts are collected and approaches for hypothesis testing are properly selected.
5. Consistent logic is adopted to validate the hypothesis.
6. The analysis is comprehensively conducted and the findings are successfully summarized.
7. Foreign language proficiency, which is considered necessary for study, must be achieved.

[Doctoral Program]

Enrolled in the course for the designated period of time, candidates must conduct high level of research work under the guidance of supervisors, and submit a doctoral thesis to prove to have the capability as independent researcher. Those who pass the defense awarded a Ph. D. degree.

Note: The English translation is provided for information. The original Japanese version remains the sole official version. If there is any discrepancy between the two versions, the Japanese original should take precedence.

GRADUATE PROGRAM IN GLOBAL ENVIRONMENTAL STUDIES OVERVIEW

The Graduate School of Global Environmental Studies (GSGES) was established in 2005 to focus specifically on environmental problems, an area which we consider as one of the greatest challenges facing humanity today. The curriculum combines social and natural sciences, in recognition of the fact that effective environmental studies spans a number of scholastic disciplines including law, policy, administration, economics, population, energy and engineering. The school is devoted to fostering graduates able to serve society effectively as business persons, professionals, consultants or scholars in the area of environmental protection, conservation and sustainability.

International Graduate Course

The International Graduate Course in Global Environmental Studies (IGCGES) commenced in September of 2011. IGCGES provides educational programs for students who intend to obtain degrees in English. No knowledge or proficiency in Japanese is needed as all seminars, lectures and guidance are conducted in English. The curriculum consists of three fields: 1) Economics and Business Administration for the Environment; 2) Law, Policies and Sociology for the Environment; 3) Science and Engineering for the Environment. One of the strategies of IGCGES is to enhance the capacity of students to contribute to the solving of current environmental issues through a variety of practical and discipline specific programs. Moreover, we intend to collaborate with the Graduate School of Science and Technology and Graduate School of Economics so as to create an integrated and interdisciplinary curriculum.

1. DEGREES

IGCGES offers two degrees: M.A. and Ph.D.—both of which are accredited by the Ministry of Education, Culture, Sports, Science and Technology (MEXT). Both the M.A. and Ph.D. degrees focus on the study of environmental issues and processes from both social science and natural science perspectives.

The ultimate aim of IGCGES is to develop highly effective human resources capable of tackling environmental and sustainability issues from the local to global levels of diverse situations and locations.

2. CURRICULUM

From the natural sciences to the humanities, students are free to choose classes suited to their interests, background and future career aspirations from a wide range of courses covering diverse aspects of global environmental issues. This flexibility means that students may in effect create their own curriculum chart and timetable. Another feature of the ICGGES curriculum is the small class sizes, with student numbers ranging from two to ten per seminar or lecture. This ensures that students will be able to receive devoted, passionate and student needs-focused instruction from experienced professors.

The M.A. degree has two tracks, with each track having different graduation requirements. Students in the credit track concentrate on obtaining course credits and must complete a graduation project report while those in the thesis track write an in-depth master's thesis. All students enter the ICGGES on the thesis track. After the first semester students can transfer to the credit-project track.

Although the language of instruction is English, ICGGES students are permitted to take courses from the Japanese curriculum of the Graduate Program in Global Environmental Studies. These may be counted as official credits towards ICGGES degree requirements. All students in ICGGES are required to write their graduation project report or master's thesis in English.

Doctoral students will work on their dissertation under the guidance of a supervisor. While no formal course work is required, doctoral candidates are encouraged to participate in numerous workshops and other program activities and may, in consultation with their supervisor, attend regular courses.

3. FACILITIES

ICGGES and GSGES graduate students have access to the GSGES study rooms, computer facilities and provides students with on-campus lockers for storing materials. In addition, graduate students can use the university computer rooms, cafeterias, gymnasium and athletic fields, medical and counseling facilities. As with all urban universities in Japan, Sophia University has several off campus dormitories and affiliated dormitories in and around the Tokyo area.

M.A. CURRICULUM

M.A in Global Environmental Studies

The diverse courses for the International Graduate Course in Global Environmental Studies are designed to provide students with a holistic understanding of the multiple and complex factors that have contributed to the global environmental crisis. Whether in the natural sciences or humanities, students are free to choose classes suited to their interests, background and future career aspirations from a wide range of courses covering diverse aspects of global environment issues. This flexibility means that students may in effect create their own curriculum chart and timetable. Another feature of the ICGES curriculum is the small class sizes, with student numbers ranging from two to as many as ten per seminar. This ensures that students will be able to receive devoted, compassionate and student needs focused instruction from experienced professors.

1. Completion Requirements

【Students who entered in April 2016 or after】

<Thesis-track>

Requirements	Required credits	Remarks
Total credits	30	
<ul style="list-style-type: none"> ▸Compulsory Elective <ul style="list-style-type: none"> ↳Seminar I, II, III, IV 	8	Up to 12 credits from Seminar I, II, III and/or IV may be counted towards the total 30 credits required for Master's degree.
<ul style="list-style-type: none"> ▸Electives <ul style="list-style-type: none"> ↳Courses offered at GSGES ↳Courses offered at UNU 	22	
Research Guidance (compulsory)		Non-credit but compulsory. All students are required to register for Research Guidance with their selected advisor from second semester and all subsequent semesters.
Master's Thesis		Must register for Master's Thesis during the course registration period of the final semester when student plans to submit and defend thesis.

<Credit-track>

Requirements	Required credits	Remarks
Total credits	34	
<ul style="list-style-type: none"> ▸Compulsory Elective <ul style="list-style-type: none"> ↳Seminar I, II, III, IV 	4	Up to 8 credits from Seminar I, II, III and/or IV may be counted towards the total 34 credits required for Master's degree.

Requirements	Required credits	Remarks
▸Electives	30	
↳Courses offered at GSGES		
↳Courses offered at UNU		2 credits taken at UNU may be included into Elective Courses with an approval from the Director. For procedures, consult the Center for Academic Affairs.
Research Guidance (compulsory)		No credit but compulsory. All students are required to register for Research Guidance with their selected advisor from second semester and all subsequent semesters.
Graduation Project		Must register for Graduation Project during the course registration period of the final semester. Project will be submitted as a final graduation paper, which will be evaluated for successful completion of credit-track.

【Students who entered in April 2014 and 2015】

<Thesis-track>

Requirements	Required credits	Remarks
Total credits	30	
▸Compulsory	8	
↳Seminar I, II, III, IV		Up to 12 credits from Seminar I, II, III and/or IV may be counted towards the total 30 credits required for Master's degree.
▸Electives	22	
↳Courses offered at GSGES		
↳Courses offered at UNU		2 credits taken at UNU may be included into Elective Courses with an approval from the Director. For procedures, consult the Center for Academic Affairs.
Research Guidance (compulsory)		Non-credit but compulsory. All students are required to register for Research Guidance with their selected advisor from second semester and all subsequent semesters.
Master's Thesis		Must register for Master's Thesis during the course registration period of the final semester when student plans to submit and defend thesis.

<Credit-track>

Requirements	Required credits	Remarks
Total credits	34	
▸Compulsory	4	
↳Seminar I, II, III, IV		Up to 8 credits from Seminar I, II, III and/or IV may be counted towards the total 34 credits required for Master's degree.
▸Electives	30	
↳Courses offered at GSGES		
↳Courses offered at UNU		2 credits taken at UNU may be included into Elective Courses with an approval from the Director. For procedures, consult the Center for Academic Affairs.
Research Guidance (compulsory)		No credit but compulsory. All students are required to sign up for Research Guidance with their selected advisor from second semester and all subsequent semesters.
Graduation Project		Must register for Graduation Project during the course registration period of the final semester. Project will be submitted as a final graduation paper, which will be evaluated for successful completion of credit-track.

【 Students who entered before 2014】

< Thesis-track >

Requirements	Required credits	Remarks
Total credits	30	
▸ Compulsory	4	
↳ Thesis Seminar	4	Register during course registration period of the semester in which student plans to submit and defend Master's thesis.
▸ Electives	26	
↳ Courses offered at GSGES		
↳ Courses offered at UNU		2 credits taken at UNU may be included into Elective Courses with an approval from the Director. For procedures, consult the Center for Academic Affairs.
Research Guidance (compulsory)		Non-credit but compulsory. Students who entered in 2012 must register for Research Guidance every semester. Students who entered in 2013 must register for Research Guidance from their second semester and all subsequent semesters.
Master's Thesis		Must register for Master's Thesis during the course registration period of the final semester when student plans to submit and defend thesis.

< Credit-track >

Requirements	Required credits	Remarks
Total credits	30	
▸ Electives	30	
↳ Courses offered at GSGES		
↳ Courses offered at UNU		2 credits taken at UNU may be included into Elective Courses with an approval from the Director. For procedures, consult the Center for Academic Affairs.
Research Guidance (compulsory)		Non-credit but compulsory. Students who entered in 2012 must register for Research Guidance every semester. Students who entered in 2013 must register for Research Guidance from second semester and all subsequent semesters.
Graduation Project		Must register for Graduation Project during the course registration period of the final semester. Project will be submitted as a final graduation paper, which will be evaluated for successful completion of credit-track.

2. Criteria for the Evaluation of Master's Thesis

1. Thesis topic: The thesis shall address the reason(s) for the selection of a thesis topic and justify the appropriateness of the topic in the research area.
2. Previous studies: The thesis shall sufficiently cover previous studies on the selected topic and exhibit them in an organized manner.
3. Originality: The thesis shall illustrate original, unique aspects of research. Presentation of new research findings is an example of such aspects.
4. Research method: The thesis shall succinctly describe a research method, collected data, and materials.
5. Thesis structure: The thesis shall clearly exhibit the structure of the contents of the thesis and the logical

- flow of research. There shall be consistency among the thesis topic, the hypothesis, and the conclusion.
6. Ethical standards: The thesis shall consider ethical standards with respect to research methods and the target(s) of analysis. The thesis shall meet the ethical standards established by the university and the academic community.
 7. Format: The thesis shall sufficiently cover materials related to the thesis topic and clearly indicate sources of information and data in citations and in a list of references.
- * Evaluation Criteria for Graduation Project will be announced later.

3. Curriculum Structure/credits [applicable to all matriculation years]

Course Title	Course Title in Japanese	Credits		
		Compulsory	Compulsory elective	Elective
Thesis Seminar *1	論文演習	(4)		
Environmental Economics	環境経済学			2
Strategic Environmental Management	戦略的環境マネジメント			2
Environment and Development in Developing Countries	環境と開発			2
Climate Change Policy	地球温暖化対策論			2
Environmental Administration	環境行政論			2
Global Environmental Policy	地球環境政策論			2
Integrative Environmental Policy	総合環境政策論			2
Environmental History	環境歴史学			2
Japanese Environmental Law	日本の環境法			2
International Environmental Treaties	国際環境条約論			2
Environment and Sustainable Lifestyles	環境と持続のためのライフスタイル			2
Ecology and the Environment	生物と環境			2
Chemical Substances and the Environment	化学物質と環境			
Environmental Assessment	環境アセスメント論			2
Environmental Planning	環境計画論			2
Global Environment Outlook	地球環境概論			2
Japanese Experiences in Environmental Management	日本の環境管理			2
Ocean and Environment	海洋と環境			2
Marine Environmental Policy	海洋環境政策			2
Business Strategies for Sustainability	サステイナビリティのビジネス戦略			2
Environmental Resource Management Policy	環境資源管理政策			2
Global Forest Conservation Policy	世界の森林保全政策			2
Introduction to Environmental Accounting	環境会計入門			2
Green Marketing	環境マーケティング			2
Environment and Supply Chain Management	環境とサプライチェーンマネジメント			2
Recycling Systems in Asia	アジア地域の循環システム			2
Energy and Environmental Technology	環境・エネルギー技術論			2
Seminar I*2	演習 I	(2)	2	
Seminar II*2	演習 II	(2)	2	
Seminar III*2	演習 III	(2)	2	
Seminar IV*2	演習 IV	(2)	2	
Corporate Finance *3	(他) 金融論特講			4
English for Science / Engineering A*4	(他) 科学技術英語A			2

Course Title	Course Title in Japanese	Credits		
		Compulsory	Compulsory elective	Elective
English for Science / Engineering B*4	(他) 科学技術英語B			2
Environmental Chemistry *4	(他) 環境科学			2
Environmental Life Science *4	(他) 環境生命科学			2
Environmental Basic Biology *4	(他) 環境基礎生物学			2
Green Science and Engineering 1 *4	(他) グリーンサイエンス・エンジニアリング1			2
Green Science and Engineering 2 *4	(他) グリーンサイエンス・エンジニアリング2			2
Green Science and Engineering 3 *4	(他) グリーンサイエンス・エンジニアリング3			2
Green Science and Engineering 4 *4	(他) グリーンサイエンス・エンジニアリング4			2

*1 Courses offered only for 2012 and 2013 enrolled students

*2 Compulsory for the students who entered before 2015

*3 Offered by the Graduate Program in Economics

*4 Offered by the Graduate Program in Science and Technology

Course Title	Credits		
	Compulsory	Compulsory elective	Elective
演習A※注1	(2)	2	
演習B※注1	(2)	2	
演習C※注1	(2)	2	
演習D※注1	(2)	2	
日本の環境法			2
環境リスクマネジメント			2
環境経済学Ⅰ			2
環境経済学Ⅱ			2
森林環境政策			2
環境政策論			2
環境工学			2
化学物質と環境			2
生物と環境			2
環境金融論			2
環境マーケティング			2
国際環境法			2
循環型社会形成・廃棄物対策論			2
環境経営学			2
環境と経済制度			2
地球温暖化対策論			2
CSR経営			2
地球環境工学論			2
環境研究のための統計学			2
ジェンダーと環境			2
アジア環境研修			4
環境社会学			2

Course Title	Credits		
	Compulsory	Compulsory elective	Elective
途上国の環境と開発			2
エネルギーと環境			2
環境行政論			2
環境と消費			2
カーボンマネジメント論			2
環境倫理			2
環境教育			2
環境史			2
環境研究のフロンティア			2
環境・エネルギー技術論			2
環境計画・リスクマネジメント論			2
インターンシップⅠ			2
インターンシップⅡ			2
(他) 環境法政策 ※注2			2
(他) 比較環境法 ※注2			2
(他) 環境訴訟 ※注2			2
(他) 環境会計論特講 ※注3			2

*注1：2015年次生以前は必修科目

*注2：法科大学院開講科目

*注3：経営学専攻開講科目

4. Notes about Course Enrollment

1) Completion Requirements

Students enrolled in the International Graduate Course are automatically registered for Thesis-track upon entering the graduate school. Those students interested in changing to the Credit-track are required to submit a formal letter of intent during designated period using the official format to the academic supervisor they intend to receive guidance from for their research and writing.

【Students who entered in April 2016 or after】

A. Thesis-track

- 1) Must earn 8 credits in “Seminar” or “演習” (Enshu) (Compulsory elective). The sequence of the Seminars does not have to be in order. At least 4 credits earned for Seminar or 演習(Enshu) must be taught by the chosen academic supervisor. Up to 12 credits from Seminar I, II, III and/or IV may be approved as completion requirements and up to 4 credits may be included into Electives. You may repeatedly register for the same Seminar/演習 (Enshu) offered by the same instructor; although these additional credits may not be counted towards the completion requirements unless special circumstances with a permission from the Chairperson exist.
- 2) Must earn 22 credits of Electives.
- 3) Must register for Research Guidance (Compulsory) in the second semester and all subsequent semesters.
- 4) Must register for Graduation Project in final semester and submit a research paper.

B. Credit-track

- 1) Must earn 4 credits in “Seminar” or “演習” (Enshu) (Compulsory elective) instructed by the academic supervisor. The sequence of the Seminars does not have to be in order. Up to 8 credits from Seminar I, II, III and/or IV may be included into completion requirements and up to 4 credits may be counted towards Electives. You may repeatedly take the same Seminar/演習 (Enshu) offered by the same instructor; although these additional credits may not be included into the completion requirements unless special circumstances with a permission from the Chairperson exist.
- 2) Must earn 30 credits from Electives.
- 3) Must register for Research Guidance (Compulsory) in the second semester and all subsequent semesters.
- 4) Must register for Master’s Thesis in the final semester, complete the Master’s Thesis under the guidance of the academic supervisor and successfully defend before judgment committee.

【Students who entered in April 2014 and 2015】

A. Thesis-track

- 1) Must earn 8 credits in “Seminar” or “演習”(Enshu) (Compulsory). The sequence of the Seminars does not have to be in order. At least 4 credits earned for Seminar or 演習 (Enshu) must be taught by the chosen academic supervisor. Up to 12 credits from Seminar I, II, III and/or IV may be included into completion requirements and up to 4 credits may be applied to Electives. You may repeatedly register for the same Seminar/演習 (Enshu) offered by the same instructor; although these additional credits may not be counted towards the completion requirements unless special circumstances with a permission from the Chairperson exist.
- 2) Must earn 22 credits from Electives.
- 3) Must register for Research Guidance (Compulsory) in the second semester and all subsequent semesters.
- 4) Must register for Master’s Thesis in the final semester, complete the Master’s Thesis under the guidance of the academic supervisor and successfully defend before judgment committee.

B. Credit-track

- 1) Must earn 4 credits in “Seminar” or “演習” (*Enshu*) (Compulsory) instructed by the academic supervisor. The sequence of the Seminars does not have to be in order. Up to 8 credits from Seminar I, II, III and/or IV may be included into completion requirements and up to 4 credits may be counted towards Electives. You may repeatedly take the same Seminar/演習 (*Enshu*) offered by the same instructor; although these additional credits may not be included into the completion requirements unless special circumstances with a permission from the Chairperson exist.
- 2) Must earn 30 credits of Electives.
- 3) Must register for Research Guidance (Compulsory) in the second semester and all subsequent semesters.
- 4) Must register for Graduation Project in final semester and submit a research paper.

【Students who entered before 2014】

A. Thesis-track

- 1) Must earn 26 credits from Electives.
- 2) 2012 enrolled students must register for Research Guidance every semester.
2013 enrolled students must register for Research Guidance from their second semester and all subsequent semesters.
- 3) Must register for and take Thesis Seminar instructed by the academic supervisor in the semester you intend to write your Master’s Thesis.
- 4) Must register for Master’s Thesis in the final semester, complete the Master’s Thesis under the guidance of the academic supervisor and successfully defend before judgment committee.

B. Credit-track

- 1) Must earn 30 credits from Electives.
- 2) 2012 enrolled students must register for Research Guidance every semester.
2013 enrolled students must register for Research Guidance from their second semester and all subsequent semesters.
- 3) Must register for Graduation Project in the final semester, submit a research paper and obtain passing evaluation.

2) Notes about course registration

- 1) You cannot repeat a course of the same title even when offered by a different lecturer.
- 2) You are not allowed to repeat the following courses even if the titles are changed.
Because the lecture content is the same as the former one

Course title in 2014	Course title in 2013
アジア環境研修	アジア環境研修 I
	アジア環境研修 II
Course title in 2015	Course title in 2014
環境政策形成論	環境政策論
English for Science / Engineering A	English for Science / Engineering II (1)

- 3) Students who enrolled before 2014 and have already earned credits for Research Seminar I and II, “演習” (*Enshu*) I and II, Seminar I ~ IV, and “演習” (*Enshu*) A ~ D may include up to 4 credits into Electives.
- 4) Students who enrolled from before 2014 who are registered as Credit-track cannot take “Thesis Seminar”
- 5) The student may withdraw Seminar or “演習” (*Enshu*) courses only when you are taking these courses as Compulsory electives or Electives. In such a case, students must come to the Center for Academic Affairs and submit an application form during the withdrawal period. Please note that the withdrawal of Seminar or “演習” (*Enshu*) cannot be done via Loyola.

5. List of Courses Offered (applicable to all matriculation years)

Registration code	Course numbering	Semester	Course Title	Credits	Instructor * : Part-time teacher Co) : Coordinator	Remarks
MGGE2150	GES601	Not offered	Thesis Seminar	4	STAFF	
MGGE7645	GES752	SPR	Green Marketing	2	FRANK Bjoern	
MGGE7641	GES779	SPR	Environmental Administration	2	OKAZAKI Yuta	
MGGE7690	GES760	SPR	Introduction to Environmental Accounting	2	*MURAI Hideki	
MGGE7710	GES762	SPR	Japanese Experiences in Environmental Management	2	Co) ORI Akemi	Team-taught course
MGGE7655	GES754	SPR	Japanese Environmental Law	2	ORI Akemi	
MGGE7730	GES764	SPR	Environment and Development in Developing Countries	2	PUTHENKALAM John Joseph	
MGGE7770	GES767	SPR	Environmental Assessment	2	HUANG Guangwei	
MGGE7780	GES768	SPR	Integrative Environmental Policy	2	McDONALD Anne	
MGGE7790	GES769	SPR	Ocean and Environment	2	*BEHERA Swadhin	
MGGE7795	GES770	SPR	Marine Environmental Policy	2	McDONALD Anne	
MGGE7840	GES511	SPR	Seminar I	2	McDONALD Anne	
MGGE7841	GES512	SPR	Seminar II	2	McDONALD Anne	
MGGE7850	GES511	SPR	Seminar I	2	PUTHENKALAM John Joseph	
MGGE7860	GES511	SPR	Seminar I	2	HUANG Guangwei	
MGGE7861	GES512	SPR	Seminar II	2	HUANG Guangwei	
MGGE7870	GES511	SPR	Seminar I	2	SUZUKI Masachika	
MGGE7871	GES512	SPR	Seminar II	2	SUZUKI Masachika	
MGGE7980	GES775	SPR	Business Strategies for Sustainability	2	SUZUKI Masachika	
MGGE7990	GES776	SPR	Environmental Resource Management Policy	2	SHIBATA Shingo	
MGGE7642	GES780	SPR	Ecology and the Environment	2	TANAKA Yoshinari	
MGGE9510	GES899	SPR	Master's Thesis	0	Academic supervisors	
MGGE9530	GES898	SPR	Graduation Project	0	Academic supervisors	
MSCT7025	SCT702	SPR	English for Science / Engineering A	2	DZIEMINSKA Edita	(other) Grad. Program in Science and Technology
MSGR7170	GRS717	SPR	Environmental Basic Biology	2	KONDO Jiro	(other) Grad. Program in Science and Technology Team-taught course
MSGR7180	GRS718	Not offered	Environmental Life Science	2	Co) SASAKAWA, Nobuyuki	(other) Grad. Program in Science and Technology Team-taught course
MSGR7020	GRS702	SPR	Green Science and Engineering 2	2	BRENNER Tom, FUJITA Masahiro	(other) Grad. Program in Science and Technology
MSGR7040	GRS704	Not offered	Green Science and Engineering 4	2	STAFF	(other) Grad. Program in Science and Technology
MGGE2160	GES601	Not offered	Thesis Seminar	4	STAFF	
MGGE7740	GES765	AUT	International Environmental Treaties	2	Co) OKAZAKI Yuta	Team-taught course
MGGE7650	GES753	AUT	Global Environment Outlook	2	HUANG Guangwei	
MGGE7665	GES755	AUT	Environment and Supply Chain Management	2	FRANK Bjoern	

Registration code	Course numbering	Semester	Course Title	Credits	Instructor * : Part-time teacher Co) : Coordinator	Remarks
MGGE7670	GES756	AUT	Global Environmental Policy	2	McDONALD Anne	
MGGE7675	GES757	AUT	Recycling Systems in Asia	2	ORI Akemi	
MGGE7680	GES758	AUT	Environment and Sustainable Lifestyles	2	HIRAO Keiko	
MGGE7685	GES759	AUT	Energy and Environmental Technology	2	SUZUKI Masachika	
MGGE7643	GES781	AUT	Chemical Substances and the Environment	2	TANAKA Yoshinari	
MGGE7720	GES763	AUT	Environmental Economics	2	WASHIDA Toyoaki	
MGGE7750	GES766	Not offered	Environmental Planning	2	HUANG Guangwei	
MGGE7800	GES771	AUT	Global Forest Conservation Policy	2	SHIBATA Shingo	
MGGE7810	GES772	AUT	Environmental History	2	McDONALD Anne	
MGGE7900	GES513	AUT	Seminar III	2	McDONALD Anne	
MGGE7901	GES514	AUT	Seminar IV	2	McDONALD Anne	
MGGE7910	GES513	AUT	Seminar III	2	HUANG Guangwei	
MGGE7911	GES514	AUT	Seminar IV	2	HUANG Guangwei	
MGGE7920	GES513	AUT	Seminar III	2	SUZUKI Masachika	
MGGE7921	GES514	AUT	Seminar IV	2	SUZUKI Masachika	
MGGE7930	GES513	AUT	Seminar III	2	PUTHENKALAM John Joseph	
MGGE7960	GES774	AUT	Strategic Environmental Management	2	SUZUKI Masachika	
MGGE7940	GES773	AUT	Climate Change Policy	2	OKAZAKI Yuta	
MGGE9520	GES899	AUT	Master's Thesis	0	Academic supervisors	
MGGE9540	GES898	AUT	Graduation Project	0	Academic supervisors	
MEEC7190	ECN716	AUT	Corporate Finance	4	KAWANISHI Satoshi	(other) Grad. Program in Economics
MSGR7090	GRS709	Not offered	Environmental Chemistry	2	HORIKOSHI Satoshi	(other) Grad. Program in Science and Technology
MSCT7045	SCT704	AUT	English for Science / Engineering B	2	TRIHAN Fabien	(other) Grad. Program in Science and Technology
MSGR7010	GRS701	Not offered	Green Science and Engineering 1	2	STAFF	(other) Grad. Program in Science and Technology
MSGR7030	GRS703	AUT	Green Science and Engineering 3	2	ARAKI Tsuyoshi GONSALVES Tad	(other) Grad. Program in Science and Technology

* For Intensive Courses, check the schedule and classroom on Loyola Bulletin Board (Academic Service).

Registration code	Course numbering	Semester	Course Title	Credits	Instructor * : Part-time teacher	Remarks
MGGE1010	GES501	春	演習A	2	織 朱 實	
MGGE1011	GES502	春	演習B	2	織 朱 實	
MGGE1020	GES501	春	演習A	2	鷺 田 豊 明	
MGGE1021	GES502	春	演習B	2	鷺 田 豊 明	
MGGE1030	GES501	春	演習A	2	田 中 嘉 成	
MGGE1031	GES502	春	演習B	2	田 中 嘉 成	
MGGE1040	GES501	春	演習A	2	FRANK Bjoern	
MGGE1041	GES502	春	演習B	2	FRANK Bjoern	
MGGE1050	GES501	春	演習A	2	柴 田 晋 吾	
MGGE1051	GES502	春	演習B	2	柴 田 晋 吾	
MGGE1060	GES501	春	演習A	2	平 尾 桂 子	
MGGE1061	GES502	春	演習B	2	平 尾 桂 子	
MGGE1070	GES501	春	演習A	2	岡 崎 雄 太	
MGGE1071	GES502	春	演習B	2	岡 崎 雄 太	
MGGE1080	GES501	春	演習A	2	プテンカラム ジョンジョセフ	
MGGE6000	GES701	春	日本の環境法	2	織 朱 實	隔週開講
MGGE6005	GES702	春	環境マーケティング	2	フランク ビョーン	
MGGE6030	GES705	春	環境経済学 I	2	鷺 田 豊 明	
MGGE6035	GES706	春	国際環境法	2	*磯 崎 博 司	隔週開講
MGGE6045	GES708	春	環境政策論	2	柴 田 晋 吾	
MGGE6001	GES782	春	循環型社会形成・廃棄物対策論	2	*柳 下 正 治	
MGGE6080	GES712	春	環境経営学	2	鈴 木 政 史	
MGGE6002	GES783	春	環境行政論	2	岡 崎 雄 太	
MGGE7070	GES715	春	環境と経済制度	2	鷺 田 豊 明	隔年開講
MGGE7180	GES718	休講	環境社会学	2	平 尾 桂 子	
MGGE7240	GES721	春	環境と消費	2	*中 原 秀 樹	
MGGE7270	GES722	春	環境倫理	2	*鬼 頭 秀 一	
MGGE7290	GES723	春	環境教育	2	(他)吉川 まみ	
MGGE7370	GES725	春	地球環境工学論	2	*大 坪 國 順	隔年開講
MGGE7390	GES727	春	環境研究のための統計学	2	平 尾 桂 子	隔年開講
MGGE7420	GES729	春	環境史	2	まくどなるど・あん	春学期集中
MGGE7430	GES730	春	アジア環境研修	4	黄 光 偉	春学期集中 ※
MGGE7440	GES731	春	カーボンマネジメント論	2	*糸 原 茂 人	
MGGE7480	GES733	春	生物と環境	2	田 中 嘉 成	
MGGE7550	GES734	春	環境金融論	2	*藤 井 良 広	
MGGE7610	GES735	春	インターンシップ I	2	柴 田 晋 吾	春学期集中 ※
MGGE7630	GES737	春	環境計画・リスクマネジメント論	2	黄 光 偉	
LWS54100	ENL702	春	環境法政策	2	北 村 喜 宣	(他) 法科大学院
MGGE1200	GES503	秋	演習C	2	織 朱 實	
MGGE1201	GES504	秋	演習D	2	織 朱 實	
MGGE1210	GES503	秋	演習C	2	鷺 田 豊 明	
MGGE1211	GES504	秋	演習D	2	鷺 田 豊 明	

Registration code	Course numbering	Semester	Course Title	Credits	Instructor * : Part-time teacher	Remarks
MGGE1220	GES503	秋	演習C	2	田中嘉成	
MGGE1221	GES504	秋	演習D	2	田中嘉成	
MGGE1230	GES503	秋	演習C	2	FRANK Bjoern	
MGGE1231	GES504	秋	演習D	2	FRANK Bjoern	
MGGE1240	GES503	秋	演習C	2	柴田晋吾	
MGGE1241	GES504	秋	演習D	2	柴田晋吾	
MGGE1250	GES503	秋	演習C	2	プテンカラム ジョンジョセフ	
MGGE1260	GES503	秋	演習C	2	平尾桂子	
MGGE1261	GES504	秋	演習D	2	平尾桂子	
MGGE1270	GES503	秋	演習C	2	岡崎雄太	
MGGE1271	GES504	秋	演習D	2	岡崎雄太	
MGGE6015	GES703	秋	C S R経営	2	FRANK Bjoern	
MGGE6025	GES704	秋	環境リスクマネジメント	2	織 朱 實	
MGGE6040	GES707	秋	環境経済学Ⅱ	2	鷲田豊明	
MGGE6060	GES710	休講	環境工学	2	未 定	隔年開講
MGGE6070	GES711	秋	森林環境政策	2	柴田晋吾	
MGGE6090	GES713	休講	環境・エネルギー技術論	2	鈴木政史	
MGGE7120	GES716	秋	地球温暖化対策論	2	岡崎雄太	隔週開講
MGGE7200	GES719	休講	途上国の環境と開発	2	プテンカラム ジョンジョセフ	隔年開講
MGGE7210	GES720	秋	エネルギーと環境	2	*柳下正治他	輪講
MGGE7300	GES724	秋	環境研究のフロンティア	2	コーディネータ 未 定	輪講
MGGE7410	GES728	秋	ジェンダーと環境	2	平尾桂子	
MGGE7450	GES732	秋	化学物質と環境	2	田中嘉成	隔週開講
MGGE7620	GES736	秋	インターンシップⅡ	2	柴田晋吾	秋学期集中 ※
LWS54200	ENL703	秋	環境訴訟	2	越智敏裕	(他)法科大学院
LWS54600	ENL707	休講	比較環境法	2	未 定	(他)法科大学院
MEMG7060	MAC512	秋	環境会計論特講	2	上妻義直	(他)経営学専攻 科目

6. List of Research Guidance

Course numbering; GES888

Course code	Semester	Course Title	Instructor	Remarks
MGGE1951	SPR	Research Guidance	WASHIDA Toyoaki	
MGGE1952	AUT	Research Guidance		
MGGE1953	SPR	Research Guidance	TANAKA Yoshinari	
MGGE1954	AUT	Research Guidance		
MGGE1955	SPR	Research Guidance	HIRAO Keiko	
MGGE1956	AUT	Research Guidance		
MGGE1957	SPR	Research Guidance	OKAZAKI Yuta	
MGGE1958	AUT	Research Guidance		
MGGE1959	SPR	Research Guidance	PUTHENKALAM John Joseph	
MGGE1960	AUT	Research Guidance		
MGGE1961	SPR	Research Guidance	ORI Akemi	
MGGE1962	AUT	Research Guidance		
MGGE1963	SPR	Research Guidance	SHIBATA Shingo	
MGGE1964	AUT	Research Guidance		
MGGE1965	SPR	Research Guidance	HUANG Guangwei	
MGGE1966	AUT	Research Guidance		
MGGE1967	SPR	Research Guidance	McDONALD Anne	
MGGE1968	AUT	Research Guidance		
MGGE1969	SPR	Research Guidance	SUZUKI Masachika	
MGGE1970	AUT	Research Guidance		
MGGE1971	SPR	Research Guidance	FRANK Bjoern	
MGGE1972	AUT	Research Guidance		

7. Early Graduation

【Students entered in April 2014 or after】

Students in the Thesis-Track who wish to graduate early (eg. in 2 or 3 semesters) can apply for Early Graduation if they are in good academic standing by the judgment of the faculty and satisfy the following requirements:

- A. Submit an “Early Graduation Request” form at least one year prior to the requested graduation date.
- B. Complete the required 30 credits of courses from the ICGGES curriculum by the time of graduation and obtain a GPA of 3.8 or higher.
- C. Complete all the requirements and have M.A. thesis evaluated as “excellent (A).”

【Students entered before 2014】

Students who wish to graduate early (eg. in 2 or 3 semesters) can apply for Early Graduation if they are in good academic standing by the judgment of the faculty and satisfy the following requirements:

- A. Submit an “Early Graduation Request” form.
- B. Complete at least 30 credits of courses from the ICGGES curriculum by the time of graduation and obtain a GPA of 3.8 or higher.
- C. Complete all requirements for either the M.A. credit track or M.A. thesis track.

“Application for Early Graduation” forms are available in the ICGGES office. Students should submit the proposal form to the Dean one year before graduating.

PH.D. CURRICULUM

Ph.D in Global Environmental Studies

The Ph.D. in Global Environmental Studies is designed for the advanced study of specific areas relating to the global environment. While the questions and lines of inquiry are interdisciplinary, research and writing agendas emphasize methods and concepts from various disciplines of economics, law, political science, sociology, natural science as well as engineering. The degree is intended to prepare persons for academic positions in research institutions, IGOs and NGOs engaged in the area of environmental issues, the public and private sector and requiring advanced knowledge pertaining to specific environmental and sustainability matters.

The IGCGES Ph.D. program requires a three-year residency and is focused upon the production of a doctoral dissertation. While no formal course work is required, candidates are encouraged to participate in workshops and other program activities and may, in consultation with their dissertation supervisor, attend courses from the master's program. Ph.D. candidates must first pass several qualifying exams and then, upon successful defense of a dissertation prospectus, proceed to dissertation research and writing. To ensure solid guidance of dissertation research and production, entrance is limited to only a few candidates each year.

1. Completion Requirements: Required Courses, Credits, Number of Courses

Requirements	Required credits	Remarks
Total credits		
Compulsory		
Electives		
Research Guidance (compulsory)		Non-credit but compulsory. Must be taken every semester.
Doctoral Dissertation		Complete required research guidance, write doctoral thesis in English, submit by designated deadline and successfully defend doctoral dissertation.

2. Criteria for the Evaluation of Doctoral Thesis

The thesis shall exhibit the author's skills and capabilities to conduct research and to make original contributions to the concerned academic area. The thesis shall also meet the following criteria:

1. Thesis topic: The thesis shall address the reason(s) for the selection of a thesis topic and justify the appropriateness of the topic in the research area.
2. Previous studies: The thesis shall sufficiently cover previous studies on the selected topic and exhibit them in an organized manner.
3. Originality: The thesis shall illustrate original, unique aspects of research. Presentation of new research findings is an example of such aspects.
4. Research method: The thesis shall succinctly describe a research method, collected data, and materials.
5. Thesis structure: The thesis shall clearly exhibit the structure of the contents of the thesis and the logical flow of research. There shall be consistency among the thesis topic, the hypothesis, and the conclusion.
6. Ethical standards: The thesis shall consider ethical standards with respect to research methods and the target(s) of analysis. The thesis shall meet the ethical standards established by the university and the academic community.

7. Format: The thesis shall sufficiently cover materials related to the thesis topic and clearly indicate sources of information and data in citations and in a list of references.

In addition, the thesis shall go through the steps required by the regulations at the Graduate School of Global Environmental Studies.

3. Curriculum Structure/ Credits

Course Title	Credits		
	Compulsory	Compulsory elective	Elective
Research Guidance	0		

4. Notes about Course Registration

- 1) A student must register Research Guidance (compulsory) taught by academic supervisor every semester.
- 2) Upon passing the qualifying examination and successful defense of dissertation prospectus, a student must submit doctoral dissertation in English according to specified procedures, and successfully defend before examination committee.

5. List of Research Guidance

Course numbering; GES988

Course code	Semester	Course Title	Instructor	Remarks
DGGE3610	SPR	Research Guidance	WASHIDA Toyoaki	research guidance course
DGGE3620	AUT	Research Guidance		research guidance course
DGGE3630	SPR	Research Guidance	TANAKA Yoshinari	research guidance course
DGGE3640	AUT	Research Guidance		research guidance course
DGGE3670	SPR	Research Guidance	OKAZAKI Yuta	research guidance course
DGGE3680	AUT	Research Guidance		research guidance course
DGGE3650	SPR	Research Guidance	HIRAO Keiko	research guidance course
DGGE3660	AUT	Research Guidance		research guidance course
DGGE3690	SPR	Research Guidance	PUTHENKALAM John Joseph	research guidance course
DGGE3700	AUT	Research Guidance		research guidance course
DGGE3710	SPR	Research Guidance	ORI Akemi	research guidance course
DGGE3720	AUT	Research Guidance		research guidance course
DGGE3730	SPR	Research Guidance	McDONALD Anne	research guidance course
DGGE3740	AUT	Research Guidance		research guidance course

Course code	Semester	Course Title	Instructor	Remarks
DGGE3750	SPR	Research Guidance	HUANG Guangwei	research guidance course
DGGE3760	AUT	Research Guidance		research guidance course
DGGE3790	SPR	Research Guidance	SHIBATA Shingo	research guidance course
DGGE3800	AUT	Research Guidance		research guidance course
DGGE3810	SPR	Research Guidance	SUZUKI Masachika	research guidance course
DGGE3820	AUT	Research Guidance		research guidance course
DGGE3830	SPR	Research Guidance	FRANK Bjoern	research guidance course
DGGE3840	AUT	Research Guidance		research guidance course

Students must register for “Research Guidance” via Loyola each semester during their residency in GSGES.

Ph.D. Degree Requirements and Schedules

A doctoral student begins working towards the doctoral degree upon matriculation in GSGES. With successful acceptance of the dissertation draft, typically in the third semester, a student is considered as a doctoral candidate. The general requirements for completing the Ph.D. are a three-year residency and the writing of a thesis that is successfully defended and accepted by the dissertation committee. Note that doctorates are not awarded as a result of completing a specified number of courses or credits. The doctoral program consists of a combination of course seminars and individual study and research that meets the minimum requirements of the GSGES and is approved by the doctoral committee for each individual student.

Process for Attaining a Doctorate Degree

Step 1: Submission of “Thesis Title” Form

Doctoral students must submit their doctoral thesis title to their supervisor in the first semester of their first year after officially entering the doctoral program. A tentative title is acceptable and title changes based on consultation with supervisor are allowed at a later date.

Step 2: Presentation of Dissertation Plan

At the beginning of the second year of studies, doctoral students must present their dissertation plan to all the faculty members of the Graduate School of Global Environmental Studies. Depending on consultation with supervisor and permission from supervisor, the doctoral student may be given a chance to present their progress once a year.

Step 3: Research and Writing (Dissertation Proposal Defense)

To become a doctoral candidate, students must submit a draft of the dissertation and present and defend it in front of the faculty members of the Graduate School of Global Environmental Studies. If necessary, an outside reader may be invited to the proposal defense under the consent of the faculty. Upon successful evaluation of the presentation and acceptance of the dissertation draft, the doctoral student will officially qualify as a doctoral candidate and will proceed to finalizing their research and writing up their dissertation. Doctoral candidates are required to consult with their supervisor throughout the writing process of their dissertation.

Step 4. Dissertation Submission and Defense

The final dissertation must be submitted by the end of the semester prior to the one during which the candidate intends to defend the thesis. It must be submitted to the supervisor first to be evaluated at the faculty meeting. The dissertation must obtain approval by the faculty meeting before it is officially submitted to the Center for Academic Affairs. Upon successfully defending the dissertation before the examination committee, a doctoral degree will be conferred.

FACULTY OFFICES

Name	Room
PUTHENKALAM, John Joseph	2-1129
SHIBATA, Shingo	2-1516
TANAKA, Yoshinari	2-1517
ORI, Akemi	2-1518
WASHIDA, Toyoaki	2-1519
FRANK, Bjoern	2-1520
SUZUKI, Masachika	2-1526
HIRAO, Keiko	2-1527
McDONALD, Anne	2-1618
HUANG, Guangwei	2-1619
OKAZAKI, Yuta	2-1620

Yotsuya Campus
四谷キャンパス

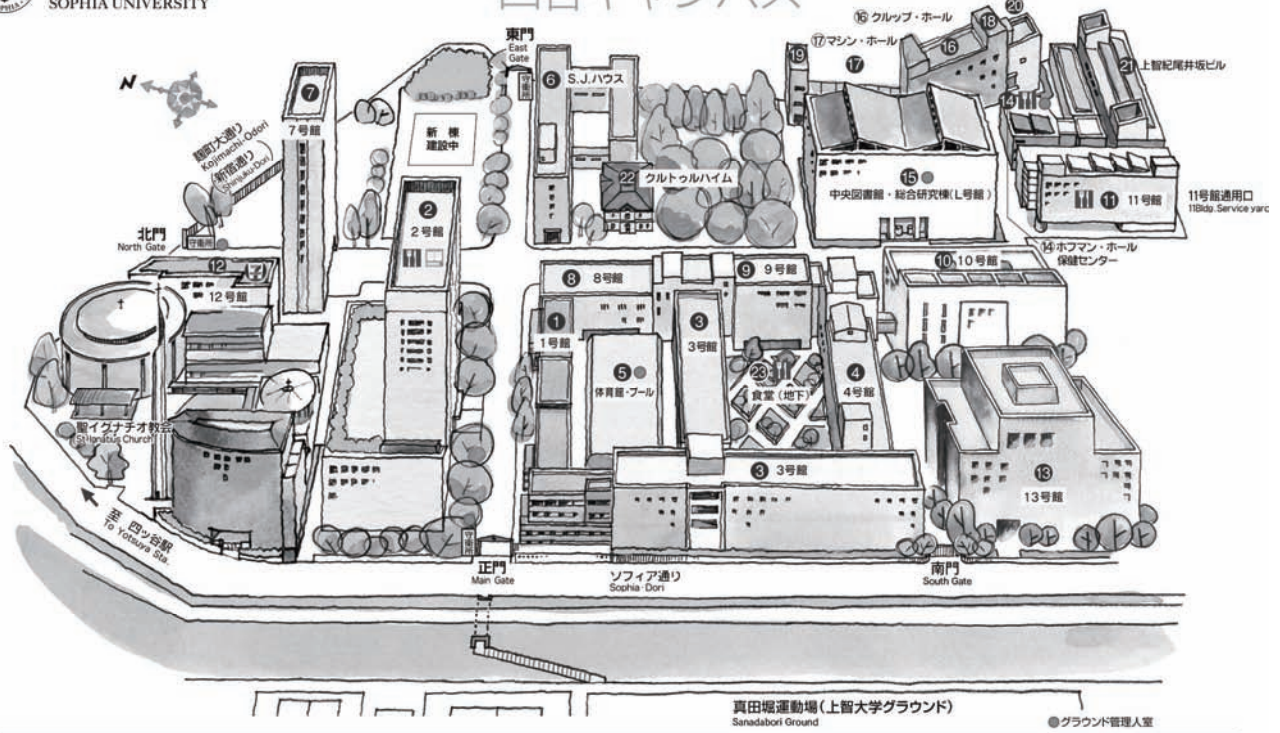

- | | | | | |
|------------------------|------------------------------------|--|-----------------------------------|--------------------------|
| ① 1号館
Bldg. No.1 | ⑥ S.J.ハウス S.J. House
Bldg. No.7 | ⑬ 12号館
Bldg. No.12 | ⑰ クルップ・ホール
Krupp Hall | ⑳ クルトゥルハイム
Kulturheim |
| ② 2号館
Bldg. No.2 | ⑦ 7号館
Bldg. No.7 | ⑭ 13号館
Bldg. No.13 | ⑱ マシン・ホール
Machine Hall | ㉑ 購買 Maruzen Sophia Shop |
| ③ 3号館
Bldg. No.3 | ⑧ 8号館
Bldg. No.8 | ⑮ ホフマン・ホール
Hofmann Hall | ㉒ パワーステーションⅠ
Power Station I | ㉒ 地下(basement) |
| ④ 4号館
Bldg. No.4 | ⑨ 9号館
Bldg. No.9 | ⑯ ホフマン・ホール
保健センター
Health Center | ㉓ パワーステーションⅡ
Power Station II | ㉓ 食堂 Restaurant |
| ⑤ 体育館
Gymnasium | ⑩ 10号館
Bldg. No.10 | ⑰ 中央図書館
保健センター
+ 総合研究棟(L号館)
and Research Institutes | ㉔ パワーステーションⅢ
Power Station III | ㉔ 5階(5F) |
| ⑥ プール
Swimming Pool | ⑪ 11号館
Bldg. No.11 | ⑱ 上智紀尾井坂ビル
Jochi Koizuka Bldg. | | ㉔ 4階(4F) |
| | | | | ㉔ 地下(basement) |
- ㉕ AED (自動体外式除細動器) : 学内6カ所 Automated External Defibrillator
 ㉖ コンビニエンスストア Convenience Store ㉗ 地下(basement)

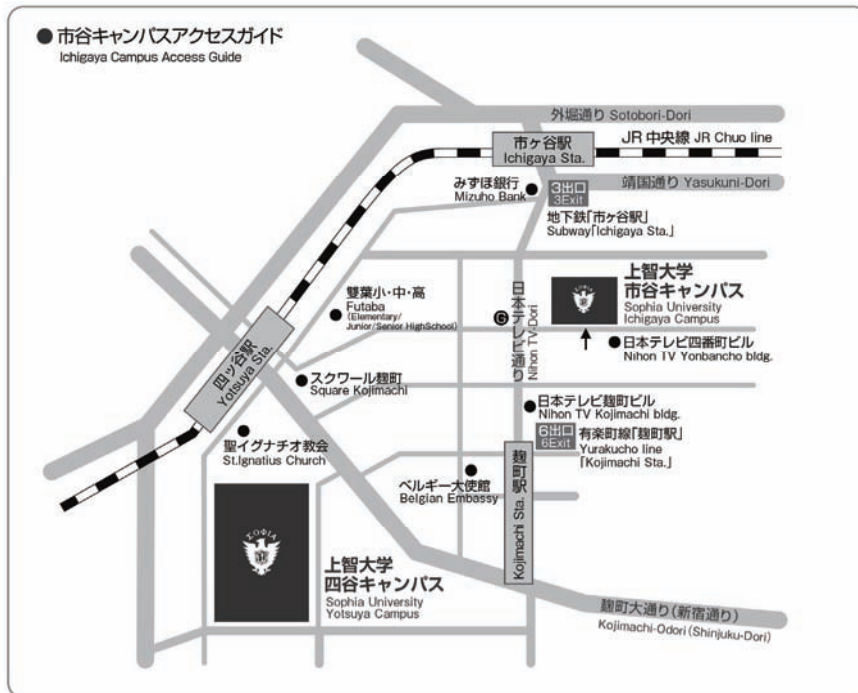

Yotsuya Campus

Bulletin Boards in Building No.2 1F

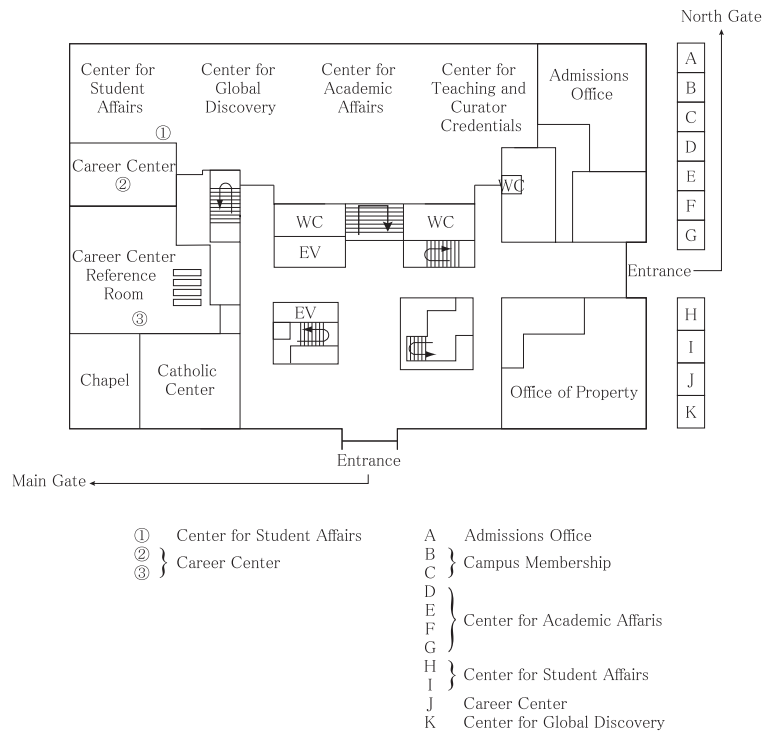

Building No.1,3,4,8,9

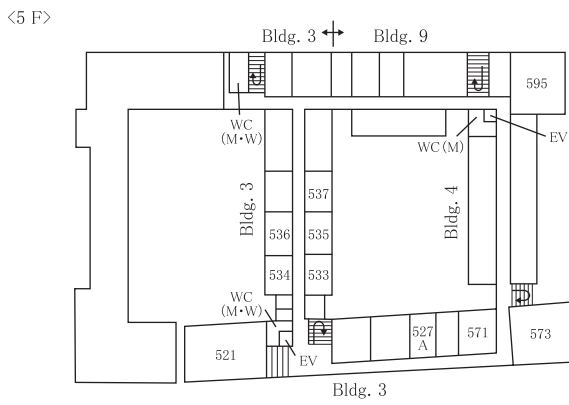
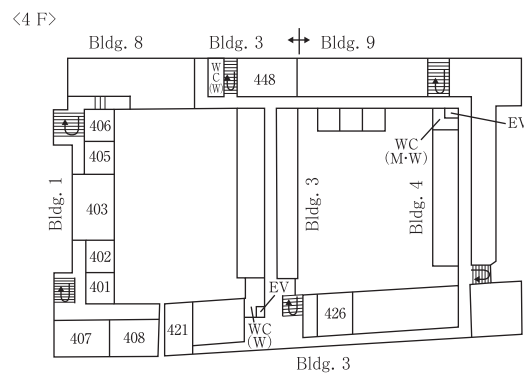
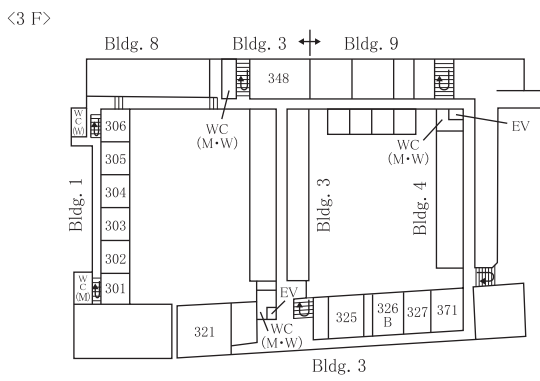
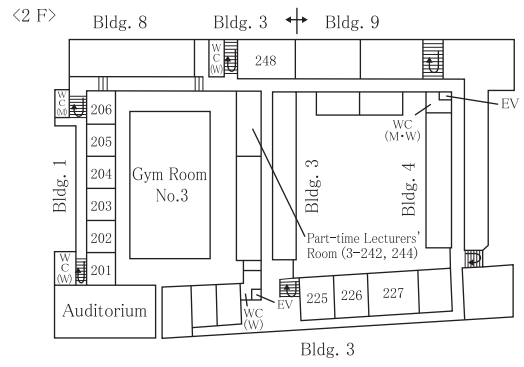
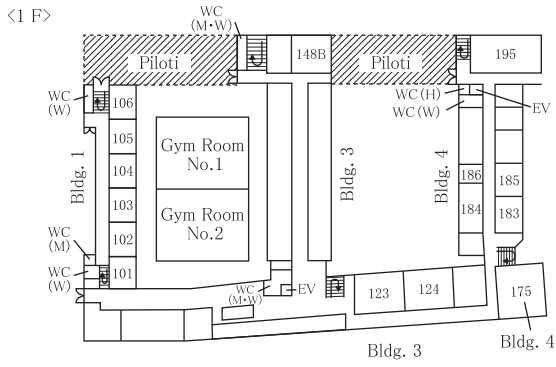

Building No.2

<B2 F>

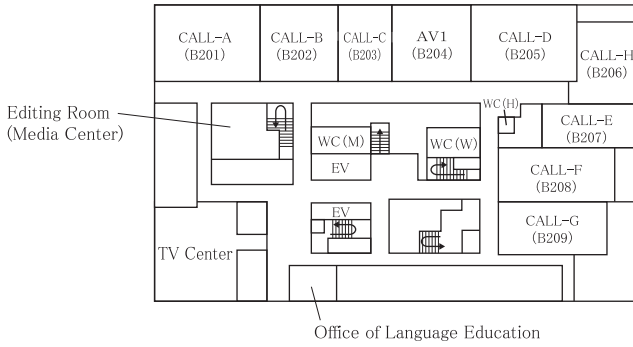

<B1 F>

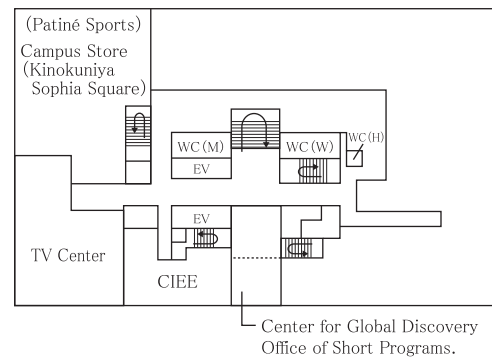

<1 F>

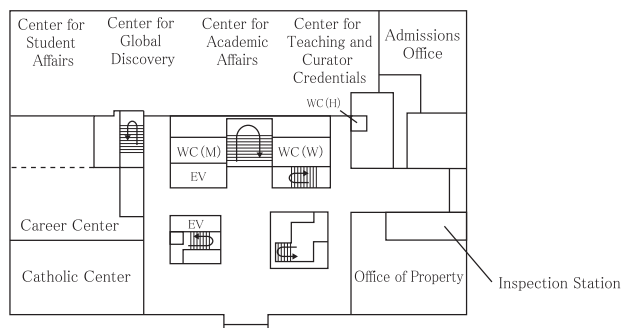

<2F>

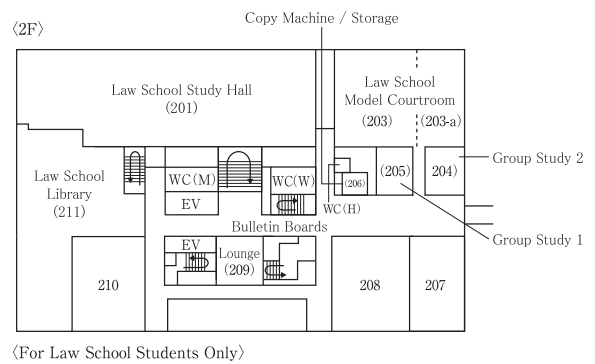

<3 F>

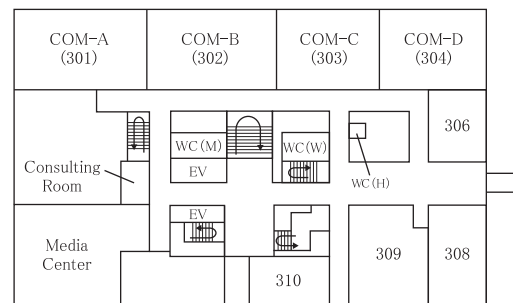

<4 F>

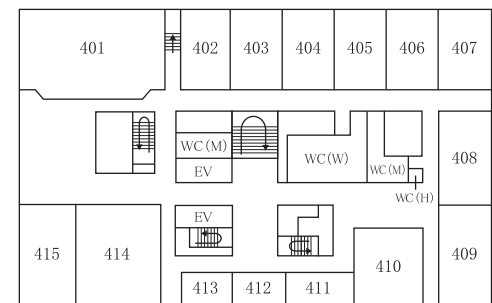

<5 F>

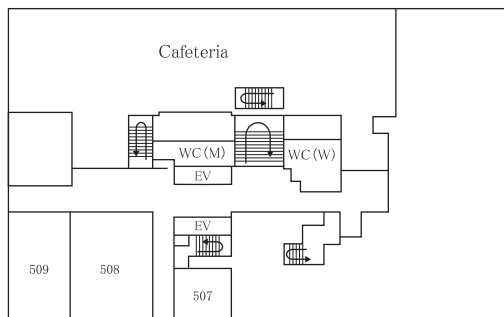

Central Library (Building L)

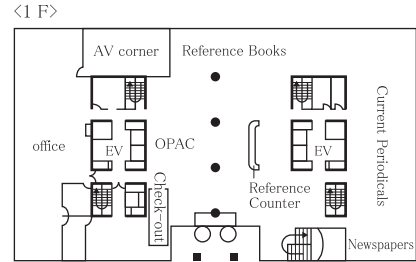
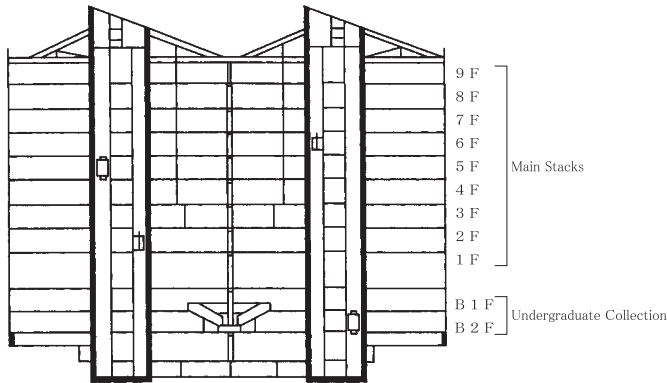

Building No.10

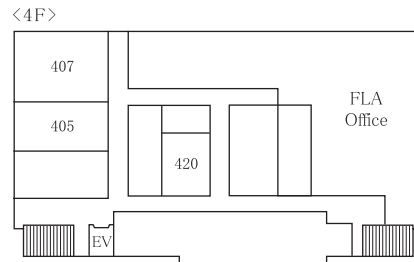
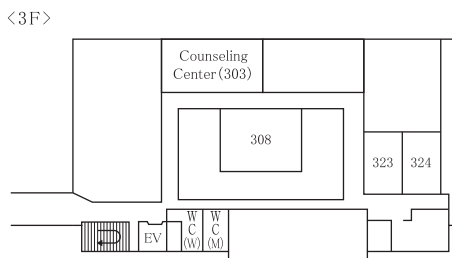
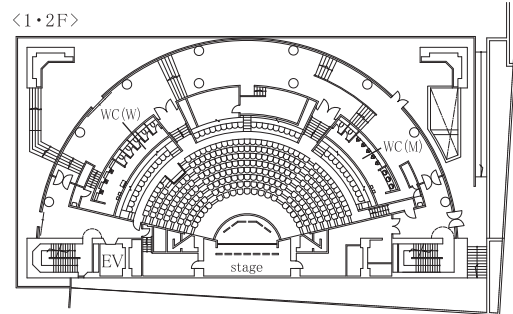
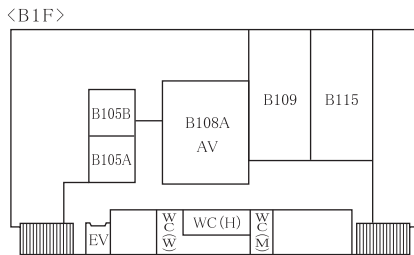

Building No.11 & Jochi Kioizaka Building

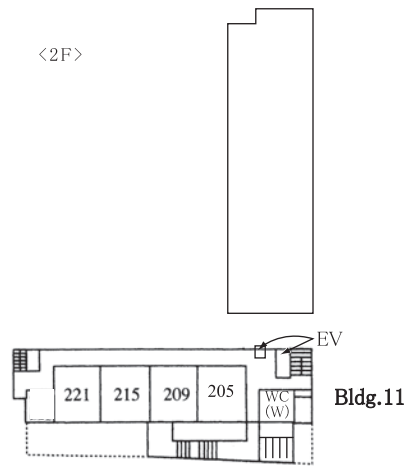
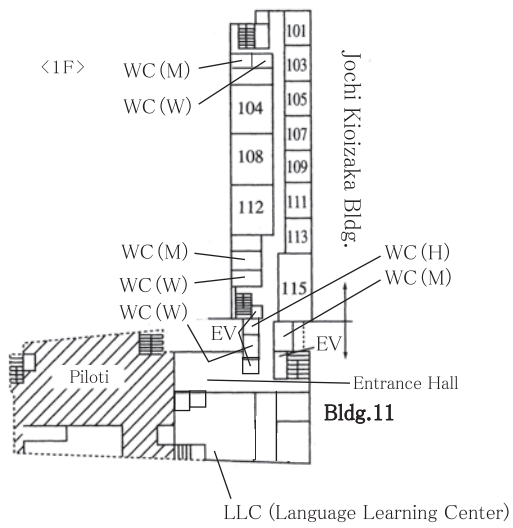
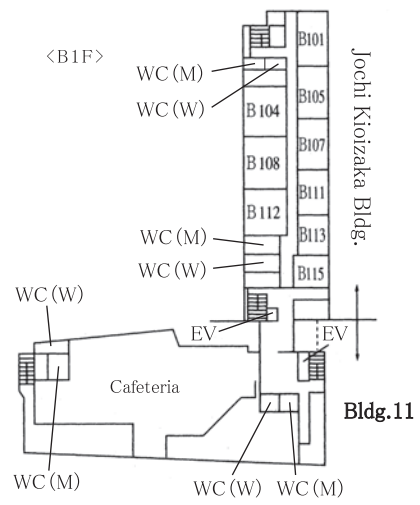
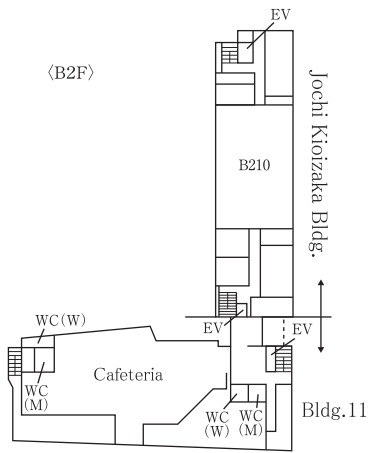

Building No.11

< 3 F >

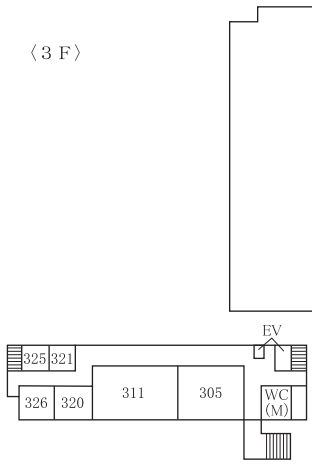

< 4 F >

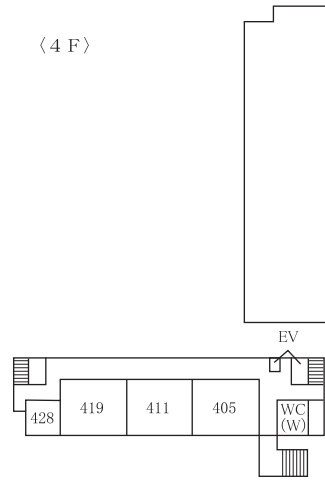

< 5 F >

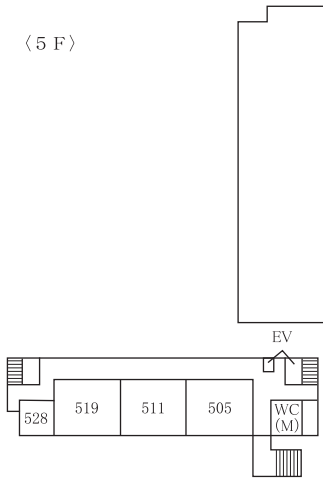

< 6 F >

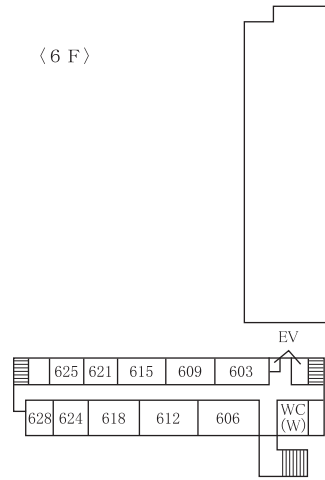

< 7 F >

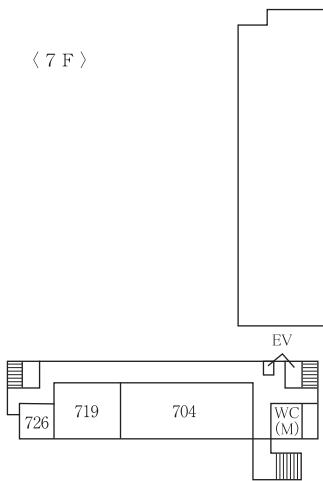

Building No.12

<B1F>

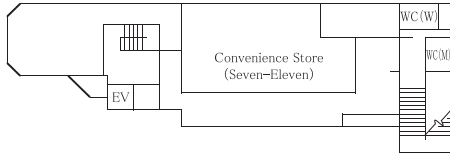

<1F>

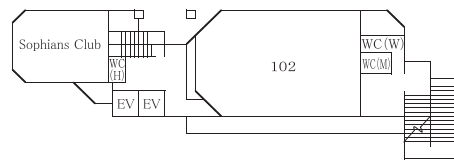

<2F>

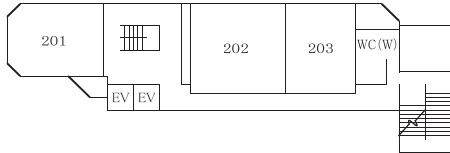

<3F>

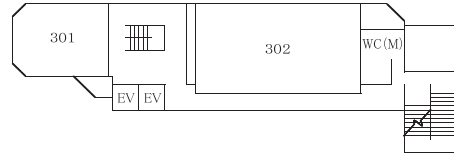

<4F>

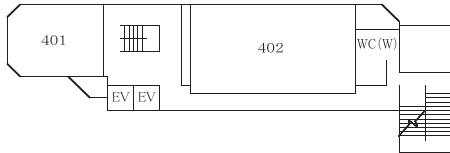

<5F>

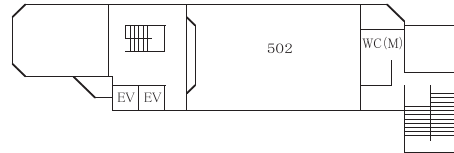

Krupp Hall / Machine Hall

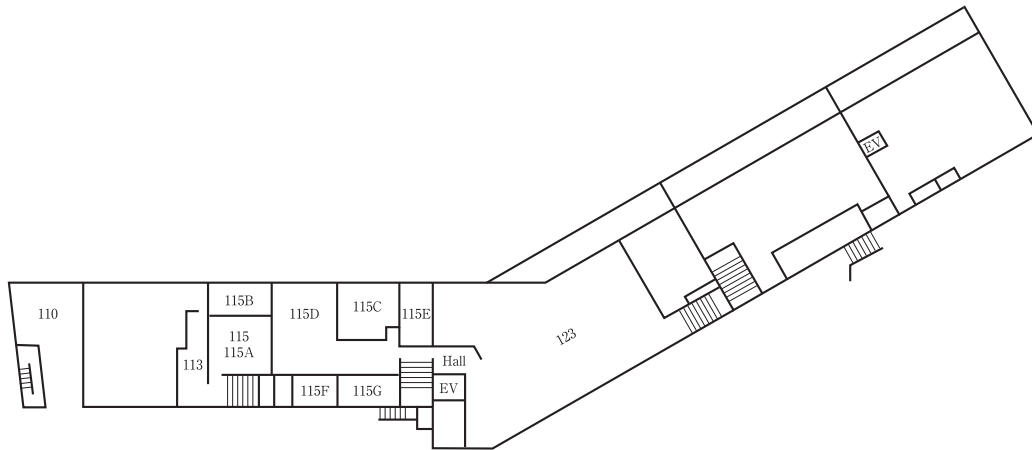

1F

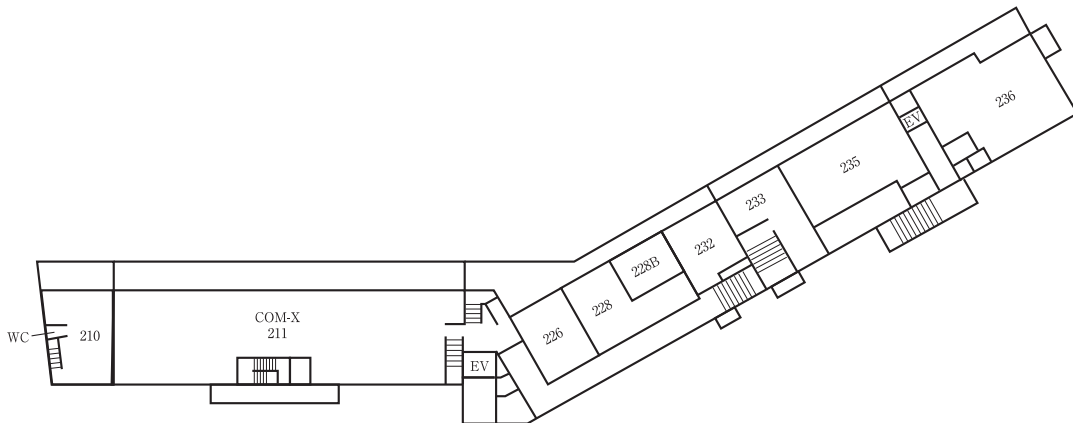

2F

Ichigaya Campus

Main Building

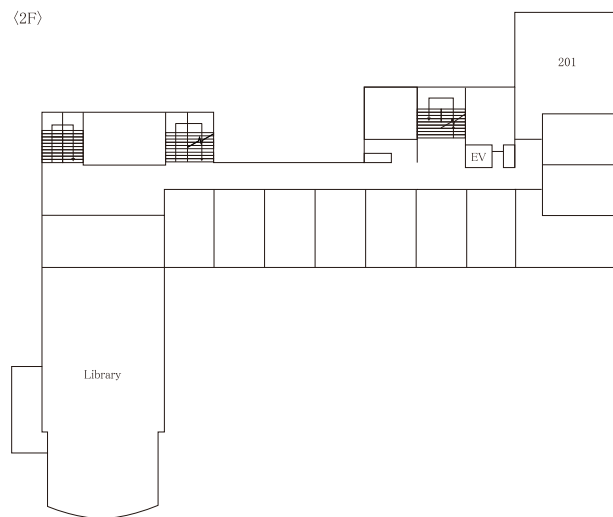
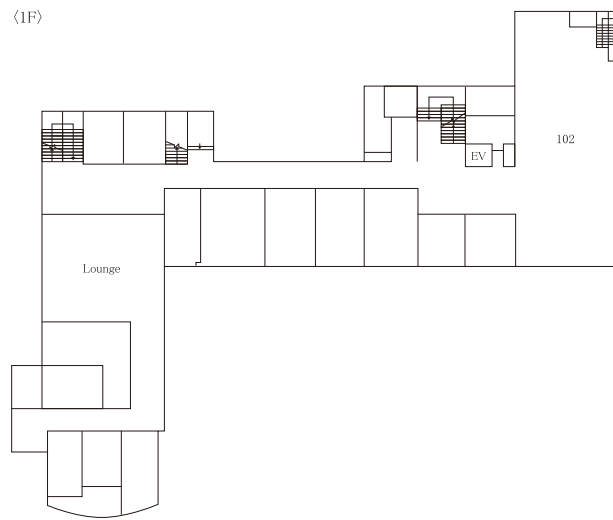

Research Building

