

## CALENDAR FOR THE ACADEMIC YEAR 2014

### SPRING SEMESTER (April 1- September 20, 2014)

2014

<b>APRIL</b>	
1 (TUE)	Orientation for new students (degree, non-degree) English placement test
1 (TUE)-21 (MON)	Self-evaluation/Category change period
2 (WED)	Orientation for new exchange students Japanese placement test Chinese, French and Spanish placement interview
3 (THU)-15 (TUE)	Course registration (sophomores, juniors, seniors)
4 (FRI)-15 (TUE)	Course registration (freshmen, exchange/non-degree students)
3 (THU)-7 (MON)	First lottery registration (sophomores, juniors, seniors)
4 (FRI)-7 (MON)	First lottery registration (freshmen, exchange/non-degree students)
5 (SAT)-6 (SUN)	Orientation camp for new degree students
7 (MON)	Individual advising for all students Guidance for transfer students
8 (TUE)	Results of first lottery registration available on Loyola
8 (TUE)-9 (WED)	Second lottery registration
9 (WED)	Entrance ceremony for new degree students
10 (THU)	Results of second lottery registration available on Loyola Third lottery registration (foreign language courses only)
11 (FRI)	Results of third lottery registration available on Loyola
11 (FRI)-15 (TUE)	Final lottery registration (first-come, first-served basis)
12 (SAT)	Classes begin
16 (WED)-17 (THU)	Results of course registration available on Loyola
18 (FRI)-21 (MON)	Course adjustment
23 (WED)	Final confirmation of course registration available on Loyola
24 (THU)-28 (MON)	Cancellation period
29 (TUE)	Classes to be held
<b>MAY</b>	
7 (WED)	Tuition bill sent
23 (FRI)	Tuition payment deadline
30 (FRI)	Leave of absence application deadline
<b>JUNE</b>	
6 (FRI)-11 (WED)	Withdrawal period
9 (MON)-JULY 18 (FRI)	Summer Session in Japanese Language Course registration: MAY 12 (MON)-14 (WED)
12 (THU)	Sophomore guidance
<b>JULY</b>	
5 (SAT)	Make-up classes
9 (WED)	Final exam schedule available on Loyola
12 (SAT)	Make-up classes
19 (SAT)	Make-up classes
21 (MON)	Classes to be held
22 (TUE)	Classes end
23 (WED)-30 (WED)	Final examinations
24 (THU)- AUG 15 (FRI)	Summer Session in Asian Studies Course registration: JUN 16 (MON)-20 (FRI) Final examination: AUG 15 (FRI)
31 (THU)-SEPT 26 (FRI)	Summer recess
<b>AUGUST</b>	
26 (TUE)	Grades available on Loyola (for senior and graduating students)
26 (TUE)-27 (WED)	Deadline for request for grade review (for senior and graduating students)
late AUG-early SEPT	Make-up examinations
<b>SEPTEMBER</b>	
10 (WED)	Announcement of graduating students on Loyola
11 (THU)	Grades/Self-evaluation/Category change available on Loyola (juniors)
12 (FRI)	Grades/Self-evaluation/Category change available on Loyola (sophomores)
13 (SAT)	Grades/Self-evaluation/Category change available on Loyola (freshmen, exchange / non-degree students)
19 (FRI)	Graduation ceremony Early graduation application deadline (for March graduation)
26 (FRI)	Deadline for request for grade review (for 2014 spring courses)

**AUTUMN SEMESTER (September 21, 2014- March 31, 2015)****2014****SEPTEMBER**

22 (MON)	Entrance ceremony for new degree students Orientation for new students (degree, non-degree, exchange) English placement test
23 (TUE)	Japanese placement test Chinese, French and Spanish placement interview
25 (THU)-26 (FRI)	Orientation camp for new degree students
21 (SUN)-OCT 1 (WED)	Course registration (sophomores, juniors, seniors)
22 (MON)-OCT 1 (WED)	Course registration (freshmen, exchange/non-degree students)
21 (SUN)-26 (FRI)	First lottery registration (sophomores, juniors, seniors)
21 (SUN)-OCT 6 (MON)	Self-evaluation/Category change period
22 (MON)-26 (FRI)	First lottery registration (freshmen, exchange/non-degree students)
27 (SAT)	Results of First lottery registration available on Loyola
27 (SAT)-28 (SUN)	Second lottery registration
29 (MON)-OCT 1 (WED)	Results of Second lottery registration available on Loyola
27 (SAT)	Guidance for transfer students Individual advising for all students
27 (SAT)	Final lottery registration (first-come, first-served basis) Classes begin

**OCTOBER**

2 (THU)-3 (FRI)	Results of course registration available
4 (SAT)-6 (MON)	Course adjustment
8 (WED)	Final confirmation of course registration available on Loyola
9 (THU)-13 (MON)	Cancellation period
13 (MON)	Classes to be held
17 (FRI)	Tuition bill sent
28 (TUE)	Virtual Friday*
31 (FRI)	Tuition payment deadline

**NOVEMBER**

6 (THU)	Virtual Monday*
24 (MON)	Classes to be held
28 (FRI)	Leave of absence application deadline

**DECEMBER**

4 (THU)	Sophomore guidance
8 (MON)-12 (FRI)	Withdrawal period
20 (SAT)	Make-up classes
23 (TUE)-JAN 4 (SUN)	Winter recess

**2015****JANUARY**

5 (MON)	Classes resume
9 (FRI)	Final exam schedule available on Loyola
10 (SAT)	Make-up classes
17 (SAT)	Make-up classes
22 (THU)	Classes end
23 (FRI)-30 (FRI)	Final examinations
31 (SAT)-MAR 31 (TUE)	Spring recess

**FEBRUARY**

mid to late February	Make-up examinations
26 (THU)	Grades available on Loyola (for senior and graduating students)
26 (THU)-MAR 2 (MON)	Deadline for request for grade review (for senior and graduating students)

**MARCH**

14 (SAT)	Announcement of graduating students on Loyola
15 (SUN)	Grades/Self-evaluation/Category change available on Loyola (juniors)
16 (MON)	Grades/Self-evaluation/Category change available on Loyola (sophomores)
17 (TUE)	Grades/Self-evaluation/Category change available on Loyola (freshmen, exchange/non-degree students)
26 (THU)	Graduation ceremony
31 (TUE)	Early graduation application deadline (for September graduation) Deadline for request for grade review (for 2014 autumn courses)

\* Virtual days are scheduled so that each course is held a sufficient number of hours to fulfill the requirements set by the Ministry of Education, Culture, Sports, Science and Technology (MEXT).

---

## **HOLIDAYS AND NO-CLASS DAYS**

Spring Semester:

May 3 (Sat)	Constitution Day (National Holiday)
May 5 (Mon)	Children's Day (National Holiday)
May 6 (Tue)	Public Holiday

Autumn Semester:

September 29 (Mon)	No-class Day
November 1 (Sat)	Foundation Day (School Holiday)
November 3 (Mon)	Culture Day (National Holiday)
December 3 (Wed)	St. Xavier's Day (School Holiday)
January 12 (Mon)	Adults' Day (National Holiday)

---

## **CLASS CANCELLATIONS**

Classes are normally held according to the academic calendar, but they may be canceled due to an academic conference, business trip or illness of a faculty member. Class cancellations are announced on Loyola when the teacher notifies the Center for Academic Affairs. An announcement may be posted on Loyola on the same day a class is canceled, so please make it a habit to check Loyola before each class. You may check class cancellations on the day of the class also from your mobile phone.

If a faculty member does not come to class within 30 minutes of the starting time please notify the Center for Academic Affairs and follow the instructions.

---

## **MAKE-UP CLASSES**

Make-up classes are normally held on predetermined dates scheduled in the Spring and Autumn Semesters, but other days may also be arranged for make-up classes. In both cases, the days for the make-up classes will be announced on Loyola; please check the date, time, and classroom.

---

Class cancellations, make-up classes or any additional no-class days will be announced on the Loyola bulletin board.
--

# **SOPHIA UNIVERSITY**

**FACULTY OF LIBERAL ARTS**

**BULLETIN OF INFORMATION**

**2014-2015**

**Bulletin of Information 2014-2015**  
**Faculty of Liberal Arts**  
**Sophia University**

**7-1 Kioi-cho, Chiyoda-ku, Tokyo 102-8554, Japan**  
**Telephone 03 (3238) 4004**  
**Fax 03 (3238) 4076**

**Published by the Center for Academic Affairs,**  
**Sophia University**

**7-1 Kioi-cho, Chiyoda-ku, Tokyo 102-8554, Japan**  
**Telephone 03 (3238) 3515**  
**Fax 03 (3238) 3264**

**March, 2014**

---

Every effort is made to ensure the accuracy of the information contained herein. However, subsequent to the date of publication, circumstances may necessitate changes. The University reserves the right to make all such changes, including those in the program of study, courses of instruction, fees, and officers of administration and instruction, without notice.

---

# TABLE OF CONTENTS

<b>I. INTRODUCTION .....</b>	<b>1</b>
<b>II. REGULATIONS AND PROCEDURES.....</b>	<b>3</b>
<b>General Information for FLA Students.....</b>	<b>3</b>
<b>Requirements for a Degree.....</b>	<b>5</b>
<b>Course Registration .....</b>	<b>8</b>
<b>Examinations .....</b>	<b>14</b>
<b>Grades.....</b>	<b>20</b>
<b>Change in Student Status .....</b>	<b>22</b>
<b>Study Abroad Program.....</b>	<b>26</b>
<b>Certification Programs .....</b>	<b>27</b>
<b>Tuition and Fees.....</b>	<b>28</b>
<b>Announcements from University Offices.....</b>	<b>30</b>
<b>III. FLA CURRICULUM.....</b>	<b>36</b>
<b>Curriculum for students who entered from 2014 .....</b>	<b>36</b>
<b>Curriculum for students who entered before 2014 .....</b>	<b>56</b>
<b>FLA Course List.....</b>	<b>80</b>
<b>Changes in Course Number and/or Title .....</b>	<b>86</b>
<b>IV. INFORMATION ON CURRICULUM .....</b>	<b>88</b>
<b>Course Numbers.....</b>	<b>88</b>
<b>Summer Session.....</b>	<b>90</b>
<b>Certificate Programs.....</b>	<b>91</b>
<b>V. TEACHING STAFF AND FACULTY OFFICES 2014-2015 .....</b>	<b>96</b>
<b>General Information and Office Directory.....</b>	<b>100</b>
<b>Yotsuya Campus.....</b>	<b>104</b>

## I. INTRODUCTION

### **The Educational Ideals of Sophia University**

Based on Christian principles of education, Sophia University attests to the four-hundred-year-old interest of the Jesuit Order in Japan. Its aim is to prepare men and women coming from different countries to recognize in the different cultural traditions of the world the fundamental unity of the human race and to work for the concrete achievement of that unity. The roots of the university go back to 1549, when St. Francis Xavier, a Jesuit, landed in Kagoshima with the hope of starting a Catholic university which would introduce Western culture to Japan. In 1908, nearly 360 years later, three members of the Society of Jesus—the German Father Joseph Dahlmann, the French Father Henri Boucher, and the English Father James Rockliff—came to Japan with the mission of fulfilling St. Francis Xavier’s aspiration. As a result of their efforts, Sophia University was established in 1913, when the Japanese Ministry of Education gave the Jesuits permission to found a new educational institution under the Japanese name of Jōchi Gakuin. Sixteen students enrolled in the first class. From this modest beginning Sophia University has grown to be one of the foremost of Japan’s private universities, with a student body of over 12,000 undergraduate and graduate students and a teaching staff of more than one thousand. In the tradition of the international character of Sophia’s founders, the faculty members represent twenty different nationalities; they are committed to conveying to the next generation through their scholarship and teaching both humankind’s cultural and intellectual heritage and a concern for the problems facing the world today.

### **The Faculty of Liberal Arts**

The Faculty of Liberal Arts continues in a new form the educational approach and goals established by its predecessor, the Faculty of Comparative Culture and its two departments, the Department of Comparative Culture and the Department of Japanese Language & Studies.

The mission of the Faculty of Liberal Arts (FLA) and its Department of Liberal Arts is to prepare students of diverse backgrounds to take the lead in bridging differences and promoting understanding in the complex world of the twenty-first century. Through its broad interdisciplinary curriculum, centered on courses in the humanities, economics and business, and the social sciences, the faculty seeks to enlarge students’ general knowledge, develop critical thinking, and nurture a

broad, humanistic vision. All courses except language courses are conducted in English, and core courses in English composition and public speaking equip students of different linguistic backgrounds to perform at a high academic level. A comprehensive Japanese-language program offers courses in advanced communication skills for native Japanese speakers as well as a full range of classes for non-native students. Courses on Japan distributed throughout the curriculum enable students to understand both present-day Japan and its traditions in a global context.

Graduates of the faculty will receive a Bachelor of Arts degree, 学士(国際教養), accredited by the Ministry of Education, Culture Sports, Science and Technology (MEXT).



## II. REGULATIONS AND PROCEDURES

### GENERAL INFORMATION FOR FLA STUDENTS

#### **The Academic Year**

The Faculty of Liberal Arts follows the same calendar as the other faculties of the university. There are two semesters, beginning in April and September. Each semester consists of 15 weeks of classes, including final examinations. To ensure that each course is held a sufficient number of hours to fulfill the regulations set by the MEXT, make-up class days to offset holidays may be scheduled during each term. For the Academic Year 2014, the following “virtual days” have been scheduled:

Virtual Friday: *October 28 (Tue), 2014*

Virtual Monday: *November 6 (Thu), 2014*

#### **Categories of Students**

##### **1. Degree Students**

Degree students are those who intend to graduate from Sophia. Degree students are admitted in both spring and autumn semesters.

##### **2. Non-Degree Students**

Non-degree students are those who enroll for one year to take courses and obtain credits but do not intend to earn an academic degree from Sophia. This status is applicable only to international students who enroll as full-time students. Non-degree students are admitted in both spring and autumn semesters.

#### **Requirements for Maintaining Non-Degree Status**

A non-degree student must register for the equivalent of at least 10 hours of instruction per week. If the student does not register for a sufficient number of courses or fails to meet the deadline for the payment of tuition and fees, he/she will lose student status at the university.

#### **Change of Student Status**

It is impossible for a non-degree student to change his/her status to that of a degree student without reapplying for admission as a degree student.

### 3. **Non-Matriculated (科目等履修生自由履修コース) Students**

Non-matriculated students are persons of any nationality who wish to take one or more courses of their choice, up to 30 credits in one year, but do not intend to earn a degree from Sophia. In order to be eligible for this status, the student must hold a valid visa for Japan.

#### **Loyola Web Site**

The Loyola web site for teachers and students enables students to:

- Search course schedule and classrooms
- Register and withdraw from courses (there are some exceptions)
- Check their registration status and grades
- Check information concerning cancelled classes, make-up classes, or notices on the web bulletin board through PCs and mobile phones
- Check progress toward fulfillment of graduation requirements using the self-evaluation system
- Update the registered data if there are any changes in the student's or guarantor's address

Please refer to the “Loyola Handbook” (available online via Loyola) for detailed explanations on how to use Loyola.

## REQUIREMENTS FOR A DEGREE

### **Credit Requirements**

The Bachelor of Arts degree is awarded to students who successfully complete the required number of credits according to the distribution specified in the Bulletin of Information for the year in which they were admitted.

A study of 45 hours is required to earn one credit (Government requirements of Standards for Establishment of Universities and Article 22 of Sophia University Regulations).

### **Residence Requirements**

Residence requirements refer to the amount of time a student must be enrolled in the university. With the exception of students who qualify for early graduation, a student must be enrolled for a total of four years (eight semesters) in order to graduate. The time spent on leave of absence or suspension from the university will not be counted as part of the residence requirement.

A student's total period of residence at the university may not exceed eight years, excluding the period of time spent on leave of absence from the university.

### **Deciding Area and Major**

Students accepted into the Faculty of Liberal Arts as freshmen will choose, at the end of the first semester of their sophomore year, a major in one of three areas (Comparative Culture, International Business and Economics, or Social Studies). In the case of Comparative Culture and Social Studies, students must also select a primary and secondary field within the area. At the same time, students are urged to decide which language is to be counted for the general language requirement. Please note that there are rules concerning the general language requirement (see 'LANGUAGES' section of the FLA curriculum).

During the first semester of the second year, students will be notified about the procedures for making the choices mentioned above. Guidance for choosing a major (Sophomore Guidance) will be held every semester. For dates, see the Calendar for the academic year 2014. Students admitted as FLA transfer students at the junior level must indicate their intended major, fields and language at the time of entry.

N.B. The Chair of the Department of Liberal Arts is responsible for matters concerning freshmen and first-term sophomores. The Area Coordinators oversee matters concerning students who have declared an area and major. When, as

specified below, students are directed to consult the Chair or Area Coordinator, they should go to the person responsible for students in their category.

### **Certificates in Japanese Studies and Japanese Language Pedagogy**

In addition to their major, FLA students may also obtain a Certificate in Japanese Studies (日本研究履修証明) or a Certificate in Japanese Language Pedagogy (日本語教授法履修証明). For specifics, see pp.93~95.

### **Preparation for Graduation**

It is the student's responsibility to make sure that he/she has fulfilled all the requirements for graduation. To check their progress toward meeting graduation requirements, FLA students should regularly use the Loyola online self-evaluation system (Loyola, see p.12). Any problems arising from the self-evaluation must be resolved with the Center for Academic Affairs before registration in a student's last semester. Refer to the online handbook of the self-evaluation system for details.

### **Early Graduation**

To qualify for early graduation, a student must complete at least three years (six semesters) of study, complete all credits required for graduation, and have a cumulative GPA of 3.50 or above. The FLA faculty meeting will review and decide upon applications for early graduation.

*Application procedure:*

1. If a student wants to graduate after completing six semesters, he/she should submit an application form to the FLA office by the end of the fifth semester.
2. If a student wants to graduate after completing seven semesters, he/she should submit an application form to the FLA office by the end of the sixth semester.
3. The applicant must be able to complete the credits required for graduation within the following term. Please note that the maximum number of credits for which an upper-class student may register is 24 credits per term. Thus students who wish to apply for early graduation at the end of the autumn term must have no more than 24 credits remaining. For those who want to apply for early graduation at the end of the spring term, the maximum number of outstanding credits is 30 (24 for spring term and 6 for the Summer Session).
4. The student must already have a GPA of 3.50 at the time of application.
5. Transfer students are not eligible for early graduation.
6. If the student wants to withdraw the request, he/she must notify the Chairperson during the withdrawal period.

### **Transfer of Credits and Residency**

Students who have studied at other universities before entering Sophia University may be eligible to transfer credits and residency time. There are two categories for transferring credits and residency.

#### *Transfer of credits earned before entering as a freshman:*

Up to 30 credits (nyūgakumae nintei) may be transferred. Students using this system may transfer credits, but not residency. However, students who meet all of the other qualifications may apply for early graduation (see p.6).

#### *Transfer of credits and residency for students admitted as transfer students:*

The number of credits to be transferred may not exceed half of the required number of credits for graduation. Decisions about the transfer of credits will be made after consultation with the student's Area Coordinator. As a general rule, a transfer student must have completed at least two years of university/college work as a regular student at another institution before entering Sophia. A transfer student may transfer a two-year period of time in residence at his/her previous university/college. Acceptance as a third year student does not necessarily mean that you will automatically graduate in two years.

#### *Application for transfer of credits:*

Students should apply for transfer of credits within three months of entering Sophia University. For that application, you need to bring the following documents from your previous university:

- (1) official transcript (in English)
- (2) grading system explanation
- (3) academic calendar
- (4) syllabus of each course, containing brief course description and course schedule

For (3) and (4), the description must be for the year that you registered for the courses.

## COURSE REGISTRATION

### Course Registration Procedure and Schedule (SPRING & AUTUMN 2014)

Event		SPRING	AUTUMN
1. Individual Advising		April 7 (Mon), 10:30 - 12:00	September 27 (Sat), 10:30 - 12:00
2. Course Registration		Sophomores, Juniors & Seniors: April 3 (Thu), 10:00 - April 15 (Tue), 21:00  Freshmen, Exchange & Non-degree: April 4 (Fri), 10:00 - April 15 (Tue), 21:00	Sophomores, Juniors & Seniors September 21 (Sun), 10:00 - October 1 (Wed), 21:00  Freshmen, Exchange & Non-degree: September 22 (Mon), 10:00 - October 1 (Wed), 21:00
3. First Lottery Registration	Period	Sophomores, Juniors & Seniors: April 3 (Thu), 10:00 - April 7 (Mon), 18:00  Freshmen, Exchange & Non-degree: April 4 (Fri), 10:00 - April 7 (Mon), 18:00	Sophomores, Juniors & Seniors: September 21 (Sun), 10:00 - September 26 (Fri), 18:00  Freshmen, Exchange & Non-degree: September 22 (Mon.), 10:00 - September 26 (Fri), 18:00
	Registration Results Available Online	April 8 (Tue), 13:00	September 27 (Sat), 13:00
4. Second Lottery Registration	Period	April 8 (Tue), 13:00 – April 9 (Wed), 18:00	September 27 (Sat), 13:00 – September 28 (Sun), 18:00
	Registration Results Available Online	April 10 (Thu), 13:00	September 29 (Mon), 13:00
5. Third Lottery Registration (Foreign language courses only)	Period	April 10 (Thu), 13:00-21:00	/
	Registration Results Available Online	April 11 (Fri), 13:00	
6. Final Lottery Registration (first-come, first-served basis)		April 11 (Thu) 13:00- April 15 (Tue) 21:00	September 29 (Mon) 13:00- October 1 (Wed) 21:00
7. Beginning of Classes		April 12 (Sat)	September 27 (Sat)
8. Result of Course Registration Available Online		April 16 (Wed), 10:00 - April 17 (Thu), 21:00	October 2 (Thu), 10:00 - October 3 (Fri), 21:00
9. Self Evaluation & Category Changes via Loyola		April 1 (Tue), 10:00 - April 21 (Mon), 23:59	September 21 (Sun), 10:00 - October 6 (Mon), 21:00
10. Course Adjustment		April 18 (Fri), 10:00 - April 21 (Mon), 21:00	October 4 (Sat), 10:00 - October 6 (Mon), 21:00
11. Final Confirmation of Course Registration Available Online		April 23 (Wed), 13:00	October 8 (Wed), 13:00
12. Cancellation Period		April 24 (Thu) – 28 (Mon) 17:00	October 9 (Thu) – 13 (Mon) 17:00
13. Withdrawal from Courses		June 6 (Fri), 10:00 - June 11 (Wed), 21:00	December 8 (Mon), 10:00 - December 12 (Fri), 21:00

### **1. Course Information / Registration Materials**

After the designated distribution period, the following materials will be available at the Center for Academic Affairs:

- FLA Bulletin of Information
- Sophia University Handbook of Course Registration (履修要覧) : available only in Japanese; on request for students registering for courses offered by other faculties and programs.

The following material is available at the FLA office in Building No. 10:

FLA Academic Record Sheet (for keeping track of credit requirements).

### **2. Individual Advising**

Individual advising will be offered by the FLA at the beginning of each semester. All students are urged to see an advisor. Freshmen and first-term sophomores should consult the Freshman Advisor assigned to them when they entered the university. Students who have declared their major should consult the Area Coordinator. The dates for the advising sessions will be posted on the Loyola bulletin board.

When consulting their advisor or Area Coordinator about their individual programs, students should bring their transcript and academic record sheet. In planning their programs, students should pay attention to the following points.

### **3. Limit on Number of Credits per Semester**

Freshmen may register for a maximum of 20 credits per semester. Sophomores and above may register for a maximum of 24 credits per semester. These upper limits include courses taken from other faculties and programs. Registration for more than 24 credits (or 20 credits in the case of freshmen) is not allowed. However, junior and senior students seeking certification as junior high school or high school teachers or as curators may register for additional credits required for such certification. They should consult with the Center for Teaching and Curator Credentials. If you would like to register for additional credits for other reasons, please consult with the FLA office.

### **4. Course Conflict**

A student may not register for two courses scheduled for the same day and hour. Students may not attend courses for which they have not officially registered.

## 5. Course Registration

Students may register for FLA courses and courses offered by other faculties and programs during the course registration period online (Loyola). During the course registration period, adjustment (add/delete) can be made any number of times except for lottery courses.

**Course Registration online** ( URL : <https://scs.cl.sophia.ac.jp/campusweb/> )

### **【Note】**

- Unless an exception is specified, you cannot register for the same course you have already received credits for. Same courses are, generally, courses that have the same course code. If you need to register for a course which has the same code, please inquire at the Center for Academic Affairs.
- For courses offered by other faculties and programs, refer to the Handbook of Course Registration (履修要覧).
- For online course registration, you must complete registration by the closing time on the last day of the Course Registration Period. Registration is finalized only when you click the "登録完了" (complete registration) button on the Course Registration screen. Note carefully that your registration will not be finalized unless you click on the button "登録完了" before the closing time. Also note that heavy access is expected on the last day of the registration period. Try to finalize your registration by the day before the closing date.

## 6. Lottery Courses

Lottery courses are courses with limited class capacity, which include "Studies in Christian Humanism," Information Literacy (compulsory for students who entered before 2011), and courses which are held in computer rooms and CALL rooms. The class capacity is indicated in the Remarks column on the course list. To take lottery courses, students must register during the lottery course registration period of each semester. The lottery is conducted by computer and only selected students in the lottery are registered for the course. Students should be careful when they register for these courses since these courses cannot be deleted until the cancellation period.

## 7. FLA Core Courses

Students who are scheduled to take FLA Core courses are assigned to class sections at the beginning of each semester. These assignments cannot be changed. Students must register for the sections to which they have been assigned.

Students must enroll in the FLA Core Program courses in sequence. If a student fails a Core Program course (including Basic Skills), he/she must repeat and pass that course before proceeding to the next level. Neither cancellation nor withdrawal is allowed from FLA Core Program courses, including Basic Skills.

For details see page 13.



## **8. Courses offered by other faculties and programs**

In addition to FLA courses, students may take courses offered by other faculties and programs as part of their graduation requirement. Except for compulsory courses such as "Studies in Christian Humanism", "Wellness, the Body and Culture" and some language courses (French, Spanish, Chinese and Japanese), most of the courses are conducted in Japanese. To register for courses offered in Japanese, a student must be a "graduate of a Japanese high school" or have demonstrated sufficient proficiency in Japanese by receiving a qualifying score on the Japanese Placement Test or passing JPN343, Reading and Writing 3.

Types of the courses offered by other faculties and programs

1. Zengaku Kyotsu Kamoku (全学共通科目 General Studies)
  - i. University wide General Studies Courses not offered by FLA.  
These courses can be counted as General Studies Electives only. The courses are listed in the 2014 年度 履修要覧.
  - ii. Gaku-Zen Kamoku (学全科目)  
These courses may be counted as General Studies electives and Specialized Education electives courses. If a student takes these courses as Specialized Education electives courses, up to 16 credits can be included. The courses are listed in the 2014 年度 履修要覧.
2. Language
  - i. Japanese language courses.
  - ii. Language courses for FLA students (conducted in English).
  - iii. Language courses (conducted in Japanese).
3. Specialized education courses offered by other faculties and programs  
If a student takes these courses as Specialized Education electives courses, up to 16 credits can be included. Please check the course syllabus to know whether it is open to the students of other departments.

## **9. Result of Course Registration**

Results of course registration will be available via Loyola. Please make sure to confirm the results and prepare for the course adjustment, if necessary.

## **10. Self Evaluation and Category Changes on Loyola**

Students must check their own accumulated credits and adjust the category of courses via Loyola. Seniors should be careful to confirm that their self-evaluation is accurate, especially the category into which a course is placed.

Please note that the function is not to ensure graduation.

### ■ “Self Evaluation” function:

The function allows you to check your status of courses you have taken and the credits earned for each category of graduation requirements, and to calculate the missing number of credits you need to graduate based on the sum total of credits of courses you are currently taking and the credits you have earned so far.

### ■ Self Evaluation function available period

Self Evaluation function on Loyola is available for a designated period only. For the schedule of available periods during the 2014 Academic Year, check the Loyola Bulletin Board (Academic Services).

### ■ “Change of category” function

It allows students to change the category of courses to meet their graduation requirements.

**In recent years, there have been cases of students who do not realize until just before they expect to graduate that they are not eligible to graduate due to errors in calculating the credits required and credits taken.**

To avoid such misunderstanding, students should use Self Evaluation and Change of category functions and Bulletin of Information, as the students themselves are responsible for keeping track of their credits.

## **11. Course Adjustment**

Students can change or add courses (except lottery courses) any number of times during this period. As this is the final chance to register for courses, be careful.

## **12. Final Confirmation of Course Registration**

Final confirmation of course registration will be available online. Please make sure you check the registration on Loyola carefully. It is the student’s responsibility to confirm that his/her registration is correct.

### **13. Cancellation Period**

If there are any errors in a student's course registration, he/she should apply for cancellation of course(s). Students are allowed to cancel with an approval from the Chair. This must be done before the end of the cancellation period. Note that only cancellations are allowed. **Under no circumstances may courses be added at this stage.**

### **14. Withdrawal from Courses**

If a student decides after the cancellation period not to finish a course for which he/she has registered, the student should apply to withdraw from the course online (Loyola). Please note that the student will be responsible for full payment of the tuition charged for the course. If a student discontinues attending a course and does not complete withdrawal online during the withdrawal period, he/she will receive an "F" for the course. The grade of "W" will not be calculated into the student's GPA, but an "F" will. Students may not withdraw from compulsory courses in Health and Physical Education and Information Literacy (if taken as a GS compulsory course), from compulsory courses in the English Skills/FLA Core Program, and from language courses. For regulations on withdrawal from language courses, see 'LANGUAGES' section of the FLA curriculum.

## EXAMINATIONS

### Types of Examination

Examinations are held during or at the end of term in spring and autumn semesters, and are categorized in the following types:

Type of exam	Exam period / deadline of submission	Announcements of exam schedule, etc.	Make-up exam	Notes
In-class Examinations	Any time during class sessions (usually on the last day of class)	Given in class by the class teacher	Not applicable	Foreign language courses usually have in-class exams
Final Examinations (written tests)	During Final Exam period	Announced on Loyola by Center for Academic Affairs	Will be held	General information is announced on Loyola Bulletin Board; note that the class teacher may give additional instructions in class.
Final Papers	To be submitted by the deadline set at end of the term		—	

### Final Examination Schedule

The final examination schedule will be announced on the Loyola bulletin board each semester two weeks before the first day of final examinations. Students are responsible for noting accurately the dates, the times, and the classrooms of the examinations for the courses in which they are enrolled. Basically, final exams in the Faculty of Liberal Arts are 90 minutes in length.

### Examination Policy

Note the following policies concerning examinations:

1. The student must take the examination in the prescribed classroom.
2. The student's ID card must be placed on the desk during the examination.
3. If a student forgets his/her ID, he/she must obtain a Temporary ID Card (Fees : 500 yen) from the automatic certificate issuing machine on the 3rd floor in Building 2. Valid only for the day of issuance.
4. Students who come to the classroom more than 20 minutes after the beginning of the examination will not be allowed to enter under any circumstances. Also, no student may leave the classroom until 30 minutes after the beginning of the

- examination.
5. No student may leave the classroom unless he/she has submitted his/her answer sheet.
  6. Mobile phones must be turned off and kept in the student's bag. They are not to be used for any reason during the exam.
  7. As a rule, students are given only one answer sheet. If a student needs another answer sheet, he/she must return the first answer sheet.
  8. If a student wishes to use an underlay pad for writing, it must be completely white or almost so. Using a notebook or other book as an underlay is not permitted.
  9. A student's answers will become invalid under the following circumstances:
    - a. When there is no name or no ID number written on the answer sheet.
    - b. When any paper is submitted to the proctor other than the answer sheet handed out.
  10. A student may be ordered to leave the classroom and have his/her answers invalidated under the following circumstances:
    - a. When a student continues to talk unnecessarily or exhibits improper behavior even after being warned.
    - b. When a student does not immediately follow the proctor's instructions.

### **Academic Dishonesty**

It is expected that all students will follow the highest standards of academic honesty.

#### **1. Cheating**

If a student is found cheating in an exam or violating an exam policy/rule, the University will impose severe punishment. Honest performance is also expected at in-class exams held during class sessions. The following are some actions that would be considered as cheating:

- Using materials that are not permitted
- Exchanging answer sheets with other students
- Bringing in answer sheets written prior to the exam
- Taking the exam for another student or having another student take the exam for you
- Using mobile phones or other communication devices. (You may not use them even as a watch to check the time.)
- Other actions that violate the rules for administering exams

The consequences of cheating are as follows.

- The student will be suspended or dismissed from the university, depending on the seriousness of the offense.
- The grade "F" will be entered on the student's record for the course.
- The student's grades for all other courses that have final written examinations during the final exam period will also be canceled.
- The suspended period will not be counted in the residence requirement and graduation will be delayed.
- Any scholarship the student is receiving from the university will also be canceled.
- The student's qualification for study-abroad, overseas short-term language/Study Abroad program, and nominations to university-organized programs may be canceled.

## **2. Plagiarism**

Plagiarism will result in a failing grade for a course. Plagiarism is defined as the use of the words or ideas of others, whether unintentional or deliberate, without proper acknowledgment. This includes claiming authorship for material taken from books and other publications and material found on the internet, as well as the use of papers purchased online or previously submitted by other students in the faculty. Instructors who find evidence of plagiarism have the discretion to fail the student in all or part of the course, and severe punishment, as imposed when cheating in exams, may also be applied. When a student is unsure whether or not a particular behavior might constitute an act of plagiarism, he or she should seek clarification from a member of the faculty.

## **Make-up Exams**

If a student is unable to take a final exam for one of the reasons specified, they may be allowed to take make-up exam by submitting an "Application for Make-up Exams". This application must be submitted during the given period, and the student will need to obtain permission and pay a make-up exam fee.

No make-up examinations are allowed for courses that held in-class exams (other than Final Exams period).

### **1. Legitimate reasons for applying for make-up exams**

Legitimate reasons include illness, family emergencies involving someone with a third degree of kinship, disasters, delay in public transport service, and appointment to lay judge service. The application for Make-up Exams must be accompanied by the following supporting documents to prove that the student was unable to come on the day of the final exam(s). The application procedure must be completed within the specified period.

## 2. Supporting documents and procedures

When applying for a make-up exam, bring the necessary supporting document (see below) and a print-out of the Loyola final exam inquiry screen.

1. Illness	Medical certificate or permission to return to school issued by a physician *Payment receipts are not acceptable.
------------	--

The medical certificate must state all of the following:

- a) The name of the illness and a statement by physician attesting that the student was not in a condition to take an exam on the day of the exam.
- b) A statement attesting that the student was unable to come to the exam because of a scheduled consultation or because the student was undergoing treatment.

If the student had to be absent over several days, the medical certificate must clearly show that these days include the consultation day or the treatment period. If the medical certificate does not state both a) and b), it will be deemed incomplete document and the student will not be able to apply for a make-up exam.

\*In case of an infectious disease, application for the make-up exam(s) must also be filed during the designated application period for the make-up exams. If a student is unable to come to campus due to the infectious disease, he/she should contact the Center for Academic Affairs by phone before the end of the application period.

2. Bereavement involving a third degree of kinship	Funeral service card/thank you card, etc. addressed to funeral guests
--	---

The cards must show the date of the exam the student was unable to take.

✘ The travel days will not be applicable to make-up exams.

3. Delay in public transport service	Delay certificates issued by the public transport service (indicating the date and the delayed time); a delay certificate printed out from the Internet is also acceptable.
--------------------------------------	---

If the delay in public transport service was 20 minutes or more and a student arrived at the exam more than 20 minutes past the scheduled starting time, he/she may apply for a make-up exam. However, the application must be filed on the very day of the delay in public transport service.

Note: An application for make-up exams due to the transportation delay will not be accepted on the day following the exam day or later.

NB:

\*If a student is unable to come to the university on the day of the delay for unavoidable reasons such as a shutdown of public transportation services, or a long distance commute, a “tentative application” must be made by telephone to the Center for Academic Affairs before 17:00 on the day of the delay (for exams held in the 5-6th class periods, before the end of the exam time). If the student fails to file the “tentative application” during the above period, or if a proper application is not made following the “tentative application” during the specified period, he/she will not be allowed to apply for a make-up exam whatever the reasons may be.

\*The delay will be accepted only on a student’s normal commuting route between his/her home and the university. The Center for Academic Affairs will check the address given on the “commuting route certificate seal” on the back of the Student ID Card before accepting the application for the make-up exam.

\*The delay certificate must show a delay longer than the actual length of the student’s delay (e.g. the delay certificate must prove a delay of more than 30 minutes). Application for make-up exam will not be accepted if the student did not make an effort to arrive on time for the exam.

\*A proxy application submitted by someone other than the student himself/herself will not be accepted for reasons of delay in public transport service.

If a student arrives late for the exam because of a delay in public transportation service, the student should take one of the following steps depending on the length of the delay;



(1) If a student arrives within 20 minutes of the scheduled exam starting time, he/she is allowed to take the exam. In such cases, the student should go directly to the classroom and take the exam.

(2) If a student arrives more than 20 minutes after the starting of the scheduled exam, he/she should immediately bring the delay certificate to Center for Academic Affairs (Academic Services) on 1st floor, Bldg. No.2., have the arrival time checked, submit the delay certificate and then apply for a make-up exam.

If the student is not sure where to go, he/she should go first to the exam room and follow the instructions of the exam supervisor.

If the reason for applying for make-up exam is a natural disaster, selection for lay judge service, or some other reason, please inquire at the Center for Academic Affairs Make-up Exam section for more information on the application procedures.

3. Make-up exam fee: 2,000 yen per course

4. Make-up exam schedule

Schedule will be announced on Loyola Bulletin Board for Center for Academic Affairs (Academic Services).

## GRADES

### Grading

A student's work is graded according to the following table:

Grade	Scale		Quality Point Index
A	100-90	Excellent	4.0
B	89-80	Good	3.0
C	79-70	Satisfactory	2.0
D	69-60	Passing	1.0
W		Withdrawal	
F		Failure	

### Grade Point Average (GPA)

Each grade is assigned a weight called the quality point index (QPI: e.g., A=4.0, etc.). The QPI multiplied by the number of credits for the course determines the quality points (QP) for that course. The sum of all the quality points divided by the total number of credits attempted (including the credits of a course for which an "F" is assigned) gives the grade point average (GPA).

N.B.

Grades received for courses offered by other faculties and programs will also be calculated into the student's grade point average.

### Grade Review

Students must confirm their grades via Loyola at the end of the semester. If a student believes there has been a mistake in the grades, he/she may submit a request for grade review to the Center for Academic Affairs. Note that the purpose of this procedure is to confirm the accuracy of the grade recorded, not to petition for changing a grade. Final authority regarding grades rests with the instructor. No requests for grade review can be accepted after the deadline for submitting such requests.

*Deadline for Grade Review:*

*2014 Spring courses: September 26 (Fri), 2014*

*For graduating students: August 26 (Tue) - August 27 (Wed), 2014*

*2014 Autumn courses: March 31 (Tue), 2015*

*For graduating students: February 26 (Thu) - March 2 (Mon), 2015*

### **Repetition of a Course**

Unless otherwise specified, a student may not repeat for credit a course in which he/she has received a passing grade. If a student repeats the same course, the previous record will not be deleted from the transcript. This applies as well to courses being offered under a new name or number (see p.88-89, Change in Course Number and/or Title).

### **Honors**

The Dean's List is published each semester. To qualify, a student must be a degree student and have a semester average of 3.5 or better out of a possible 4.0 and must have completed at least 16 credits during the semester concerned.

### **Attendance at Classes**

Students are expected to attend all classes except in cases of illness (See p.33 "Infectious diseases") or urgent necessity, for which written proof must be submitted to each instructor. Regardless of the excuse, absences do not exempt a student from quizzes, tests, examinations, or other written work required during the period of absence. The responsibility for making up such work rests wholly upon the student. A failing grade for the omitted work will be assigned if the student does not fulfill his/her obligations within the time set by the instructor.

## CHANGE IN STUDENT STATUS

### Leave of Absence

A student who wishes to take a leave of absence must consult the Department Chairperson and submit a completed “Request for Leave of Absence” form (休学願). If the reason is illness, the form must be accompanied by a doctor’s certificate (診断書).

The period of leave of absence is not counted in the residence requirement and graduation will be delayed for the duration of the absence. A student who is taking a leave of absence cannot graduate in that term.

#### 1. Period of Leave of Absence

A leave of absence may be requested semester by semester. A leave of absence may not extend over two sequential years or a total of 4 years (Article 32 University Regulations).

#### 2. Deadline to Submit Request

	Period of Leave of Absence	Deadline to submit request
Spring Semester	April 1 – September 20, 2014	May 30 (Fri), 2014
Autumn Semester	September 21, 2014 – March 31, 2015	November 28 (Fri), 2014

A student who intends to take a planned leave of absence must submit the “Request for Leave of Absence” at least one month prior to the beginning of the semester of the planned absence.

Any request submitted after the deadline will not be accepted for any reason. If the request is sent by postal mail, it must be postmarked on or before the deadline date. The request for leave of absence may be submitted for two consecutive years of absence.

#### 3. Tuition and Fees

There will be a reduction of the tuition and fees during a leave of absence. For more details, inquire at the Academic Records Section: Tuition and Fees, the Center for Academic Affairs.

#### 4. For Foreign Students with College Student Visa

Students with a College Student Visa who take a leave of absence may lose their status of residence in Japan. For details, please consult with the Academic Records Section.

## **5. Resuming Studies**

When the period for Leave of Absence is over, student status returns automatically, so there is no need to submit an “Intent to Resume Studies” form (復学届). However, in the following cases, it is necessary to submit the “Intent to Resume Studies” form before the beginning of the semester.

- 1) Leave of Absence due to illness (attach doctor’s certificate)
- 2) A student wishes to return to studies earlier than scheduled: that is, when permission for the leave was obtained for 2 or more semesters but the student wishes to shorten the period of absence because the reason for taking the leave no longer exists (the period may not be shortened to less than one semester).

## **Withdrawal and Dismissal**

There are two types of withdrawal from university: voluntary withdrawal and dismissal.

### **1. Date of Withdrawal**

Date of withdrawal is the last date of the semester (September 20 or March 31).

### **2. Voluntary Withdrawal**

A student wishing to withdraw from university for certain reasons must consult the Department Chairperson, complete the "Request for Withdrawal from the University"(退学願) and submit the request to the Academic Records Section with the Student ID Card before the desired date of withdrawal.

### **3. Dismissal from the University**

The following students shall be dismissed from the university:

- 1) Expiry of Period of Enrollment  
Students whose period of enrollment (excluding leave of absence period) exceeds 8 years.
- 2) Students to whom Article 40\* of the University Regulations applies  
Students who fail to obtain 32 credits or more including subjects specified by undergraduate departments in two consecutive academic years.\*\*
- 3) Failure to pay tuition and fees  
Students who fail to pay the tuition and fees before the set deadline.
- 4) Other reasons  
Students to whom Articles 60 and 61 of University Regulations apply.

**\*Preferential Measures**

Upon deliberation by the faculty meeting, a student who is in the third-year or above, and who has taken less than 32 credits in two consecutive academic years may be exempted from expulsion by Article 40, if the total number of credits taken divided by the number of total years of enrollment is more than 16 credits. In this case, the academic year which includes the period of leave of absence is not counted in the total period of enrollment but the credits earned shall be included in the total number of credits taken.

In the case of students of the Faculty of Liberal Arts and the English Programs in the Faculty of Science and Technology, the total number of credits earned divided by the number of semesters of enrollment should be more than 8 credits.

\*\* "Two consecutive academic years" refers to two academic years of enrollment. If the student takes a leave of absence, the academic year that includes the period of leave of absence will not be counted as a part of the "two consecutive academic years," and instead, the academic years before and after the year of leave of absence will be considered as those "two consecutive years."

For students of the Faculty of Liberal Arts, "two consecutive academic years" refers to four consecutive semesters excluding the period(s) of leave of absence.

**Change of Faculty/Department**

Students who wish to change to a department of another faculty and who satisfy the following requirements may do so by submitting a request. After submitting the request, the student will take an exam given by the department.

**Eligibility**

- 1) The student has completed or is expected to complete at least two years of study at the time of the requested change (period of leave of absence is not included).
- 2) The student has a 2.6 GPA or higher for credits obtained in University-wide General Studies (Zengaku Kyotsu).
- 3) The student satisfies all requirements set by the department he/she wishes to change to.
- 4) There is adequate reason for the change.

**Re-admission**

A degree student who has withdrawn or been dismissed from the university may re-enter the university upon approval of his/her application. However, if a re-admitted student withdraws or is dismissed a second time, or if the student was dismissed because his/her length of residence had reached the limit of eight years, he/she will not be allowed to apply for re-admission. Further information is available at the Academic Records Section.

**Admission for a Second Degree**

Graduates of Sophia may apply to enter another faculty or department. Further information is available at the Academic Records Section.

## STUDY ABROAD PROGRAM

**1. Exchange Program:** Students participating in this program are regarded as simultaneously enrolled at Sophia and a foreign institution. Degree students who wish to study at an exchange partner institution are permitted to do so only if the Department Chair or Area Coordinator determines that such a choice would be educationally beneficial for the student. Internal screening will be conducted at Sophia approximately one year before the beginning of the exchange period. The students must first pass the internal selection process to be nominated to the exchange program. Students studying abroad at a school with which Sophia has a formal exchange agreement receive reciprocal treatment regarding credits and school expenses. For details, see “Handbook for Study Abroad.”

**2. General Study Abroad Program:** Students who plan to study abroad on their own and wish to transfer the credits back to Sophia must apply in advance to the General Study Abroad Program. Credit transfer arrangements are the same as for Exchange Program students, but students must apply independently to an approved institution and arrange their own accommodation. Also, in contrast to the Exchange Program, students participating in the General Study Abroad Program must pay tuition and fees both to Sophia and the overseas institution. For details, see “Handbook for Study Abroad.”

\* For both the Exchange Program and the General Study Abroad Program, students may study abroad for one year or one semester without taking a leave of absence.

**3. Short-term Language Programs:** Sophia sends students to several language programs at designated overseas universities during the summer and spring vacations. By participating in these programs and successfully completing the courses, students will be able to earn language credits that can be used for fulfilling Sophia's graduation requirements.

**4. Short-term Study Abroad Programs:** Sophia sends students to several intensive programs on specialized subjects at designated overseas institutions during the summer and spring vacations. By participating in one of these programs and successfully completing the courses, students earn credits that can be transferred, with the approval of their department, as specialized education or general studies credits.



## **CERTIFICATION PROGRAMS**

Pending completion of the required course work, FLA degree students may obtain certification in the following areas: Teacher Certification (教職課程) and Curator Certification (学芸員課程). These programs are taught only in Japanese. Students interested in these programs are strongly advised to attend the special guidance meeting held by the Center for Teaching and Curator Credentials. Notices will be posted on the bulletin board for Certification Programs. Further information may be obtained at the Center for Teaching and Curator Credentials.

For regulations about the credits for courses required for Teacher and Curator Certification, see ‘SPECIALIZED EDUCATION ELECTIVES’ section of the FLA curriculum.

## TUITION AND FEES

### Tuition and Other Fees: Academic Year 2014

#### 1. Degree Students

Currency : Japanese Yen

	Entrance Year				
	2014	2013	2012	2011	before 2010
Entrance Fee	270,000	—	—	—	—
Semester Enrollment Fee	30,000	30,000	30,000	30,000	30,000
Tuition Fee per credit (1)	30,000	30,000	30,000	30,000	30,000
Education Enhancement Fee (per semester)	117,600 (2)	90,000	90,000	90,000	90,000
Alumni Association Fee (per year)	5,000	5,000	5,000	5,000	—
Dues for Sophia University Student Health Insurance Mutual Union (per year) (3)	—	—	—	2,000	2,000
Premium for Personal Accident Insurance for Students Pursuing Education and Research (4)	2,650	—	—	—	800

(Note) Starting in Academic Year 2014, categories of payment have been changed.

Up to 2013: Entrance Fee, Tuition Fee, Orientation Fee, Building & Maintenance Fee, Laboratory & Research Fee, Correspondence Fee (Including Consumption Taxes)

From 2014 on: Entrance Fee, Semester Enrollment Fee, Tuition Fee, Education Enhancement Fee

(1) Tuition fees are revised annually in accordance with changes in personnel expenses and operating subsidy from the government.

(2) For student who enter in Spring 2014, the amount due for the Autumn semester is ¥100,000.

(3) Students who entered in 2011 and before are required to pay ¥2000 per year (until 2014).

(4) If a student studies beyond the standard residence requirement, he/she will be charged ¥800 per year.

#### 2. Non-Degree Students

Currency : Japanese Yen

	Entrance Year	
	2014	2013
Registration Fee (per year)	27,000	27,000
Tuition Fee (per credit)	30,000	30,000
Education Enhancement Fee (per semester)	100,000	90,000

## **Payment of Tuition and Fees**

### **1. Calculation of Tuition and Fees**

After final confirmation of course registration, a single adjusted bill will be issued, which will include all tuition and fees required for the term in question. For first-term students, the bill will include only tuition and the remaining fees that are not paid prior to entrance. Once registered for a course, a student is responsible for the payment unless he/she cancels the course during the Course Adjustment Period or Cancellation Period. Students are responsible for paying for any course from which they withdraw after the Cancellation Period.

### **2. Issuance of Bills**

*Dates when bills of tuition and fees are sent:*

*Spring 2014: May 7 (Wed), 2014*

*Autumn 2014: October 17 (Fri), 2014*

A bill and remittance form will be mailed to the student's address on the dates indicated above. Any student who does not receive the bill within one week after its issuance should notify the Center for Academic Affairs.

### **3. Deadline for Full Payment**

*Deadline for full payment of tuition and fees:*

*Spring 2014: May 23 (Fri), 2014*

*Autumn 2014: October 31 (Fri), 2014*

Failure to complete payment will result in dismissal from the university.

Students who are experiencing financial difficulties should consult with the Center for Student Affairs for scholarship and other information.

### **4. Fees to Be Paid During a Leave of Absence**

During a leave of absence, the following fees must be paid by the tuition payment deadline:

Semester Enrollment Fee, Education Enhancement Fee (only first-term students), Alumni Association Fee, Dues for Sophia University Student Health Insurance Mutual Union, and Premium for Personal Accident Insurance for Students Pursuing Education and Research.

## ANNOUNCEMENTS FROM UNIVERSITY OFFICES

### Bulletin Boards

Notices concerning classes (cancelled classes, make-up classes, change of classrooms, and exam schedules) and announcements for individual students, including urgent matters, will be posted on the Loyola online bulletin board. Some notices may also be posted on university bulletin boards (see p.105 for the location of the bulletin boards). All students are strongly advised to check the Loyola and university bulletin boards regularly.

### Certificates

Various certificates can be obtained either from the certificate issuance machine or at relevant offices. Check the type of certificate you need and apply as follows:

#### Certificates from the certificate issuance machine

Certificates	Fees	Day of issue	Notes
Certificate of Attendance (Japanese / English)	¥100	On the same day	Issuance machines are installed on: · 3rd floor, Bldg. No.2; · Mejiro Seibo Campus (in office center)  Service Hours: Mon. - Fri. 9:00 to 17:00 *any changes due to school events will be announced
Official Transcript (Japanese / English)	¥200		
Certificate of Prospective Graduation (Japanese / English)	¥100		
Student Discount Certificate (up to 10 per year)	free		
Medical Checkup Certificate (university designated form in Japanese only)	¥300		
Temporary Student ID Card (issued only during Final Exam period)	¥500		

Please follow the voice instructions of the certificate issuance machine on how to operate the machine.

- \* Student ID Card is required in order to have the certificate issued. The certificate issuance machine is available for current students only.
- \* The Certificate of Prospective Graduation certifies that the student is eligible to graduate if the student has met all graduation requirements, but it does not mean that the University guarantees the student's graduation.
- \* For the password, inquire at the Center for Academic Affairs, Academic Records Section.

Certificates issued at the Center for Academic Affairs
--

Certificates	Fees	Day of issue
Certificate of prospective acquisition of teacher's license	¥400	Takes 3 working days from the application date
Certificates necessary for application of "Permission to change the status of residence" and "Permission to extend period of stay"	¥100	Application received → Day of issue • Mon./Tue. → Fri. • Wed./Thu. → following Mon. • Fri. → following Wed.
Re-issue of Student ID Card	¥800	On the same day

Office in charge: Center for Academic Affairs, Academic Records Section  
1F, Bldg. No.2

Office hours: Mon. - Fri. 9:30 - 11:30, 12:30 - 17:00

\* Any changes due to school events will be announced on Loyola.

- 1) Complete the application form available at the office.
- 2) Purchase the fee payment sticker from the vending machine and place it on the application form.
- 3) Submit the application form with your Student ID Card to the office. Receipts will be issued to the applicant.
- 4) On the day of issue, show the receipt at the office and receive the certificate.

### Student Identification Card (ID Card)

The Student ID Card certifies that you are a student of Sophia University. Carry it with you at all times as you may be asked to show it in various situations both on and off campus. Services may not be provided if you do not have your Student ID Card.

Student ID Cards should not be lent or given to another person whatever the reasons may be. Return the Student ID Card to the university when you lose your student status by withdrawal from university.

You will need the Student ID Card in the following cases:

- 1) to take exams
- 2) to use the certificate issuance machine and obtain a certificate or student travel fare discount certificate
- 3) to enter the university main library and borrow library books
- 4) to buy your commuting pass
- 5) to show at the request of officials when you are on trains, etc. using a commuting pass or student discount ticket
- 6) to show when requested by a faculty member or staff of Sophia University

### 1. Valid Enrollment Sticker

The student ID Card is valid only with a current Enrollment Sticker (*Zaiseki – kakunin Seal*) affixed on the back. The sticker is valid for one year; Students should obtain a valid current sticker at the beginning of each academic year. Notify the Academic Records Section if there are any changes to your address or commuting route, or when there is no vacant column left in the commuting pass issue record.

### 2. Changes in the data of Student ID Card

If there are any changes or errors in the data (name, date of birth, etc.) on the Student ID Card, notify the Academic Records Section.

### 3. Lost, damaged or defective Student ID Card

Request a re-issue of your card at the Academic Records Section; purchase a fee payment sticker (800 yen) and place it on the designated form of “Request for re-issue of Student ID Card” (学生証再発行願).

## **Guarantor**

Sophia University requires all students to have a guarantor. Sophia University sends important notices regarding academic affairs and school newsletters to the guarantor’s address, or may contact the guarantor in the case of emergency.

A guarantor should be one of the below (listed in order of priority) :

1. A parent who lives in Japan.
2. A person who lives in Japan and earns his/her living independently.
3. A person who earns his/her living independently and who lives in a foreign country. (This option is only for non-Japanese students)

## **Change of Guarantor, Student Name, Other Changes**

If there are any changes in your or your guarantor's address, renew the registered data on Loyola under the address registration menu. In case your guarantor's address is outside Japan, submit a notification by designated form available at the Academic Records Section (This option is only for non-Japanese students). If a student's address is changed, he/she should obtain a new enrollment sticker (*Zaiseki-kakunin Seal*) at the Academic Records Section.

If there is a change in your name, submit a notification by designated form available at the Academic Records Section, and attach a certificate of residence (住民票の写し) issued by the local government (stating the full name, gender, date of birth of the student, permanent address; family relation information is not required).

If you intend to change his/her guarantor, submit a notification by designated form available at the Academic Records Section. Only non-Japanese students can have a guarantor who lives outside Japan.

### **When Public Transport Service is Shut Down**

When the university decides that it is not possible to hold regular classes or final exams due to the shutdown of transport services caused by natural disasters such as typhoons, heavy rainfall, accidents or strikes, classes will be canceled and exams rescheduled to another day. Such cancellation and changes will be announced on the university's official website, Loyola or official Facebook. Be sure to check one of these sites.

### **Infectious Diseases**

He/She is not allowed to attend school for a designated period of time to prevent the spread of the disease. When a student has contracted one of the diseases the School Health Law (Gakko-Hoken-Anzen-Ho) prescribes as “Gakko Kansen-sho” (such as influenza, measles, whooping cough, German measles, mumps and chicken pox).

For a new infectious disease, special measures might be taken. Please check Loyola for any notice from the university.

When a student has contracted such an infectious disease:

1. The student must follow physician’s instructions and stay home until there is no risk of infection.
2. The student must download the form “Doctor’s permission to return to campus” (Toko Kyoka Sho) from the university website or request the university Health Center to provide the form and then ask the physician to fill out the form and specify the date when the student is permitted to return to school. (Other forms prepared by a hospital are acceptable if the period of required absence is clearly stated.)
3. The student must give the original copy of the form to the university Health Center. He or she is also required to give a photocopy of the form to the instructor of each course he or she is enrolled in.

It is the student’s responsibility to inform his or her instructors about the situation when he or she returns to school. The Center for Academic Affairs does not pass on such information to instructors.

**Absences Due to Lay Judge Service**

Based on the “Act on Criminal Trials Examined under the Lay Judge System,” students may decline to serve as lay judges under the lay judge system. However, in order to respect the wishes of students who consent to being appointed as lay judges, absences due to lay judge service (including any attendant procedures) will be treated as follows.

**1. Scope of Policy**

This policy applies to degree-seeking undergraduate and graduate students as well as non-matriculated students. This policy does not apply to auditing students.

**2. Accepted Grounds for Absence**

- a. Appearing at a courthouse as a lay judge candidate for appointment procedures
- b. Attending a trial as a lay judge.
- c. Sitting in on trial proceedings as an alternate lay judge.

**3. Procedures**

In general, students must contact the Center for Academic Affairs, receive a copy of the designated Notification of Absence due to Lay Judge Service form, and submit this form, along with a copy of the Notice of Date for Lay Judge Appointment sent in the mail from the court, to the faculty member(s) in charge of the class(es) from which the student is to be absent. The student must also show to the faculty member(s) the post-trial discharge certification documentation issued by the court.

**4. Handling of Absences**

Provided that the student has given notice of absence by means of the designated forms mentioned above, faculty will observe the following considerations to avoid causing detriment to the student.

- a. Classes missed will not be counted as absences. Make-up opportunities will be determined by the faculty member.
- b. Quizzes: Make-up opportunities will be determined by the faculty member.
- c. Examinations: Student will be allowed to sit a make-up examination. The request for a make-up examination should be submitted in time.



### III. FACULTY OF LIBERAL ARTS CURRICULUM

#### 【For students who entered from 2014】

The curriculum is divided into three parts:

- General Studies (GS)
- Language
- Specialized Education (SE)

<b>General Studies (全学共通科目 Zengaku Kyōtsū Kamoku)</b>		<b>22 credits</b>
Compulsory courses		
① (必修科目 Hisshū Kamoku)		
Health and Physical Education		2 cr
② (選択必修科目 Sentaku Hisshū Kamoku)		
Studies in Christian Humanism		4 cr
GS Electives		
FLA Distribution Courses*	}	16 cr
FLA General Courses		
University-wide General Studies Courses (全学共通科目)		
Advanced General Education Subjects** (高学年向け教養科目)		
*12 cr must be taken from FLA Distribution Courses.		
**2 cr must be taken from Advanced General Education subjects.		
<b>Language</b>		<b>8 credits</b>
Compulsory Courses		8 cr
<b>Specialized Education (学科科目 Gakka Kamoku)</b>		<b>94 credits</b>
FLA Core Program		
Thinking Processes		4 cr
English Composition 1		4 cr
English Composition 2		4 cr
Public Speaking		4 cr
Major Courses		48 cr
SE Electives		30 cr
<b>A total of 124 credits is required for graduation.</b>		

## GENERAL STUDIES

### STUDIES IN CHRISTIAN HUMANISM

Two courses in the category “Studies in Christian Humanism” (キリスト教人間学) for a total of 4 credits are compulsory for all students who are enrolled in the Faculty of Liberal Arts. Normally, students must take one course in their first semester and another the second semester.

Philosophy of the Human Person**	2 cr
Philosophy of Human Rights and Human Dignity*	2 cr
Philosophy of Human Violence***	2 cr
Philosophy of Love***	2 cr
Foundations : Territory & Sacred Space**	2 cr
Modern Philosophy*	2 cr

\*offered in the spring semester

\*\*offered in the autumn semester

\*\*\*offered in the spring & autumn semester

Please note that places in these courses will be chosen by lottery so students should register for these courses during the **lottery registration period**. Details will be announced on Loyola bulletin board (Academic Services).

## HEALTH AND PHYSICAL EDUCATION

“Wellness, the Body and Culture” (ウエルネスと身体), 2 credits, is compulsory for all students entering from 2009. This course should be taken in the semester the student enters the university. The course will be offered in Japanese and English every semester. Students will be assigned to the appropriate class. An adapted course for students with disabilities will be offered every autumn semester. Details will be announced on Loyola bulletin board (Academic Services). Neither cancellation nor withdrawal is allowed for compulsory H.P.E. courses.

- **Class**

Students entering in 2014 will be assigned to one of the class sections.

**The class assignment will be posted on Loyola. You should check the bulletin board and make sure to register for the course that you are assigned.**

- **Day & Time**

**Common to all sections: Wednesday, 13:30-15:00**

**Bring a photo (3×3 cm) and a pen at the first class session.**

\*For students with disabilities. “Wellness, the Body and Culture” Adapted class will be held on Tuesday at 11:00-12:30 in the autumn semester.

## GS ELECTIVES

All students enrolled in the Faculty of Liberal Arts must take 16 credits in total of GS Elective courses as part of the General Studies program. Of the 16 credits, students must take (a) a minimum of 12 credits from at least 2 of the 3 categories of FLA Distribution Courses (Society and Culture, Cultural Traditions, and Politics and Economy) and (b) a minimum of 2 credits from Advanced General Education Subjects (高学年向け教養科目) after their fourth semester. Students could also take courses from FLA General Courses and Zengaku Kyōtsū Kamoku University-wide General Studies Courses (全学共通科目) to fulfill their remaining credits.

Some courses are listed under both General Studies and Specialized Education categories and may be chosen to fulfill requirements in either category. However, the same course may not be used to fulfill requirements in both categories simultaneously.

## CATEGORIES AND LIST OF COURSES

### FLA DISTRIBUTION COURSES

**Society and Culture:** The courses in this category introduce students to the experiences of different human societies, from ancient times to the present. They look at the development of institutional, intellectual, and social patterns that continue to influence our way of thinking and acting today.

HST251	Development of Japanese Civilization 1
HST252	Development of Japanese Civilization 2
HST261	History of Chinese Civilization
SOC201	Introduction to Sociology
SOC222	Introduction to Contemporary Chinese Society
SOC223	Globalization and Society
ANT202	Introduction to Cultural and Social Anthropology
ANT220	Anthropology of Japan
ANT230	Culture and Identity

**Cultural Traditions:** From the very beginning humans have sought to communicate their ideas about themselves, their societies, and the world. The courses in this category introduce written and artistic expressions of human creativity. They provide students with experience in the analysis and interpretation of particular literary texts, philosophic concepts, works of art, systems of belief and symbolic structures.

ART201	Introduction to Art History/Visual Culture 1
ART250	Introduction to Art History/Visual Culture 2
LIT201	Literary Genres
LIT231	Introduction to Japanese Literature
RPH201	Introduction to Philosophy
RPH202	Fundamentals of Religion
LNG210	Introduction to Linguistics

**Politics and Economy:** Political and economic factors play a major role in shaping the world in which we live. The courses in this category introduce students to some of the major approaches for investigating the nature and impact of such factors.

IBE200	Principles of Microeconomics
IBE201	Principles of Macroeconomics
POL201	Theories and Themes of Contemporary Politics
POL205	Introduction to International Relations
POL210	Introduction to Comparative Politics
POL215	Controversies in Globalization
MTH111	Mathematics and Statistics for Business and Economics

#### **FLA GENERAL COURSES**

COM211	Computer Studies 1*
COM212	Computer Studies 2*
COM213	Computer Studies 3*
COM214	Computer Studies 4*
ENV131	Environmental Issues 1
GEO201	Human Geography
GEO202	Geography
MTH101	College Mathematics

\*The courses with asterisk carry 2 credits each.

#### **ADVANCED GENERAL STUDIES Subjects**

Courses will be listed from 2016.

## LANGUAGES

Students must complete 8 credits in one language chosen from among the languages offered by the Center for Language Education and Research (CLER):

- **Chinese, French, Spanish** (conducted in English and exclusively offered for FLA students)
- **Japanese** (conducted in English)
- **Arabic, German, Indonesian, Italian, Korean, Latin, Portuguese, Russian, Tagalog** (conducted in Japanese)

N.B.

1. Students are encouraged to select a language that they have not previously studied. A student who chooses a language he or she has studied previously and is placed at an advanced level may encounter difficulties in completing the required 8 credits in one language.
2. The language required for non-native speakers of Japanese is Japanese unless they demonstrate sufficient proficiency on the Japanese Placement Test. Citizenship is not a consideration in determining whether a student is a native or non-native speaker.
3. Students who are assigned to Japanese language track 3 (Japanese Reading and Writing Courses) on the basis of the Japanese placement test and want to choose Japanese to fulfill their language requirements must obtain approval from the coordinator of the Japanese Language Program. For procedure, please consult with the Center for Language Education and Research.
4. Language courses must be taken in the correct sequence. Credit will not be counted for a language course of a level lower than one taken previously for the graduation requirement.
5. Students who wish to continue study of a language other than Japanese beyond the required 8 credits may include additional credits in their SE Electives as specified below:
  - a. Up to 4 credits of advanced courses in the same language selected to fulfill the language requirement may be included in the student's SE Electives.
  - b. Up to 8 credits in a second language may be included as SE Electives.
  - c. Apart from Japanese, the credits for a third language cannot be counted for graduation.
6. Students whether native or non-native speakers, may include up to a total of 30 credits in Japanese as SE Electives.

7. In principle, no withdrawals are allowed for language courses. If a student withdraws from such a class, he/she may not subsequently choose that language to fulfill the language requirement.

### Course Registration for **Chinese, French, and Spanish Courses for FLA Students**

Depending on a student's placement and other factors, the course registration process may vary. In addition to the information given below, instructions will be provided by the teachers who conduct the Placement Interview and those who teach the classes.

1. Those students who meet the following criteria must register for their courses on Loyola.
  - Students placed in Basic 1 in the Placement Interview.
  - Students who must repeat Basic 1.
  - Students who have successfully completed one or more courses in the language sequence and wish to register for the next course in that sequence.
2. Students who meet the following criteria must fill in the "CLER Language Program Registration Request Form," obtain a signature of approval from either the teacher administering the Placement Interview or the teacher in charge of the class, and submit the completed form to the Center for Academic Affairs during the registration period or the course adjustment period.
  - Students placed in classes other than Basic 1 in the Placement Interview.
  - Students who have not required any credit for their language of choice but wish to repeat a class other than Basic 1.

### Course Registration for **Japanese**

Please refer to the "Japanese Language Program" brochure and Loyola bulletin board (CLER and Center for Academic Affairs).



## SPECIALIZED EDUCATION

### FLA CORE PROGRAM

The following courses are compulsory for all students enrolled in the Faculty of Liberal Arts and must be taken during the first and second year.

ENG111	English Composition 1	4 cr
ENG112	English Composition 2	4 cr
ENG115	Public Speaking	4 cr
THP101	Thinking Processes	4 cr

#### **English Placement Test and Course Assignments**

Incoming students will be given an English placement test and, on the basis of the results, will be assigned to English Composition 1 or 2 or given a waiver for the course. To fulfill the total number of credits needed for graduation, students given a waiver for English Composition 1 or 2 should take an equivalent number of credits as additional SE Electives. Any student who does not demonstrate the English skills necessary to take English Composition 1 will first be required to take Basic Skills courses in writing and/or reading comprehension (2 credits each). These courses will count towards graduation as SE Electives.

#### **Course Registration for FLA Core Courses**

1. Students who are scheduled to take FLA Core courses are assigned to class sections at the start of each semester. These assignments cannot be changed. Students must register for the sections to which they have been assigned.
2. Students must enroll in the FLA Core Program courses in sequence. If a student fails a Core Program course (including Basic Skills), he/she must repeat and pass the course before proceeding to the next level.
3. Neither cancellation nor withdrawal is allowed from FLA Core Program courses, including Basic Skills.

## MAJOR COURSES

The Department of Liberal Arts offers three majors:

**Comparative Culture**  
**International Business and Economics**  
**Social Studies**

Students must choose a major at the end of their third semester and meet its requirements. Each major requires students to complete 48 credits. For details, see the sections pp.47~54.

## SPECIALIZED EDUCATION ELECTIVES

Students should take as SE Electives a total number of 30 credits chosen from the Specialized Education courses offered by the Faculty of Liberal Arts or other faculties and programs of the university.

N.B.

1. **Students may count as SE Electives a maximum of 8 credits chosen from courses included on the list of FLA Distribution Courses and FLA General Courses.**
2. **Students may count as SE Electives a maximum of 16 credits chosen from courses offered by other faculties and programs of the university (including Gakuzen Kamoku (学全科目)).** If a student chooses to study a language, the credits taken in that language will not be included in the 16-credit limit. Regulations apply to the language requirement. Please see page 42~43 for more details.
3. There are regulations concerning the number of credits in language courses that may be counted as SE Electives (see pp.42~43.).
4. Second-term first-year students and above may count credits earned in the Summer Session as SE Electives.
5. Zengaku Kyōtsū Kamoku (全学共通科目) courses with course numbers (科目コード) starting with 0 or GS offered by the university-wide General Studies Program (see 2014 年度履修要覧) may not be counted as SE Electives.
6. Advanced General Education Subjects (高学年向け教養科目) may not be counted as SE Electives.

7. Credits in courses with course numbers (科目コード) starting with 62 taken in the programs for certification as junior and high school teachers (教職課程) or as curators (学芸員課程) (see 2014 年度履修要覧課程編) may not be counted as fulfilling the credits required for graduation. The tuition for these courses will be waived.

Courses	SE electives	Remarks
FLA Distribution Courses and FLA General Courses (100-200 level Courses)	○	8 credits maximum See pp. 40-41 for course list
FLA 300-400 level courses	○	
University-wide Zengaku Kyotsu Kamoku (全学共通科目)	×	See 2014 年度履修要覧
Advanced General Education Subjects (高学年向け教養科目)	×	
Studies in Christian Humanism	×	
Specialized Education Courses offered by other faculties (including Gakuzen Kamoku)	○	16 credits maximum
Language Courses	○	Japanese, second language, advanced level of the language selected for the language requirement may be included. See pp. 42-43 for regulations in detail concerning credits
Sophia Summer Session Courses	○	
Credits in course numbers starting with 62 (courses in the programs for certification as junior and high school teachers or as curators 教職 課程、学芸員課程)	×	See 2014 年度履修要覧課程編

## **MAJOR COURSES**

### **COMPARATIVE CULTURE**

The Comparative Culture major emphasizes interdisciplinary approaches to knowledge within three fields: art history/visual culture (ART), literature (LIT), and religion/philosophy (RPH). Students take 48 credits in the major distributed among a primary field and secondary field. The primary field consists of 28 credits in one of the above three fields. The secondary field consists of 20 credits taken in another field.

### **COMPARATIVE CULTURE FIELDS**

#### **ART HISTORY/VISUAL CULTURE (ART)**

The field of art history and visual culture focuses on the acquisition of visual literacy across different media, from fine arts such as painting and sculpture to more contemporary media such as film and digital works, as well as ephemeral images including prints and propaganda. Art offers a rich source of knowledge concerning the human condition, providing visual records of human emotions, thought, ideals, and aspirations, as well as evidence of the social and political conditions under which people have lived, past and present.

#### **LITERATURE (LIT)**

The field of literature offers courses in the literature of Japan, China, Britain, the United States, and continental Europe. Comparative study of the diverse literary expressions of these countries and cultures will deepen student's appreciation of the vastness of the human imagination while training them in close textual analysis, critical theory, and cultural discourse.

#### **RELIGION/PHILOSOPHY (RPH)**

The field of comparative studies in religion/philosophy is centered on understanding the ways in which people of various historical periods and cultures have conceived, imagined, and lived out their lives in the world. Courses focus on understanding the philosophical and religious orientations of human communities as expressed in systems of thought, texts, the arts, rituals, and ethical practices.

		cr	total
Requirements for the Primary Field	Compulsory Courses One 200-level Course One 400-level Course Elective Comparative Culture Courses	4 4 20	28
Requirements for the Secondary Field	Compulsory Course One 200-level Course Elective Comparative Culture Courses	4 16	20
Total			48

The following courses offered by the FLA Social Studies Area are cross-listed as FLA religion/philosophy courses. Students may include these courses as elective courses for the religion/philosophy field.

course no.	course title	cr
HST439	Issues in Japanese Thought	4
HST445	Religion and Society in Japan	4
POL301	Classical Western Political Theory	4

## INTERNATIONAL BUSINESS AND ECONOMICS

Courses offered in this major emphasize both the development of tools of theoretical and empirical analysis and the application of these tools to the understanding of specific economic phenomena and managerial problems. The major stresses the international dimensions of both business and economics. Within this global context, special attention is given to Japanese business and economic studies.

Students majoring in International Business and Economics must complete 48 credits of IBE courses, including five 300-level courses and three 400-level courses.

		cr	total
International Business and Economics	Compulsory Courses		
	IBE200	4	48
	IBE201	4	
	Five 300-level IBE Courses	20	
	Three 400-level IBE Courses	12	
Elective IBE Courses	8		
Total			48

The following courses offered by the Faculty of Economics are cross-listed as FLA International Business and Economics courses. Students may include up to 8 credits from these courses as Elective IBE Courses, if they were cross-listed in the year when they were taken. For details on these courses refer to the 2014 年度履修要覧, and course syllabi on the Loyola system. Some of these cross-listed courses may have prerequisites and/or require the instructor's permission due to limited enrollment places. Furthermore, students may not be able to take courses that have undergone a number or title change, if they have taken them previously under the former number or title.

course no.	course title	cr	Dept offered
403101	History of Economics 1 経済学史 I	2	経済学科
403102	History of Economics 2 経済学史 II	2	経済学科
407403	Econometrics 計量経済学	4	経済学科
467920	Asian Economy 1 アジア開発経済論	2	経済学科
467921	Asian Economy 2 アジア経済成長論	2	経済学科
430801	Logistics ロジスティクス	4	経営学科
433300	Direct Marketing ダイレクト・マーケティング	2	経営学科
438410	Auditing 1 監査論 I	2	経営学科
438420	Auditing 2 監査論 II	2	経営学科

## SOCIAL STUDIES

The Social Studies major provides students with historical, comparative, and theoretical insights into the processes that constitute civilizations and social orders. Courses consider how particular societies and cultures have changed over time, patterns of similarity and difference across events and places, and how these patterns and processes have been interpreted and depicted in popular and scholarly imagination.

The Social Studies major has three fields: anthropology-sociology, history, and political science. Students take 48 credits in the major with 36 being in the primary field and 12 in the secondary field of a student's choosing. The distribution of compulsory courses varies among the different fields.

### GENERAL REQUIREMENTS

		cr	total
Requirements for the Primary Field	Compulsory Courses 200-level Courses 300-level Courses 400-level Courses	Please refer to pages 52-54	36
	Elective Social Studies Courses		
Requirements for the Secondary Field	Compulsory Course Elective Social Studies Courses		12
Total			48



## SOCIAL STUDIES FIELDS

### ANTHROPOLOGY-SOCIOLOGY

Anthropology and sociology focus on how social orders are constituted. Although they are distinct academic disciplines, there is considerable overlap in their intellectual traditions and concerns. They are offered as an integrated field that focuses on culture and society in the making of individual identities, behavior patterns, and social institutions.

		cr	total
As Primary Field	Compulsory Courses		
	Two 200-level Anthropology/Sociology Courses including either ANT202 or SOC201	8	36
	One Methods Course chosen from ANT313, 315, 316, 317, SOC312, 315, 316, IBE340	4	
	One 400-level Anthropology/Sociology Course	4	
Elective Anthropology/Sociology Courses	20		
As Secondary Field		cr	total
	Compulsory Course ANT202 or SOC201	4	12
	Elective Anthropology/Sociology Courses	8	

IBE 340 offered by the FLA International Business and Economics Area is cross-listed as an anthropology/sociology course. Students may include this course as a methods course or as an elective course for the Anthropology/Sociology field.

## HISTORY

History creates narratives and interpretations of the past with an eye toward understanding the present. This process involves asking complex questions about the experiences of humans over time. The courses encourage students to think critically about the patterns and processes that have created the modern world, with particular attention paid to the interconnectivity and transnational dimensions of East Asian history.

		cr	total
As Primary Field	Compulsory Courses		
	One 200-level History Course	4	36
	One 400-level History Course	4	
	Elective History Courses	28	

		cr	total
As Secondary Field	Compulsory Course		
	One 200-level History Course	4	12
	Elective History Courses	8	

The following courses offered by the Faculty of Humanities and the Faculty of Foreign Studies are cross-listed as FLA history courses. Students may include up to 8 credits from these courses as elective history courses, if they were cross-listed in the year when they were taken. For details on these courses refer to the appropriate department descriptions in the 2014 年度履修要覧 and course syllabi on the Loyola system. Some of these cross-listed courses may have prerequisites and/or require the instructor's permission due to limited enrollment places. Furthermore, students may not be able to take courses that have undergone a number or title change, if they have taken them previously under the former number or title.

course no.	course title	cr	Dept offered
160711	Problems in History 歴史学をめぐる諸問題	2	史学科
165814	Confucian Ethics in the Choson Era 東洋史特講(朝鮮伝統社会と儒教倫理)	2	史学科
501316	Topics in American History 1 (旧 Topics in American History I「米国史特講I」)	2	英語学科
501317	Topics in American History 2 (旧 Topics in American History II「米国史特講II」)	2	英語学科

## POLITICAL SCIENCE

Political Science focuses on the study of the state, government, and politics. It is particularly concerned with questions such as how power and authority are exercised and how that exercise leads to conflict or to the promotion of peaceful relations among social actors and states.

		cr	total
As Primary Field	Compulsory Courses		
	Two 200-level Political Science Courses	8	36
	Two 400-level Political Science Courses	8	
	Elective Political Science Courses	20	

		cr	total
As Secondary Field	Compulsory Course		
	One 200-level Political Science Course	4	12
	Elective Political Science Courses	8	

The following courses offered by the Faculty of Foreign Studies are cross-listed as FLA political science courses. Students may include these courses as electives.

course no.	course title	cr	Dept offered
608940	Seminar (Global & International Studies)1 演習 (グローバル・国際研究) 1	2	外国語学部
608941	Seminar (Global & International Studies)2 演習 (グローバル・国際研究) 2	2	外国語学部

**【For students who entered from 2011 to 2013】**

The curriculum is divided into two parts:

General Studies (GS)

Specialized Education (SE)

<b>General Studies (全学共通科目 Zengaku Kyōtsū Kamoku)</b>		<b>30 credits</b>
Compulsory courses		
① (必修科目 Hisshū Kamoku)		
Health and Physical Education		2 cr
Language		8 cr
② (選択必修科目 Sentaku Hisshū Kamoku)		
Studies in Christian Humanism		4 cr
GS Distribution Courses		12 cr
GS Electives (選択科目 Sentaku Kamoku)		4 cr
<b>Specialized Education (学科科目 Gakka Kamoku)</b>		<b>94 credits</b>
FLA Core Program		
Thinking Processes		4 cr
English Composition 1		4 cr
English Composition 2		4 cr
Public Speaking		4 cr
Major Courses		48 cr
SE Electives		30 cr
<b>A total of 124 credits is required for graduation.</b>		

**【For students who entered before 2011】**

The curriculum is divided into two parts:

General Studies (GS)

Specialized Education (SE)

<b>General Studies (全学共通科目 Zengaku Kyōtsū Kamoku)</b>		<b>32 credits</b>
Compulsory courses		
① (必修科目 Hisshū Kamoku)		
Health and Physical Education		2 cr
Language		8 cr
Information Literacy		2 cr
② (選択必修科目 Sentaku Hisshū Kamoku)		
Studies in Christian Humanism		4 cr
GS Distribution Courses		12 cr
GS Electives (選択科目 Sentaku Kamoku)		4 cr
<b>Specialized Education (学科科目 Gakka Kamoku)</b>		<b>92 credits</b>
FLA Core Program		
Thinking Processes		4 cr
English Composition 1		4 cr
English Composition 2		4 cr
Public Speaking		4 cr
Major Courses		48 cr
SE Electives		28 cr
<b>A total of 124 credits is required for graduation.</b>		

## GENERAL STUDIES

### STUDIES IN CHRISTIAN HUMANISM

Two courses in the category “Studies in Christian Humanism” (キリスト教人間学) for a total of 4 credits are compulsory for all students who are enrolled in the Faculty of Liberal Arts. Normally, students must take one course in their first semester and another the second semester.

Philosophy of the Human Person**	2 cr
Philosophy of Human Rights and Human Dignity*	2 cr
Philosophy of Human Violence***	2 cr
Philosophy of Love***	2 cr
Foundations : Territory & Sacred Space**	2 cr
Modern Philosophy*	2 cr

\*offered in the spring semester

\*\*offered in the autumn semester

\*\*\*offered in the spring & autumn semester

Please note that places in these courses will be chosen by lottery so students should register for these courses during the **lottery registration period**. Details will be announced on Loyola bulletin board (Academic Services).

#### **For students who entered before 2010 and have not yet taken Philosophical Anthropology 1 and 2:**

Philosophical Anthropology 1 and 2 are no longer offered. The students who have not yet taken or have failed them must take a total of two courses from the above list, but can take only one Christian Humanism course in a semester.

The students should register for these courses during the lottery registration period.

## LANGUAGES

Students must complete 8 credits in one language chosen from among the languages offered by the Center for Language Education and Research :

- **Chinese, French, Spanish** (conducted in English and exclusively offered for FLA students)
- **Japanese** (conducted in English)
- **Arabic, German, Indonesian, Italian, Korean, Latin, Portuguese, Russian, Tagalog** (conducted in Japanese)

N.B.

1. Students are encouraged to select a language that they have not previously studied. A student who chooses a language he or she has studied previously and is placed at an advanced level may encounter difficulties in completing the required 8 credits in one language.
2. The language required for non-native speakers of Japanese is Japanese unless they demonstrate sufficient proficiency on the Japanese Placement Test. Citizenship is not a consideration in determining whether a student is a native or non-native speaker.
3. Students who are assigned to Japanese language track 3 (Japanese Reading and Writing Courses) on the basis of the Japanese placement test and want to choose Japanese to fulfill their language requirements must obtain approval from the coordinator of the Japanese Language Program. For procedure, please consult with the Center for Language Education and Research.
4. Language courses must be taken in the correct sequence. Credit will not be counted for a language course of a level lower than one taken previously for the graduation requirement.
5. Students who wish to continue study of a language other than Japanese beyond the required 8 credits may include additional credits in their SE Electives as specified below:
  - a. Up to 4 credits of advanced courses in the same language selected to fulfill the language requirement may be included in the student's SE Electives.
  - b. Up to 8 credits in a second language may be included as SE Electives.
  - c. Apart from Japanese, the credits for a third language cannot be counted for graduation.
6. Students who entered from 2011, whether native or non-native speakers, may include up to a total of 30 credits in Japanese as SE Electives.  
For those who entered before 2012, 28 credits, may be counted as SE

Electives.

7. Withdrawals are only allowed for Chinese, French, and Spanish offered exclusively for FLA students and Japanese. If a student withdraws from such a class, he/she may not subsequently choose that language to fulfill the language requirement. Please note withdrawal will NOT be allowed for any language courses from 2015.

### Course Registration for **Chinese, French, or Spanish Courses offered for FLA students**

The course registration process may differ depending on the condition for those students. Please check below. More information will be provided from the instructors during the Placement Interview or the teacher in charge of the class.

1. For those students who meet the following criteria must register their courses on LOYOLA.
  - (1) Students who were placed in “Basic 1” in the Placement Interview
  - (2) Students who are repeating “Basic 1”
  - (3) Students who are already taking either of the above languages and wish to continue to register for courses in consecutive order
2. For those students who meet the following criteria must fill out the necessary information on the “CLER Language Program Registration Form”, obtain a signature of approval from either the teacher administering the Placement Interview or the teacher in charge of the class and submit it to the Center for Academic Affairs during the registration period or the adjustment period.
  - (1) Students who were placed in classes other than “Basic 1” in the Placement Interview
  - (2) Students who have not acquired any credit for the language of choice but wish to repeat a class other than “Basic 1”

### Course Registration **Japanese**

Please refer to the “Japanese Language Program” brochure and loyola bulletin board (CLER and Center for Academic Affairs).



## HEALTH AND PHYSICAL EDUCATION

“Wellness, the Body and Culture” (ウエルネスと身体), 2 credits, is compulsory for all students entering from 2009. This course should be taken in the semester the student enters the university. The compulsory course in Health and Physical Education for students who entered between 2006 and 2008 is “Theory and Practice of Wellness” (ウエルネスの理論と実践); students who have not taken this course should take “Wellness, the Body and Culture” (ウエルネスと身体). The course will be offered in Japanese and English every semester. Students will be assigned to the appropriate class. An adapted course for students with disabilities will be offered every autumn semester. Details will be announced in the “Course Registration Procedures” on Loyola bulletin board (Academic services). Neither cancellation nor withdrawal is allowed for compulsory H.P.E. courses.

Students who entered before 2014 cannot register online via Loyola.

\*For students who entered before 2014 and have not completed “Wellness, the Body and Culture”, students who entered before 2009 and have not completed “Theory and Practice of Wellness”(ウエルネスの理論と実践), and transfer students who have not completed compulsory HPE

Those students should take ‘Wellness, the Body and Culture’, and have to register a course after receiving a permission sheet from the Department of Health and Physical Education to register for the course, and the sheet must be submitted to the Center for Academic Affairs.

\*For students with disabilities.

“Wellness, the Body and Culture” Adapted class will be held on Tuesday at 11:00-12:30 in autumn semester.

## INFORMATION LITERACY

The course of “Information Literacy”(情報リテラシー), with 2 credits, is compulsory for students who entered before 2011. Students who have not yet taken this course should take it in either spring and autumn semester 2014. Students can choose the course offered in English or Japanese. Students should register during the lottery registration period. Neither cancellation nor withdrawal is allowed for this course. Details will be announced on Loyola bulletin board (Academic Services).

## GS DISTRIBUTION AND ELECTIVE COURSES

The courses offered by the Faculty of Liberal Arts as part of the General Studies program provide an introduction to major themes and approaches to study in various key areas of human knowledge.

Students entering prior to 2014 must take one course from each of the three categories of GS Distribution Courses (Legacy of the Past, Cultural Traditions, and Contemporary World) for a total of 12 credits. In addition to the 12 credits of GS Distribution Courses, students must take a further 4 credits as GS Electives. These 4 credits may be chosen from (a) any of the three categories of GS Distribution Courses, (b) FLA General Studies Elective Courses, or (c) any courses listed in the university-wide General Studies Program as Zengaku Kyōtsū Kamoku (全学共通科目).

Some courses are listed under both General Studies and Specialized Education categories and may be chosen to fulfill requirements in either category. However, the same course may not be used to fulfill requirements in both categories simultaneously.

**【For Students who entered before 2014】****GENERAL STUDIES DISTRIBUTION COURSES**

**Legacy of the Past:** The courses in this category introduce students to the experiences of different human societies, from ancient times to more recent periods. They look at the development of institutional, intellectual, and social patterns that continue to influence our ways of thinking and acting today.

HST251	Development of Japanese Civilization 1
HST252	Development of Japanese Civilization 2
HST261	History of Chinese Civilization

**Cultural Traditions:** From the very beginning humans have sought to communicate their ideas about themselves, their societies, and the world. The courses in this category introduce written and artistic expressions of human creativity. They provide students with experience in the analysis and interpretation of particular literary texts, philosophic concepts, works of art, systems of belief, and symbolic structures.

ART201	Introduction to Art History/Visual Culture 1
ART250	Introduction to Art History/Visual Culture 2
LIT201	Literary Genres
LIT231	Introduction to Japanese Literature
RPH201	Introduction to Philosophy
RPH202	Fundamentals of Religion

**Contemporary World:** Social, political, and economic factors play a major role in shaping the world in which we live. The courses in this category introduce students to some of the major approaches for investigating the nature and impact of such factors.

ANT202	Introduction to Cultural and Social Anthropology
ANT220	Anthropology of Japan
ANT230	Culture and Identity
IBE200	Principles of Microeconomics
IBE201	Principles of Macroeconomics
POL201	Theories and Themes of Contemporary Politics
POL205	Introduction to International Relations

POL210	Introduction to Comparative Politics
POL215	Controversies in Globalization
SOC201	Introduction to Sociology
SOC222	Introduction to Contemporary Chinese Society
SOC223	Globalization and Society

### **GENERAL STUDIES ELECTIVE COURSES**

COM211	Computer Studies 1*
COM212	Computer Studies 2*
COM213	Computer Studies 3*
COM214	Computer Studies 4*
ENV131	Environmental Issues 1
GEO201	Human Geography
GEO202	Geography
LNG210	Introduction to Linguistics
MTH101	College Mathematics
MTH111	Mathematics and Statistics for Business and Economics

#### Note

1. The courses with asterisk carry 2 credits each.
2. There are changes in the list of FLA GS Distribution and Elective Courses. The courses will only be counted as GS Electives if they were taken in the year when they were listed as GS Electives. They may still be counted as SE Electives.
3. Students who have scheduling difficulties in fulfilling graduation requirements in the category of “Legacy of the Past” should consult with the FLA Chair.

## **SPECIALIZED EDUCATION**

### **FLA CORE PROGRAM**

The following courses are compulsory for all students enrolled in the Faculty of Liberal Arts and must be taken during the first and second year.

ENG111	English Composition 1	4 cr
ENG112	English Composition 2	4 cr
ENG115	Public Speaking	4 cr
THP101	Thinking Processes	4 cr

#### **English Placement Test and Course Assignments**

Incoming students will be given an English placement test and, on the basis of the results, will be assigned to English Composition 1 or 2 or given a waiver for the course. To fulfill the total number of credits needed for graduation, students given a waiver for English Composition 1 or 2 should take an equivalent number of credits as additional SE Electives. Any student who does not demonstrate the English skills necessary to take English Composition 1 will first be required to take Basic Skills courses in writing and/or reading comprehension (2 credits each). These courses will count towards graduation as SE Electives.

#### **Course Registration for FLA Core Courses**

1. Students who are scheduled to take FLA Core courses are assigned to class sections at the start of each semester. These assignments cannot be changed. Students must register for the sections to which they have been assigned.
2. Students must enroll in the FLA Core Program courses in sequence. If a student fails a Core Program course (including Basic Skills), he/she must repeat and pass the course before proceeding to the next level.
3. Neither cancellation nor withdrawal is allowed from FLA Core Program courses, including Basic Skills.

## MAJOR COURSES

The Department of Liberal Arts offers three majors:

**Comparative Culture**  
**International Business and Economics**  
**Social Studies**

Students must choose a major at the end of their third semester and meet its requirements. Each major requires students to complete 48 credits. For details, see the sections pp.68~80.

## SPECIALIZED EDUCATION ELECTIVES

Students should take as SE Electives a total number of 30 credits chosen from the Specialized Education courses offered by the Faculty of Liberal Arts or other faculties and programs of the university. Those who entered before 2011 should take 28 credits as SE Electives.

N.B.

1. **Students may count as SE Electives a maximum of 8 credits chosen from courses included on the list of FLA General Studies Courses.**
2. **Students may count as SE Electives a maximum of 16 credits chosen from courses offered by other faculties and programs of the university (including Gakuzen Kamoku (学全科目)).** If a student chooses to study a language, the credits taken in that language will not be included in the 16-credit limit. Regulations apply to the language requirement. Please see page 59~60 for more details.
3. There are regulations concerning the number of credits in language courses that may be counted as SE Electives (see pp.59~60.).
4. Second-term first-year students and above may count credits earned in the Summer Session as SE Electives.
5. Zengaku Kyōtsū Kamoku (全学共通科目) courses with course numbers (科目コード) starting with 0 or GS offered by the university-wide General Studies Program (see 2014 年度履修要覧) may not be counted as SE Electives.

6. Credits in courses with course numbers (科目コード) starting with 62 taken in the programs for certification as junior and high school teachers (教職課程) or as curators (学芸員課程) (see 2014 年度履修要覧課程編) may not be counted as fulfilling the credits required for graduation. The tuition for these courses will be waived.

Courses	SE electives	Remarks
FLA General Studies Courses (100-200 level Courses)	○	8 credits maximum See pp. 63-64 for course list
FLA 300-400 level Courses	○	
University-wide Zengaku Kyotsu Kamoku (全学共通科目)	×	See 2014 年度履修要覧
Advanced General Education Subjects (高学年向け教養科目)	×	
Studies in Christian Humanism	×	
Specialized education courses offered by other faculties (including Gakuzen Kamoku)	○	16 credits maximum
Language Courses	○	Japanese, second language, advanced level of the language selected for the language requirement may be included. See pp. 59-60 for regulations in detail concerning credits
Sophia Summer Session Courses	○	
Credits in course numbers starting with 62 (courses in the programs for certification as junior and high school teachers or as curators 教職 課程、学芸員課程)	×	See 2014 年度履修要覧課程編

## MAJOR COURSES

### COMPARATIVE CULTURE

The Comparative Culture major emphasizes interdisciplinary approaches to knowledge within three fields: art history, literature, and religion-philosophy. Students take 48 credits in the major distributed among a primary and secondary field.

For students who entered before 2014, the primary field consists of 36 credits in one of the above three fields. At least 4 credits in the primary field should be a 400-level course. The secondary field consists of 12 credits taken in another field.

### GENERAL REQUIREMENTS

		cr	total
Requirements for the Primary Field	Compulsory Courses	4	36
	One 200-level Course	4	
	One 400-level Course	28	
	Elective Comparative Culture Courses		
Requirements for the Secondary Field	Compulsory Course	4	12
	Elective Comparative Culture Courses	8	
Total			48



## COMPARATIVE CULTURE FIELDS

### ART HISTORY

The discipline of art history covers all fields of art: from sculpture, architecture, painting, and crafts, to applied and industrial arts. Art is a rich source of knowledge concerning the human condition, providing visual records of human emotions, thought, ideals, and aspirations, as well as evidence of the social and political conditions under which people have lived, past and present.

#### For students entering from 2009 to 2013

		cr	total
As Primary Field	Compulsory Courses		
	ART201 or ART250	4	36
	One 400-level Art Course	4	
	Elective Art Courses	28	

		cr	total
As Secondary Field	Compulsory Course		
	ART201 or ART250	4	12
	Elective Art Courses	8	

From 2014, ART230 is not offered. ART230 taken before 2014 may still be counted as a compulsory course.

#### For students entering before 2009

		cr	total
As Primary Field	Compulsory Courses		
	ART201	4	36
	One 400-level Art Course	4	
	Elective Art Courses	28	

		cr	total
As Secondary Field	Compulsory Course		
	ART201	4	12
	Elective Art Courses	8	

## LITERATURE

The field of literature offers courses in the literature of Japan, China, Britain, the United States, and continental Europe. Comparative study of the diverse literary expressions of these countries and cultures will deepen students' appreciation of the vastness of the human imagination while training them in close textual analysis, critical theory, and cultural discourse.

		cr	total
As Primary Field	Compulsory Courses		
	LIT201 or LIT231	4	36
	One 400-level Literature Course	4	
	Elective Literature Courses	28	

		cr	total
As Secondary Field	Compulsory Course		
	LIT201 or LIT231	4	12
	Elective Literature Courses	8	

From 2014, LIT202 is not offered. LIT202 taken before 2014 may still be counted as a compulsory course.

## RELIGION-PHILOSOPHY

The field of comparative studies in religion-philosophy is centered on understanding the ways in which people of various historical periods and cultures have conceived, imagined, and lived out their lives in the world. Courses focus on understanding the philosophical and religious orientations of human communities as expressed in systems of thought, texts, the arts, rituals, and ethical practices.

		cr	total
As Primary Field	Compulsory Courses		
	RPH201 or RPH202	4	36
	One 400-level RPH Course	4	
	Elective RPH Courses	28	

		cr	total
As Secondary Field	Compulsory Course		
	RPH201 or RPH202	4	12
	Elective RPH Courses	8	

From 2014, RPH203 is not offered. RPH203 taken before 2014 may still be counted as a compulsory course.

The following courses offered by the FLA Social Studies Area are cross-listed as FLA religion/philosophy courses. Students may include these courses as elective courses.

course no.	course title	cr
HST439	ISSUES IN JAPANESE THOUGHT	4
HST445	RELIGION AND SOCIETY IN JAPAN	4
POL301	CLASSICAL WESTERN POLITICAL THEORY	4

From 2014, HST412 is not offered. HST412 taken before 2014 may still be counted as an elective course.

## INTERNATIONAL BUSINESS AND ECONOMICS

Courses offered in this major emphasize both the development of tools of theoretical and empirical analysis and the application of these tools to the understanding of specific economic phenomena and managerial problems. The major stresses the international dimensions of both business and economics. Within this global context, special attention is given to Japanese business and economic studies.

Students majoring in International Business and Economics must complete 48 credits of IBE courses, including five 300-level courses and three 400-level courses.

		cr	total
International Business and Economics	Compulsory Courses		
	IBE200	4	
	IBE201	4	
	Five 300-level IBE Courses	20	48
	Three 400-level IBE Courses	12	
	Elective IBE Courses	8	
Total			48

The following courses offered by the Faculty of Economics are cross-listed as FLA International Business and Economics courses. Students may include up to 8 credits from these courses as Elective IBE Courses, if they were cross-listed in the year when they were taken. For details on these courses refer to the 2014 年度履修要覧, and course syllabi on the Loyola system. Some of these cross-listed courses may have prerequisites and/or require the instructor's permission due to limited enrollment places. Furthermore, students may not be able to take courses that have undergone a number or title change, if they have taken them previously under the former number or title.

course no.	course title	cr	Dept offered
403101	History of Economics 1 経済学史 I	2	経済学科
403102	History of Economics 2 経済学史 II	2	経済学科
407403	Econometrics 計量経済学	4	経済学科
467920	Asian Economy 1 アジア開発経済論	2	経済学科
467921	Asian Economy 2 アジア経済成長論	2	経済学科
430801	Logistics ロジスティクス	4	経営学科
433300	Direct Marketing ダイレクト・マーケティング	2	経営学科
438410	Auditing 1 監査論 I	2	経営学科
438420	Auditing 2 監査論 II	2	経営学科

## SOCIAL STUDIES

The Social Studies major provides students with historical, comparative, and theoretical insights into the processes that constitute civilizations and social orders. Courses consider how particular societies and cultures have changed over time, patterns of similarity and difference across events and places, and how these patterns and processes have been interpreted and depicted in popular and scholarly imagination.

The Social Studies major has three fields: anthropology-sociology, history, and political science. Students take 48 credits in the major with 36 being in the primary field and 12 in the secondary field of a student's choosing. The distribution of compulsory courses varies among the different fields.

### GENERAL REQUIREMENTS

		cr	total
Requirements for the Primary Field	Compulsory Courses 200-level courses 300-level courses 400-level courses  Elective Social Studies Courses	Please refer to pages 75-78	36
Requirements for the Secondary Field	Compulsory Course Elective Social Studies Courses		12
Total			48

## SOCIAL STUDIES FIELDS

### ANTHROPOLOGY-SOCIOLOGY

Anthropology and sociology focus on how social orders are constituted. Although they are distinct academic disciplines, there is considerable overlap in their intellectual traditions and concerns. They are offered as an integrated field that focuses on culture and society in the making of individual identities, behavior patterns, and social institutions.

As Primary Field	Compulsory Courses	cr	total
	Two 200-level Anthropology/Sociology Courses including either ANT202 or SOC201	8	36
	One Methods Course chosen from ANT313, 315, 316, 317, SOC312, 315, 316, IBE340	4	
	One 400-level Anthropology/Sociology Course	4	
Elective Anthropology/Sociology Courses	20		
As Secondary Field	Compulsory Course: ANT202 or SOC201	4	12
	Elective Anthropology/Sociology Courses	8	

IBE340 may be included as a methods course or as an elective course.

ANT314 taken before 2010 may still be counted as a Methods course.

From 2014, IBE426 is not offered. IBE426 taken before 2014 may still be counted as an elective course.

### HISTORY

History creates narratives and interpretations of the past with an eye toward understanding the present. This process involves asking complex questions about the experiences of humans over time. The courses encourage students to think critically about the patterns and processes that have created the modern world,

with particular attention paid to the interconnectivity and transnational dimensions of East Asian history.

As Primary Field		cr	total
	Compulsory Courses Two 400-level History Courses Elective History Courses	8 28	36

As Secondary Field		cr	total
	Elective History Courses	12	12

The following courses offered by the Faculty of Humanities and the Faculty of Foreign Studies are cross-listed as FLA history courses. Students may include up to 8 credits from these courses as elective history courses, if they were cross-listed in the year when they were taken. For details on these courses refer to the appropriate department descriptions in the 2014 年度履修要覧 and course syllabi on the Loyola system. Some of these cross-listed courses may have prerequisites and/or require the instructor's permission due to limited enrollment places. Furthermore, students may not be able to take courses that have undergone a number or title change, if they have taken them previously under the former number or title.

course no.	course title	cr	Dept offered
160711	Problems in History 歴史学をめぐる諸問題	2	史学科
165814	Confucian Ethics in the Choson Era 東洋史特講(朝鮮伝統社会と儒教倫理)	2	史学科
501316	Topics in American History 1 (旧 Topics in American History I「米国史特講I」)	2	外国語学部
501317	Topics in American History 2 (旧 Topics in American History II「米国史特講II」)	2	外国語学部

The following course offered by Faculty of Foreign Studies was cross-listed as a FLA History course for 2012. The course taken in 2012 may still be counted as an elective course.

course no.	course title	cr	Dept offered
607123	Life and Writings of Joze Rizal	2	アジア文化 副専攻



## POLITICAL SCIENCE

Political Science focuses on the study of the state, government, and politics. It is particularly concerned with questions such as how power and authority are exercised and how that exercise leads to conflict or to the promotion of peaceful relations among social actors and states.

		cr	total
As Primary Field	Compulsory Courses		
	Two 200-level Political Science Courses	8	36
	Two 400-level Political Science Courses	8	
	Elective Political Science Courses	20	

		cr	total
As Secondary Field	Compulsory Course		
	One 200-level Political Science Course	4	12
	Elective Political Science Courses	8	

IBE470 taken before 2011 may still be counted as an elective course.

The following courses offered by the Faculty of Foreign Studies are cross-listed as FLA political science courses.

**For Social Studies area students who entered before 2011, and choose the political science field as their primary or secondary field,** the courses listed below may be counted as electives (up to 8 credits).

course no.	course title	cr	Dept offered
608940	Seminar (Global & International Studies)1 演習 (グローバル・国際研究) 1 (旧「演習 (国際関係論 A)」*)	2	外国語学部
608941	Seminar (Global & International Studies)2 演習 (グローバル・国際研究) 2 (旧「演習 (国際関係論 A)」*)	2	外国語学部
537914	European Politics 1 ヨーロッパ政治論 1	2	ドイツ語学科
600641	Foreign Policy 1 外交政策 1	2	外国語学部
600642	Foreign Policy 2 外交政策 2	2	外国語学部
601403	Peace Research	4	国際関係副専攻
605123	Seminar (Comparative Politics 1) 演習 (比較政治学 1)	2	外国語学部
605124	Seminar (Comparative Politics 2) 演習 (比較政治学 2)	2	外国語学部

**For Social Studies area students who entered in 2011 and 2012 and choose the political science field as their primary or secondary field, the courses listed below may still be counted as electives (up to 8 credits).**

course no.	course title	cr	Dept offered
608940	Seminar (Global & International Studies)1 演習 (グローバル・国際研究) 1 (旧「演習 (国際関係論 A)」*)	2	外国語学部
608941	Seminar (Global & International Studies)2 演習 (グローバル・国際研究) 2 (旧「演習 (国際関係論 A)」*)	2	外国語学部
537914	European Politics 1 ヨーロッパ政治論 1	2	ドイツ語学科
600641	Foreign Policy 1 外交政策 1	2	外国語学部
600642	Foreign Policy 2 外交政策 2	2	外国語学部
601403	Peace Research	4	国際関係副専攻

**For Social Studies area students who entered in 2013 and choose the political science field as their primary or secondary field, the courses listed below may be counted as electives.**

course no.	course title	cr	Dept offered
608940	Seminar (Global & International Studies)1 演習 (グローバル・国際研究) 1 (旧「演習 (国際関係論 A)」*)	2	外国語学部
608941	Seminar (Global & International Studies)2 演習 (グローバル・国際研究) 2 (旧「演習 (国際関係論 A)」*)	2	外国語学部

For details on the courses refer to the 2014 年度履修要覧, and course syllabi on the Loyola system. Students may not be able to take courses that have undergone a number or title change, if they have taken them previously under the former number or title.

\*From 2014, 604522 International Relations A/「演習 (国際関係論 A)」is not offered. 604522 taken before 2014 may still be counted as an elective course.

For details on the courses refer to the 2014 年度履修要覧, and course syllabi on the Loyola system.

## FLA COURSE LIST

Course CD	Course Title	Cr.	Semester Offered	Instructor	Student Year	Remarks
<b>GENERAL STUDIES</b>			<b>SPR: Spring AUT: Autumn blank: not offered in 2014</b>			
COM211	COMPUTER STUDIES 1	2	SPR	BOSSIEUX Eric*	1·2·3·4	[40] A class
COM211	COMPUTER STUDIES 1	2	SPR	ASHTON Hugh*	1·2·3·4	[40] B class
COM212	COMPUTER STUDIES 2	2	SPR	ASHTON Hugh*	1·2·3·4	[19]
COM213	COMPUTER STUDIES 3	2	AUT	BOSSIEUX Eric*	1·2·3·4	[40] A class
COM213	COMPUTER STUDIES 3	2	AUT	BOSSIEUX Eric*	1·2·3·4	[40] B class
COM214	COMPUTER STUDIES 4	2	AUT	BOSSIEUX Eric*	1·2·3·4	[40]
ENV131	ENVIRONMENTAL ISSUES 1	4	AUT	CAVASIN Nathalie*	1·2·3·4	
GEO201	HUMAN GEOGRAPHY	4	AUT	CAVASIN Nathalie*	1·2·3·4	
GEO202	GEOGRAPHY	4	SPR	CAVASIN Nathalie*	1·2·3·4	
LNG210	INTRODUCTION TO LINGUISTICS	4	AUT	MOTOHASHI Tatsushi	1·2·3·4	
MTH101	COLLEGE MATHEMATICS	4	SPR	MURAKAMI Junko*	1·2·3·4	
MTH111	MATHEMATICS AND STATISTICS FOR BUSINESS AND ECONOMICS	4	SPR	MURAKAMI Junko*	1·2·3·4	[40]
MTH111	MATHEMATICS AND STATISTICS FOR BUSINESS AND ECONOMICS	4	AUT	STAFF	1·2·3·4	[40]
<b>SPECIALIZED EDUCATION FLA CORE PROGRAM</b>						
ENG001	BASIC SKILLS (WRITING)	2	SPR/AUT	FACULTY	1	
ENG002	BASIC SKILLS (READING)	2		FACULTY	1	
ENG111	ENGLISH COMPOSITION 1	4	SPR/AUT	FACULTY	1	
ENG112	ENGLISH COMPOSITION 2	4	SPR/AUT	FACULTY	1	
ENG115	PUBLIC SPEAKING	4	SPR/AUT	FACULTY	2	
THP101	THINKING PROCESSES	4	SPR/AUT	FACULTY	1	
<b>COMPARATIVE CULTURE</b>						
ART201	INTRODUCTION TO ART HISTORY/VISUAL CULTURE 1	4	AUT	HAYASHI Michio	1·2·3	
ART250	INTRODUCTION TO ART HISTORY/VISUAL CULTURE 2	4	SPR	HIRASAWA Caroline	1·2·3	
ART301	SURVEY OF WESTERN ART 1	4	SPR	KONDO Gaku*	1·2·3	*
ART302	SURVEY OF WESTERN ART 2	4		HAYASHI Michio	2·3·4	*
ART321	SURVEY OF JAPANESE ART 1	4	SPR	NAKAJIMA Izumi*	2·3·4	
ART322	SURVEY OF JAPANESE ART 2	4		HIRASAWA Caroline	2·3·4	*
ART331	SURVEY OF EAST ASIAN VISUAL MEDIA AND CULTURE	4	AUT	STAFF	2·3·4	*
ART332	SURVEY OF CHINESE ART	4		STAFF	2·3·4	*
ART351	STUDIES IN ART HISTORY	4	AUT	HAYASHI Michio	2·3·4	*
ART352	STUDIES IN VISUAL CULTURE	4	AUT	TAKII Naoko*	2·3·4	*
ART361	STUDIES IN JAPANESE ART HISTORY 1	4		MURAI Noriko	2·3·4	*
ART365	STUDIES IN JAPANESE ART HISTORY 2	4	SPR	MURAI Noriko	2·3·4	*
ART366	STUDIES IN EAST ASIAN VISUAL CULTURE	4	SPR	YATSUNAMI Hirokazu*	2·3·4	*
ART375	TOPICS IN JAPANESE ART HISTORY	4		MURAI Noriko	2·3·4	*
ART435	TOPICS IN CHINESE ART HISTORY	4	SPR	KOBAYASHI Hiromitsu	3·4	
ART436	SEMINAR IN EAST ASIA MEDIA AND CULTURE	4	AUT	STAFF	3·4	*
ART451	COMPARATIVE ART HISTORY 1	4		HIRASAWA Caroline	3·4	*
ART452	COMPARATIVE ART HISTORY 2	4		HIRASAWA Caroline	3·4	*
ART461	SEMINAR IN ART HISTORY 1	4		HAYASHI Michio	3·4	
ART482	SEMINAR IN JAPANESE ART HISTORY	4	AUT	MURAI Noriko	3·4	★
LIT201	LITERARY GENRES	4	AUT	THOMPSON Mathew	1·2·3	
LIT231	INTRODUCTION TO JAPANESE LITERATURE	4	SPR	THOMPSON Mathew	1·2·3	
LIT303	CULTURAL ENCOUNTERS AND LITERATURE	4	SPR	KONO Shion	2·3·4	*
LIT311	THE BEST OF BRITISH LITERATURE	4		STAFF	2·3·4	*
LIT312	20TH-CENTURY BRITISH LITERATURE	4	SPR	JOHNSON Jeffrey*	2·3·4	*
LIT320	AMERICAN POETRY	4		WITMER Robert	2·3·4	*
LIT322	CONTEMPORARY LITERATURE	4	AUT	JOHNSON Jeffrey*	2·3·4	*
LIT324	LITERATURE AND FILM	4		KONO Shion	2·3·4	*
LIT331	SURVEY OF JAPANESE LITERATURE 1	4		THOMPSON Mathew	2·3·4	*
LIT332	SURVEY OF JAPANESE LITERATURE 2	4	AUT	THOMPSON Mathew	2·3·4	*
LIT344	COMPARATIVE LITERATURE	4	AUT	JOHNSON Jeffrey*	2·3·4	*
LIT350	TOPICS IN THE PERFORMING ARTS	4	AUT	BOYD Mariko	2·3·4	*
LIT351	THE PERFORMING ARTS	4	SPR	FUJIKURA Takeo*	2·3·4	*
LIT365	TOPICS IN JAPANESE LITERATURE 1	4		YIU Angela	2·3·4	*
LIT366	TOPICS IN JAPANESE LITERATURE 2	4		YIU Angela	2·3·4	*
LIT370	CREATIVE WRITING	4	AUT	WITMER Robert	2·3·4	*

## 81 FLA Curriculum

Course CD	Course Title	Cr.	Semester Offered	Instructor	Student Year	Remarks
LIT435	MODERN JAPANESE FICTION 1	4		YIU Angela	3-4	*
LIT436	MODERN JAPANESE FICTION 2	4		YIU Angela	3-4	*
LIT440	BURAKUMIN, OKINAWA, MINORITY JAPANESE LITERATURE	4	AUT	DODD, Stephen Howard	3-4	
LIT445	SAMURAI IN LITERATURE AND HISTORY	4		THOMPSON Mathew	3-4	*
LIT446	MODERN WESTERN LITERATURE	4		KONO Shion	3-4	*
LIT450	CONTEMPORARY JAPANESE THEATER	4	SPR	BOYD Mariko	1-2-3	*
RPH201	INTRODUCTION TO PHILOSOPHY	4	SPR	ROBOUAM Thierry	1-2-3	
RPH202	FUNDAMENTALS OF RELIGION	4	SPR	MURAKAMI Tatsuo	1-2-3	
RPH302	CONTEMPORARY ISSUES IN RELIGION AND SOCIETY	4		STAFF	2-3-4	
RPH303	THE ENCOUNTER OF RELIGIONS IN THE MODERN WORLD	4	AUT	MURAKAMI Tatsuo	2-3-4	*
RPH311	RELIGIOUS BIOGRAPHIES:BUDDHA & CHRIST	4		ROBOUAM Thierry	2-3-4	*
RPH316	INDIAN THOUGHT AND CULTURE 1	4	SPR	VELIATH Cyril	2-3-4	*
RPH335	RELIGION,CONFLICT AND VIOLENCE	4		MURAKAMI Tatsuo	2-3-4	
RPH341	JAPANESE RELIGIONS	4	AUT	STAFF	2-3-4	
RPH351	RELIGION AND THE ARTS	4	SPR	JOHNSON Jeffery*	2-3-4	
RPH352	JAPANESE RELIGION AND THE ARTS	4	AUT	STAFF	2-3-4	
RPH361	BUDDHIST TRADITIONS	4	AUT	ROBOUAM Thierry	2-3-4	
RPH370	BUSINESS ETHICS	4	AUT	ROBOUAM Thierry	3-4	*
RPH401	INDIGENOUS RELIGION	4		MURAKAMI Tatsuo	3-4	*
RPH403	MYTHS AND LEGENDS/INDIAN ART HISTORY	4	AUT	VELIATH Cyril	3-4	*
RPH410	RELIGION, MODERNITY AND COLONIALISM	4	AUT	MURAKAMI Tatsuo	3-4	*
RPH414	COMPARATIVE RELIGION AND CULTURE	4		STAFF	3-4	*
RPH417	INDIAN THOUGHT AND CULTURE 2	4		VELIATH Cyril	3-4	*
RPH435	SYMBOL AND RELIGION	4		GARDNER Richard	3-4	*
RPH437	PHILOSOPHICAL APPROCHES TO BUDDHISM	4	SPR	ROBOUAM Thierry	3-4	
RPH444	INDIAN MYSTICISM	4		VELIATH Cyril	3-4	*
RPH455	SACRED SPACE AND TIME	4	AUT	GARDNER Richard	3-4	*
RPH480	CHRISTIANITY AND JAPANESE CULTURE	4		STAFF		*

**INTERNATIONAL BUSINESS AND ECONOMICS**

IBE200	PRINCIPLES OF MICROECONOMICS	4	SPR	ASANO Akihito	1-2-3	
IBE200	PRINCIPLES OF MICROECONOMICS	4	AUT	KONISHI Yoshifumi	1-2-3	
IBE201	PRINCIPLES OF MACROECONOMICS	4	SPR	ISAKA Naoto	1-2-3	
IBE201	PRINCIPLES OF MACROECONOMICS	4	AUT	KOSAKA Michiru	1-2-3	
IBE300	PRINCIPLES OF MANAGEMENT	4	SPR	HAGHIRIAN Parissa	2-3-4	
IBE303	MANAGEMENT INFORMATION SYSTEMS	4	AUT	SINGH Mahendra*	2-3-4	
IBE305	INTRODUCTION TO ACCOUNTING	4	AUT	UENISHI Junko	2-3-4	
IBE306	MANAGEMENT ACCOUNTING	4	SPR	UENISHI Junko	2-3-4	
IBE310	FINANCIAL MANAGEMENT	4	SPR	ISAKA Naoto	2-3-4	
IBE311	INTERMEDIATE MICROECONOMICS	4	AUT	ASANO Akihito	2-3-4	
IBE313	STRATEGIC MANAGEMENT	4	AUT	KHOJASTEY Yacob	2-3-4	
IBE315	MARKETING	4	SPR	MORIMOTO Mariko	2-3-4	
IBE316	PUBLIC ECONOMICS	4	SPR	KONISHI Yoshifumi	2-3-4	
IBE320	HUMAN RESOURCE MANAGEMENT	4	AUT	HAGHIRIAN Parissa	2-3-4	
IBE322	INTERNATIONAL TRADE	4	SPR	ASANO Akihito	2-3-4	
IBE323	INTERNATIONAL FINANCE	4	SPR	HAMANO Masashige	2-3-4	
IBE326	MONEY AND BANKING	4	AUT	ISAKA Naoto	2-3-4	
IBE331	INDUSTRIAL ORGANIZATION	4	AUT	KONISHI Yoshifumi	2-3-4	
IBE332	WOMEN AND MEN IN THE LABOR MARKET	4	AUT	STAFF	2-3-4	
IBE340	ECONOMIC STATISTICS	4	SPR	OZAKI Valerie	2-3-4	[40]
IBE345	NGO MANAGEMENT	4	SPR	MCJILTON Charles*	2-3-4	
IBE351	INTERNATIONAL MARKETING	4	AUT	MORIMOTO Mariko	2-3-4	
IBE353	INTERNATIONAL BUSINESS	4	SPR	KHOJASTEY Yacob	2-3-4	
IBE356	CONSUMER BEHAVIOR	4	AUT	MORIMOTO Mariko	2-3-4	
IBE405	QUANTITATIVE APPROACHES TO MANAGEMENT	4		KHOJASTEY Yacob	3-4	* [40]
IBE430	ECONOMIC SURVEY OF CONTEMPORARY JAPAN	4	AUT	KOSAKA Michiru	3-4	
IBE434	ADVANCED MACROECONOMICS	4	SPR	SAKUDO Mari*	3-4	*
IBE435	SEMINAR IN BUSINESS	4		HAGHIRIAN Parissa	3-4	*
IBE445	MANAGEMENT IN JAPAN	4	SPR	HAGHIRIAN Parissa	3-4	
IBE455	HUMAN RESOURCE MANAGEMENT IN JAPAN	4	AUT	DEBROUX Philippe*	3-4	
IBE456	SUPPLY CHAIN MANAGEMENT	4	SPR	KHOJASTEY Yacob	3-4	
IBE457	VENTURE MANAGEMENT	4	AUT	LIU Simon*	3-4	
IBE462	ECONOMICS OF NATURAL RESOURCES AND ENVIRONMENT	4	SPR	KONISHI Yoshifumi	3-4	*

Course CD	Course Title	Cr.	Semester Offered	Instructor	Student Year	Remarks
IBE464	ADVERTISING	4	SPR	MORIMOTO Mariko	3·4	*
IBE471	ECONOMICS OF HEALTH AND HELTH CARE POLICY	4		STAFF	3·4	*
IBE477	STRATEGIC THINKING	4		ASANO Akihito	3·4	*
IBE486	TOPICS IN FINANCE	4		ISAKA Naoto	3·4	* [40]
IBE491	ISSUES IN ACCOUNTING	4		UENISHI Junko	3·4	*
IBE492	FINANCIAL ACCOUNTING	4	AUT	UENISHI Junko	3·4	
403101	HISTORY OF ECONOMICS 1	2		STAFF	2·3·4	E
403102	HISTORY OF ECONOMICS 2	2		STAFF	2·3·4	E
407403	ECONOMETRICS	4	SPR	ASUKA Takeuchi	2·3·4	
467920	ASIAN ECONOMY 1	2	SPR	PUTHENKALAM John Joseph	2·3·4	E
467921	ASIAN ECONOMY 2	2	AUT	PUTHENKALAM John Joseph	2·3·4	E
430801	LOGISTICS	4		ARAKI Tsutomu	2·3·4	* E
433300	DIRECT MARKETING	2		ARAI Noriko	2·3·4	E [200]
438410	AUDITING 1	2	SPR	MACHIDA Yoshihiro*	2·3·4	E
438420	AUDITING 2	2	AUT	MACHIDA Yoshihiro*	2·3·4	E

**SOCIAL STUDIES**

ANT202	INTRODUCTION TO CULTURAL AND SOCIAL ANTHROPOLOGY	4	AUT	FAHY Sandra	1·2·3	
ANT220	ANTHROPOLOGY OF JAPAN	4	AUT	SLATER David	1·2·3	
ANT230	CULTURE AND IDENTITY	4	SPR	BALL Patrick Devin*	1·2·3	
ANT309	JAPAN RESEARCH	4	SPR	SLATER David	2·3·4	*
ANT313	ETHNOGRAPHIC READINGS	4		FAHY Sandra	2·3·4	*
ANT315	ETHNOGRAPHY 1	4	AUT	SLATER David	2·3·4	*
ANT316	ETHNOGRAPHY 2	4		SLATER David	2·3·4	*
ANT317	FIELD METHODS IN CULTURAL ANTHROPOLOGY	4	AUT	WATANABE Takehiro	2·3·4	
ANT350	CULTURAL THEORY	4		FAHY Sandra	2·3·4	*
ANT363	ANTHROPOLOGY AND MODERN SOCIETY	4	AUT	WATANABE Takehiro	2·3·4	*
ANT365	KOREAN STUDIES: NORTH AND SOUTH	4	SPR	FAHY Sandra	2·3·4	*
ANT447	ANTHROPOLOGY PRACTICUM 1	4		SLATER David	3·4	*
ANT448	ANTHROPOLOGY PRACTICUM 2	4	SPR	SLATER David	3·4	*
ANT461	NATURE AND SOCIETY	4	SPR	WATANABE Takehiro	3·4	
ANT462	ADVANCED READINGS IN ANTHROPOLOGY	4	SPR	FAHY Sandra	3·4	
SOC201	INTRODUCTION TO SOCIOLOGY	4	SPR	WANK David	1·2·3	
SOC222	INTRODUCTION TO CONTEMPORARY CHINESE SOCIETY	4	AUT	FARRER James	1·2·3·4	
SOC223	GLOBALIZATION AND SOCIETY	4	SPR	NAULT Derrick*	1·2·3	
SOC301	SOCIAL THEORIES	4		FARRER James	2·3·4	*
SOC305	SOCIAL STRATIFICATION	4		STAFF	2·3·4	*
SOC312	INTRODUCTION TO FIELD RESEARCH	4	AUT	WANK David	2·3·4	
SOC315	SURVEY METHODS	4	AUT	STAFF	2·3·4	
SOC316	QUALITATIVE RESEARCH METHODS	4	SPR	FARRER James	2·3·4	
SOC439	SOCIOLOGY OF SEXUALITY AND GENDER	4	AUT	FARRER James	3·4	
SOC448	SOCIOLOGY OF ECONOMIC LIFE	4	AUT	WANK David	3·4	*
SOC451	SOCIETY AND POLITICS	4	SPR	WANK David	3·4	
SOC470	SOCIOLOGY OF HEALTH AND AGING	4	AUT	STAFF	3·4	
HST251	DEVELOPMENT OF JAPANESE CIVILIZATION 1	4	AUT	GRAMLICH-OKA Bettina	1·2·3	
HST252	DEVELOPMENT OF JAPANESE CIVILIZATION 2	4	SPR	SAALER Sven	1·2·3	
HST261	HISTORY OF CHINESE CIVILIZATION	4	SPR	HESS Christian	1·2·3	
HST300	TOPICS IN HISTORY	4	SPR	HESS Christian	2·3·4	
HST352	WOMEN IN JAPANESE HISTORY	4	SPR	GRAMLICH-OKA Bettina	2·3·4	
HST353	MODERN JAPAN	4		SAALER Sven	2·3·4	
HST354	HISTORY OF JAPANESE FOREIGN RELATIONS	4		SAALER Sven	2·3·4	*
HST363	CHINESE CULTURAL HISTORY	4	AUT	HESS Christian	2·3·4	
HST370	GLOBAL HISTORY	4	SPR	WEBER Torsten*	2·3·4	
HST439	ISSUES IN JAPANESE HISTORY AND THOUGHT	4	AUT	Niels Van Steenpaal*	3·4	*
HST445	RELIGION AND SOCIETY IN JAPAN	4	SPR	UMEZAWA Fumiko*	3·4	
HST453	SEMINAR IN MODERN JAPANESE HISTORY 1	4	SPR	SAALER Sven	3·4	*
HST454	SEMINAR IN JAPANESE HISTORY	4		GRAMLICH-OKA Bettina	3·4	*
HST456	SEMINAR IN MODERN JAPANESE HISTORY 2	4		SAALER Sven	3·4	*
HST463	ISSUES IN CHINESE HISTORY	4		HESS Christian	3·4	*
HST465	SEMINAR IN MODERN EAST ASIAN HISTORY	4	AUT	HESS Christian	3·4	*
HST466	MODERN KOREAN HISTORY	4	AUT	CAPRIO Mark*	3·4	
HST471	THE EURO-ASIAN ENCOUNTER	4	SPR	BURTSCHER Michael*	3·4	
HST473	ISSUES IN EAST ASIAN HISTORY	4	AUT	BURTSCHER Michael*	3·4	

Course CD	Course Title	Cr.	Semester Offered	Instructor	Student Year	Remarks
160711	PROBLEMS IN HISTORY	2	SPR	Co) SASAGAWA Yuji	3·4	H★
165814	CONFUCIAN ETHICS IN THE CHOSON ERA	2	AUT	YAMAUCHI Koichi	2·3·4	H★
501316	TOPICS IN AMERICAN HISTORY 1	2	SPR	OSHIO Kazuto	2·3·4	F★
501317	TOPICS IN AMERICAN HISTORY 2	2	AUT	OSHIO Kazuto	2·3·4	F★
POL201	THEORIES AND THEMES OF CONTEMPORARY POLITICS	4		NAKANO Koichi	1·2·3	
POL205	INTRODUCTION TO INTERNATIONAL RELATIONS	4	SPR	ANNO Tadashi	1·2·3	
POL210	INTRODUCTION TO COMPARATIVE POLITICS	4	AUT	ITO Takeshi	1·2·3	
POL215	CONTROVERSIES IN GLOBALIZATION	4	SPR	BURRETT Tina	1·2·3	
POL301	CLASSICAL WESTERN POLITICAL THEORY	4		NAKANO Koichi	2·3·4	*
POL305	MODERN WESTERN POLITICAL THEORY	4		NAKANO Koichi	2·3·4	*
POL310	EUROPEAN POLITICS	4	AUT	BURRETT Tina	2·3·4	
POL315	THEORIES OF NGOS	4	AUT	ROSSITTO Sarajeon*	2·3·4	
POL321	JAPANESE GOVERNMENT AND POLITICS	4	SPR	NAKANO Koichi	2·3·4	
POL341	SOUTHEAST ASIAN POLITICS	4	SPR	HASEGAWA Takuya*	2·3·4	*
POL354	GLOBAL POLITICAL ECONOMY	4	SPR	BURRETT Tina	2·3·4	*
POL355	ENVIRONMENTAL POLITICS OF AGRICULTURE	4		ITO Takeshi	2·3·4	*
POL376	REGIONAL SECURITY IN NORTHEAST ASIA	4	SPR	ANNO Tadashi	2·3·4	
POL405	SEMINAR IN POLITICAL SCIENCE	4	AUT	MCNEILL David*	3·4	
POL407	AGRARIAN SOCIETIES	4	SPR	ITO Takeshi	3·4	*
POL408	POLITICAL LEADERSHIP	4		BURRETT Tina	3·4	*
POL414	NATIONALISM, CITIZENSHIP AND DEMOCRACY IN JAPAN	4	AUT	ANNO Tadashi	3·4	*
POL422	COMPARATIVE POLITICS OF ADVANCED INDUSTRIAL DEMOCRACIES	4		NAKANO Koichi	3·4	*
POL427	INTERNATIONAL RELATIONS THEORY	4		ANNO Tadashi	3·4	*
POL429	INTERNATIONAL AND REGIONAL ORGANIZATIONS	4		BURRETT Tina	3·4	*
POL441	POLITICAL ECONOMY OF DEVELOPMENT	4	AUT	ITO Takeshi	3·4	*
POL460	COMPARATIVE POLITICS OF POST-COMMUNIST STATES	4	AUT	ANNO Tadashi	3·4	*
608940	SEMINAR (GLOBAL & INTERNATIONAL STUDIES)1	2	SPR	WESSELS David	3·4	F★
608941	SEMINAR (GLOBAL & INTERNATIONAL STUDIES)2	2	AUT	WESSELS David	3·4	F★

**LINGUISTICS**

LNG301	INTRODUCTION TO JAPANESE LINGUISTICS	4	SPR	MOTOHASHI Tatsushi	2·3·4	
LNG302	HISTORY OF THE JAPANESE LANGUAGE	4	AUT	MOTOHASHI Tatsushi	2·3·4	
LNG452	TOPICS IN LINGUISTICS	4	SPR	MOTOHASHI Tatsushi	3·4	

E: offered by Faculty of Economics

F: offered by Faculty of Foreign Studies

H: offered by Faculty of Humanities

\*: every other year

★: can be repeated for graduation credit with the instructor's permission

[ ] = Lottery Course. Number in brackets is the capacity

Instructor's name with \* = adjunct instructor

Courses with blank in "Semester offered" are not offered in 2014.

For descriptions of the courses listed above, please refer to course syllabi on the Loyola System.

Some FLA courses have the same course numbers as courses taught in other faculties. Note that credits from these courses of the other faculties may only count toward fulfilling the requirement for Specialized Education Electives.

**LANGUAGE COURSES  
OFFERED BY THE CENTER FOR LANGUAGE EDUCATION AND RESEARCH**

Course ID	Course Title	Cr.	Semester Offered	Instructor	Student Year	Remarks
CHN101	BASIC CHINESE 1	2	SPR	HUANG Wanting	1-2	
CHN101	BASIC CHINESE 1	2	AUT	HUANG Wanting	1-2	
CHN102	BASIC CHINESE 2	2	SPR	ZHANG Tong	1-2	
CHN102	BASIC CHINESE 2	2	AUT	HUANG Wanting	1-2	
CHN103	INTERMEDIATE CHINESE 1	2	SPR	ZHANG Tong	1-2	
CHN103	INTERMEDIATE CHINESE 1	2	AUT	ZHANG Tong	1-2	
CHN104	INTERMEDIATE CHINESE 2	2	SPR	HUANG Wanting	1-2	
CHN104	INTERMEDIATE CHINESE 2	2	AUT	ZHANG Tong	1-2	
FRN101	BASIC FRENCH 1	2	SPR	COHEN Jacqueline*	1-2	A class
FRN101	BASIC FRENCH 1	2	SPR	JAFFREDO Sebastien*	1-2	B class
FRN101	BASIC FRENCH 1	2	AUT	DELMAIRE Gilles*	1-2	
FRN102	BASIC FRENCH 2	2	SPR	JAFFREDO Sebastien*	1-2	
FRN102	BASIC FRENCH 2	2	AUT	COHEN Jacqueline*	1-2	A class
FRN102	BASIC FRENCH 2	2	AUT	JAFFREDO Sebastien*	1-2	B class
FRN103	INTERMEDIATE FRENCH 1	2	SPR	LUBIN Muriel*	1-2	A class
FRN103	INTERMEDIATE FRENCH 1	2	SPR	DELMAIRE Gilles*	1-2	B class
FRN103	INTERMEDIATE FRENCH 1	2	AUT	JAFFREDO Sebastien*	1-2	
FRN104	INTERMEDIATE FRENCH 2	2	SPR	DELMAIRE Gilles*	1-2	
FRN104	INTERMEDIATE FRENCH 2	2	AUT	LUBIN Muriel*	1-2	A class
FRN104	INTERMEDIATE FRENCH 2	2	AUT	DELMAIRE Gilles*	1-2	B class
FRN201	ADVANCED FRENCH 1	2	SPR	LUBIN Muriel*	1-2	
FRN202	ADVANCED FRENCH 2	2	AUT	LUBIN Muriel*	1-2	
SPN101	BASIC SPANISH 1	2	SPR	KASHIWAGI Noriko*	1-2	[25]
SPN101	BASIC SPANISH 1	2	AUT	ISABEL GALA Carlos*	1-2	A class
SPN101	BASIC SPANISH 1	2	AUT	ITAGAKI Saraguevara*	1-2	B class
SPN102	BASIC SPANISH 2	2	SPR	ISABEL GALA Carlos*	1-2	A class
SPN102	BASIC SPANISH 2	2	SPR	ITAGAKI Saraguevara*	1-2	B class
SPN102	BASIC SPANISH 2	2	AUT	KASHIWAGI Noriko*	1-2	[25]
SPN103	INTERMEDIATE SPANISH 1	2	SPR	ISABEL GALA Carlos*	1-2	
SPN103	INTERMEDIATE SPANISH 1	2	AUT	ISABEL GALA Carlos*	1-2	A class
SPN103	INTERMEDIATE SPANISH 1	2	AUT	ITAGAKI Saraguevara*	1-2	B class
SPN104	INTERMEDIATE SPANISH 2	2	SPR	ITAGAKI Saraguevara*	1-2	A class
SPN104	INTERMEDIATE SPANISH 2	2	SPR	ISABEL GALA Carlos*	1-2	B class
SPN104	INTERMEDIATE SPANISH 2	2	AUT	ISABEL GALA Carlos*	1-2	
SPN201	ADVANCED SPANISH 1	2	SPR	ITAGAKI Saraguevara*	1-2	
SPN202	ADVANCED SPANISH 2	2	AUT	ITAGAKI Saraguevara*	1-2	

[ ] = Lottery Course. Number in brackets is the capacity

Instructor's name with \* = adjunct instructor

For descriptions of the courses listed above, please refer to course syllabi on the Loyola System.

## JAPANESE LANGUAGE PROGRAM (JLP)

The FLA expects students to become Japanese/English bilinguals. The Center for Language Education and Research (CLER) offers multiple tracks and levels of Japanese language courses. The type of course a student initially enrolls in will depend on his/her linguistics background. Placement into the JLP will be determined by a placement test. Students should consult with the CLER about the Japanese Placement Test. Further information about the JLP can be found in the brochure “Japanese Language Program.”

### LANGUAGE COURSES OFFERED BY THE CENTER FOR LANGUAGE EDUCATION AND RESEARCH

Course CD	Course Title	Cr.	Semester Offered	Instructor	Student Year	Remarks
JPN111	JAPANESE 1	4	SPR/AUT	STAFF	1•2•3•4	
JPN150	JAPANESE M1	4	SPR/AUT	STAFF	1•2•3•4	
JPN112	JAPANESE 2	4	SPR/AUT	STAFF	1•2•3•4	
JPN200	JAPANESE M2	4	SPR/AUT	STAFF	1•2•3•4	
JPN211	JAPANESE 3	4	SPR/AUT	STAFF	1•2•3•4	
JPN250	JAPANESE M3	4	SPR/AUT	STAFF	1•2•3•4	
JPN212	JAPANESE 4	4	SPR/AUT	STAFF	1•2•3•4	
JPN321	ADVANCED JAPANESE 1	4	SPR/AUT	STAFF	1•2•3•4	
JPN322	ADVANCED JAPANESE 2	4	SPR/AUT	STAFF	1•2•3•4	
JPN311	BUSINESS JAPANESE 1	2	SPR/AUT	STAFF	1•2•3•4	★
JPN312	BUSINESS JAPANESE 2	2	SPR/AUT	STAFF	1•2•3•4	★
JPN180	INTENSIVE JAPANESE 1	8	SPR/AUT	STAFF	1•2•3•4	
JPN270	INTENSIVE JAPANESE 2	8	SPR/AUT	STAFF	1•2•3•4	
JPN280	INTENSIVE JAPANESE 3	8	SPR/AUT	STAFF	1•2•3•4	
JPN280	INTENSIVE JAPANESE 3	8	SPR/AUT	STAFF	1•2•3•4	
JPN370	INTENSIVE JAPANESE 4	8	SPR/AUT	STAFF	1•2•3•4	
JPN340	READING & WRITING (BASICS)	2	SPR/AUT	STAFF	1•2•3•4	
JPN341	READING & WRITING 1	2	SPR/AUT	STAFF	1•2•3•4	
JPN342	READING & WRITING 2	2	SPR/AUT	STAFF	1•2•3•4	
JPN343	READING & WRITING 3	2	SPR/AUT	STAFF	1•2•3•4	
JPN352	JAPANESE LITERACY 1	4	SPR/AUT	STAFF	1•2•3•4	
JPN353	JAPANESE LITERACY 2	4	SPR/AUT	STAFF	1•2•3•4	★
JPN405	TRANS ENG TO JPN :THEORY&PRAC1	4	SPR	KATORI Yoshikazu*	1•2•3•4	★
JPN406	TRANS ENG TO JPN :THEORY&PRAC2	4	AUT	KATORI Yoshikazu*	1•2•3•4	★
JPN407	TRANS JPN TO ENG :THEORY&PRAC	4	SPR/AUT	TAKAHASHI Kinuko*	1•2•3•4	★
JPN411	ACADEMIC JAPANESE 1A	1	SPR	AIGASE Chigusa*/ KOJIMA Yawara*	1•2•3•4	★
JPN412	ACADEMIC JAPANESE 1B	1	AUT	AIGASE Chigusa*/ KOJIMA Yawara*	1•2•3•4	★
JPN421	ACADEMIC JAPANESE 2A	1	SPR	KAJIKAZAWA Chizuru*	1•2•3•4	★
JPN422	ACADEMIC JAPANESE 2B	1	AUT	KAJIKAZAWA Chizuru*	1•2•3•4	★
JPN423	ACADEMIC JAPANESE 2C	1	SPR	TOMIYA Reiko*	1•2•3•4	★
JPN424	ACADEMIC JAPANESE 2D	1	AUT	TOMIYA Reiko*	1•2•3•4	★

Instructor's name with \* = adjunct instructor

For descriptions of the courses listed above, please refer to course syllabi on the Loyola System.

★These courses can only be counted as SE electives.



**CHANGES IN COURSE NUMBER AND/OR TITLE**

Courses listed here under a new number or title may not be taken if they were taken previously under the former number or title.

NEW COURSE NUMBER & TITLE		year changed	FORMER COURSE NUMBER & TITLE	
			ANT	FORMER COURSE NUMBER & TITLE
ANT202	INTRODUCTION TO CULTURAL AND SOCIAL ANTHROPOLOGY	2014	ANT202	CULTURAL & SOCIAL ANTHROPOLOGY
ANT220	ANTHROPOLOGY OF JAPAN	2010	ANT220	ETHNOGRAPHY OF JAPAN AND OTHER SOCIETIES
ANT309	JAPAN RESEARCH	2011	ANT309	APPROACHES TO JAPANESE SOCIETY
ANT313	ETHNOGRAPHIC READINGS	2014	ANT313	VISUAL METHODS IN ANTHROPOLOGY
ANT315	ETHNOGRAPHY 1	2011	ANT315	ANTHROPOLOGICAL RESEARCH
ANT341	TOPICS IN ANTHROPOLOGY	2013	ANT341	GENDER AND SOCIETIES
ANT350	CULTURAL THEORY	2014	ANT350	CULTURE CHANGE
ANT447	ANTHROPOLOGY PRACTICUM 1	2012	ANT447	ANTHROPOLOGY PRACTICUM
ANT451	ADVANCED TOPICS IN ANTHROPOLOGY	2013	ANT451	INDIVIDUAL CULTURE AND SOCIETY
ANT461	NATURE AND SOCIETY	2014	ANT461	SEMINAR IN ANTHROPOLOGY
ART201	INTRODUCTION TO ART HISTORY/VISUAL CULTURE 1	2014	ART201	INTRODUCTION TO ART HISTORY
ART250	INTRODUCTION TO ART HISTORY/VISUAL CULTURE 2	2014	ART250	INTRODUCTION TO JAPANESE ART
ART331	SURVEY OF EAST ASIAN VISUAL MEDIA AND CULTURE	2014	ART331	SURVEY OF CHINESE ART1
ART332	SURVEY OF CHINESE ART	2014	ART332	SURVEY OF CHINESE ART2
ART352	STUDIES IN VISUAL CULTURE	2014	ART352	HST AND THEORY OF ARCHITECTURE
ART435	TOPICS IN CHINESE ART HISTORY	2010	ART435	MING AND QING PAINTING
ART436	SEMINAR IN EAST ASIA MEDIA AND CULTURE	2014	ART436	CHINESE WOODBLOCK ILLUSTRATION
ART482	SEMINAR IN JAPANESE ART HISTORY	2012	ART482	JAPANESE NARRATIVE PAINTING
HST261	HISTORY OF CHINESE CIVILIZATION	2014	HST261	HISTORY OF CHINESE CIVIL 1
HST300	TOPICS IN HISTORY	2011	HST300	RESEARCH METHODS IN HISTORY
HST352	WOMEN IN JAPANESE HISTORY	2014	HST352	JAPANESE WOMEN'S HISTORY
HST439	ISSUES IN JAPANESE HISTORY AND THOUGHT	2014	HST439	ISSUES IN JAPANESE THOUGHT
HST453	SEMINAR IN MODERN JAPANESE HISTORY 1	2010	HST453	SEMINAR IN MODERN JAPANESE HISTORY
HST456	SEMINAR IN MODERN JAPANESE HISTORY 2	2014	HST456	SEMINAR IN MODERN JAPANESE HISTORY II
HST463	ISSUES IN CHINESE HISTORY	2012	HST463	ISSUES IN CHINESE WOMEN'S HIST
HST465	SEMINARS IN MODERN EAST ASIAN HISTORY	2013	HST465	SEMINARS IN EAST ASIAN ECONOMIC HISTORY
HST466	MODERN KOREAN HISTORY	2013	HST365	MODERN KOREAN HISTORY
HST471	THE EURO-ASIAN ENCOUNTER	2014	HST471	THE EURO POWERS & EAST ASIA
IBE200	PRINC OF MICROECONOMICS	2012	IBE200	PRINC OF ECONOMICS (MICRO)
IBE201	PRINC OF MACROECONOMICS	2012	IBE201	PRINC OF ECONOMICS (MACRO)
IBE303	MANAGEMENT INFORMATION SYSTEMS	2010	IBE303	COMPUTER FOR BUSINESS AND ECONOMICS
IBE311	INTERMEDIATE MICRO	2010	IBE311	ECONOMIC ANALYSIS (MICRO)
IBE311	INTERMEDIATE MICROECONOMICS	2012	IBE311	INTERMEDIATE MICRO
IBE316	PUBLIC ECONOMICS	2010	IBE316	ECONOMIC POLICY
IBE455	HUMAN RESOURCE MANAGEMENT IN JAPAN	2012	IBE455	HUMAN RESOURCE DEVELOP IN JAPN
LIT445	SAMURAI IN LITERATURE AND HISTORY	2011	LIT445	SEMINAR IN LITERATURE AND HISTORY
LIT450	CONTEMPORARY JAPANESE THEATER	2011	LIT450	SEMINAR IN JAPANESE THEATER
POL201	THEORIES AND THEMES OF CONTEMPORARY POLITICS	2012	POL201	INTRO TO METHODS IN POL SCI
POL354	GLOBAL POLITICAL ECONOMY	2014	POL354	INT'L POLITICAL ECONOMY
POL355	ENVIRONMENTAL POLITICS OF AGRICULTURE	2014	POL355	ENVIRONMENT POLITICS OF AGRICULTURE
POL376	REGIONAL SECURITY IN NORTHEAST ASIA	2012	POL376	SECURITY IN NORTHEAST ASIA
POL429	INTERNATIONAL AND REGIONAL ORGANISATIONS	2014	POL429	INT'L ORGANIZATION AND LAW

NEW COURSE NUMBER & TITLE			FORMER COURSE NUMBER & TITLE	
		year changed		
POL430	PEACE AND SECURITY IN ASIA-PACIFIC	2010	POL430	INTERNATIONAL RELATIONS IN PACIFIC ASIA
POL460	COMPARATIVE POLITICS OF POST-COMMUNIST STATES	2014	POL460	COMP POL POST COMMUNIST STATES
RPH302	CONTEMPORARY ISSUES IN RELIGION AND SOCIETY	2012	RPH302	WESTERN TRAD.AND MOD.WORLD 1
RPH303	THE ENCOUNTER OF RELIGIONS IN THE MODERN WORLD	2012	RPH303	WESTERN TRAD.AND MOD.WORLD 2
RPH351	RELIGION AND THE ARTS 1	2010	RPH351	RELIGION AND THE ARTS
RPH351	RELIGION AND THE ARTS	2012	RPH351	RELIGION AND THE ARTS 1
RPH352	JAPANESE RELIGION AND THE ARTS	2012	RPH352	RELIGION AND THE ARTS 2
SOC301	SOCIAL THEORIES	2013	SOC301	CLASSICAL SOCIAL THEORY
SOC439	SOC OF SEXUALITY & GENDER	2013	SOC339	SOC OF SEXUALITY & GENDER

## IV. INFORMATION ON CURRICULUM

### COURSE NUMBERS

- 100-level courses:** Designed for beginning students. These include FLA Core courses, General Studies courses for beginning students, and beginning language courses.
- 200-level courses:** Introductory courses to the various disciplines; designed for first- and second-year students. Every academic discipline has its own language of analysis, and these courses are intended to introduce students to the basic analytical concepts and language of a specific field. Students should begin their study of a discipline with the 200-level course or courses in that field.
- 300-level courses:** Courses that concentrate on more specialized areas within a discipline, providing in-depth knowledge of a particular sub-field. Designed for second- and third-year students.
- 400-level courses:** Advanced or specialized courses within a discipline; designed for third- and fourth-year students. A 400-level course will often require more independent research or an extensive research paper.
- Prerequisites:** Check the course description before registering for a course. If a prerequisite course number is listed, it means that students should finish that course first. If “instructor’s permission” is listed as an alternative to a prerequisite, the student must talk to the instructor before registering for the course.

FIELD (Alphabet)	FIELD
ANT	Anthropology
ART	Art History/Visual Culture
COM	Computer Studies
ENG	English
ENV	Environmental Studies
GEO	Geography
HST	History
IBE	International Business and Economics
LIT	Literature
LNG	Linguistics
MTH	Mathematics
POL	Political Science
RPH	Religion/Philosophy
SOC	Sociology
THP	Thinking processes

## SUMMER SESSION

Every year students and professionals from throughout the world come to the Summer Session at Sophia in quest of a broader understanding of Japan and Asia. The Summer Session in Asian Studies offers these students the opportunity to take two upper-level intensive courses (6 credits) running from July 24 to August 15, 2014.

The Summer Session in Japanese Language and Culture was introduced in 2013. This program will be held from June 9 to July 18, 2014. Alongside the Japanese language courses, a lecture series, “Japanese Studies,” will provide the students with insights on important topics of contemporary Japan. Eight lectures will introduce the participants to Japanese culture, society, economy and history.

Credits earned in the Summer Session will be counted as Specialized Education Electives.

### <Asian Studies>

ARZ320	Japanese Art
IBZ415	Contemporary Japanese Economy
IBZ435	Development Issues: Asia and the World
IBZ446	Japanese Business and Management
HSZ310	Japanese History: Edo and Tokyo
LIZ333	Japanese Literature and the City
LIZ440	Japanese Theater
POZ300	Contemporary Japanese Politics
RPZ330	Survey of Japanese Religions
SOZ410	Foundations of East Asian Culture
SOZ430	Japanese Popular Culture
SOZ470	Contemporary Japanese Society

N.B. Courses in Asian Studies carry 3 credits each.

### <Japanese Language and Culture>

JSZ200	Japanese Studies
--------	------------------

N.B. Course in Japanese Language and Culture carries 1 credit.

For descriptions of these courses, please refer to the following webpage:

<http://www.fla.sophia.ac.jp/academics/summersession>

## CERTIFICATE PROGRAMS

FLA students who wish to apply for one of the following certificates should submit their application in their last term. They will receive the certificate at the time of graduation.

### JAPANESE STUDIES CERTIFICATE

Together with completing the requirements for a B.A. degree from FLA, students may combine GS, Major, and Specialized Elective courses to obtain a Certificate in Japanese Studies (日本研究履修証明). For the certificate they should complete six courses (24 credits) in designated Japanese Studies (JS) courses according to the following specifications.

JS courses are divided among two categories: A (Comparative Culture) and B (Social Studies and IBE). FLA students must take a combination of courses from both categories, with a maximum of four courses (16 credits) from a single category. At least three courses (12 credits) must be taken as SE electives.

Students from other faculties and non-degree students may obtain a Certificate in Japanese Studies by completing six courses (24 credits) in designated FLA JS courses. These students should take a combination of courses from categories A and B, with a maximum of four courses (16 credits) from a single category.

#### Category A (Comparative Culture)

ART250	Introduction to Art History/Visual Culture 2
ART321	Survey of Japanese Art 1
ART322	Survey of Japanese Art 2
ART361	Studies in Japanese Art History 1
ART365	Studies in Japanese Art History 2
ART375	Topics in Japanese Art History
ART451	Comparative Art History 1
ART452	Comparative Art History 2
ART482	Seminar in Japanese Art History
LIT231	Introduction to Japanese Literature
LIT331	Survey of Japanese Literature 1
LIT332	Survey of Japanese Literature 2
LIT365	Topics in Japanese Literature 1

LIT366	Topics in Japanese Literature 2
LIT435	Modern Japanese Fiction 1
LIT436	Modern Japanese Fiction 2
LIT450	Contemporary Japanese Theater
RPH341	Japanese Religions
RPH351	Religion and the Arts
RPH352	Japanese Religion and The Arts
RPH361	Buddhist Traditions
RPH414	Comparative Religion and Culture
RPH435	Symbol and Religion
RPH437	Philosophical Approaches to Buddhism
RPH455	Sacred Space and Time
RPH480	Christianity and Japanese Culture

### **Category B (Social Studies and IBE)**

ANT220	Anthropology of Japan
ANT309	Japan Research
HST251	Development of Japanese Civilization 1
HST252	Development of Japanese Civilization 2
HST300	Topics in History
HST352	Japanese Women's History
HST353	Modern Japan
HST354	History of Japanese Foreign Relations
HST439	Issues in Japanese History and Thought
HST445	Religion and Society in Japan
HST453	Seminar in Modern Japanese History 1
HST454	Seminar in Japanese History
HST456	Seminar in Modern Japanese History 2
POL321	Japanese Government and Politics
POL414	Nationalism, Citizenship, and Democracy in Japan
POL422	Comparative Politics of Advanced Industrial Democracies
IBE430	Economic Survey of Contemporary Japan
IBE445	Management in Japan
IBE455	Human Resource Management in Japan

## JAPANESE LANGUAGE PEDAGOGY CERTIFICATE

Together with completing the requirements for a B.A. degree from FLA, students may combine GS and SE Elective courses from the Faculty of Liberal Arts, the Center for Language Education and Research and the Faculty of Foreign Studies to obtain a certificate in Japanese Language Pedagogy (日本語教授法履修証明). Students from other faculties and non-degree students may also obtain the certificate by fulfilling the requirements listed below. Basically only students who entered before 2012 are eligible to apply for this certificate. Students who entered from 2013 and are interested in it should consult with the FLA office.

The MEXT's guidelines for the qualification to teach in Japanese language schools (below university level) are a bachelor's degree in Japanese Language Pedagogy or successful completion of the Japanese Teaching Competency Test authorized by the Ministry in 1988. Although FLA cannot offer courses in all the areas covered by the test, the program aims to provide a foundation for students who would like to prepare themselves to take it.

Students who wish to pursue this certificate should take 24 credits as described below.

### For FLA students

General requirements	credits	course
Basic Linguistics Course	4	LNG210 or LNG301
Basic JLP Course	4	日本語教育学A(文法)1&2, 日本語教育学B(言語習得)1&2, 日本語教育学C(社会言語学)1&2.
Advanced JLP Course	4	日本語教授法A(初級)1&2 or 日本語教授法B(中上級)1&2
Elective JLP Courses	12	Courses from Category I and II (may include 4 credits from Category III)



**For students from other faculties**

General requirements	credits	Course
Basic Linguistics Course	4	LNG210, LNG301, 言語学概論 1 & 2, or 日本語学概説 1 & 2
Basic JLP Course	4	日本語教育学A(文法)1&2, 日本語教育学B(言語習得)1&2, 日本語教育学C(社会言語学)1&2
Advanced JLP Course	4	日本語教授法A(初級)1&2 or 日本語教授法B(中上級)1&2
Elective JLP Courses	12	Courses from Category I and II

**Category I: Japanese Language Pedagogy Courses Offered by FLA & the Faculty of Foreign Studies**

- LNG 210 Introduction to Linguistics  
 LNG 301 Introduction to Japanese Linguistics  
 LNG 302 History of the Japanese Language  
 LNG 452 Topics in Linguistics  
 660111 日本語教育学A(文法)1(Japanese Pedagogical Grammar 1) \*  
 660112 日本語教育学A(文法)2(Japanese Pedagogical Grammar 2) \*  
 660113 日本語教育学B(言語習得)1(Japanese Language Acquisition 1) \*  
 660114 日本語教育学B(言語習得)2(Japanese Language Acquisition 2) \*  
 660115 日本語教育学C(社会言語学)1(Japanese Sociolinguistics 1) \*  
 660116 日本語教育学C(社会言語学)2(Japanese Sociolinguistics 2) \*  
 660117 日本語教授法A(初級)1(Japanese Teaching Methods A 1) \*  
 660118 日本語教授法A(初級)2(Japanese Teaching Methods A 2) \*  
 660119 日本語教授法B(中上級)1(Japanese Teaching Methods B 1) \*  
 660120 日本語教授法B(中上級)2(Japanese Teaching Methods B 2) \*

**Category II: Linguistics Courses Offered by the Faculty of Foreign Studies**

- 501268 Introduction to Language Acquisition  
 501297, 501298 Second Language Acquisition 1, 2  
 501294 Bilingual Education  
 501269 Introduction to Psycholinguistics  
 660105, 660106 言語学概論1, 2 (Introduction to Linguistics 1, 2) \*  
 660109, 660110 日本語教育入門1, 2  
 (Introduction to Teaching Japanese As a SL 1, 2) \*

- 660121, 660122 日本語教授法C  
(技能別1, 2 (Japanese Teaching Methods C 1,2) \*)
- 661005, 661006 日本語学概説1, 2 (Introduction to Japanese Linguistics 1, 2) \*
- 671111, 671121 応用言語研究入門1, 2 (Introduction to Applied Linguistics1, 2) \*

### Category III: Advanced Japanese Language Courses Offered by CLER

(For non-native speakers)

JPN322 Advanced Japanese 2

(For native speakers)

JPN353 Japanese Literacy 2 (JPN351 has been changed to JPN353 from 2014)

JPN405 Translating English to Japanese: Theory and Practice 1

JPN406 Translating English to Japanese: Theory and Practice 2

JPN407 Translating Japanese to English: Theory and Practice

N.B. The language of instruction for courses with an asterisk is Japanese.

The following courses have been moved from Faculty of Liberal Arts to Faculty of Foreign Studies. If students face difficulties obtaining the certificate due to this transition, they need to consult with the FLA office.

Old		New
LNG304	Teaching Methods and Pedagogical Grammar	日本語教育学 A(文法)1
		日本語教育学 A(文法)2
LNG305	Teaching Methods and Language Acquisition	日本語教育学 B(言語習得)1
		日本語教育学 B(言語習得)2
LNG306	Teaching Methods and Sociolinguistics	日本語教育学 C(社会言語学)1
		日本語教育学 C(社会言語学)2
LNG473	Teaching Methods and Beginning Japanese	日本語教授法 A(初級)1
		日本語教授法 A(初級)2
LNG474	Teaching Methods and Intermediate Japanese	日本語教授法 B(中上級)1
		日本語教授法 B(中上級)1

## V. TEACHING STAFF AND OFFICE HOURS 2014-2015

Name	Area	Career
Tadashi Anno	Associate Professor, Political Science	B.A., University of Tokyo M.A., Ph.D., University of California, Berkeley
Akihito Asano	Associate Professor, Economics	B.A., Yokohama National University M.A., Hitotsubashi University M.A., Ph.D., Australian National University
Mari Boyd	Professor, Theater	B.A., Japan Women's University M.A., Mount Holyoke College Ph.D., University of Hawaii
Tina Burrett	Assistant Professor, Political Science	B.A., Leeds University Mphil, Ph.D., Cambridge University
Sandra Fahy	Assistant Professor, Anthropology	B.A., M.A., York University, Ph.D., School of Oriental and African Studies, University of London
James C. Farrer	Professor, Sociology	B.A., University of North Carolina M.A., Ph.D., University of Chicago
Richard A. Gardner	Professor, Religion	B.A., Miami University M.A., Ohio State University M.A., Ph.D., University of Chicago
Bettina Gramlich-Oka	Associate Professor, History	B.A., Tübingen Universität M.A., Sophia University Ph.D., Tübingen Universität
Parissa Haghirian	Associate Professor, Business	B.A., M.A., University of Vienna M.A., Ph.D., Vienna University of Economics and Business Administration
Michio Hayashi	Professor, Art History	B.A., University of Tokyo M.A., Ph.D., Columbia University
Christian A. Hess	Associate Professor, History	B.A., University of California, Davis M.A., University of California, San Diego Ph. D., University of California, San Diego
Caroline Hirasawa	Associate Professor, Art History	B.A., Empire State College M.F.A., Tokyo University of Fine Arts M.A., Ph.D., Stanford University
Naoto Isaka	Associate Professor, Finance	B.A., Sophia University M.A., Osaka University Ph.D., Hitotsubashi University
Takeshi Ito	Associate Professor, Political Science	B.A., Keio University M.A., Hitotsubashi University M.A., M-Phil., Yale University Ph.D., Yale University
Yacob Khojasteh	Associate Professor, Business and Management	BS, Iran University of Science and Technology M. Sc., Tarbiat Modares University M.A., Ph.D., Tsukuba University
Hiroimitsu Kobayashi	Professor, Art History	B.A., Meiji University M.A., Ph.D., University of California, Berkeley
Yoshifumi Konishi	Associate Professor, Economics	B.A., Chuo University M.A., University of Pittsburgh Ph. D., University of Minnesota
Shion Kono	Associate Professor, Literature	B.A., Bowdoin College M.A., Ph.D., Princeton University
Michiru Kosaka	Assistant Professor, Economics	B.A., Hitotsubashi University M.A., Hitotsubashi University Ph.D., Duke University, Durham
James McKinley	Associate Professor, English	B.A., Susquehanna University M.A., University of Sydney Ph.D., Victoria University of Wellington

<b>Name</b>	<b>Area</b>	<b>Career</b>
Mariko Morimoto	Associate Professor, Marketing	B.A., American University M.S., Boston University Ph.D., Michigan State University
Tatsushi Motohashi	Associate Professor, Linguistics	B.A., M.A., Sophia University Ph.D., University of Arizona
Noriko Murai	Associate Professor, Art History	B.A., University of California, Berkeley M.A., Ph.D., Harvard University
Tatsuo Murakami	Assistant Professor, Religion	B.A., Beloit College M.A., Syracuse University Ph.D., University of California, Santa Barbara
Koichi Nakano	Professor, Political Science	B.A., University of Tokyo B.A., University of Oxford M.A., Ph.D., Princeton University
Hanako Okada	Assistant Professor, Applied Linguistics	B.A., Sophia University M.A., Ph.D., Temple University
Valerie Ozaki	Professor, Mathematics and Statistics	B.Sc., University of Leeds M.Sc., Ph.D., University of Manchester
Thierry-Jean Robouam, S.J.	Associate Professor, Religion	B.A., M.A., Sophia University S.T.D., Jesuit School of Theology at Berkeley
Sven Saaler	Associate Professor, History	B.A., University of Cologne M.A., Ph.D., University of Bonn
David Slater	Associate Professor, Anthropology	B.A., Vassar College M.A., Ph.D., University of Chicago
Mathew Thompson	Associate Professor, Literature	B.A., Yale University M.A., Ph.D., Columbia University
Junko Uenishi	Associate Professor, Business	B.A., Harvard University M.S., M.B.A., Northeastern University
David L. Wank	Professor, Sociology	B.A., Oberlin College M.A., Ph.D., Harvard University
Takehiro Watanabe	Assistant Professor, Anthropology	B.A., State University of New York at Albany M.A., The University of Chicago M.A., Ph.D., Columbia University
Robert E. Witmer	Professor, English	B.A., Ball State University M.A., Temple University
Angela Yiu	Professor, Literature	B.A., Cornell University M.A., Ph.D., Yale University

### Visiting Professor

Stephen Howard Dodd	Modern Japanese Literature	B.A., Keble College, Oxford M.A., Ph.D. Columbia University
---------------------	----------------------------	--

### Instructors from other Faculties

Cyril Veliath, S.J.	Professor, Philosophy	B.A., M.Ph., Ph.D., Pontifical Athenaeum
---------------------	-----------------------	--

### Adjunct Instructors

Hugh Ashton	Computer	B.A., University of Cambridge
Patrick Devin Ball	Anthropology	B.A., University of Calgary M.A., University of Hawaii at Manoa
Eric Bossieux	Computer	B.A., Sophia University
Michael Burtscher	History	B.A., University of Washington, Seattle M.A., Ludwig-Maximilians-University, Munich, Germany
David Cannell	English	B.A., Brigham Young University M.A., St. John's College Ph.D., University of California, Irvine

<b>Name</b>	<b>Area</b>	<b>Career</b>
Mark Caprio	History	M.A., Ph.D., University of Washington
Nathalie Cavasin	Geography, Environmental Studies	B.A., M.A., University of Toulouse II-Le Mirail Ph.D., University of Toulouse II-Le Mirail
Philippe Stéphan Debroux	Business	B.A., Brussels Free University M.B.A., European Institute of Business Administration Ph.D., Brussels Free University
Arlene Dinglasan	English	B.S., Computer Science Adamson University, Manila M.A., in TESOL Temple University, Japan
Takeo Fujikura	Literature	B.A., M.A., State University of New York at Binghamton Ph.D. University of Wisconsin-Madison
David Griffith	English	LLB, Victoria University of Wellington LLM, Ph.D, Auckland University
Takeo Fujikura	Literature	B.A., M.A., State University of New York at Binghamton Ph.D. University of Wisconsin-Madison
Brian Heagney	English	B.A., M.A., Trinity College, Dublin
Patrick Heller	English	B.A. The Pennsylvania State University MFA Bennington College, Vermont
Masahiko Iguchi	International Politics	B.A., University of Essex M.Sc., London School of Economics
Jeffrey Johnson	Literature	B.A., M.A., Northern Arizona University Ph.D., University of Washington
Michael Joyce	English	B.A. University of San Francisco M Ed. Temple University
Gaku Kondo	Modern Art and Theory	B.A., M.A. University of Tokyo
Shunsuke Kuwayama	English	B.A., Middlebury College M.A., Sophia University
Simon Liu	International Business, Corporate Strategy	B.E., National Taiwan University M.E., University of Tokyo Ph.D., University of Tokyo
Charles McJilton	Business	B.A., University of Minnesota M.A., Sophia University
David McNeill	Political Science	B.A., University of Ulster Ph.D., Napier University
Junko Murakami	Mathematics	B.S., M.A., University of Kansas Ph.D., Arizona State University
Sachiko Nakagome	English	B.A., Doshisha University M.A. Temple University Japan
Izumi Nakajima	Art	B.A., International Christian University M.A., Hitotsubashi University, University of Leeds Ph. D., Hitotsubashi University
Derrick Mark Nault	Sociology	B.A., M.A., University of Manitoba Ph.D., Queen's University, Kingston
Serajeon Rossitto	Social Movement Theory	B.A., State University of New York at Purchase M.A., Columbia University
Mari Sakudo	Economics	B.A. Hitotsubashi University M.A., University of Tokyo, University of Pennsylvania Ph. D. University of Pennsylvania
Mahendra Singh	Business	MBA, International University of Japan
Naoko Takii	Art	B.A., Waseda University M.A. Waseda University, University of Delaware
Akiko Tanaka	English	B.A., M.B.A., Golden Gate University, San Francisco, California
Fumiko Umezawa	History	B.A., M.A., University of Tokyo
Niels Van Steenpaal	Intellectual History	B.A., M.A. Leiden University Ph. D. Kyoto University
Hirokazu Yatsunami	Buddhist Art	B.A., M.A., International Christian University

## FLA Faculty Offices

	Name	Office Hours	Room
A	Anno, Tadashi	Tues, Fri. 1:00-2:30	10-525
	Asano, Akihito	(SPR) Mon, Thurs. 3:15-4:45 (AUT) Mon, Thurs. 12:30-1:30	10-555
B	Boyd, Mari	Tues, Fri. 2:30-3:00 or by appointment	10-642
	Burrett, Tina	(SPR) Mon. 2:00-3:00 Thurs. 5:00-6:30 (AUT) Mon. 5:00-6:00 Thurs. 11:00-12:30	10-522
F	Fahy, Sandra	(SPR) Fri. 3:30-4:30 (AUT) Tues. 11:00-12:00 Fri. 3:30-4:30 or by appointment	10-505
	Farrer, James	Mon. 2:30-3:45	10-503
G	Gardner, Richard	(SPR) Tues, Fri.1:30-3:00 (AUT) Tues, Fri. 11:00-12:30	10-649
	Gramlich-Oka, Bettina	Tues. 2:00-3:00 or by appointment	10-520
H	Haghirian, Pariassa	Mon. 3:30-4:30	10-535
	Hayashi, Michio	Mon, Thurs. 12:30-1:30	Dean's Office
	Hess, Christian	Thurs. 11:00-12:00 or by appointment	10-518
	Hirasawa, Caroline	(SPR) Mon. 1:30-2:30 with an appointment (AUT) Sabbatical	10-630
I	Isaka, Naoto	Tues. 1:00-3:00 or by appointment	10-543
	Ito, Takeshi	Tues, Fri 1:30-3:00 or by appointment	10-530
K	Khojasteh, Yacob	(SPR) Tues,Fri.10:45-11:45/3:00-4:00 (AUT) Tues, Fri.4:45-6:00 or by appointment	10-549
	Kobayashi, Hiromitsu	Wed. 11:00-1:00 with an appointment	10-632
	Konishi, Yoshifumi	(SPR) Mon,Thu 12:30-1:15 (AUT) Mon,Thu 4:45-5:45	10-547
	Kono, Shion	(SPR) Tues. 5:00-6:00 (AUT) Tues. 1:00-2:00 or by appointment	10-637
	Kosaka, Michiru	(SPR) on leave (AUT) Tues, Fri. 3:15-4:15 or by appointment	10-541
M	McKinley, James	Sabbatical	10-601
	Morimoto, Mariko	(SPR) Mon.1:30-3:00 (AUT) Mon.3:15-4:45 or by appointment	10-533
	Motohashi, Tatsushi	Mon. 1:00-3:00	10-613
	Murai, Noriko	Tues. 2:30-3:30 or by appointment	10-634
	Murakami, Tatsuo	Tues, Fri. 3:00-4:00	10-655
N	Nakano, Koichi	(SPR) Thurs. 2:00-3:00 (AUT) Sabbatical	10-528
O	Okada, Hanako	Mon,Thurs. 3:15-4:15 or by appointment	10-603
	Ozaki, Valerie	Tues, Fri. 5:00-6:00 or by appointment	10-553
R	Robouam, Thierry	Tues, Fri. 9:15-10:30	10-657
S	Saaler, Sven	(SPR) Thurs. 2:00-3:00 or by appointment (AUT) Sabbatical	10-516
	Slater, David	Mon. 12:30-2:00	10-509
T	Thompson, Mathew	Tues. 11:00-12:00	10-644
U	Uenishi, Junko	Tues, Fri. 5:00-6:00 or by appointment	10-557
W	Wank, David	Mon, Thurs. 1:30-2:00 or by appointment	10-512
	Watanabe, Takehiro	Tues, Fri 11:00-12:00	10-514
	Witmer, Robert	Mon, Thurs.12:30-2:30 Fri. 10:00-12:00 or by appointment	Chair's Office
Y	Yiu, Angela	Sabbatical	10-647

## General Information and Office Directory

### International Students Coming to Japan

#### 1. Status of Residence

Students who do not hold Japanese citizenship must have as their status of residence "college student" or other appropriate status such as "permanent resident", "long term resident", or "dependent". A temporary visitor visa is not acceptable.

To qualify for status as a "college student", students are required to register for at least 4 regular courses (i.e., at least 10 hours of class time per week).

#### 2. Extension of Period of Stay as “College Student” / Change of Status of Residence to “College Student”

For procedures on extending the period of stay or changing the status of residence, please refer to the Sophians’ Guide 2014. Please note that among the documents submitted to the Immigration Bureau, there are forms that must be filled out by the Center for Academic Affairs, which take about 4 days to be issued.

After your application is approved:

1. Registe the changes in your status of residence at the residential municipal office within 14 days.
2. Submit a photocopy of the updated "Resident Card" to the Center for Academic Affairs, Academic Records Section as soon as possible.

※ Various disadvantages regarding school life, such as Loyola access being stopped or non-receipt of scholarships, may occur until the necessary documents are submitted.

### Lost and Found

A lost-and-found service is provided at the Office of Property (Bldg. No.2, 1F). If a student loses or finds an article, it should be reported to this office.

### Parking Facilities

The University has no parking facilities for students on campus. Students are advised not to drive any vehicle to the university. Tokyo municipal law strictly prohibits the parking of cars, motorcycles or bicycles on public streets around the campus.

### **Scholarships and Financial Aid Programs**

University scholar, as well as many scholarships offered by public or private institutions are available for Japanese and international students. Detailed information is given on the university website and the online bulletin board of the Center for Student Affairs on Loyola.

General Information : [http://www.sophia.ac.jp/eng/e\\_top/studentlife](http://www.sophia.ac.jp/eng/e_top/studentlife)

### **Health and Insurance**

#### **-National Health Insurance System**

International students who will stay in Japan for more than three months are required to join this insurance system. The procedures are carried out at the student's local ward/city office.

#### **-Personal Accident Insurance for Students Pursuing Education and Research**

All degree students and exchange students must be affiliated with this insurance plan. This plan covers physical injuries a student suffers during prescribed educational and research activities at the university and during commuting to school and in transit between school facilities.

Additional information can be found in the Sophians' Guide 2014.

### **Medical Check-up**

All new degree students must have a medical check-up at the beginning of their first semester followed by check-ups every year in April. The dates and place for the medical check-up will be announced on the Loyola bulletin board.

### **Other Information**

#### **-Sophia University Academic Excellence Awards**

These awards are available to undergraduate sophomores, juniors and seniors who show high academic performance. Grantees are decided upon recommendation from the dean of each faculty.

#### **-Housing**

Sophia University has several off-campus dormitories available to all students.

#### **-Counseling Services**

Individual and group counseling is available from professional counselors to help students resolve any problems they may encounter during their college life (e.g. academic concerns, career options, student life, relationship issues,



and mental and emotional health). Counseling is available both in English and in Japanese, and the services are free of charge. Disclosed information is kept confidential. All Sophia University students are invited to utilize the services. To see a counselor, please make an appointment either in person or by phone. The Counseling Center is located at 3F, Bldg. 10.

-Campus Ministry

Catholic Center offers an English Mass on Tuesdays (1F, Bldg. 2).

For more details, please refer to the Sophians' Guide 2014 available at the Center for Student Affairs.

**OFFICE DIRECTORY****OFFICE HOURS: Mon -Fri 9:30~11:30 AM, 12:30~5:00 PM**

- ※ Services are available only during the above office hours for providing information, accepting applications and required documents.
- ※ Offices are closed on Saturdays, Sundays and national holidays.
- ※ Office hours during summer, winter vacations and on special circumstances are announced on Loyola Bulletin Board for Center for Academic Affairs (Academic Services)

	Office	Tel	Bldg	Floor
Course Registration / Class Information /Transfer Credits / Examination / Grades	Center for Academic Affairs	03-3238-3515	No. 2	1F
Tuition and Fees	Center for Academic Affairs	03-3238-3195	No. 2	1F
Request for Leave of Absence Request for Withdrawal from the University I.D. Card Reissuance Change of Address / Guarantor Re-admission Transfer of Faculty / Department	Center for Academic Affairs (Academic Records Section)	03-3238-3519	No. 2	1F
Student Travel Fare Discount Certificates Certificate of Enrollment / Official Transcript	Vending machine		No. 2	3F
Student Counseling Extra-curricular Activities & Volunteering Insurance, Dormitory, Part-time Jobs, etc Childcare Room Applications	Center for Student Affairs	03-3238-3525	No. 2	1F
Scholarship & Fees Counseling		03-3238-3523		
Lost & Found	Office of Property	03-3238-3112	No. 2	1F
Exchange Program (Incoming / Outgoing) Short-term Language Programs Short-term Study Abroad Programs Monbukagakusho Scholarship	International Liaison Office	03-3238-3521	No. 2	1F
Employment	Career Center	03-3238-3581	No. 2	1F
Admissions	Admissions Office (Undergraduate) (Graduate)	03-3238-4018 03-3238-3517	No. 2	1F
Appointment with Dean / Chair/Director	FLA/GPGS Office	03-3238-4004	No. 10	4F
Health Service	Health Center	03-3238-3394	Hoffman Hall	2F
Resources	Library	03-3238-3510	Central Library	1F
Information & Communication Technology Computer Room, Wired and Wireless LAN, Active!Mail	Media Center <a href="http://ccweb.cc.sophia.ac.jp">http://ccweb.cc.sophia.ac.jp</a>	03-3238-3101	No. 2	3F
Counseling	Counseling Center	03-3238-3559	No. 10	3F
Teacher and Curator Certification	Center For Teaching and Curator Credentials	03-3238-3520	No. 2	1F
Campus Ministry	Catholic Center	03-3238-4161	No.2	1F

**Personal Information**

For policy on protection of personal information of Sophia School Corporation, visit the following site: [http://www.sophia.ac.jp/jpn/info/privacypolicy/joho\\_toriatsukai](http://www.sophia.ac.jp/jpn/info/privacypolicy/joho_toriatsukai)



Yotsuya Campus  
四谷キャンパス

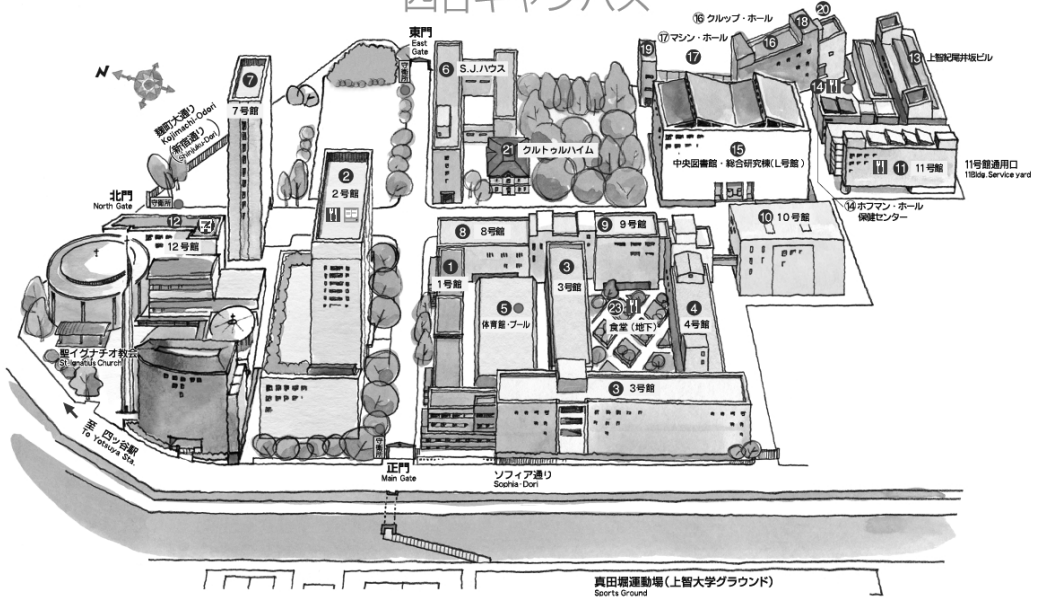

- |                     |                                    |  |                                      |   |                                  |
|---------------------|------------------------------------|--|--------------------------------------|---|----------------------------------|
| ① 1号館<br>Bldg. No.1 | ⑥ S.J.ハウス S.J. House<br>Bldg. No.7 | ⑫ 12号館<br>Bldg. No.12                    | ⑬ クレップ・ホール<br>Krupp Hall             | ⑰ マシン・ホール<br>Machine Hall   | ⑳ 地下 (basement)<br>地下 (basement) |
| ② 2号館<br>Bldg. No.2 | ⑦ 7号館<br>Bldg. No.7                | ⑬ 上智紀尾井坂ビル<br>Jochi Kozizaka Bldg.       | ⑭ マシン・ホール<br>Machine Hall            | ⑱ ナフ・ステーション I<br>Power Station I  | ㉑ 4階 (4F)<br>地下 (basement)       |
| ③ 3号館<br>Bldg. No.3 | ⑧ 8号館<br>Bldg. No.8                | ⑭ ホフマン・ホール<br>Hofmann Hall               | ⑮ ナフ・ステーション II<br>Power Station II   | ㉒ AED (自動体外式除細動器)<br>学内5カ所<br>Automated External Defibrillator<br>学内5カ所 | ㉓ 地下 (basement)<br>地下 (basement) |
| ④ 4号館<br>Bldg. No.4 | ⑨ 9号館<br>Bldg. No.9                | ⑮ 保健センター<br>Health Center                | ⑯ ナフ・ステーション III<br>Power Station III | ㉔ コンビニエンスストア<br>Convenience Store                                       |                                  |
| ⑤ 4号館<br>Gymnasium  | ⑩ 10号館<br>Bldg. No.10              | ⑯ 中央図書館<br>Central Library               | ⑰ クルトゥルハイム<br>Kulturheim             |   |                                  |
| ⑥ 体育館<br>Gymnasium  | ⑪ 11号館<br>Bldg. No.11              | ⑰ 総合研究棟 (L号館)<br>and Research Institutes |                                      |   |                                  |

● 市谷キャンパスアクセスガイド  
Ichigaya Campus Access Guide



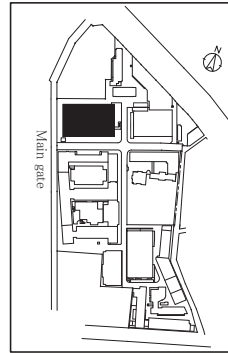

**Location of Bulletin Boards in Building No. 2 1F**

Announcements from the university offices to students are posted on the Loyola online bulletin board. Information which is not appropriate for posting on Loyola will be posted on the bulletin boards outside Building No 2.

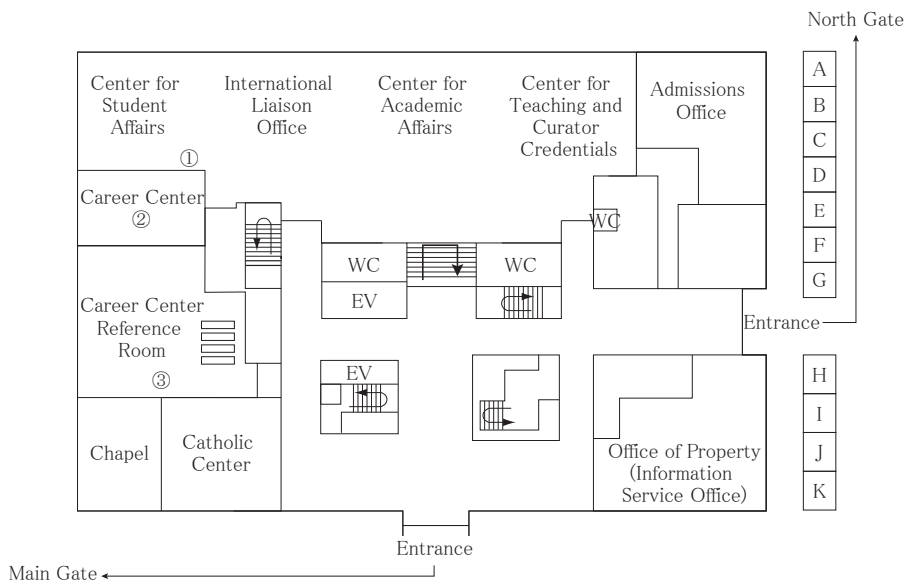

- |   |                            |   |                               |
|---|----------------------------|---|-------------------------------|
| ① | Center for Student Affairs | A | Admissions Office             |
| ② | } Career Center            | B | } Campus Membership           |
| ③ |                            | C |                               |
|   |                            | D | } Center for Academic Affairs |
|   |                            | E |                               |
|   |                            | F |                               |
|   |                            | G |                               |
|   |                            | H | } Center for Student Affairs  |
|   |                            | I |                               |
|   |                            | J | Career Center                 |
|   |                            | K | International Liaison Office  |

Building No. 1•3•4•8•9

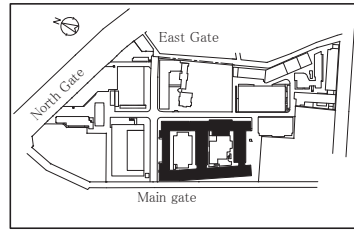

< 1 F >

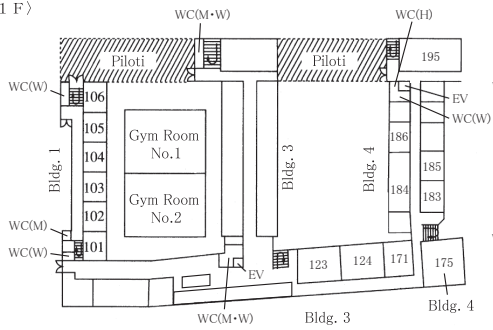

< 2 F >

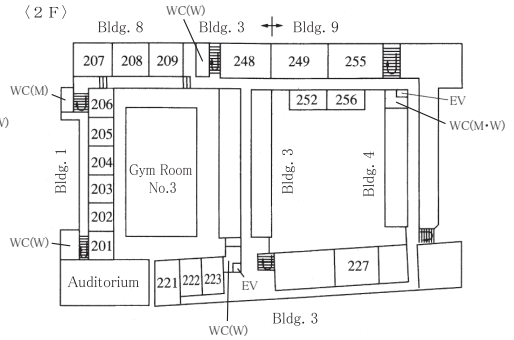

< 3 F >

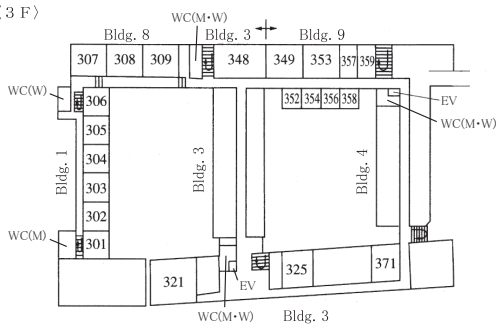

< 4 F >

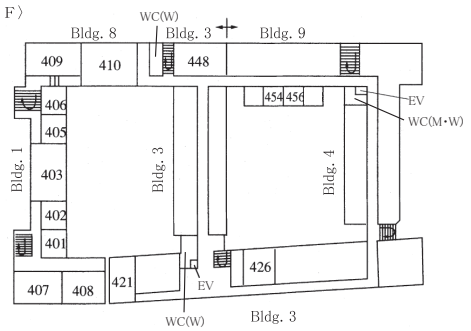

< 5 F >

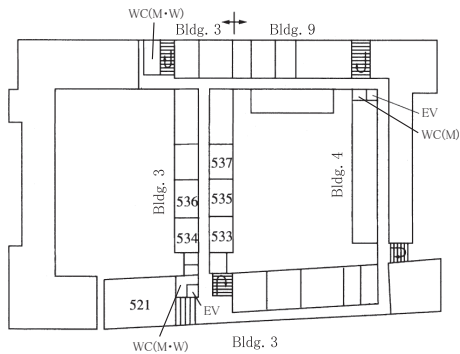

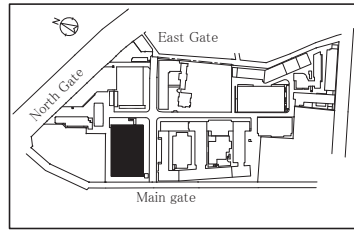

Building No. 2

(B 2 F)

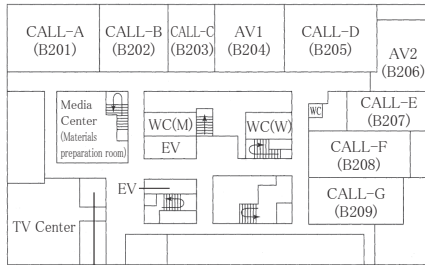

Center for Language Education and Research

(B 1 F)

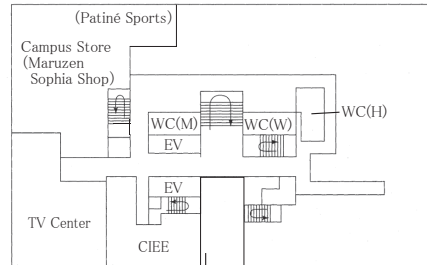

Center for Global Education, Office of Short Programs.

(1 F)

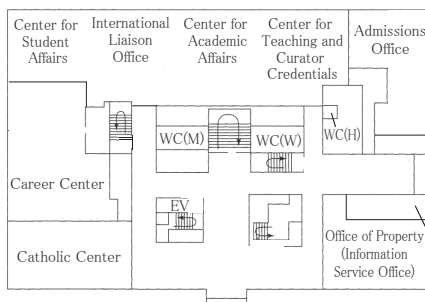

Inspection Station

(3 F)

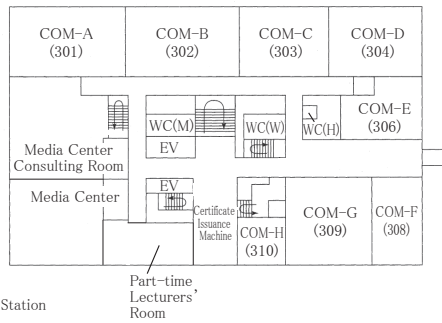

Part-time Lecturers' Room

(5 F)

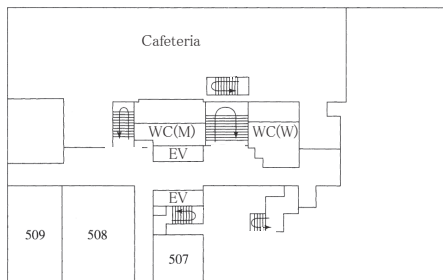

Central Library (Building L)

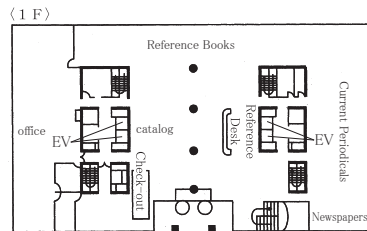
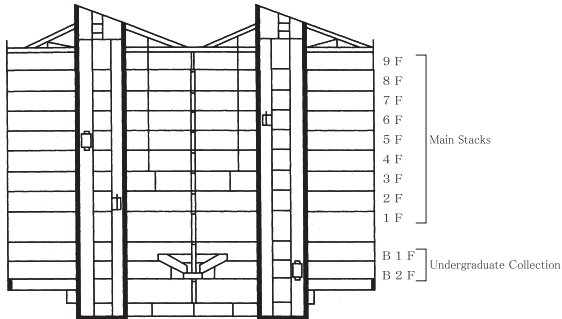
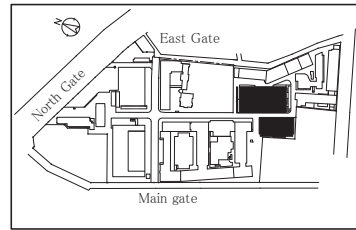

Building No. 10

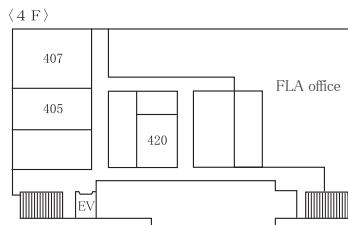
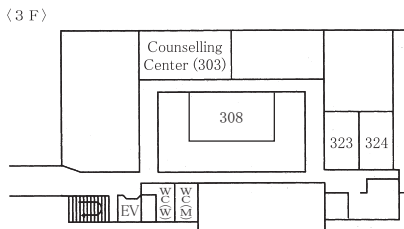
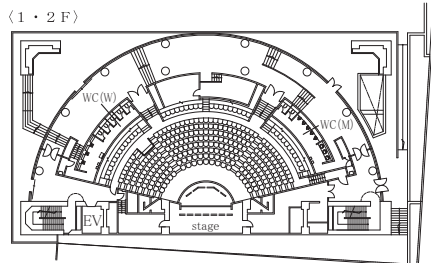
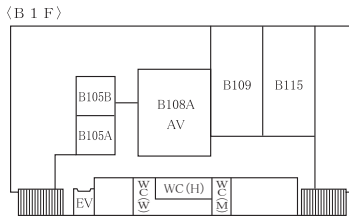

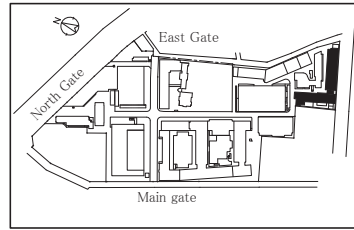

Building No. 11 & Jochi Kioizaka Building

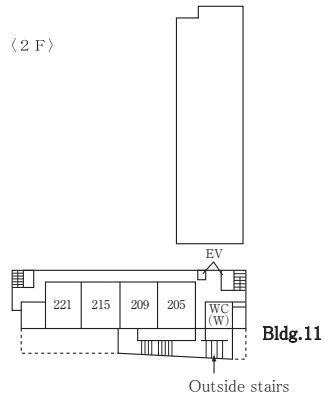
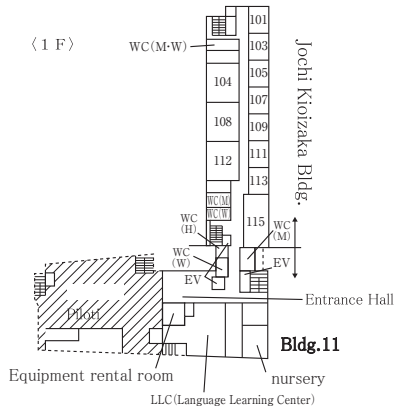
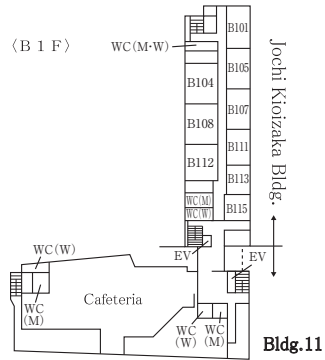
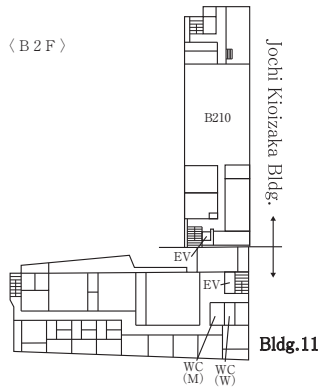



Building No. 11

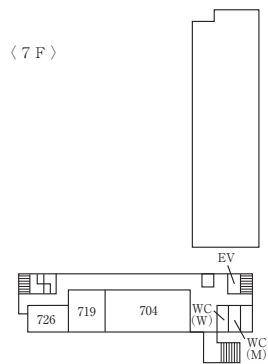
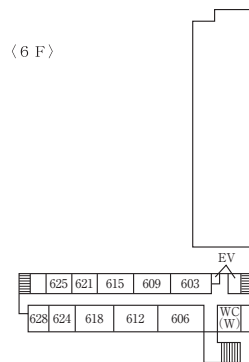
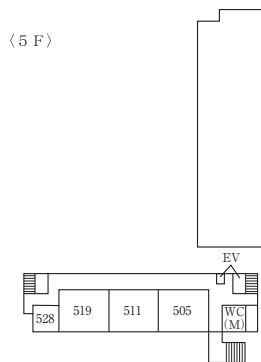
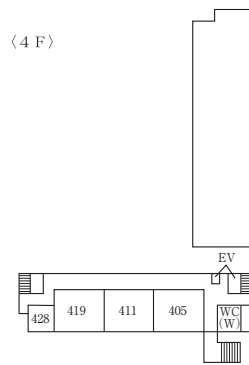
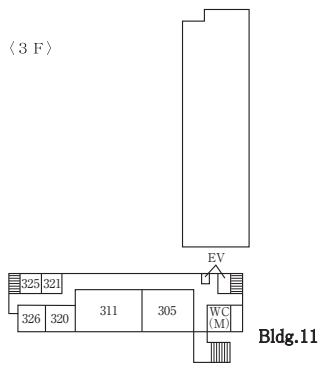
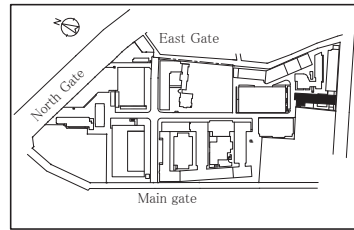

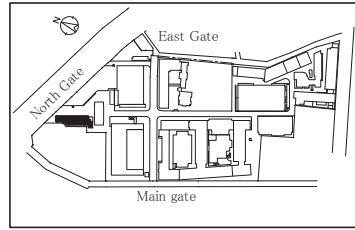

Building No. 12

(B1F)

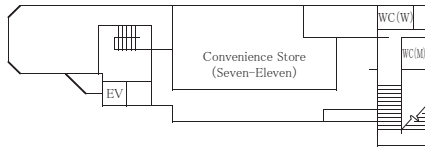

(1F)

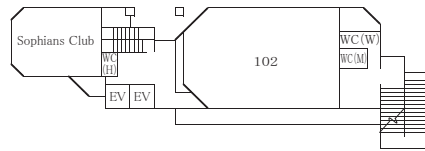

(2F)

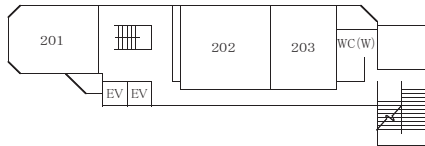

(3F)

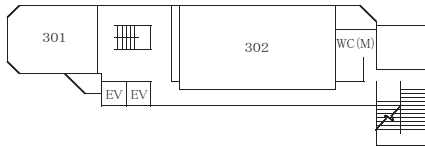

(4F)

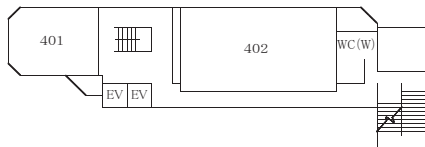

(5F)

